

(SUBMIT IN TRIPLICATE)

UNITED STATES
DEPARTMENT OF THE INTERIOR
GEOLOGICAL SURVEY

Land Office Santa Fe
Lease No. 078155
Unit Maryo

SUNDRY NOTICES AND REPORTS ON WELLS

NOTICE OF INTENTION TO DRILL	<input checked="" type="checkbox"/>	SUBSEQUENT REPORT OF WATER SHUT-OFF	
NOTICE OF INTENTION TO CHANGE PLANS		SUBSEQUENT REPORT OF SHOOTING OR ACIDIZING	
NOTICE OF INTENTION TO TEST WATER SHUT-OFF		SUBSEQUENT REPORT OF ALTERING CASING	
NOTICE OF INTENTION TO RE-DRILL OR REPAIR WELL		SUBSEQUENT REPORT OF RE-DRILLING OR REPAIR	
NOTICE OF INTENTION TO SHOOT OR ACIDIZE		SUBSEQUENT REPORT OF ABANDONMENT	
NOTICE OF INTENTION TO PULL OR ALTER CASING		SUPPLEMENTARY WELL HISTORY	
NOTICE OF INTENTION TO ABANDON WELL			

(INDICATE ABOVE BY CHECK MARK NATURE OF REPORT, NOTICE, OR OTHER DATA)

January 16, 1957

Well No. Maryo 6 is located 1280 ft. from N line and 1980 ft. from E line of Sec. 1
(34 Sec. and Sec. No.) (25N (Twp.) (13 W (Range) New Mexico P.M. (Meridian)
Bisti-Gallup (San Juan County (New Mexico (State or Territory)
(Field) (County or Subdivision)



The elevation of the derrick floor above sea level is _____ ft.

DETAILS OF WORK

(State names of and expected depths to objective sands; show sizes, weights, and lengths of proposed casings; indicate mudding jobs, cementing points, and all other important proposed work)

To drill & test subject well to the Gallup S.S. Surface Casing: 9-5/8" OD 32.3', H-40 casing to be set at approx. 210' KB & cemented with 100 sax & circulated to surface. WOC 2 1/2 hrs. Production Casing: 5 1/2" OD 114', J-55 casing to be set through the lowest producing zone. Use centralizers & rotating type scratchers thru the Gallup & cement with 100 sax Pennix "A". Casing: None. Testing: None. Logging: Combination ES-Induction Log from TD to surface casing. Detail from TD to 1000' above TD. Microlog same as Detail ES. Run Gamma Ray in conjunction with perforating. Drilling Time: Use Geolograph from 210' to TD. Drift Surveys: At 50' intervals to 300'; thereafter at 250' intervals. Depth Measurements: SLM of drill pipe at approx. 150' above the Kansas & at TD. Samples: Collect 10' samples from 1000' to TD. Completion Program: Whenever practicable, completion will be with rotary.

I understand that this plan of work must receive approval in writing by the Geological Survey before operations may be commenced.

Company THE BRITISH-AMERICAN OIL PRODUCING COMPANY

Address P. O. Box 180

Denver 1, Colorado

Original Signed
By Thomas M. Hogan

Title District Superintendent



NEW MEXICO
OIL CONSERVATION COMMISSION

Form C-128

Well Location and/or Gas Proration Plat

Date _____

Operator British American Oil Producing Company Lease _____

Well No. Marys #6 Section 1 Township 25 North Range 13 West NMPM

Located 1880 Feet From North Line, 1980 Feet From East Line,

San Juan County, New Mexico. G. L. Elevation 6219

Name of Producing Formation _____ Pool _____ Dedicated Acreage _____

(Note: All distances must be from outer boundaries of Section)

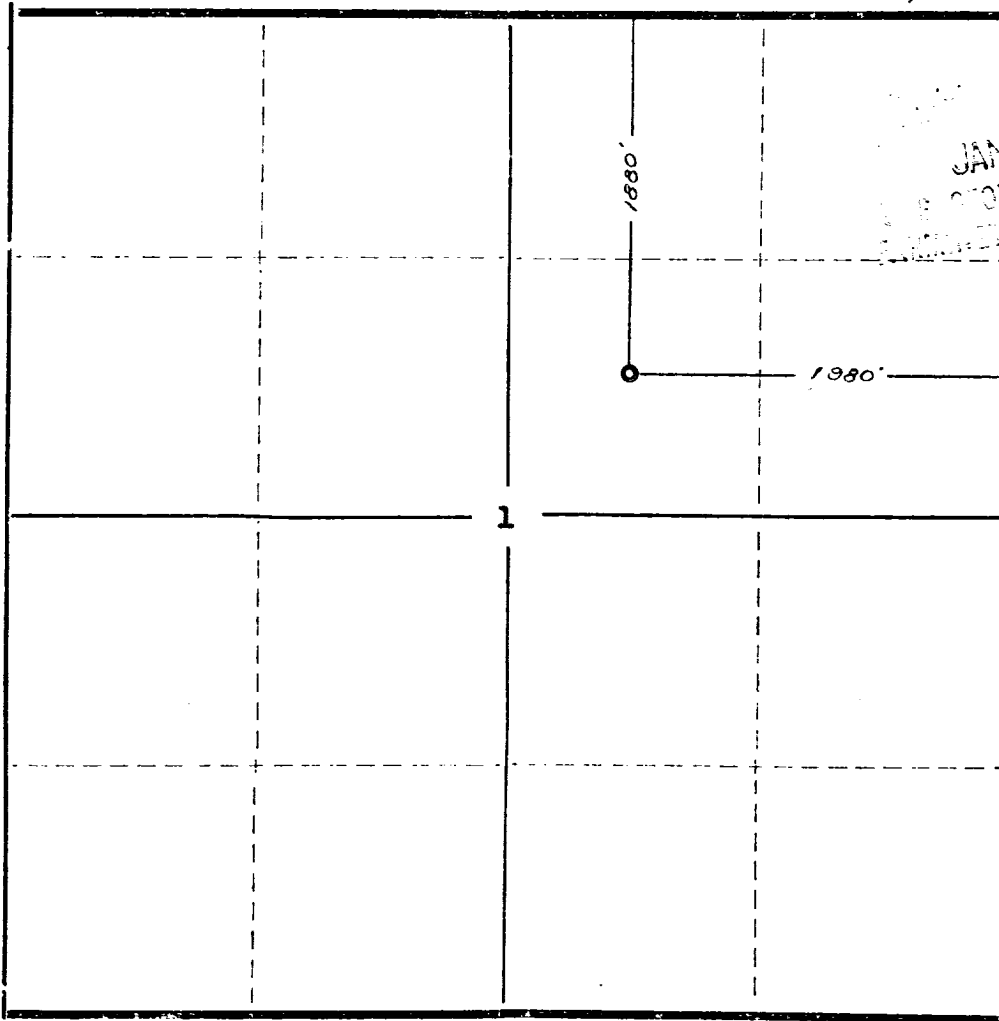

NOTE

This section of form is to be used for gas wells only.

1. Is this Well a Dual Comp. ? Yes ___ No ___
2. If the answer to Question 1 is yes, are there any other dually completed wells within the dedicated acreage?
Yes ___ No ___

Name _____
Position _____
Representing _____
Address _____

This is to certify that the above plat was prepared from field notes of actual surveys made by me or under my supervision and that the same are true and correct to the best of my knowledge and belief.

Date Surveyed January 16, 1957

Ernest V. Echohawk
Ernest V. Echohawk
Reg. Land Surveyor, N. Mex., Reg. No. 1545