

NEW MEXICO
OIL CONSERVATION COMMISSION

Form C-128

Well Location and/or Gas Proration Plat

Date 6-29-56

Operator BENSON-MONTIN Lease SHEETS

Well No. 5 Section 1 Township 25N Range 8W NMPM

Located 1470 Feet From north Line, 1230 Feet From east Line,

San Juan County, New Mexico. G. L. Elevation 6485

Name of Producing Formation Pictured Cliffs Pool Ballard Dedicated Acreage 160.37

(Note: All distances must be from outer boundaries of Section)

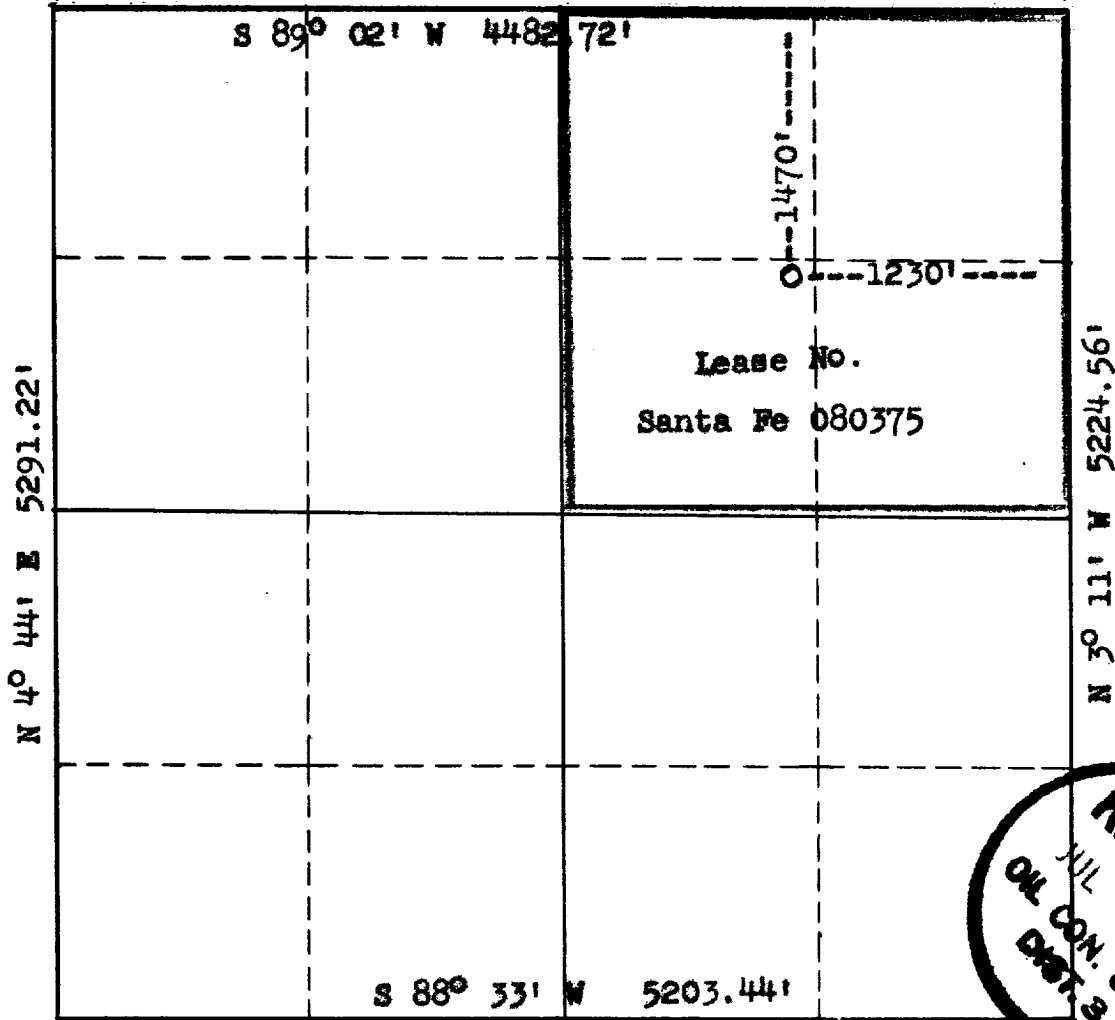

SCALE: 1"=1000'

1. Is this Well a Dual Comp. ? Yes No ~~X~~.
2. If the answer to Question 1 is yes, are there any other dually completed wells within the dedicated acreage? Yes No.

This is to certify that the above plat was prepared from field notes of actual surveys made by me or under my supervision and that the same are true and correct to the best of my knowledge and belief.

Name Albert J. Green
Position Field Superintendent
Representing Benson-Montin
Address 405 1/2 West Broadway
Farmington, New Mexico

Date Surveyed 1-30-56
S/ James P. Lease
Registered Professional Engineer and/or
Land Surveyor





OIL CONSERVATION COMMISSION		
AZTEC DISTRICT OFFICE		
No. Copies Received		3
DISTRIBUTION		
	NO. DISTRIBUTED	
Operator	1	
State Re		
Protection Off		
State Land Office	1	
U. S. G. S.		
Transporter	1	✓
File		