

(SUBMIT IN TRIPLICATE)

Land Office **Santa Fe**
Lease No. **078020**
Unit _____

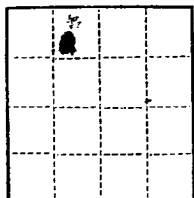

UNITED STATES
DEPARTMENT OF THE INTERIOR
GEOLOGICAL SURVEY

RECEIVED

SUNDRY NOTICES AND REPORTS ON WELLS

SEP 5 1953
U. S. GEOLOGICAL SURVEY

NOTICE OF INTENTION TO DRILL	<input checked="" type="checkbox"/>	SUBSEQUENT REPORT OF WATER SHUT-OFF	<input type="checkbox"/>
NOTICE OF INTENTION TO CHANGE PLANS	<input type="checkbox"/>	SUBSEQUENT REPORT OF SHOOTING OR ACIDIZING	<input type="checkbox"/>
NOTICE OF INTENTION TO TEST WATER SHUT-OFF	<input type="checkbox"/>	SUBSEQUENT REPORT OF ALTERING CASING	<input type="checkbox"/>
NOTICE OF INTENTION TO RE-DRILL OR REPAIR WELL	<input type="checkbox"/>	SUBSEQUENT REPORT OF RE-DRILLING OR REPAIR	<input type="checkbox"/>
NOTICE OF INTENTION TO SHOOT OR ACIDIZE	<input type="checkbox"/>	SUBSEQUENT REPORT OF ABANDONMENT	<input type="checkbox"/>
NOTICE OF INTENTION TO PULL OR ALTER CASING	<input type="checkbox"/>	SUPPLEMENTARY WELL HISTORY	<input type="checkbox"/>
NOTICE OF INTENTION TO ABANDON WELL	<input type="checkbox"/>		

(INDICATE ABOVE BY CHECK MARK NATURE OF REPORT, NOTICE, OR OTHER DATA)

Sept. 5, 1953

Figure No. 1

Well No. _____ is located **700** ft. from **[N]** line and **1650** ft. from **[E]** line of sec. **1**

SW 1/4
(1/4 Sec. and Sec. No.)

25 N.
(Twp.)

10 W.
(Range)

N.M.P.M.
(Meridian)

Wildcat
(Field)

San Juan
(County or Subdivision)

New Mexico
(State or Territory)

The elevation of the derrick floor above sea level is **6755** ft. (**6755 ft., ungraded ground**)

DETAILS OF WORK

(State names of and expected depths to objective sands; show sizes, weights, and lengths of proposed casings; indicate mudding jobs, cementing points, and all other important proposed work)

Pictured Cliffs, 2200 feet, with Rotary, shoot section with two quarts nitro-glycerine per foot; however, will test Fruitland and Farmington if these sections indicate production, or are not trashy.

Will set 10 & 1 1/2 inch surface pipe to 100 feet with 150 sacks of cement; 17 pound 7 inch to approximately 2200 feet.

Jay J. Harris, Geologist; Ben Banner, drilling contractor

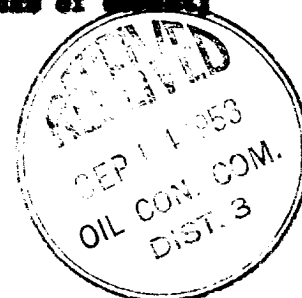

I understand that this plan of work must receive approval in writing by the Geological Survey before operations may be commenced.

Company **Lucille H. Piskin, independent**

Address **P.O. Box 1174**

Reswell, N.M.

By

Title **Owner**

THE
OFFICE OF THE
ATTORNEY GENERAL
STATE OF NEW YORK
ALBANY

RECEIVED
JAN 10 1906
OFFICE OF THE
ATTORNEY GENERAL
ALBANY

REPORT OF THE COMMISSIONER OF THE LAND OFFICE

FOR THE YEAR 1905
ALBANY: PUBLISHED BY THE STATE OF NEW YORK, 1906.
COMMISSIONER OF THE LAND OFFICE
ALBANY

THE
OFFICE OF THE
ATTORNEY GENERAL
STATE OF NEW YORK
ALBANY

REPORT OF THE COMMISSIONER OF THE LAND OFFICE

FOR THE YEAR 1905
ALBANY: PUBLISHED BY THE STATE OF NEW YORK, 1906.
COMMISSIONER OF THE LAND OFFICE
ALBANY

THE
OFFICE OF THE
ATTORNEY GENERAL
STATE OF NEW YORK
ALBANY

Company..... **LUCILLE PIPKIN**

Lease..... Well No.....

Sec..... **1**, T..... **25 N**, R..... **10 W, N.M.P.M.**

Location..... **700' from the North line and 1650' from the West line.**

Elevation: 6755 Ungraded ground.

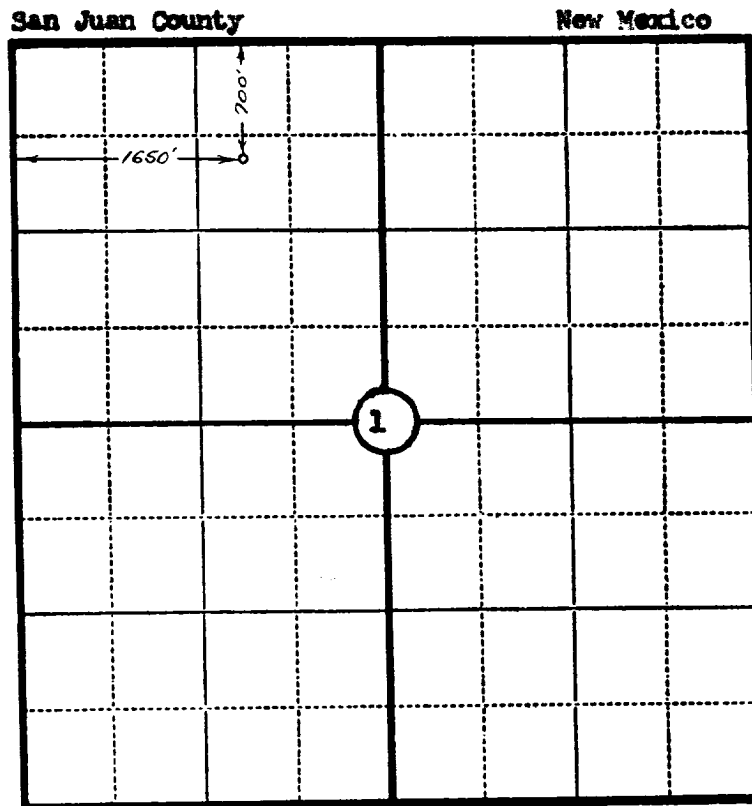

Scale—4 inches equal 1 mile.

This is to certify that the above plat was prepared from field notes of actual surveys made by me or under my supervision and that the same are true and correct to the best of my knowledge and belief.

Seal:

James P. Leese
Registered Professional
Engineer and Land Surveyor.

James P. Leese
N. Mex. Reg. No. 1463

Surveyed **11 August**, 19**53**

