

(SUBMIT IN TRIPLICATE)

UNITED STATES
DEPARTMENT OF THE INTERIOR
GEOLOGICAL SURVEY

Land Office Santa Fe, N.M.

Lease No. SF 078063

Unit Carson Unit

SUNDRY NOTICES AND REPORTS ON WELLS

NOTICE OF INTENTION TO DRILL.....	<input checked="" type="checkbox"/>	SUBSEQUENT REPORT OF WATER SHUT-OFF.....	
NOTICE OF INTENTION TO CHANGE PLANS.....		SUBSEQUENT REPORT OF SHOOTING OR ACIDIZING.....	
NOTICE OF INTENTION TO TEST WATER SHUT-OFF.....		SUBSEQUENT REPORT OF ALTERING CASING.....	
NOTICE OF INTENTION TO RE-DRILL OR REPAIR WELL.....		SUBSEQUENT REPORT OF RE-DRILLING OR REPAIR.....	
NOTICE OF INTENTION TO SHOOT OR ACIDIZE.....		SUBSEQUENT REPORT OF ABANDONMENT.....	
NOTICE OF INTENTION TO PULL OR ALTER CASING.....		SUPPLEMENTARY WELL HISTORY.....	
NOTICE OF INTENTION TO ABANDON WELL.....			

(INDICATE ABOVE BY CHECK MARK NATURE OF REPORT, NOTICE, OR OTHER DATA)

December 30, 19 60

Sisti Water Well
Well No. -2 is located 1922 ft. from [N] line and 2471 ft. from [E] line of sec. 19

SE 19 25 N 11 W 104PM
(1/4 Sec. and Sec. No.) (Twp.) (Range) (Meridian)
Sisti San Juan New Mexico
(Field) (County or Subdivision) (State or Territory)

The elevation ~~of the wellhead~~ is 6444 ft. (approx. ground)

DETAILS OF WORK

(State names of and expected depths to objective sands; show sizes, weights, and lengths of proposed casings; indicate mudding jobs, cementing points, and all other important proposed work)

Proposed Work:

1. Drill 13-3/4" hole to 60'±.
2. Run and cement 10-3/4", 40.5#, H-40 casing at 60'± with 60 sacks cement treated with 2% calcium chloride.
3. Drill 9" hole to total depth of 3900'±.
4. Run and cement 7", 23#, J-55 casing at 3900'± with 150 sacks cement and Diamix treated with 4% calcium chloride.
5. Perforate 2 bullet holes/ft. selected intervals between 2800 and 2900' (Lower Allison-Memphie and Point Lookout formations)
6. Make production tests and establish rate.

I understand that this plan of work must receive approval in writing by the Geological Survey before operations may be commenced.

Company Shell Oil Company

Address P. O. Box 1200

Farmington, New Mexico

Original Signed By
W. M. MARSHALL

By W. M. Marshall
Title Division Exploitation Engineer

NEW MEXICO OIL CONSERVATION COMMISSION

Well Location and Acreage Dedication Plat

Section A.

Date December 30, 1960

Operator Shell Oil Company Lease Carson Unit
 Well No. W-2 Unit Letter _____ Section 19 Township 25 N. Range 11 W. NMPM
 Located 1922 Feet From The North Line, 2471 Feet From The West Line
 County San Juan G. L. Elevation 6444 Dedicated Acreage _____ Acres
 Name of Producing Formation _____ Pool _____

1. Is the Operator the only owner in the dedicated acreage outlined on the plat below?
 Yes X No _____
2. If the answer to question one is "no", have the interests of all the owners been consolidated by communitization agreement or otherwise? Yes _____ No _____. If answer is "yes", Type of Consolidation. _____
3. If the answer to question two is "no", list all the owners and their respective interests below:

OwnerLand Description

Section B.

Note: All distances must be from outer boundaries of section.

This is to certify that the information in Section A above is true and complete to the best of my knowledge and belief.

Shell Oil Company

(Operator)
 Original Signed By
W. M. MARSHALL
 (Representative)

P.O. Box 1200

(Address)

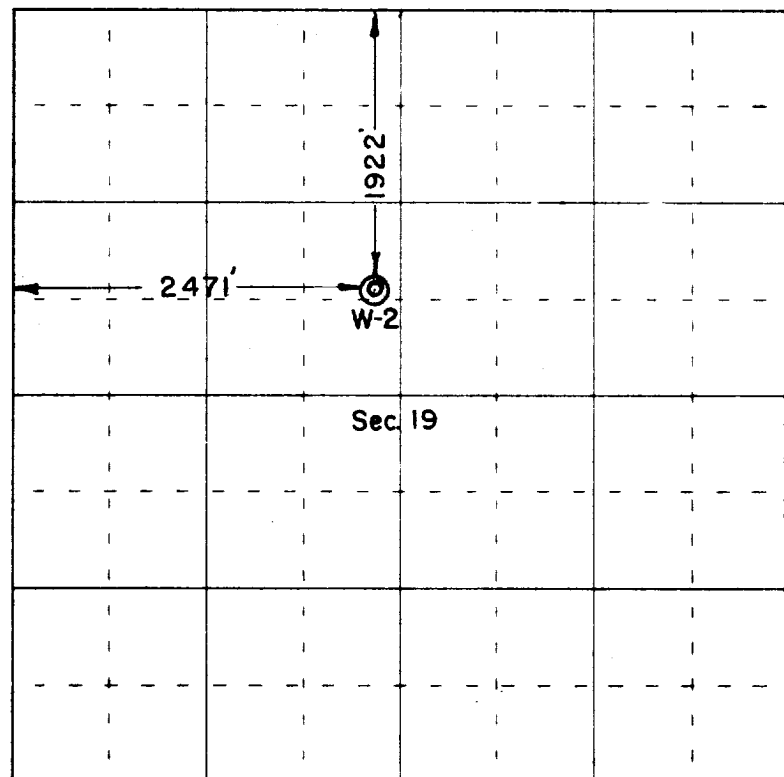
Farmington, New Mexico

0 330 660 990 1320 1650 1980 2310 2640 2000 1500 1000 500 0

Scale 4 inches equal 1 mile

This is to certify that the above plat was prepared from field notes of actual surveys made by me or under my supervision and that the same are true and correct to the best of my knowledge and belief.

(Seal)

Date Surveyed 12-29-1960

Blaine H Fitzgerald
 Registered Professional Engineer and/or Land Surveyor

Farmington, New Mexico