

(SUBMIT IN TRIPLICATE)

UNITED STATES
DEPARTMENT OF THE INTERIOR
GEOLOGICAL SURVEY

Land Office Santa Fe, N.M.
Lease No. 678664
Unit Carson Unit

SUNDRY NOTICES AND REPORTS ON WELLS

NOTICE OF INTENTION TO DRILL.....	<input checked="" type="checkbox"/>	SUBSEQUENT REPORT OF WATER SHUT-OFF.....	
NOTICE OF INTENTION TO CHANGE PLANS.....		SUBSEQUENT REPORT OF SHOOTING OR ACIDIZING.....	
NOTICE OF INTENTION TO TEST WATER SHUT-OFF.....		SUBSEQUENT REPORT OF ALTERING CASING.....	
NOTICE OF INTENTION TO RE-DRILL OR REPAIR WELL.....		SUBSEQUENT REPORT OF RE-DRILLING OR REPAIR.....	
NOTICE OF INTENTION TO SHOOT OR ACIDIZE.....		SUBSEQUENT REPORT OF ABANDONMENT.....	
NOTICE OF INTENTION TO PULL OR ALTER CASING.....		SUPPLEMENTARY WELL HISTORY.....	<u>AUG 20 1959</u>
NOTICE OF INTENTION TO ABANDON WELL.....			

(INDICATE ABOVE BY CHECK MARK NATURE OF REPORT, NOTICE, OR OTHER DATA)

Well No. 13-13 is located 130 ft. from N line and 60 ft. from E line of sec. 13
13 (1/4 Sec. and Sec. No.) 35 (Twp.) 1 (Range) 12 (Meridian)
131 (Field) San Juan (County or Subdivision) New Mexico (State or Territory)

The elevation of the derrick floor above sea level is 6397.4 ft. (above mean low water)

DETAILS OF WORK

(State names of and expected depths to objective sands; show sizes, weights, and lengths of proposed casings; indicate mudlogging jobs, cementing points, and all other important proposed work)

Proposed Work:

1. Drill 12-1/4" hole to 110'.
2. Cement 8-5/8", 24, 1-5' casing at 110' with 50 sacks cement (circulated).
3. Drill 7-7/8" hole to 320' (objective - Gallup).
4. Cement 4-1/2", 9.5#, 1-5' casing at 320' with 150 sacks cement.
5. perforate four 1/2" holes/ft selected intervals between 410 - 420.
6. sand oil fracture with 50,000 gal. crude, 1 1/2 gal. sand.
7. See over load and free oil establish initial rate.

I understand that this plan of work must receive approval in writing by the Geological Survey before operations may be commenced.

Company Shell Oil Company
Address 130
Hamington, N.M.

By R. L. Howard
Title Permitting Engineer

NEW MEXICO OIL CONSERVATION COMMISSION

Well Location and Acreage Dedication Plat

Section A.

Date **13 JANUARY 1958**Operator **SHELL OIL COMPANY**

Carson Unit

Lease **E. W. Mudge #3**

SF 078064

Well No. **13-13** Unit Letter **L** Section **13**Township **25 NORTH** Range **12 WEST** NMPMLocated **1930'** Feet From **THE SOUTH** Line **660**Feet From **THE WEST** LineCounty **SAN JUAN** G. L. Elevation **6397.4**Dedicated Acreage **40** AcresName of Producing Formation **Gallup**Pool **Bisti**

1. Is the Operator the only owner in the dedicated acreage outlined on the plat below?

Yes ☒ No ☐2. If the answer to question one is "no", have the interests of all the owners been consolidated by communization agreement or otherwise? Yes ☐ No ☐ If answer is "yes", Type of Consolidation.

3. If the answer to question two is "no", list all the owners and their respective interests below:

Owner

Land Description

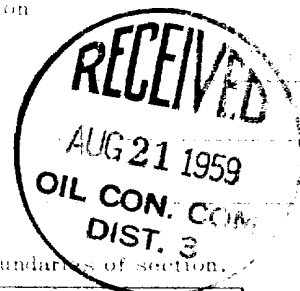

Section B.

Note: All distances must be from outer boundaries of section.

This is to certify that the information in Section A above is true and complete to the best of my knowledge and belief.

Shell Oil Company

(Operator)

(Representative)

101 South Behrend Avenue

(Address)

Farmington, New Mexico

REF. GLO Plat dated, 19 July 1915
T.B.M. Iron pin 260' WEST of Loc.
Elev. 6410.95

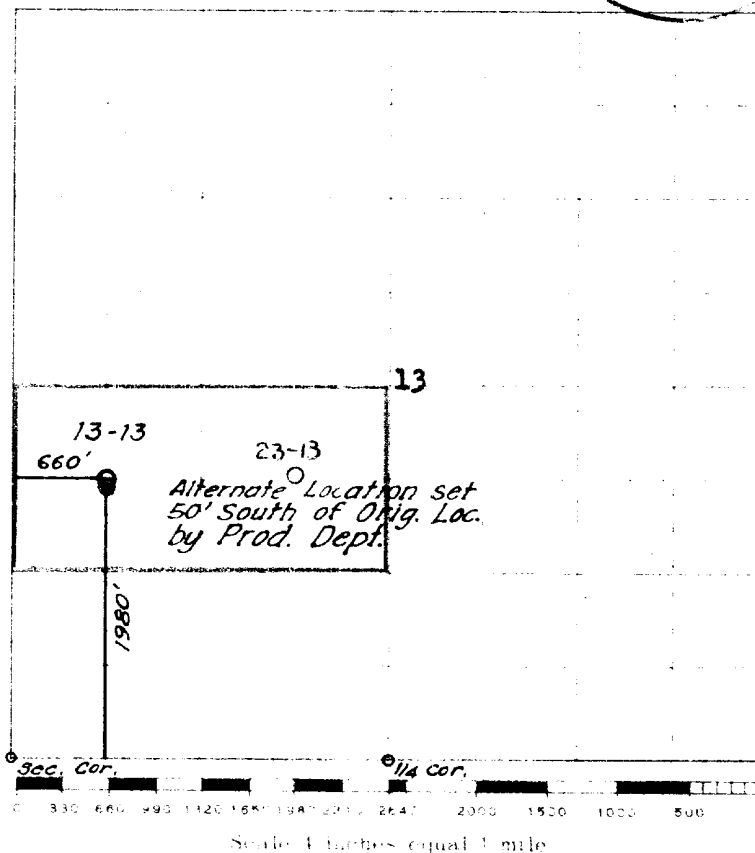

Scale: 1 inch equals 1 mile

This is to certify that the above plat was prepared from field notes of actual surveys made by me or under my supervision and that the same are true and correct to the best of my knowledge and belief.

Date Surveyed **11 JANUARY 1958**

James P. Lerser
Registered Professional Engineer and/or Land Surveyor
JAMES P. LERSER NEW MEXICO REG. NO. 1142



Farmington, New Mexico