

Form 9-331a
(Feb. 1951)

(SUBMIT IN TRIPLICATE)

UNITED STATES
DEPARTMENT OF THE INTERIOR
GEOLOGICAL SURVEY

Land Office Santa Fe
Lease No. 13A 07056
Unit Q

RECEIVED

SUNDRY NOTICES AND REPORTS ON WELLS
GEOLOGICAL SURVEY,
FARMINGTON, NEW MEXICO

NOTICE OF INTENTION TO DRILL	<input checked="" type="checkbox"/>	SUBSEQUENT REPORT OF WATER SHUT-OFF	
NOTICE OF INTENTION TO CHANGE PLANS		SUBSEQUENT REPORT OF SHOOTING OR ACIDIZING	
NOTICE OF INTENTION TO TEST WATER SHUT-OFF		SUBSEQUENT REPORT OF ALTERING CASING	
NOTICE OF INTENTION TO RE-DRILL OR REPAIR WELL		SUBSEQUENT REPORT OF RE-DRILLING OR REPAIR	
NOTICE OF INTENTION TO SHOOT OR ACIDIZE		SUBSEQUENT REPORT OF ABANDONMENT	
NOTICE OF INTENTION TO PULL OR ALTER CASING		SUPPLEMENTARY WELL HISTORY	
NOTICE OF INTENTION TO ABANDON WELL			

(INDICATE ABOVE BY CHECK MARK NATURE OF REPORT, NOTICE, OR OTHER DATA)

July 23, 1952

Well No. 4 is located 640 ft. from N line and 1000 ft. from W line of sec. 6

13A of 13A Sec. 6 25N 12W AMST
(1/4 Sec. and Sec. No.) (Twp.) (Range) (Meridian)

State Gallup San Juan New Mexico
(Field) (County or Subdivision) (State or Territory)

The elevation of the ~~derrick floor~~ ground level above sea level is 6194 ft.

DETAILS OF WORK

(State names of and expected depths to objective sands; show sizes, weights, and lengths of proposed casings; indicate mudding jobs, cementing points, and all other important proposed work)

We propose to drill a 1950' rotary tool test of the Gallup sandstone.

We propose to drill a 12 1/2" hole to approximately 100' and to set 2 5/8" casing and circulate cement to the surface.

We propose to drill a 7 7/8" hole to approximately 1950' and to set 5 1/2" casing on bottom and with sufficient cement to place the top in the annulus 500' above the pay zone. The casing will be perforated and the formation stimulated as necessary for commercial production.

I understand that this plan of work must receive approval in writing by the Geological Survey before operations may be commenced.

Company Sanjour Oil-Consolidated Oil Company

Address Room 166

Petroleum Center Building

Farmington, New Mexico

By Thomas R. Doreity

Title Jr. Engineer

NEW MEXICO OIL CONSERVATION COMMISSION
WELL LOCATION AND ACREAGE DEDICATION PLAT

FORM C-128
Revised 5/1/57

SEE INSTRUCTIONS FOR COMPLETING THIS FORM ON THE REVERSE SIDE

SECTION A

Operator SUNRAY MID-CONTINENT OIL CO.		Lease CENTRAL BISTI UNIT		Well No. 4
Unit Letter C	Section 6	Township 25 NORTH	Range 12 WEST	County SAN JUAN
Actual Footage Location of Well: 660 feet from the NORTH line and 1980 feet from the WEST line				
Ground Level Elev. 6164.3	Producing Formation Lower Gallup Sand		Pool Bisti	Dedicated Acreage: 80 Acres

1. Is the Operator the only owner in the dedicated acreage outlined on the plat below? YES _____ NO X. ("Owner" means the person who has the right to drill into and to produce from any pool and to appropriate the production either for himself or for himself and another. (65-3-29 (e) NMSA 1935 Comp.)
2. If the answer to question one is "no," have the interests of all the owners been consolidated by communization agreement or otherwise? YES X NO _____. If answer is "yes," Type of Consolidation Unitization
3. If the answer to question two is "no," list all the owners and their respective interests below:

Owner	Land Description

SECTION B

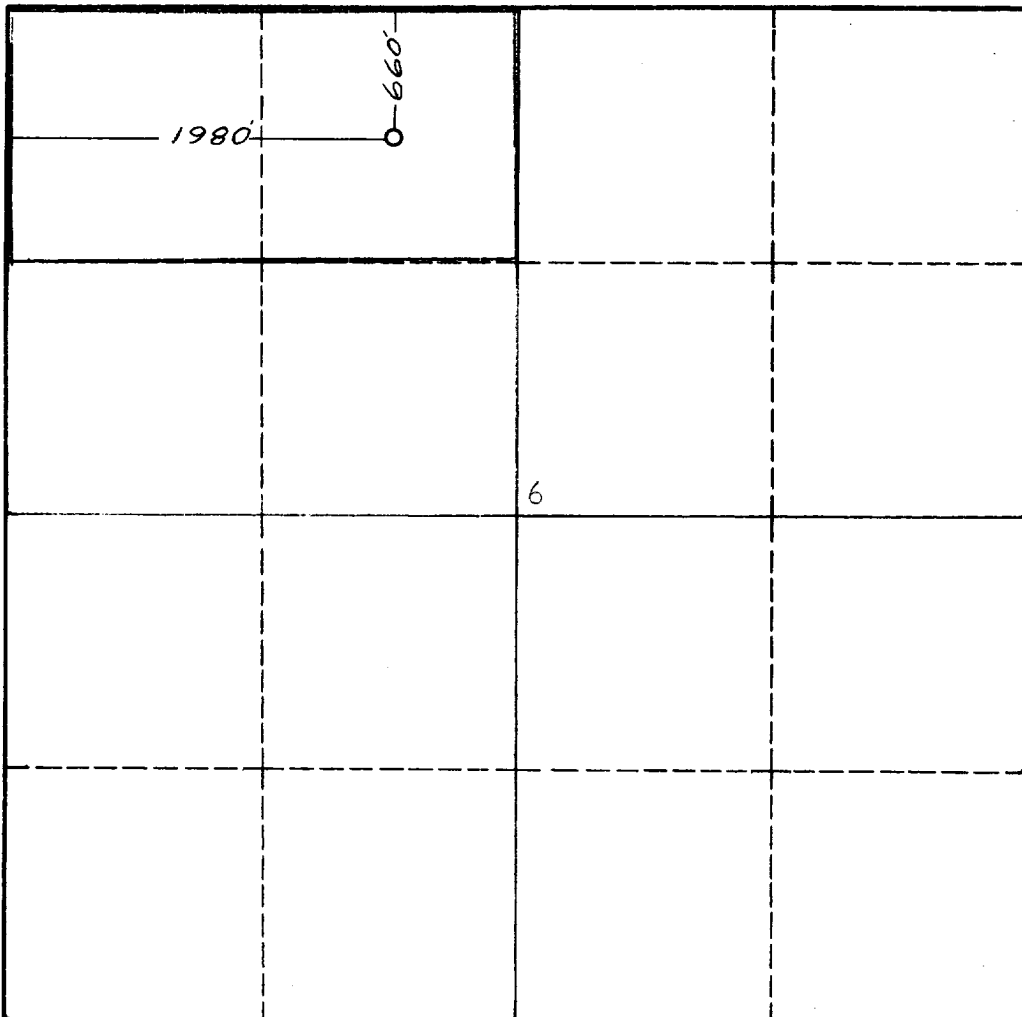

CERTIFICATION

I hereby certify that the information in SECTION A above is true and complete to the best of my knowledge and belief.

Thomas R. Lavery
Name
Thomas R. Lavery
Position
Jr. Engineer
Company
Sunray Mid-Continent
Date
July 23, 1959

I hereby certify that the well location shown on the plat in SECTION B was plotted from field notes of actual surveys made by me or under my supervision, and that the same is true and correct to the best of my knowledge and belief.

Date Surveyed
July 20, 1959
Registered Professional Engineer
and/or Land Surveyor
James P. Lave
JAMES P. LAVE

Certificate No.
1463

INSTRUCTIONS FOR COMPLETION OF FORM C-128

1. Operator shall furnish and certify to the information called for in Section A.
2. Operator shall outline the dedicated acreage for *both* oil and gas wells on the plat in Section B.
3. A registered professional engineer or land surveyor registered in the State of New Mexico or approved by the Commission shall show on the plat the location of the well and certify this information in the space provided.
4. All distances shown on the plat must be from the outer boundaries of the Section.
5. If additional space is needed for listing owners and their respective interests as required in question 3 of Section A, please use space below.