

UNITED STATES
DEPARTMENT OF THE INTERIOR
GEOLOGICAL SURVEY

APPLICATION FOR PERMIT TO DRILL, DEEPEN, OR PLUG BACK

30-045-21315

5. LEASE DESIGNATION AND SERIAL NO.

NCO-C14-20-3597-2

6. IS INDIAN, ALLOTTED OR TRIBE NAME

Navajo

7. UNIT AGREEMENT NAME

8. FARM OR LEASE NAME

Canyon

9. WELL NO.

5

10. FIELD AND POOL, OR WILLOCAT

Basin Dakota

11. SEC., T., R., M., OR BLK.
AND SURVEY OR AREA

Sec. 3, T25N, R11W

12. COUNTY OR PARISH

San Juan

13. STATE

New Mexico

17. NO. OF ACRES ASSIGNED
TO THIS WELL

320 1/8

20. ROTARY OR CABLE TOOLS

Rotary

22. APPROX. DATE WORK WILL START*
when permit approved

1. TYPE OF WORK

DRILL ☒DEEPEN ☐PLUG BACK ☐

b. TYPE OF WELL

OIL
WELL ☐GAS
WELL ☒

OTHER

SINGLE
ZONE ☐MULTIPLE
ZONE ☐

2. NAME OF OPERATOR

TENNECO OIL COMPANY

3. ADDRESS OF OPERATOR

Suite 1200 Lincoln Tower Bldg., Denver, Colorado 80203

4. LOCATION OF WELL (Report location clearly and in accordance with any State requirements.*)

At surface

800' FSL and 1840' FEL

At proposed prod. zone

14. DISTANCE IN MILES AND DIRECTION FROM NEAREST TOWN OR POST OFFICE*

15. DISTANCE FROM PROPOSED*

LOCATION TO NEAREST
PROPERTY OR LEASE LINE, FT.
(Also to nearest drlg. unit line, if any)

800'

16. NO. OF ACRES IN LEASE

18. DISTANCE FROM PROPOSED LOCATION*
TO NEAREST WELL, DRILLING, COMPLETED,
OR APPLIED FOR, ON THIS LEASE, FT.19. PROPOSED DEPTH
6,000'

21. ELEVATIONS (Show whether DF, RT, GR, etc.)

6280.0 GR

23.

PROPOSED CASING AND CEMENTING PROGRAM

SIZE OF HOLE	SIZE OF CASING	WEIGHT PER FOOT	SETTING DEPTH	QUANTITY OF CEMENT
12-1/4"	8-5/8"	24#	600'	sufficient to circulate
7-7/8"	5-1/2"	15.5#	6,000'+	2 stages. 1st. stage, T/C above Gallup. 2nd. stage, T/C above Kirtland.

Well to be drilled to approximate TD of 6,000', log, and if commercial production is indicated, run 5-1/2" casing to T.D. and cement in two stages to cover zones as indicated. Perforate casing and treat formation as necessary to establish production. B. O. P. to be tested each 24 hours.

IN ABOVE SPACE DESCRIBE PROPOSED PROGRAM: If proposal is to deepen or plug back, give data on present productive zone and proposed new productive zone. If proposal is to drill or deepen directionally, give pertinent data on subsurface locations and measured and true vertical depths. Give blowout preventer program, if any.

24.

SIGNED

Carley Watkins

TITLE Sr. Production Clerk

DATE July 30, 1973

(This space for Federal or State office use)

PERMIT NO.

APPROVAL DATE

APPROVED BY

TITLE

CONDITIONS OF APPROVAL, IF ANY:

*See Instructions On Reverse Side

U. S. GEOLOGICAL SURVEY
FARMINGTON, N. M.

**NEW MEXICO OIL CONSERVATION COMMISSION
WELL LOCATION AND ACERAGE DEDICATION PLAT**

All distances must be from the outer boundaries of the Section

Operator TENNECO OIL COMPANY		Lease CANYON		Well No 5	
Unit Letter 0	Section 3	Township 25 NORTH	Range 11 WEST	County SAN JUAN	
Actual Footage Location of Well:					
800 feet from the SOUTH line and		1840 feet from the EAST line			
Ground Level Elev. 6280.0	Producing Formation DAKOTA	Pool BASIN DAKOTA	Dedicated Acreage: 320.81 Acres		

- Outline the acreage dedicated to the subject well by colored pencil or hatchure marks on the plat below.
- If more than one lease is dedicated to the well, outline each and identify the ownership thereof (both as to working interest and royalty),
- If more than one lease of different ownership is dedicated to the well, have the interests of all owners been consolidated by communitization, unitization, force-pooling, etc?

(X) Yes () No If answer is "yes," type of consolidation Communitization

If answer is "no," list the owners and tract descriptions which have actually consolidated. (Use reverse side of this form if necessary.)

No allowable will be assigned to the well until all interests have been consolidated (by communitization, unitization, forced-pooling, or otherwise) or until a non standard unit, eliminating such interests, has been approved by the Commission.

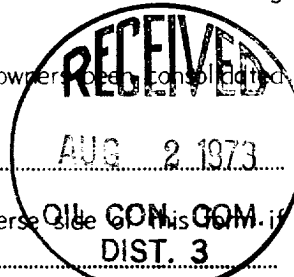

CERTIFICATION

I hereby certify that the information contained herein is true and complete to the best of my knowledge and belief.

Name Charley Hattam
 Position Sr. Production Clerk
 Company TENNECO OIL COMPANY
 Date 7/30/73

I hereby certify that the well location shown on this plat was plotted from field notes of actual surveys made by me or under my supervision, and that the same is true and correct to the best of my knowledge and belief.

18 June, 1973
 Date Surveyed
James P. Leese
 Registered Professional Engineer
 and/or Land Surveyor
JAMES P. LEESE

1463
 Certificate No.

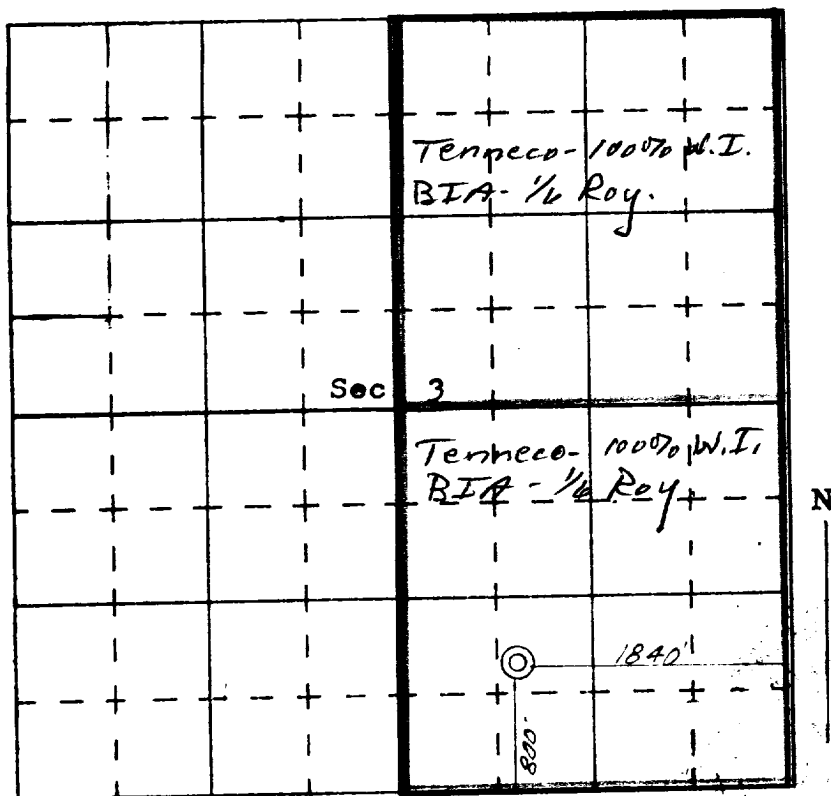

SCALE—4 INCHES EQUALS 1 MILE