

UNITED STATES
DEPARTMENT OF THE INTERIOR
GEOLOGICAL SURVEY

API 30-045-22032

APPLICATION FOR PERMIT TO DRILL, DEEPEN, OR PLUG BACK

1a. TYPE OF WORK

DRILL ☒DEEPEN ☐PLUG BACK ☐

b. TYPE OF WELL

OIL
WELL ☐GAS
WELL ☒

OTHER

SINGLE
ZONE ☒MULTIPLE
ZONE ☐

2. NAME OF OPERATOR

Union Oil Company of California

3. ADDRESS OF OPERATOR

P. O. Box 2620 - Casper, WY 82601

4. LOCATION OF WELL (Report location clearly and in accordance with any State requirements.)*

At surface

850' FNL & 850' FEL

At proposed prod. zone

Dakota

14. DISTANCE IN MILES AND DIRECTION FROM NEAREST TOWN OR POST OFFICE*

26 Miles South of Bloomfield, New Mexico

15. DISTANCE FROM PROPOSED*

LOCATION TO NEAREST
PROPERTY OR LEASE LINE, FT.
(Also to nearest drilg. unit line, if any)

850'

16. NO. OF ACRES IN LEASE

160

17. NO. OF ACRES ASSIGNED
TO THIS WELL

N / 318.68

18. DISTANCE FROM PROPOSED LOCATION*

TO NEAREST WELL, DRILLING, COMPLETED,
OR APPLIED FOR, ON THIS LEASE, FT. None on Lease

19. PROPOSED DEPTH

6250'

20. ROTARY OR CABLE TOOLS

Rotary

21. ELEVATIONS (Show whether DF, RT, GR, etc.)

6589' G.L.

22. APPROX. DATE WORK WILL START*

6-6-76

23.

PROPOSED CASING AND CEMENTING PROGRAM

SIZE OF HOLE	SIZE OF CASING	WEIGHT PER FOOT	SETTING DEPTH	QUANTITY OF CEMENT
12-1/4"	8-5/8"	24#	700'	300 sacks or to surface
7-7/8"	5-1/2"	15.5#	6250'	400 sacks

PROPOSED PROGRAM:

Drill 12-1/4" hole to 700'. Run and cement 8-5/8" casing. Drill 7-7/8" hole to 6250'. Log and if production is indicated, run and cement 5-1/2" casing. The well will be completed with 2-3/8" tubing.

The B.O.P. will be given a daily operational test and each test logged.

NOTE: Subject acreage is not dedicated to a producer.

IN ABOVE SPACE DESCRIBE PROPOSED PROGRAM: If proposal is to deepen or plug back, give data on present productive zone and proposed new productive zone. If proposal is to drill or deepen directionally, give pertinent data on subsurface locations and measured and true vertical depths. Give blowout preventer program, if any.

24.

SIGNED R. G. Ladd, Jr.TITLE District Drilling Supt.DATE 4-2-76

(This space for Federal or State office use)

PERMIT NO. _____

APPROVAL DATE _____

APPROVED BY _____

TITLE _____

DATE _____

CONDITIONS OF APPROVAL, IF ANY:

*See Instructions On Reverse Side

NEW MEXICO OIL CONSERVATION COMMISSION
WELL LOCATION AND ACREAGE DEDICATION PLAT

(STATE)
Form C-102
Supersedes C-128
Effective 1-1-65

All distances must be from the outer boundaries of the Section.

Operator Union Oil Company of California			Lease Navajo		Well No. 7 (A30)
Unit Letter A	Section 30	Township 25 North	Range 10 West	County San Juan	
Actual Footage Location of Well: 850 feet from the North line and 850 feet from the East line					
Ground Level Elev. 6589	Producing Formation Dakota		Pool Basin Dakota	Dedicated Acreage: <input checked="" type="checkbox"/> N/ 318.68 Acres	

1. Outline the acreage dedicated to the subject well by colored pencil or hachure marks on the plat below.
2. If more than one lease is dedicated to the well, outline each and identify the ownership thereof (both as to working interest and royalty).
3. If more than one lease of different ownership is dedicated to the well, have the interests of all owners been consolidated by communitization, unitization, force-pooling, etc?

☐ Yes ☐ No If answer is "yes," type of consolidation (SEE REVERSE SIDE)

If answer is "no," list the owners and tract descriptions which have actually been consolidated. (Use reverse side of this form if necessary.) _____

No allowable will be assigned to the well until all interests have been consolidated (by communitization, unitization, forced-pooling, or otherwise) or until a non-standard unit, eliminating such interests, has been approved by the Commission.

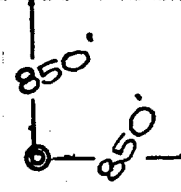
	
W.I. Owner - Union Royalty Interest - Navajo	W.I. Owner - Union Royalty Interest - Navajo
Navajo Allotted - 158.68 ac. SEC. 30	Navajo Allotted - 160 ac.

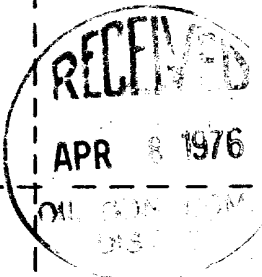

CERTIFICATION

I hereby certify that the information contained herein is true and complete to the best of my knowledge and belief.

Name *J. L. Ladd*
Position District Drilling Supt.
Company Union Oil Company of Calif.
Date April 2, 1976

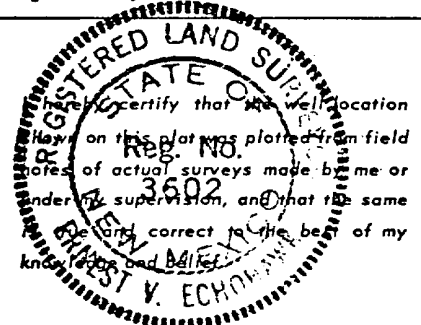

Date Surveyed March 29, 1976
Registered Professional Engineer and/or Land Surveyor
E.V. Echohawk
Certificate No. 3602
E.V. Echohawk LS



Union Oil Company of California

Section 30

Range 10 West

Township 25 North

Range 10 West

Section 30

Section 30

Range 10 West

Township 25 North

Range 10 West

Section 30

Union owns W.I. under both tracts and plans to communitize the N $\frac{1}{2}$ of Section 30, Township 25 North, Range 10 West after the well is drilled.

Section 30

Section 30

Section 30

Section 30

NAVAJO NO. 7-A30
SAN JUAN COUNTY
NEW MEXICO

12-POINT SURFACE USE PLAN

1. The proposed location is approximately 6 miles southwest of Huerfano Trading Post and N.M. Highway No. 44.
2. The access road to the location will be approximately 600' long and will branch off an existing unimproved road as shown on the attached map. Road construction will be kept to a minimum. The access road will consist of only blading away existing vegetation. Existing roads will be used wherever possible. In event the well is a commercial producer, the access road will be improved in whatever manner is customary in the area.
3. The location is 850' FNL & 850' FEL of Section 30, Township 25 North, Range 10 West, San Juan County, New Mexico, as shown on the attached map, with other wells within 1 mile.
4. Lateral roads to other locations are depicted on the attached map. No new roads will be constructed.
5. The flow line to the subject well will be laid to a tank battery located on the well location.
6. Water will be hauled to the location from Giegus Wash at the Carson Trading Post, located approximately 10 miles northwest of the wellsite.
7. Waste material and cuttings will be disposed of in the reserve pit and garbage will be disposed of in a small burn pit.
- 8 & 9. No camps or airstrips will be constructed.
10. A diagram of the drilling rig is attached.
11. The surface will be restored as nearly as possible to its original condition. Top soil will be stockpiled and later distributed evenly over the site. The site will be reseeded with a recommended seed mixture.
12. The topography is rolling sand hills sparsely covered with sagebrush and native grass. The location will require a cut of 4 to 6 feet on the east side and a fill of approximately 7 feet on the west side of the location. The subsoil that is cut from the location will be used as fill on the low areas of the location.

Union Oil Company of California
DLE/4-1-76



NAVAJO WELL NO. 7-A30
SAN JUAN COUNTY
NEW MEXICO

ADDITIONAL INFORMATION

1. Surface Casing: 8-5/8", 24#, K-55, New.
2. See attached well head schematic.
3. No intermediate casing will be run.
4. See attached schematic of BOP and manifold. BOP will be operationally tested daily and recorded.
5. Auxiliary equipment to consist of a kelly cock and a safety valve that can be stabbed into the string when the kelly is not in service.
6. Maximum anticipated bottom hole pressure is 2200 psi.
7. Drilling fluid will be water and native clay to approximately 5600', then fresh water with commercial bentonite, barite and chemical added to maintain a 9.2#/gallon mud weight to total depth.

Union Oil Company of California
DLE/4-1-76

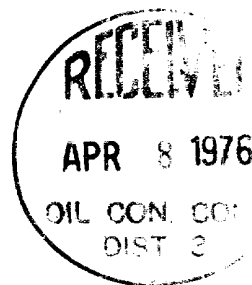

Navajo No 7-A30
DLE/4-1-76

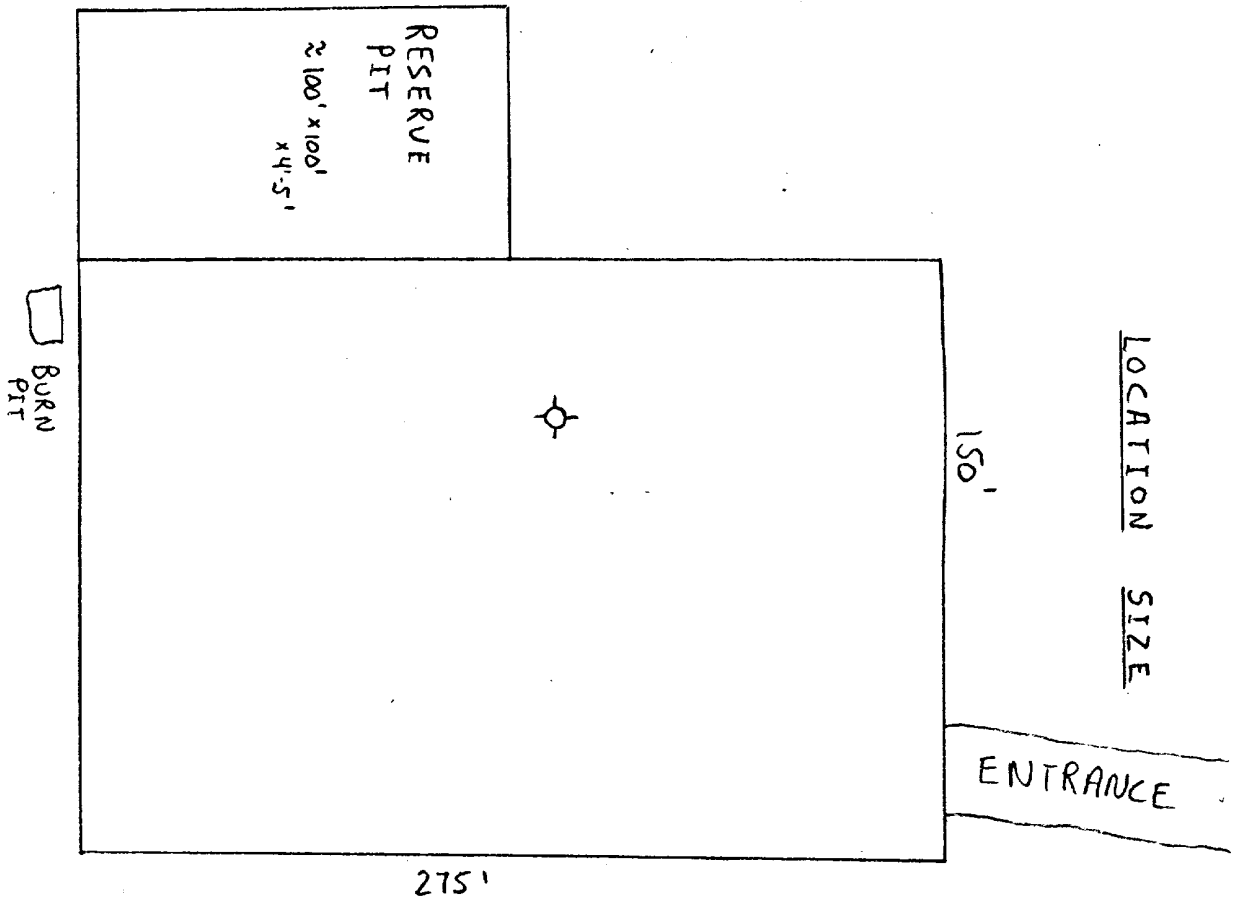

RECEIVED
APR 8 1976
OIL CON. COM.
DIST. 3

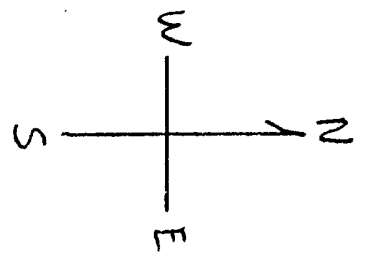

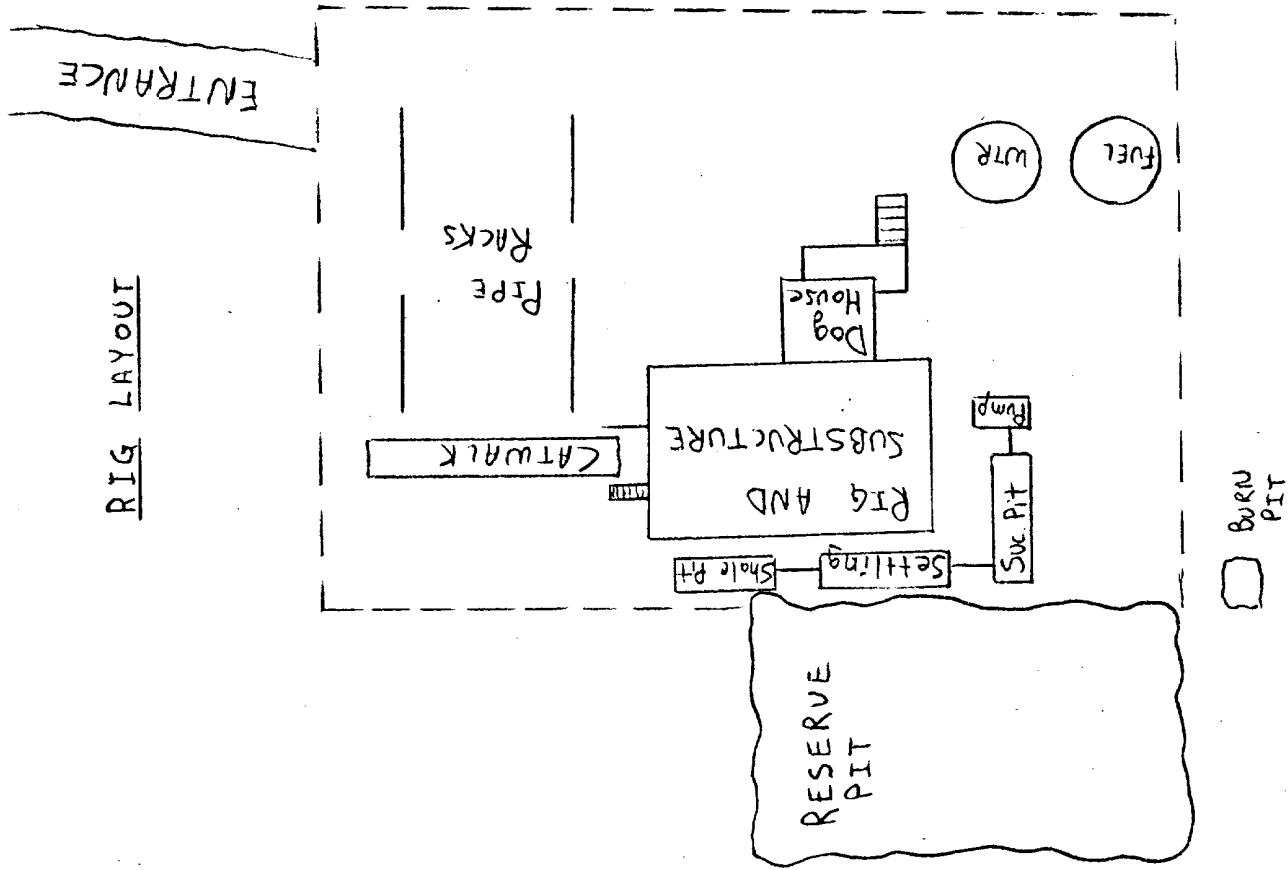
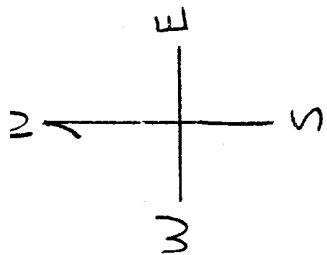

RECEIVED
APR 8 1976
OIL CON. CO.
DIST. 2

Navajo No 7-A30
DLE/4-1-76

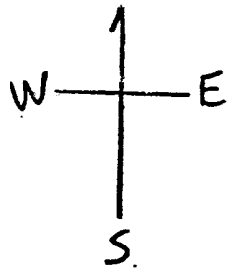

ROAD

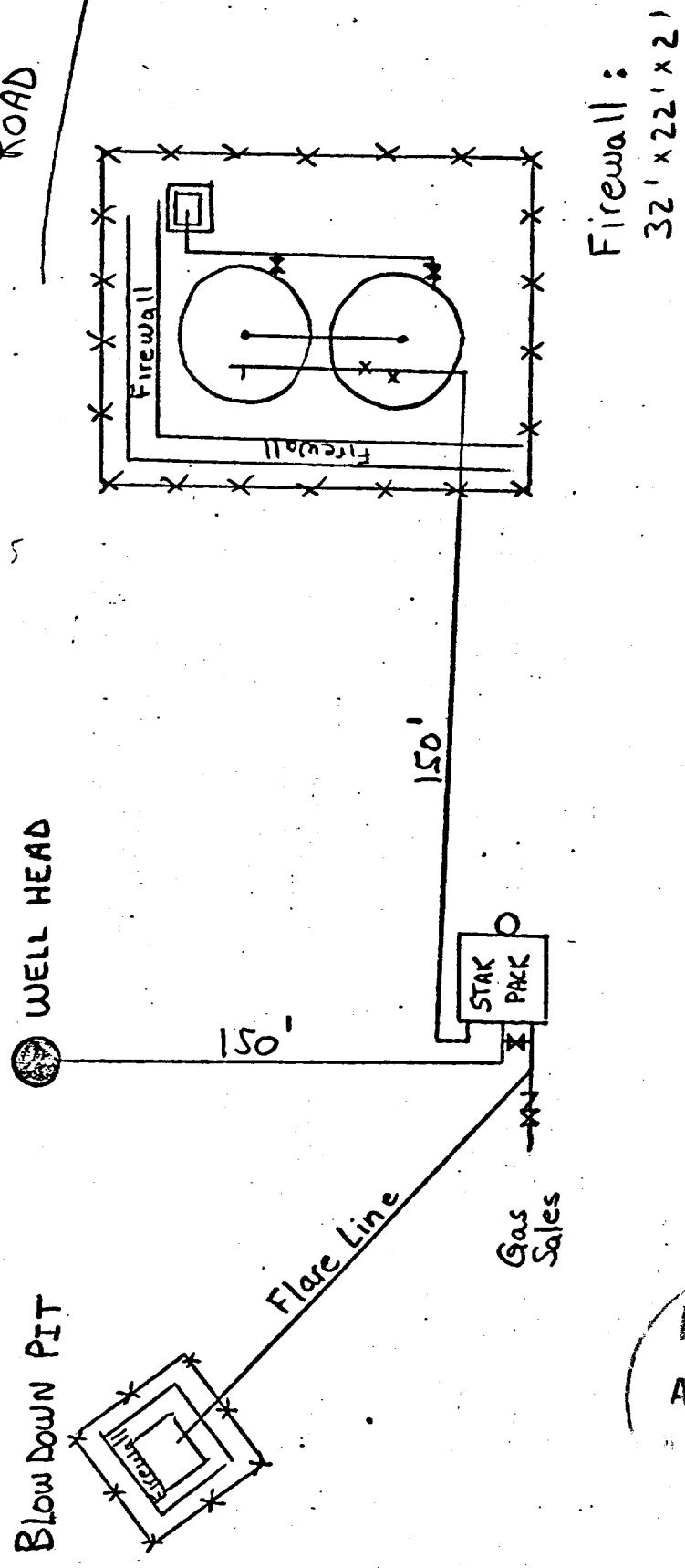

PRODUCTION FACILITIES

REF
APR 3 1976
COM. 10M.

Navajo No. 7-A30
DUE 14-5-76

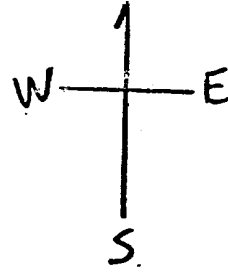

ROAD

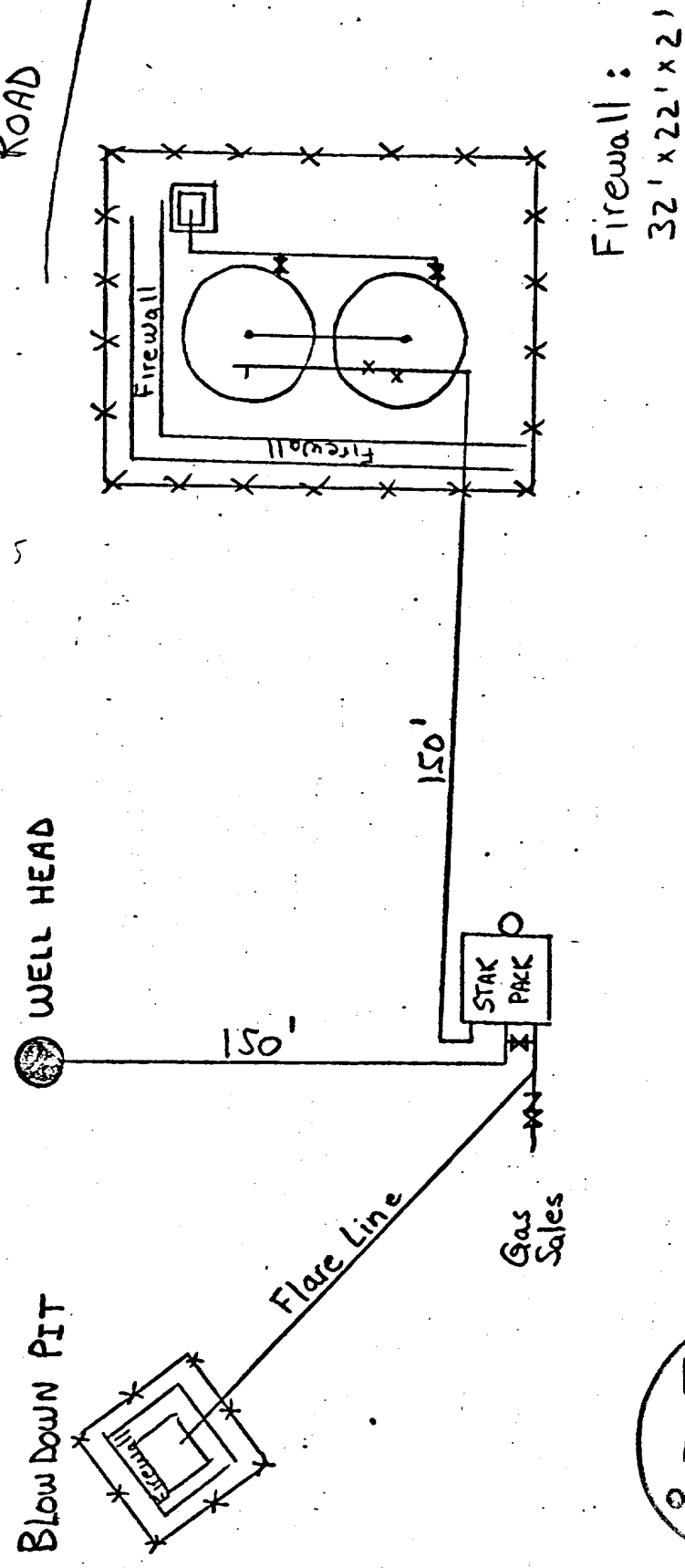

Firewall:
32' x 22' x 2'

PRODUCTION FACILITIES



Navajo No. 7-A30
DLE/4-5-76

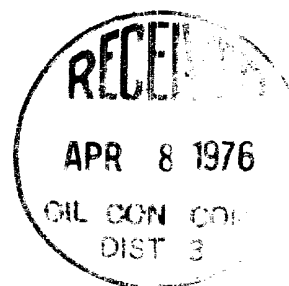
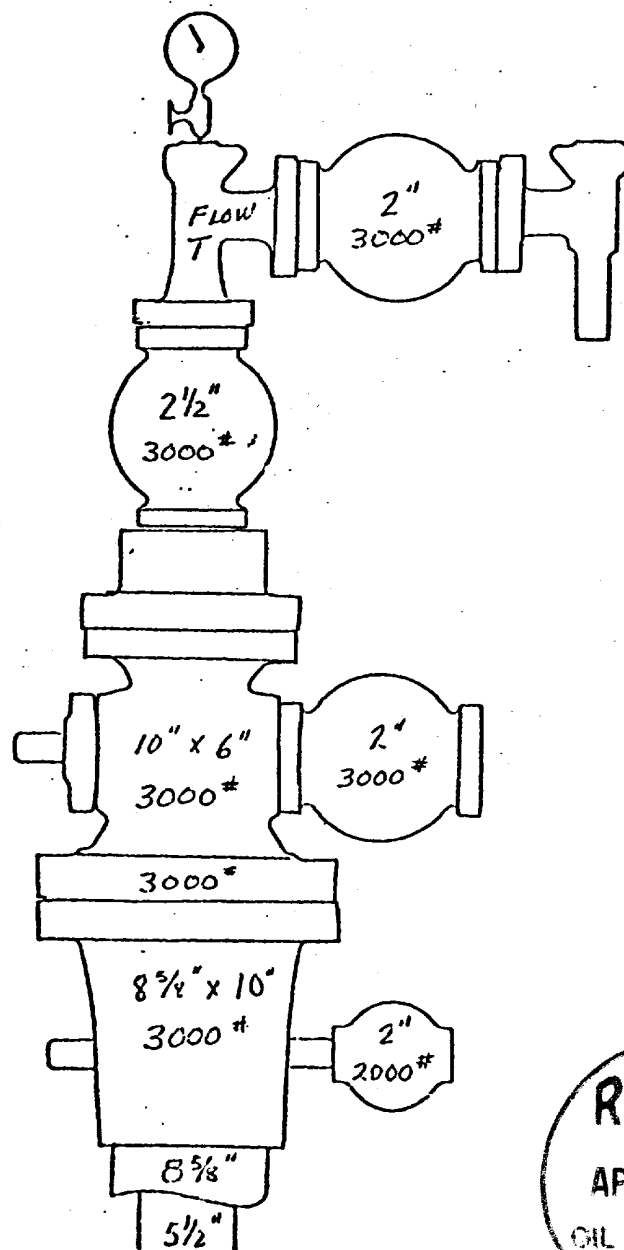

Union Oil Company of California
Navajo Well No. 7-A30

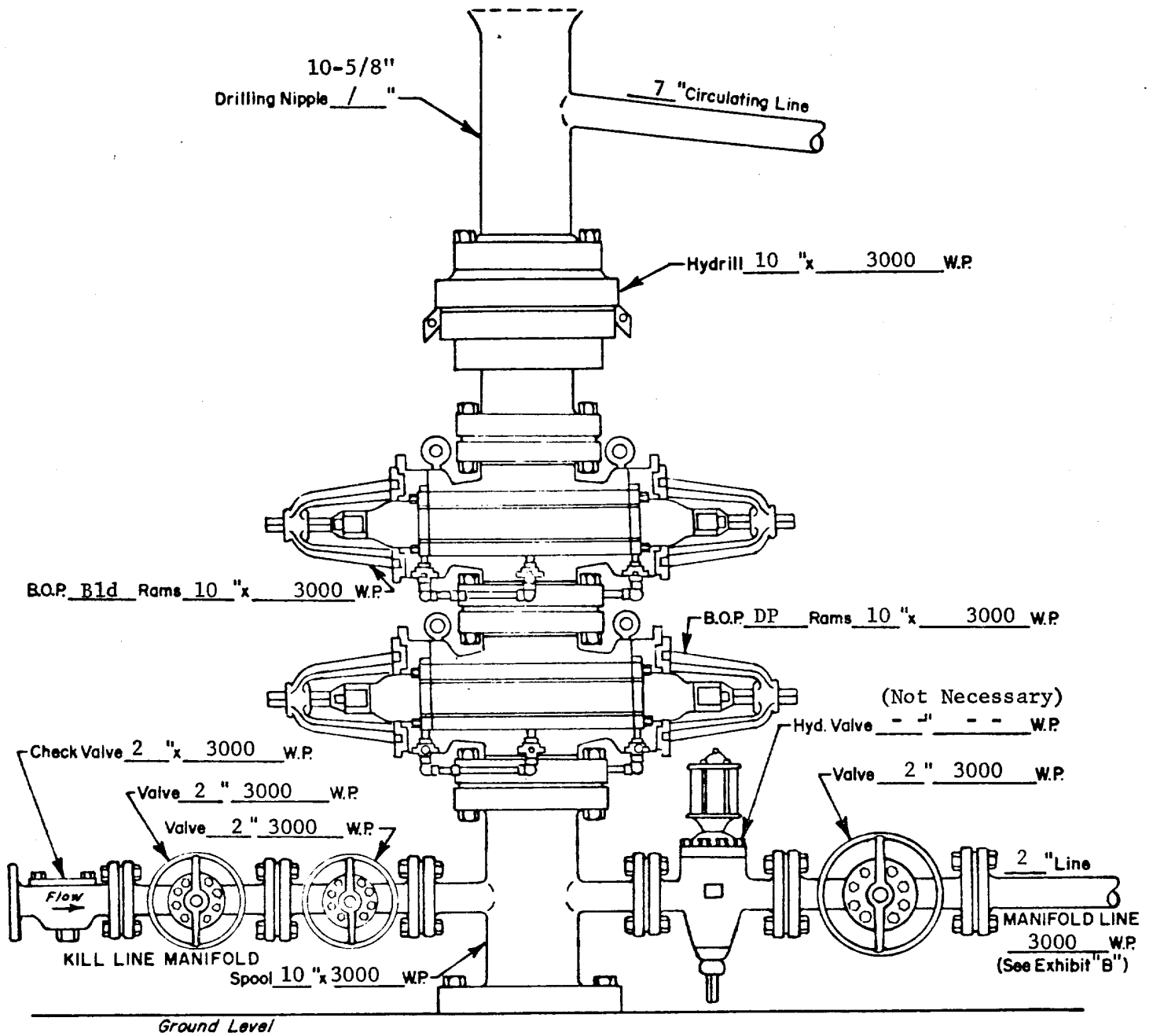

WELL HEAD B.O.P.
3000 # W.P.

☐ Manuel

☒ Hydraulic

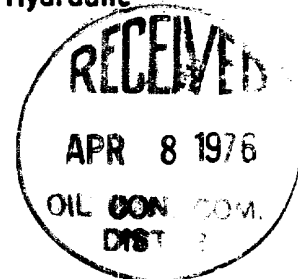

Union Oil Company of California
Navajo Well No. 7-A30

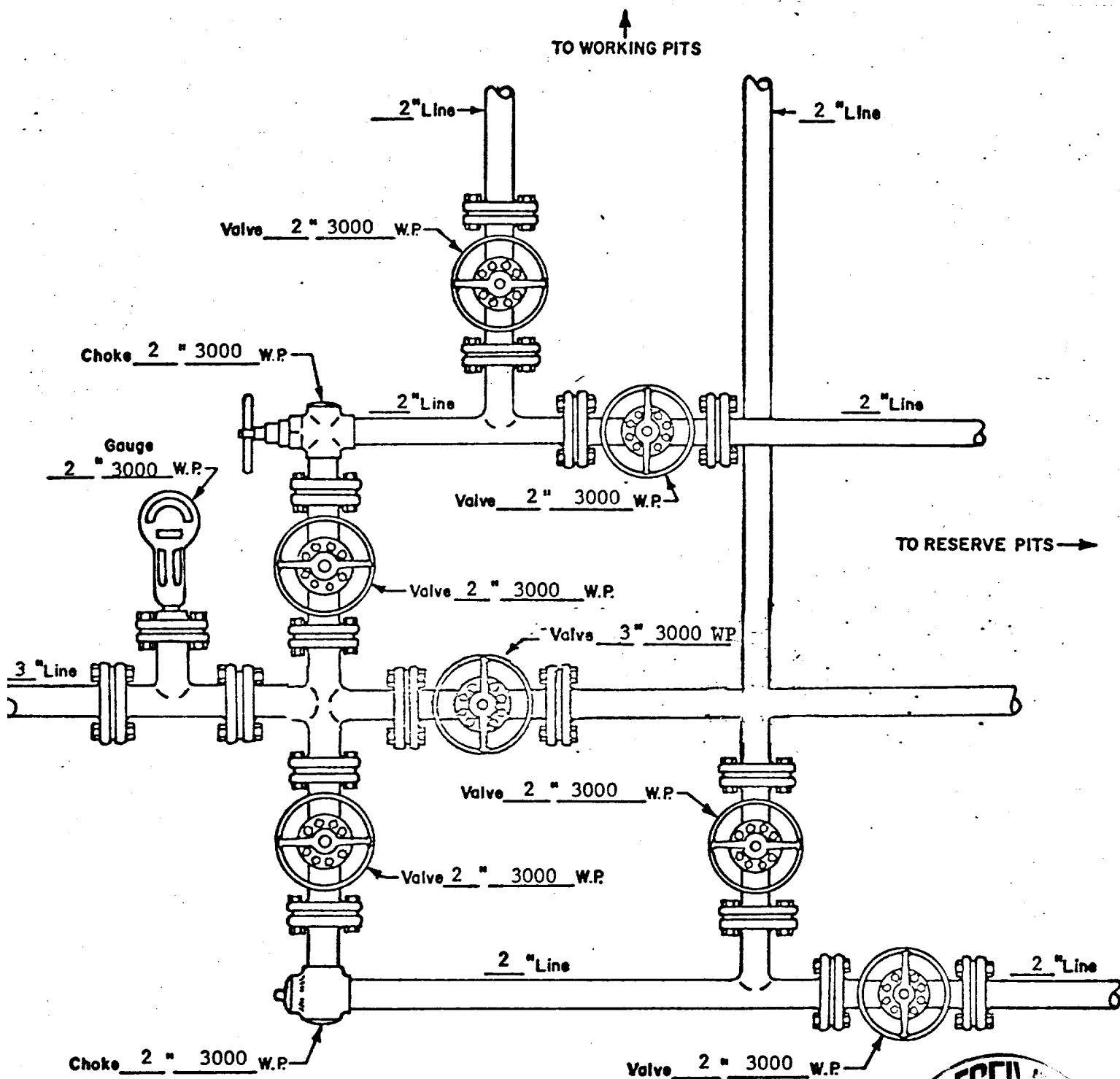

MANIFOLD
3000 #W.P.

☒ Manual
☐ Hydraulic



Union Oil Company of California
Navajo Well No. 7-A30

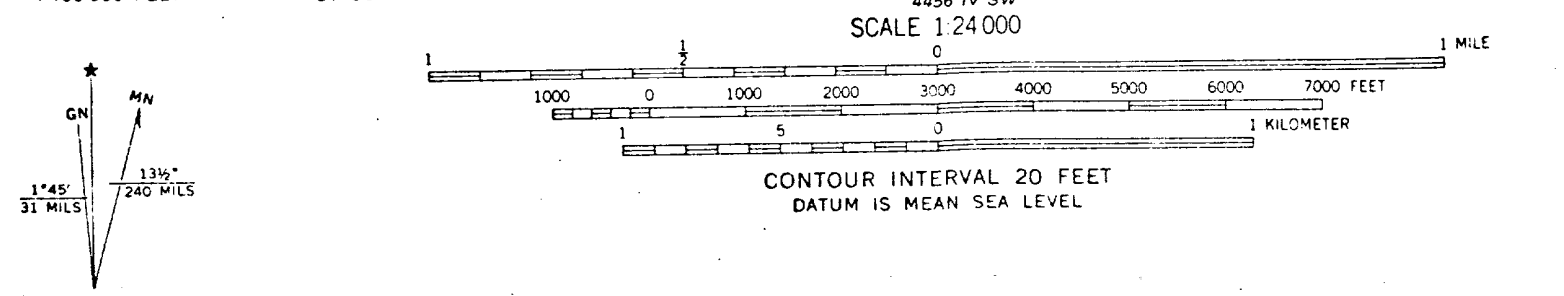
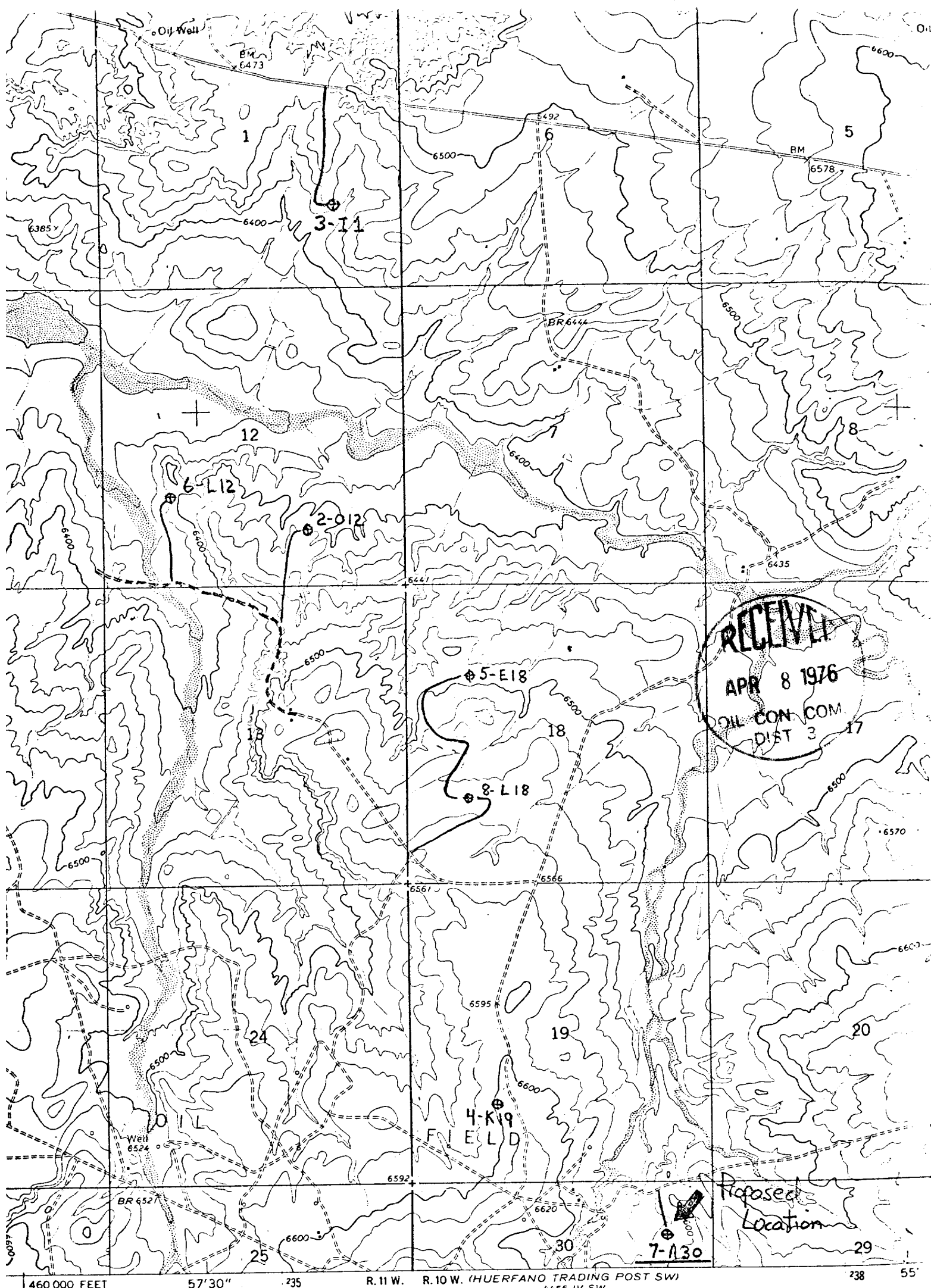

1963 AND 1966 MAGNETIC NORTH
LOCATION AT CENTER OF SHEET

THIS MAP COMPLIES WITH NATIONAL MAP ACCURACY STANDARDS
FOR SALE BY U. S. GEOLOGICAL SURVEY, DENVER, COLORADO 80225, OR WASHINGTON, D. C. 20242
A FOLDER DESCRIBING TOPOGRAPHIC MAPS AND SYMBOLS IS AVAILABLE ON REQUEST