

UNITED STATES  
DEPARTMENT OF THE INTERIOR  
GEOLOGICAL SURVEY

## APPLICATION FOR PERMIT TO DRILL, DEEPEN, OR PLUG BACK

## 1a. TYPE OF WORK

DRILL ☒DEEPEN ☐PLUG BACK ☐

## b. TYPE OF WELL

OIL  
WELL ☐GAS  
WELL ☒

OTHER

SINGLE  
ZONE ☐MULTIPLE  
ZONE ☐

## 2. NAME OF OPERATOR

Tenneco Oil Company

## 3. ADDRESS OF OPERATOR

1860 Lincoln St., Suite 1200, Denver, Colorado 80203

## 4. LOCATION OF WELL (Report location clearly and in accordance with any State regulations.)

At surface

790' FSL and 1100' FWL

At proposed prod. zone

## 14. DISTANCE IN MILES AND DIRECTION FROM NEAREST TOWN OR POST OFFICE

## 15. DISTANCE FROM PROPOSED\*

LOCATION TO NEAREST  
PROPERTY OR LEASE LINE, FT.  
(Also to nearest drg. unit line, if any)

## 18. DISTANCE FROM PROPOSED LOCATION\*

TO NEAREST WELL, DRILLING, COMPLETED,  
OR APPLIED FOR, ON THIS LEASE, FT.

## 16. NO. OF ACRES IN LEASE

320.00

## 19. PROPOSED DEPTH

+ 6125'

## 17. NO. OF ACRES ASSIGNED

TO THIS WELL  
S/320.00

## 20. ROTARY OR CABLE TOOLS

Rotary

## 21. ELEVATIONS (Show whether DF, RT, GR, etc.)

6443' GL

## 22. APPROX. DATE WORK WILL START\*

Upon Approval

## 23.

## PROPOSED CASING AND CEMENTING PROGRAM

SIZE OF HOLE	SIZE OF CASING	WEIGHT PER FOOT	SETTING DEPTH	QUANTITY OF CEMENT
12 1/4"	8 5/8"	24#/ft.	+ 300'	Suff. to circulate to surface Cement in two stages.
7 7/8"	4 1/2"	10.5#/ft.	+ 6125'	

Plan to drill well as follows:

1. Drill 12 1/4" hole to + 300'.
2. Set and cement 8 5/8" casing to + 300' & cement w/sufficient cement to circulate back to surface.
3. Install BOP and test both sets of rams to 1000 psi. for 15 min.
4. Drill 7 7/8" hole to T.D.
5. Set 4 1/2" csg. to T.D. Cement in two stages.
  - a. Cement across Gallup with enough to come out above Gallup.
  - b. Sufficient to cement back to surface casing.
6. This well to be completed through casing perforations and stimulated as necessary to establish commercial production.
7. Clean up area.

*Not dedicated*

IN ABOVE SPACE DESCRIBE PROPOSED PROGRAM: If proposal is to deepen or plug back, give data on present productive zone and proposed new productive zone. If proposal is to drill or deepen directionally, give pertinent data on subsurface locations and measured and true vertical depths. Give flow test program, if any.

SIGNED D. D. MyersTITLE Div. Production ManagerDATE 4-27-76

(This space for Federal or State office use)

PERMIT NO. \_\_\_\_\_

APPROVAL DATE \_\_\_\_\_

APPROVED BY \_\_\_\_\_  
CONDITIONS OF APPROVAL, IF ANY:

TITLE \_\_\_\_\_

RECEIVED

DATE APR 30 1976

U. S. GEOLOGICAL SURVEY  
WASHINGTON, D. C.

\*See Instructions On Reverse Side

# NEW MEXICO OIL CONSERVATION COMMISSION

## WELL LOCATION AND ACERAGE DEDICATION PLAT

All distances must be from the outer boundaries of the Section

Operator <b>TENNECO OIL COMPANY</b>			Lease <b>CANYON</b>		Well No. <b>20</b>
Unit Letter <b>R M</b>	Section <b>13</b>	Township <b>25 NORTH</b>	Range <b>11 WEST</b>	County <b>SAN JUAN</b>	
Actual Footage Location of Well: <b>790'</b> feet from the <b>SOUTH</b> line and <b>1100'</b> feet from the <b>WEST</b> line					
Ground Level Elev. <b>6443</b>	Producing Formation <b>Basin Dakota</b>	Pool <b>Basin Dakota</b>	Dedicated Acreage: <b>320.00</b>		<b>S/2</b> Acres

1. Outline the acreage dedicated to the subject well by colored pencil or hatchure marks on the plat below.
2. If more than one lease is dedicated to the well, outline each and identify the ownership thereof (both as to working interest and royalty),
3. If more than one lease of different ownership is dedicated to the well, have the interests of all owners been consolidated by communitization, unitization, force-pooling, etc?

( ☒ ) Yes ( ) No If answer is "yes," type of consolidation Communitization in progress

If answer is "no," list the owners and tract descriptions which have actually consolidated. (Use reverse side of this form if necessary.)

No allowable will be assigned to the well until all interests have been consolidated (by communitization, unitization, forced-pooling, or otherwise) or until a non standard unit, eliminating such interests, has been approved by the Commission.

### CERTIFICATION

I hereby certify that the information contained herein is true and complete to the best of my knowledge and belief.

Name John P. Leese  
 Position Production Clerk  
 Company Tenneco Oil Company  
 Date 4/27/76

I hereby certify that the well location shown on this plat was plotted from field notes or actual surveys made by me or under my supervision, and that the same is true and correct to the best of my knowledge and belief.

12 March 1976  
 Date Surveyed  
James P. Leese  
 Registered Professional Engineer  
 and/or Land Surveyor

**James P. Leese**

1463  
 Certificate No.

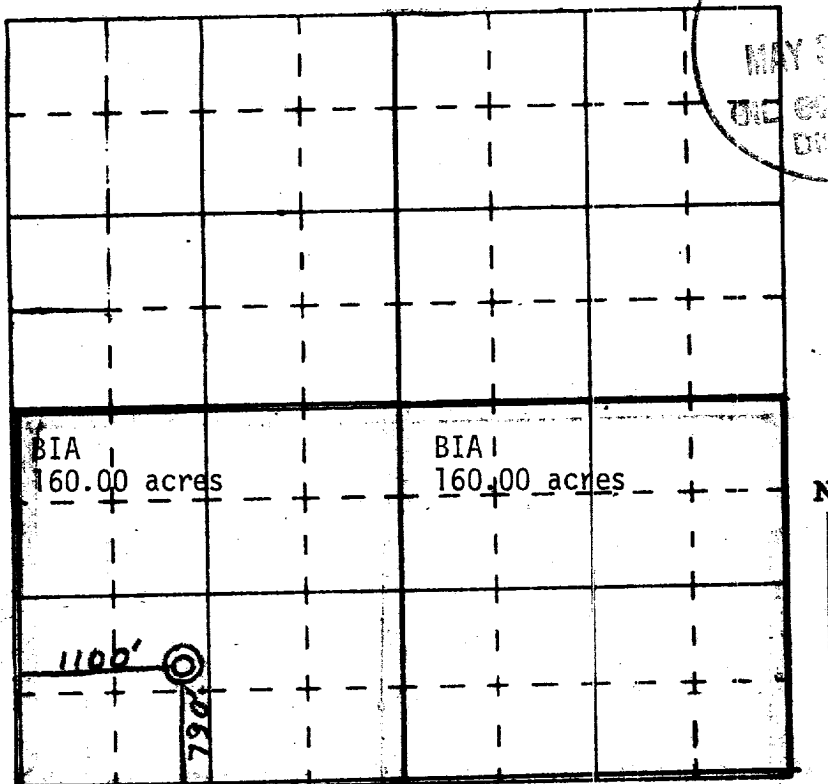

N00-C-14-20-3615

N00-C-14-20-3614