

UNITED STATES  
DEPARTMENT OF THE INTERIOR  
GEOLOGICAL SURVEY

30-075-22295

APPLICATION FOR PERMIT TO DRILL, DEEPEN, OR PLUG BACK

1a. TYPE OF WORK  
DRILL ☒ DEEPEN ☐ PLUG BACK ☐

b. TYPE OF WELL  
OIL WELL ☐ GAS WELL ☒ OTHER ☐ SINGLE ZONE ☒ MULTIPLE ZONE ☐

2. NAME OF OPERATOR  
Union Oil Company of California

3. ADDRESS OF OPERATOR  
P. O. Box 2620 - Casper, WY 82602

4. LOCATION OF WELL (Report location clearly and in accordance with any State requirements.\*)  
At surface 1100' FSL & 1185' FWL  
At proposed prod. zone Jicarilla & Graneros

14. DISTANCE IN MILES AND DIRECTION FROM NEAREST TOWN OR POST OFFICE\*  
31 miles south of Bloomfield, New Mexico

15. DISTANCE FROM PROPOSED\*  
LOCATION TO NEAREST  
PROPERTY OR LEASE LINE, FT.  
(Also to nearest drlg. unit line, if any) 1100'

16. NO. OF ACRES IN LEASE  
320

17. NO. OF ACRES ASSIGNED  
TO THIS WELL 320

18. DISTANCE FROM PROPOSED LOCATION\*  
TO NEAREST WELL, DRILLING, COMPLETED,  
OR APPLIED FOR, ON THIS LEASE, FT. None

19. PROPOSED DEPTH  
6200'

20. ROTARY OR CABLE TOOLS  
Rotary

21. ELEVATIONS (Show whether DF, RT, GR, etc.)  
6493' G.L.

22. APPROX. DATE WORK WILL START\*  
Immediately

23. PROPOSED CASING AND CEMENTING PROGRAM

SIZE OF HOLE	SIZE OF CASING	WEIGHT PER FOOT	SETTING DEPTH	QUANTITY OF CEMENT
12-1/4"	8-5/8"	24#	700'	300 Sx.
7-7/8"	5-1/2"	15.5#	6200'	To be calculated from Caliper

PROPOSED PROGRAM:

Drill 12-1/4" hole to 700'. Run and cement 8-5/8" casing. Drill 7-7/8" hole to 6200'. Log, and if production is indicated, run and cement 5-1/2" casing. The well will be completed with 2-3/8" tubing.

The B.O.P. will be given a daily operational test and each test logged.

NOTE: Subject acreage is not dedicated to a gas purchaser.

IN ABOVE SPACE DESCRIBE PROPOSED PROGRAM: If proposal is to deepen or plug back, give data on present productive zone and proposed new productive zone. If proposal is to drill or deepen directionally, give pertinent data on subsurface locations and measured and true vertical depths. Give blowout preventer program, if any.

24. Title District Drilling Supt. Signed *Ralph A. LeMay* DATE 12-17-76

(This space for Federal or State office use)

PERMIT NO. APPROVAL DATE

APPROVED BY TITLE DATE

CONDITIONS OF APPROVAL, IF ANY:

*Olaf*

\*See Instructions On Reverse Side

**NEW MEXICO OIL CONSERVATION COMMISSION  
WELL LOCATION AND ACREAGE DEDICATION PLAT**

Form C-102  
Supersedes C-128  
Effective 1-1-65

All distances must be from the outer boundaries of the Section.

Operator <b>Union Oil Company of California</b>			Lease <b>Federal</b>		Well No. <b>1 M 17</b>
Unit Letter <b>M</b>	Section <b>17</b>	Township <b>25 North</b>	Range <b>10 West</b>	County <b>San Juan</b>	
Actual Footage Location of Well: <b>1100</b> feet from the <b>South</b> line and <b>1185</b> feet from the <b>West</b> line					
Ground Level Elev. <b>6493</b>	Producing Formation <b>Jicarilla &amp; Graneros</b>		Pool <b>Basin Dakota</b> ✓	Dedicated Acreage: <b>320</b> Acres	

1. Outline the acreage dedicated to the subject well by colored pencil or hatchure marks on the plat below.
2. If more than one lease is dedicated to the well, outline each and identify the ownership thereof (both as to working interest and royalty).
3. If more than one lease of different ownership is dedicated to the well, have the interests of all owners been consolidated by communitization, unitization, force-pooling, etc?

☐ Yes   ☐ No   If answer is "yes," type of consolidation \_\_\_\_\_ (SEE REVERSE SIDE)

If answer is "no," list the owners and tract descriptions which have actually been consolidated. (Use reverse side of this form if necessary.) \_\_\_\_\_

No allowable will be assigned to the well until all interests have been consolidated (by communitization, unitization, forced-pooling, or otherwise) or until a non-standard unit, eliminating such interests, has been approved by the Commission.

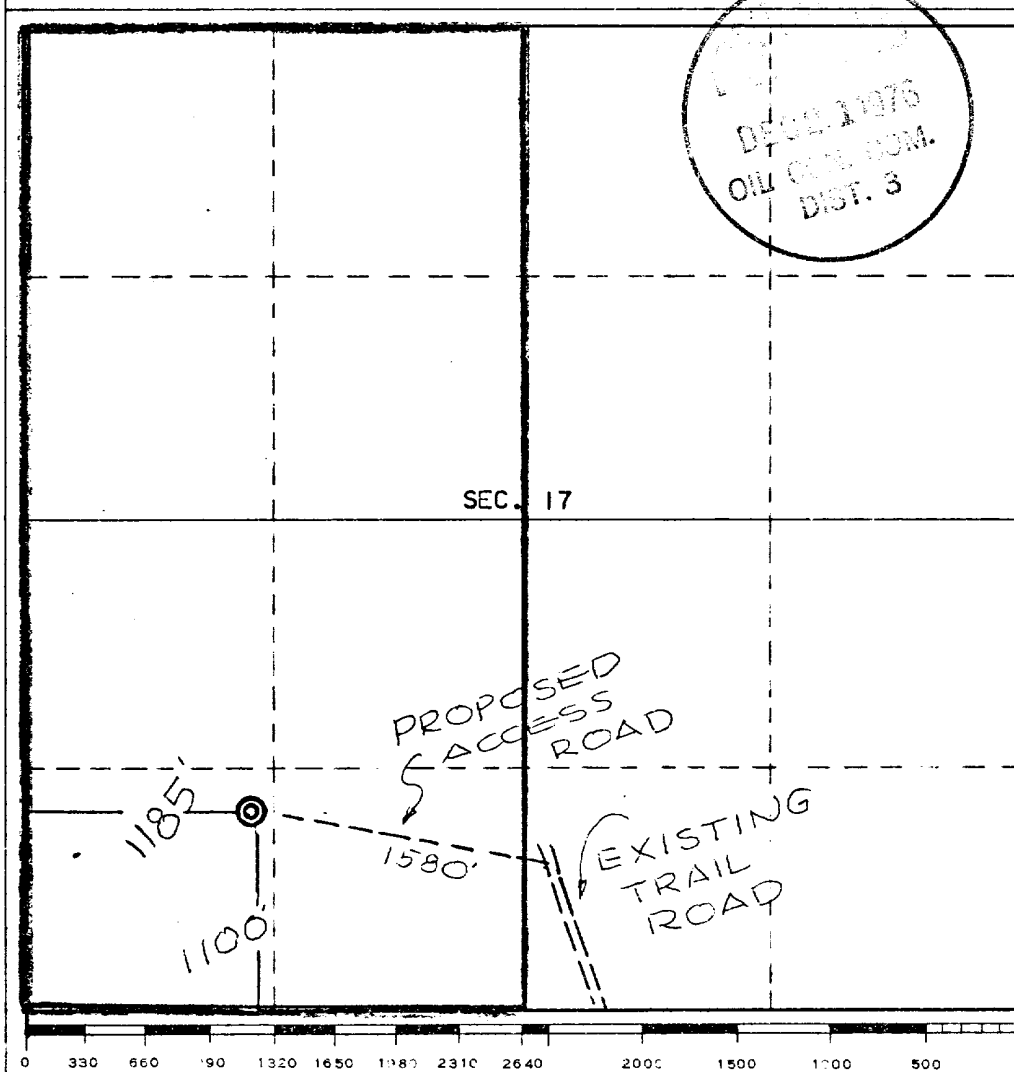

**CERTIFICATION**

I hereby certify that the information contained herein is true and complete to the best of my knowledge and belief.

Name Ralph A. Ladd  
Position District Drilling Supt.  
Company Union Oil Co. of California  
Date December 17, 1976

I hereby certify that the location shown on this plat was plotted from field notes of a Professional Engineer made by me or under my supervision, and that the same are true and correct to the best of my knowledge and belief.

Date Surveyed December 3, 1976  
Registered Professional Engineer and/or Land Survey E. V. Echolaw  
Certificate No. 3602  
E. V. Echolaw LS

Union owns 100% of the working interest under the NW/4 of subject Section 17 and plans to communitize the NW/4 with the SW/4 of said Section 17 to comply with the spacing pattern established in the field.

FEDERAL NO. 1-M17  
SAN JUAN COUNTY  
NEW MEXICO

12-POINT SURFACE USE PLAN

1. The proposed location is approximately 5.6 miles southwest of Huerfano Trading Post and N.M. Highway No. 44, and 30.6 miles southwest of Bloomfield, New Mexico.
2. The access road to the location will be approximately 1580' long and will branch off of an existing unimproved road as shown on the attached map. Road construction will be kept to a minimum. The access road will be made by merely blading away existing vegetation. Existing roads will be used wherever possible. In the event that the well is a commercial producer, the access road will be improved in the manner customary to the area. Water bars will be built on the new road and added to the old road as needed.
3. The location is 1100' FSL and 1185' FWL of Section 17, Township 25 North, Range 10 West, San Juan County, New Mexico, as shown on the attached map. No other wells may be found within one mile.
4. Lateral roads to other locations are depicted on the attached map. No new roads will be constructed.
5. The flow line to the subject well will be laid to a tank battery on the location.
6. Water will be hauled to the location from Giegus Wash at the Carson Trading Post, which is approximately 11 miles northwest of the wellsite.
7. Waste materials and cuttings will be disposed of in the reserve pit and garbage will be disposed of in a small burn pit.
- 8 & 9. No camps or airstrips will be constructed.
10. A diagram of the drilling rig is attached.
11. The surface will be restored as nearly as possible to its original condition. The top soil will be stockpiled to be evenly redistributed over the site when drilling operations are finished. The site will then be reseeded with a recommended seed mixture.
12. The topography consists of rolling sand hills sparsely covered with sagebrush and native grasses. The location will require a cut of 3 feet on the south side. The subsoil which is cut from the location will be used as fill for the low areas.

FEDERAL NO. 1-M17  
SAN JUAN COUNTY  
NEW MEXICO

ADDITIONAL INFORMATION

1. Surface casing will be 700' of 8-5/8", 24#, K-55, new casing, cemented with 300 sacks regular cement with 2% CaCl<sub>2</sub> and 1/4# Flocele/sack.
2. See attached well head schematic.
3. No intermediate casing or liner will be run.
4. Production casing will be 6200' of 5-1/2", 15.5#, K-55, new casing, cemented with regular cement with 2% CaCl<sub>2</sub> (quantity to be calculated from Caliper).
5. See attached schematic of BOP and manifold. BOP will be operationally tested and the results will be recorded.
6. Auxiliary equipment will consist of a kelly cock and a safety valve which can be stabbed into the string when the kelly is not in service.
7. Maximum anticipated bottom hole pressure is 2500 psi.
8. The drilling fluid will be a water and native clay mud to approximately 5600'. Then a fresh H<sub>2</sub>O mud with chemical additives will be used to total depth, weighted to 9.2#/gal. with commercial bentonite and barite.
9. The well will be drilled with rotary tools and spudded immediately upon approval or as soon as a rig is available. The drilling and completion will require approximately 10 days.
10. The surface formation at this location is the Nacimiento.

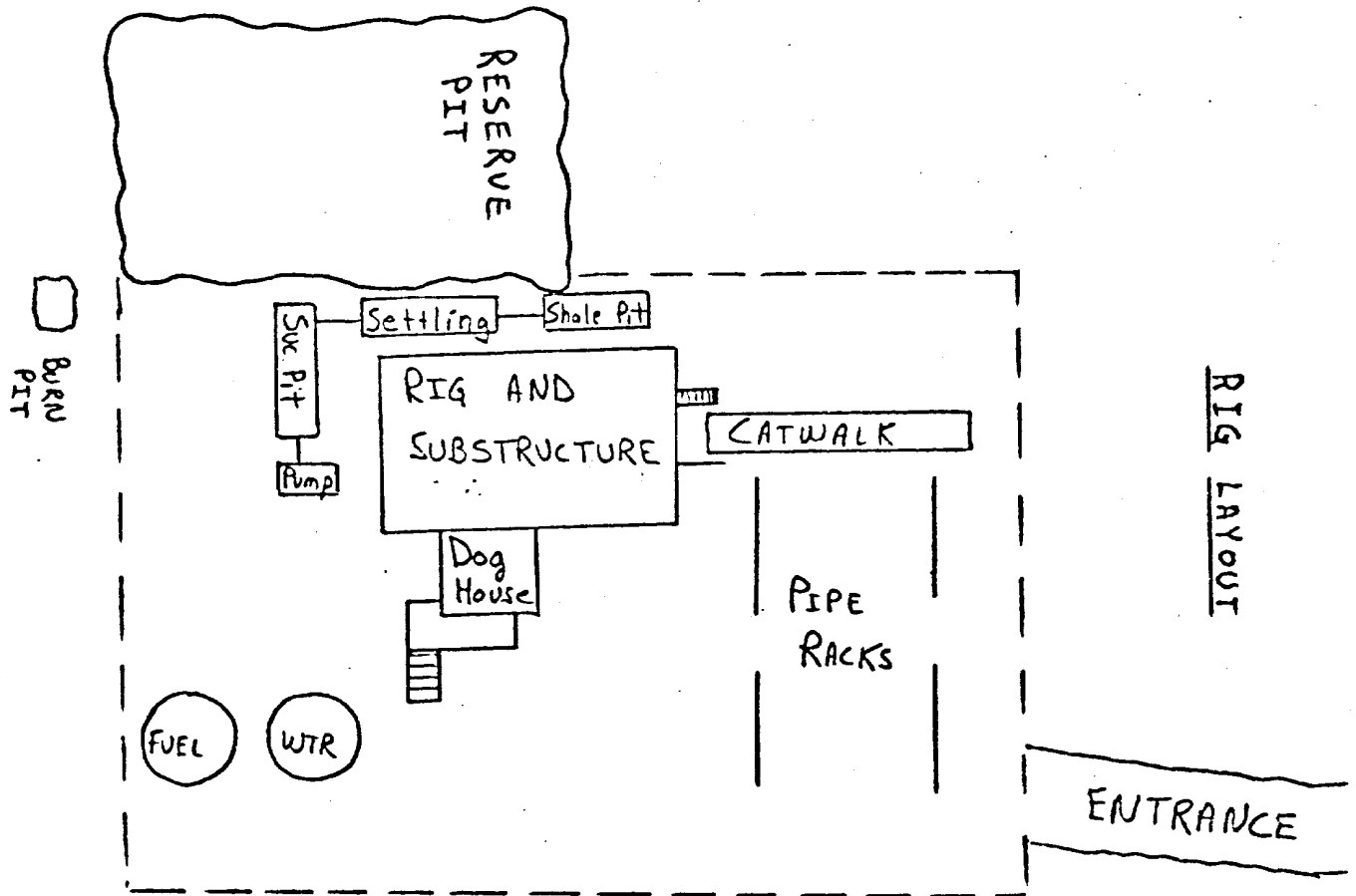
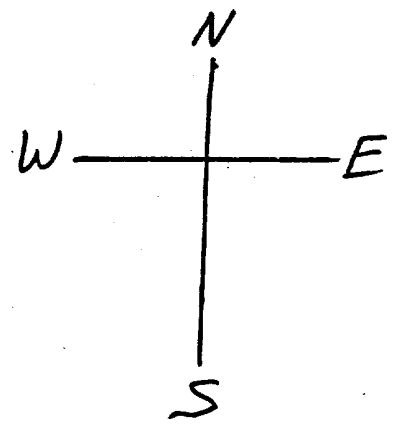

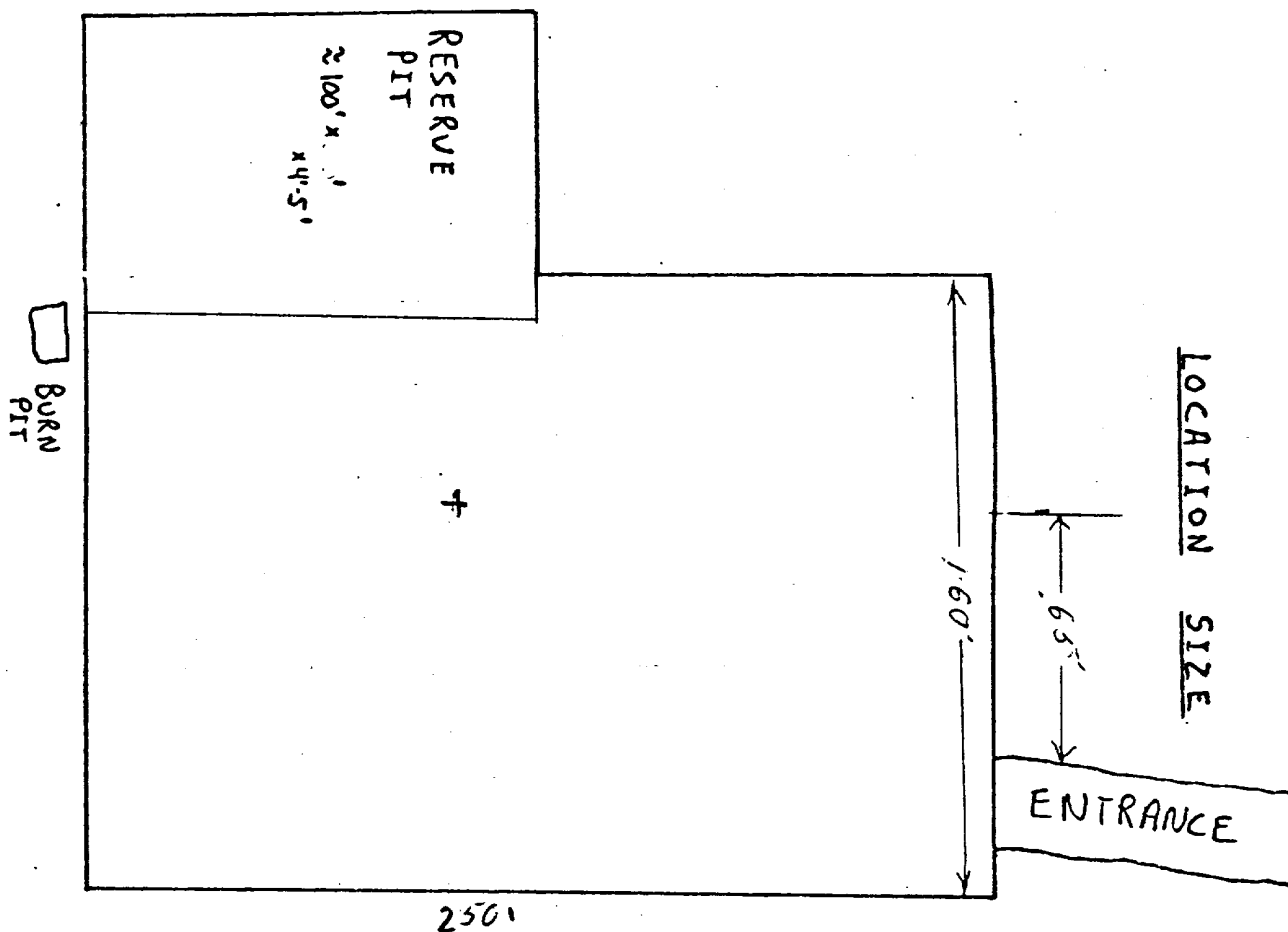
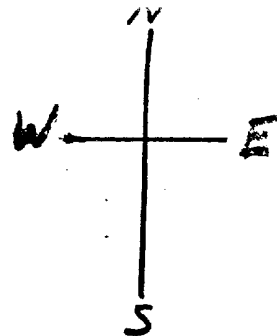

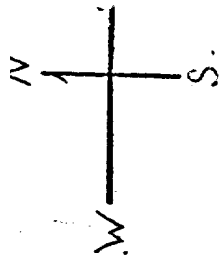

ROAD

WELL HEAD

150'

150'

STAK  
PACK

Gas  
Sales

Flare Line

Blow Down PIT

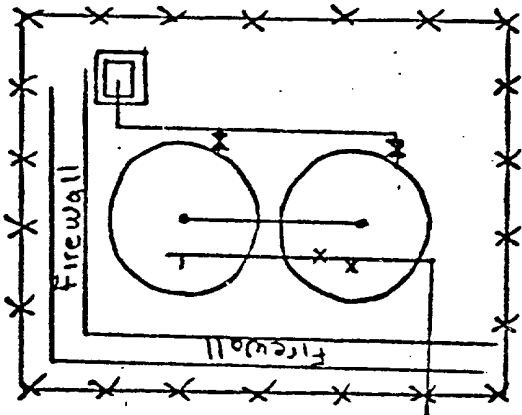
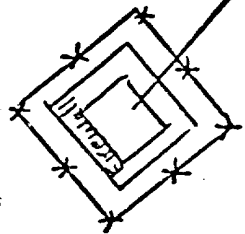

Firewall:  
32' x 22' x 2'

# PRODUCTION FACILITIES



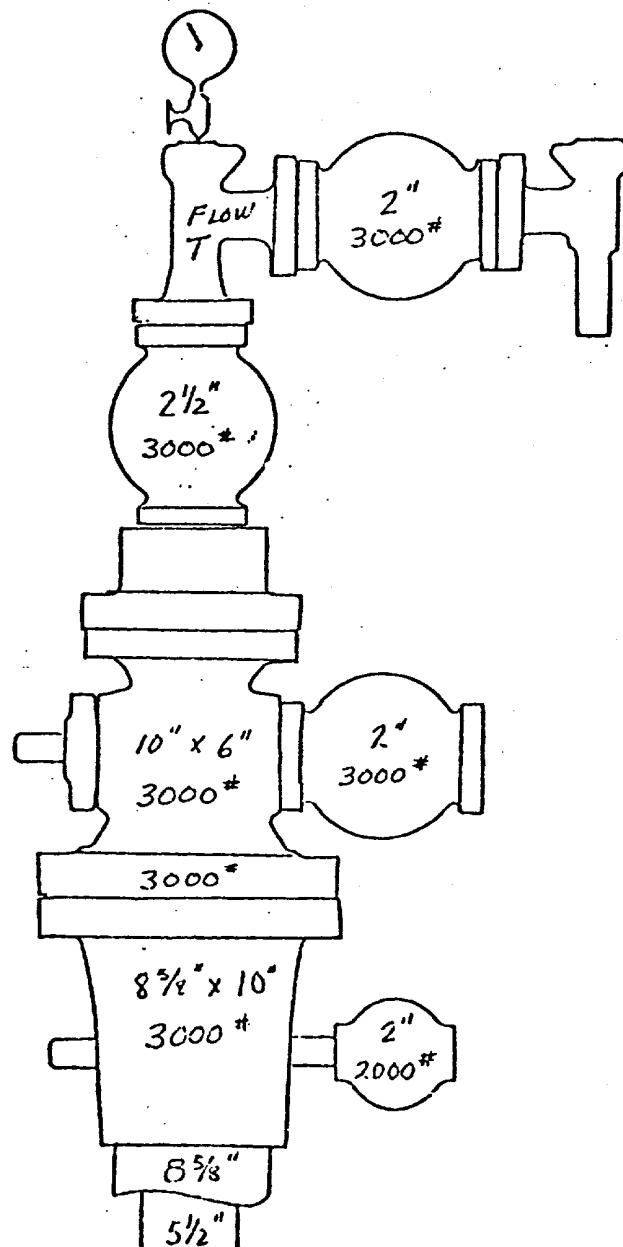

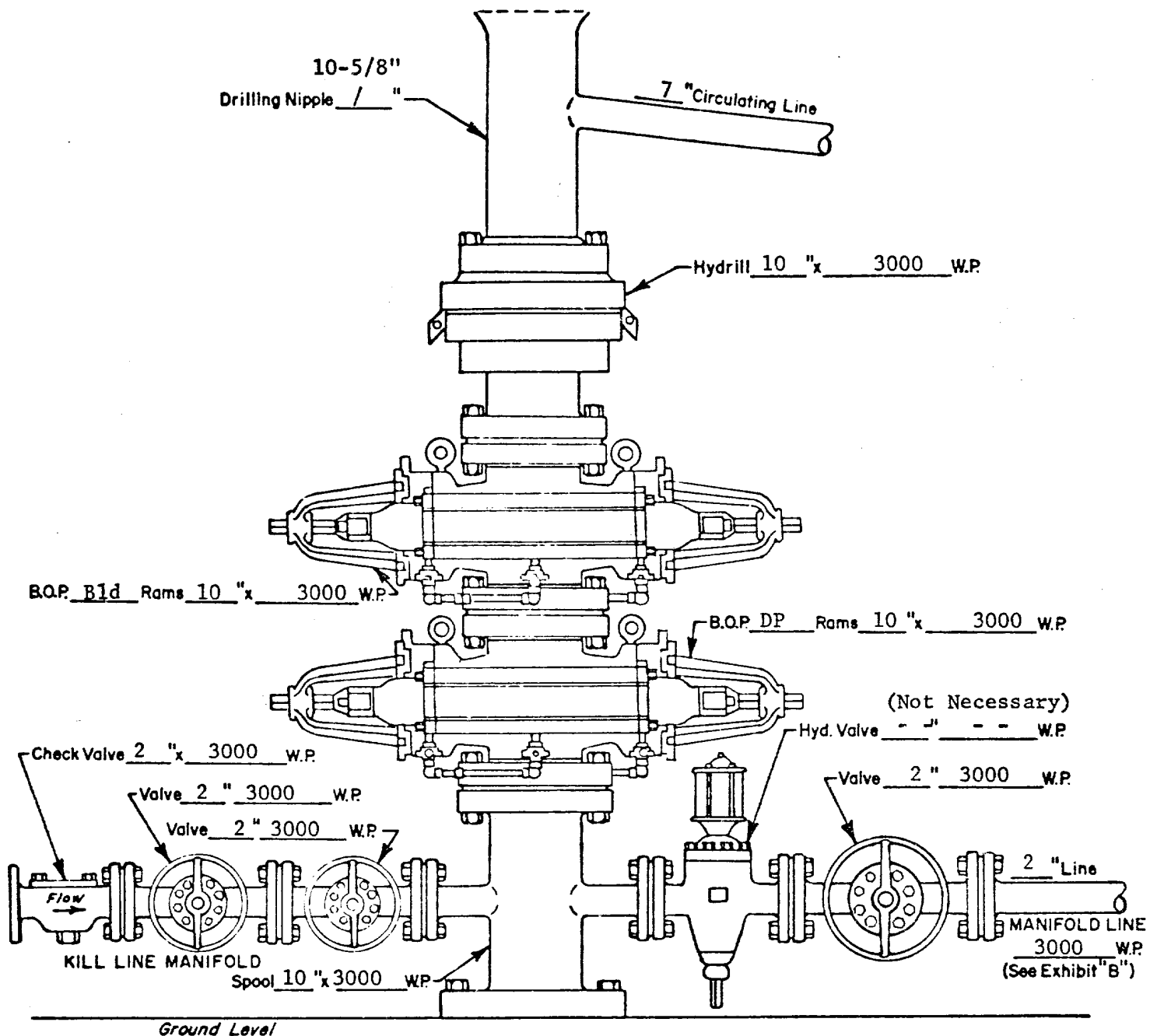

WELL HEAD B.O.P.  
3000 # W.P.

☐ Manuel  
☒ Hydraulic

TO WORKING PITS

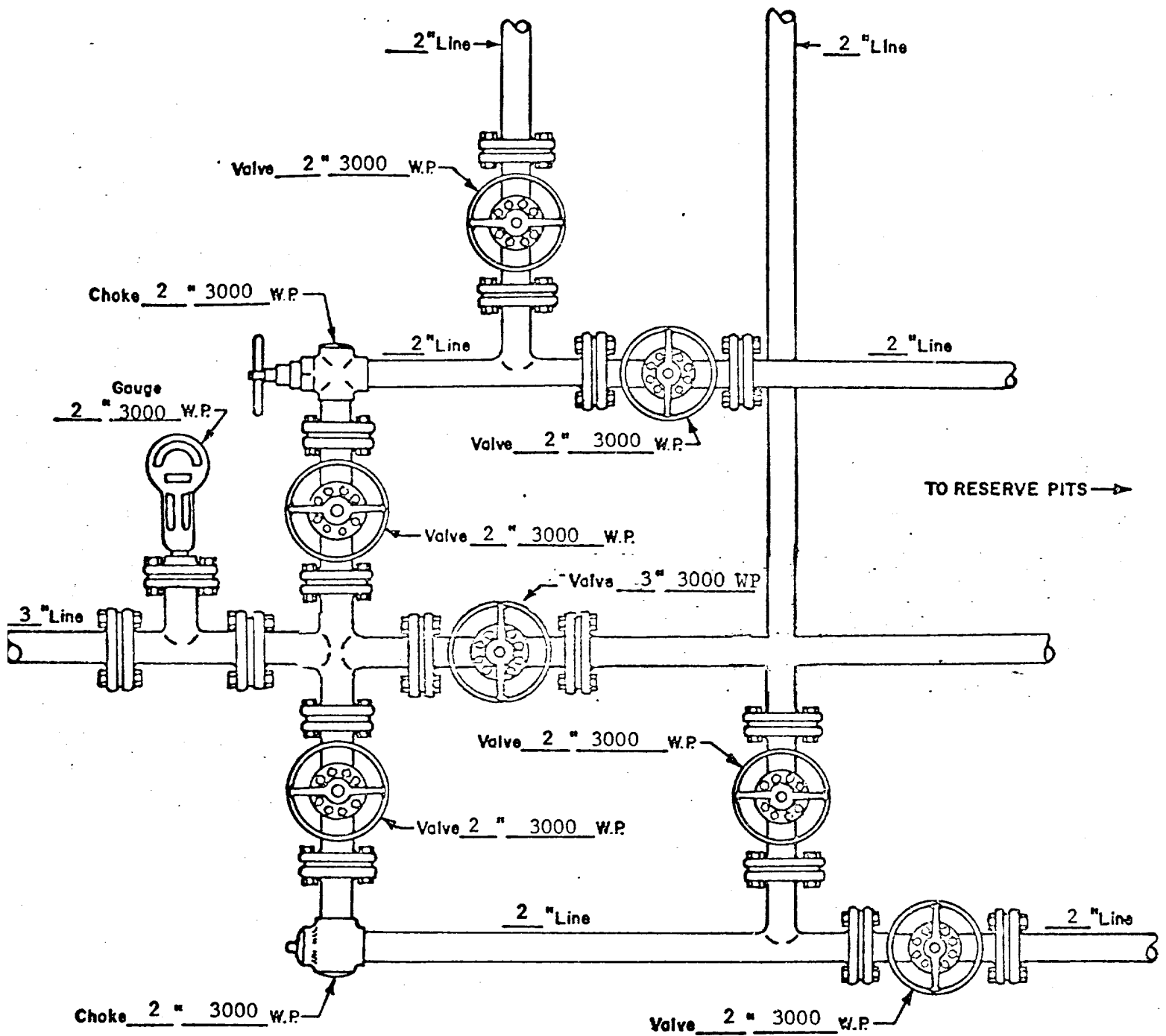

MANIFOLD  
3000 # W.P.

☒ Manual  
☐ Hydraulic

