

UNITED STATES
DEPARTMENT OF THE INTERIOR
GEOLOGICAL SURVEY

(Other instructions on
reverse side)

30-045-22496

APPLICATION FOR PERMIT TO DRILL, DEEPEN, OR PLUG BACK

1a. TYPE OF WORK

DRILL ☒

DEEPEN ☐

PLUG BACK ☐

b. TYPE OF WELL

OIL
WELL ☐

GAS
WELL ☒

OTHER

SINGLE
ZONE ☒

MULTIPLE
ZONE ☐

2. NAME OF OPERATOR

Snell Oil Company

3. ADDRESS OF OPERATOR

1700 Broadway, Denver, Colorado 80290

4. LOCATION OF WELL (Report location clearly and in accordance with any State requirements.)*

At surface

1500' FNL & 800' FWL Section 13

At proposed prod. zone

14. DISTANCE IN MILES AND DIRECTION FROM NEAREST TOWN OR POST OFFICE*

10. DISTANCE FROM PROPOSED*

LOCATION TO NEAREST
PROPERTY OR LEASE LINE, FT.
(Also to nearest drlg. unit line, if any)

800'

16. NO. OF ACRES IN LEASE

Unit

18. DISTANCE FROM PROPOSED LOCATION*

TO NEAREST WELL, DRILLING COMPLETED,
OR APPLIED FOR, ON THIS LEASE, FT.

Unit 12-13

500'+

19. PROPOSED DEPTH

1270'

17. NO. OF ACRES ASSIGNED
TO THIS WELL

160

20. ROTARY OR CABLE TOOLS

Rotary

21. ELEVATIONS (Show whether DF, RT, GR, etc.)

6374' GR

22. APPROX. DATE WORK WILL START*

February 15, 1977

23.

PROPOSED CASING AND CEMENTING PROGRAM

Complete March 15, 1977

SIZE OF HOLE	SIZE OF CASING	WEIGHT PER FOOT	SETTING DEPTH	QUANTITY OF CEMENT
12-1/4"	8-5/8"	24#	280'+	To surface
7-7/8"	4-1/2"	11.6#	1270'	To surface

Attachments:

Ten Point Drilling Plan Check List

1. Drilling Prognosis
2. Casing Program
3. BOPE Drawing
4. Choke Manifold

Multipoint Land Use Plan

1. Survey Plat
2. Road & Facilities Map
3. Location & Rig Layout



IN ABOVE SPACE DESCRIBE PROPOSED PROGRAM: If proposal is to deepen or plug back, give data on present productive zone and proposed new productive zone. If proposal is to drill or deepen directionally, give pertinent data on subsurface locations and measured and true vertical depths. Give blowout preventer program, if any.

24.

SIGNED

TITLE Div. Ops. Engr.

DATE 1/4/77

(This space for Federal or State office use)

PERMIT NO.

APPROVAL DATE

APPROVED BY

TITLE

DATE

CONDITIONS OF APPROVAL, IF ANY:

Okal

*See Instructions On Reverse Side

NEW MEXICO OIL CONSERVATION COMMISSION

WELL LOCATION AND ACERAGE DEDICATION PLAT

All distances must be from the outer boundaries of the Section

Operator SHELL OIL COMPANY			Lease CARSON UNIT		Well No. 201
Unit Letter E	Section 13	Township 25 NORTH	Range 12 WEST	County SAN JUAN	
Actual Footage Location of Well: 1500 feet from the NORTH line and 800 feet from the WEST line					
Ground Level Elev. 6374	Producing Formation <i>sectioned cliff</i>		Pool <i>Thipp</i>	Dedicated Acreage: 160 Acres	

1. Outline the acreage dedicated to the subject well by colored pencil or hatchure marks on the plat below.
2. If more than one lease is dedicated to the well, outline each and identify the ownership thereof (both as to working interest and royalty).
3. If more than one lease of different ownership is dedicated to the well, have the interests of all owners been consolidated by communitization, unitization, force-pooling, etc?

(X) Yes () No If answer is "yes," type of consolidation UNIT

If answer is "no," list the owners and tract descriptions which have actually consolidated. (Use reverse side of this form if necessary.)

No allowable will be assigned to the well until all interests have been consolidated. (by communitization, unitization, forced-pooling, or otherwise) or until a non standard unit, eliminating such interests, has been approved by the Commission.

CERTIFICATION

I hereby certify that the information contained herein is true and complete to the best of my knowledge and belief.

Name J. W. Kimmel
 Position Div. Ops. Engr.
 Company Shell Oil Company
 Date January 3, 1977

I hereby certify that the well location shown on this plat was plotted from field notes of actual surveys made by me or under my supervision, and that the same is true and correct to the best of my knowledge and belief.

Date Surveyed 1 November, 1976
James P. Loose
 Registered Professional Engineer
 and/or Land Surveyor
James P. Loose

Certificate No. 1463
 1463

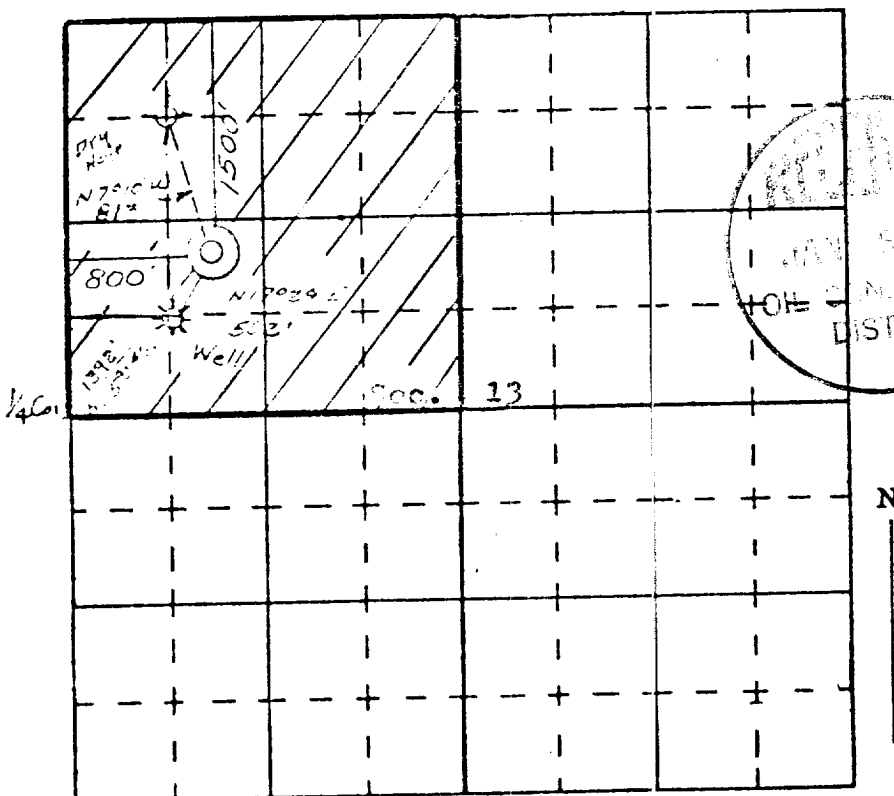

DRILLING WELL PROGNOSIS

WELL NAME Carson Unit 12X-13
 TYPE WELL Development
 FIELD/AREA Carson Unit - Bisti Field

APPROX. LOCATION (SUBJECT TO SURVEY) _____

EST. G. L. ELEVATION 6400 PROJECTED TD 1270 OBJECTIVE Pictured Cliffs
SURFACE - OJO ALAMO

HOLE SIZE	CASING PROGRAM	LOGGING PROGRAMS	MAX DEV.	DEPTHS AND FORMATION TOPS	SPECIAL INSTRUCTIONS
12-1/4	8-5/8			OJO Alamo	SAMPLES: None
					CORES: 1 Pictured Cliffs
		280+		Kirtland 270 (+6130)	DST'S: None
					DEVIATION CONTROL 1° per 1000' of depth w/dogleg severity not to exceed 1-1/2° per any 100' interval
				Farmington 650 (+5750)	CEMENT 8-5/8: Cement to surface w/class "A" + CaCl ₂ . W.O.C. 4 hrs. 4-1/2: Cement to surface w/class "A" + 18% NaCl + 2% Gel
-7/8	4-1/2	DIL/SP/GR FDC-CNL/GR BHC-Sonic/GR Sidewall Samples	1° per 1000' depth	Fruitland 890 (+5510)	MUD 0 - 280': Spud mud 280' - TD: H ₂ O
				Pictured Cliffs 1220 (+5180)	
				TD 1270 (+5130)	

ORIGINATOR: R. K. Bullard

DATE 10/27/76

ATTACHMENT 1

ENGINEERING APPROVAL:

PETROLEUM:

OPERATIONS:

OPERATIONS APPROVAL:

DIV. DRILLING SUPT.