

UNITED STATES
DEPARTMENT OF THE INTERIOR
GEOLOGICAL SURVEY

SUBMIT IN TRIPLICATE*
(Other instructions on re-
verse side)

Form approved.
Budget Bureau No. 42-R1424.

5. LEASE DESIGNATION AND SERIAL NO.

NM-23064

6. IF INDIAN, ALLOTTEE OR TRIBE NAME

7. UNIT AGREEMENT NAME

8. FARM OR LEASE NAME

Gulf Little Federal 25

9. WELL NO.

1

10. FIELD AND POOL, OR WILDCAT

Undesignated Pictured Cliffs

11. SEC., T., R., M., OR BLK. AND

Sec. 25-T25N-R10W

N.M.P.M.

12. COUNTY OR PARISH

San Juan

13. STATE

New Mexico

1. OIL WELL ☐ GAS WELL ☒ OTHER

2. NAME OF OPERATOR

ODESSA NATURAL CORPORATION Attn: John Strojek

3. ADDRESS OF OPERATOR

P. O. Box 3908 Odessa, Texas 79760

4. LOCATION OF WELL (Report location clearly and in accordance with any State requirements.*

See also space 17 below.)

At surface 1140'FNL, 1080'FEL

14. PERMIT NO.

15. ELEVATIONS (Show whether DF, RT, GR, etc.)

6697'GL, 6710'DF, 6711'KB

16.

Check Appropriate Box To Indicate Nature of Notice, Report, or Other Data

NOTICE OF INTENTION TO:

TEST WATER SHUT-OFF

FRACTURE TREAT

SHOOT OR ACIDIZE

REPAIR WELL

(Other)

PULL OR ALTER CASING

MULTIPLE COMPLETE

ABANDON*

CHANGE PLANS

SUBSEQUENT REPORT OF:

WATER SHUT-OFF

FRACTURE TREATMENT

SHOOTING OR ACIDIZING

(Other)

REPAIRING WELL

ALTERING CASING

ABANDONMENT*

See below

(NOTE: Report results of multiple completion on Well
Completion or Recompletion Report and Log form.)

17. DESCRIBE PROPOSED OR COMPLETED OPERATIONS (Clearly state all pertinent details, and give pertinent dates, including estimated date of starting any proposed work. If well is directionally drilled, give subsurface locations and measured and true vertical depths for all markers and zones pertinent to this work.)*

Change Acreage Dedication

From: N/2, 320 Acres, Sec. 25-T25N-R10W

TO: NE/4, 160 Acres, Sec. 25-T25N-R10W



FOR: ODESSA NATURAL CORPORATION

18. I hereby certify that the foregoing is true and correct

ORIGINAL SIGNED BY

SIGNED

EWELL N. WALSH, P.E.

TITLE

President, Walsh Engr.

& Prod. Corp.

DATE

5/12/80

(This space for Federal or State office use)

APPROVED BY

CONDITIONS OF APPROVAL, IF ANY:

TITLE

ACCEPTED FOR RECORD

*See Instructions on Reverse Side

NMOCC

MAY 30 1980

ADMINISTRATIVE DISTRICT

B

**NEW MEXICO OIL CONSERVATION COMMISSION
WELL LOCATION AND ACREAGE DEDICATION PLAT**

Form C-102
Supersedes C-101
Effective 1-1-77

All distances must be from the outer boundaries of the Section.

Operator Odessa Natural Corporation			Lease Gulf-Little-Federal 25		Well No. 1
Unit Letter A	Section 25	Township 25N	Range 10W	County San Juan	
Actual Footage Location of Well: 1140 feet from the North line and 1080 feet from the East line					
Ground Level Elev. 6697	Producing Formation Pictured Cliffs		Pool Undesignated Pictured Cliffs		Dedicated Acreage: 160 Acres

1. Outline the acreage dedicated to the subject well by colored pencil or hachure marks on the plat below.
2. If more than one lease is dedicated to the well, outline each and identify the ownership thereof (both as to working interest and royalty).
3. If more than one lease of different ownership is dedicated to the well, have the interests of all owners been consolidated by communitization, unitization, force-pooling, etc?

☒ Yes ☐ No If answer is "yes," type of consolidation Communitization

If answer is "no," list the owners and tract descriptions which have actually been consolidated. (Use reverse side of this form if necessary.) _____

No allowable will be assigned to the well until all interests have been consolidated (by communitization, unitization, forced-pooling, or otherwise) or until a non-standard unit, eliminating such interests, has been approved by the Commission.

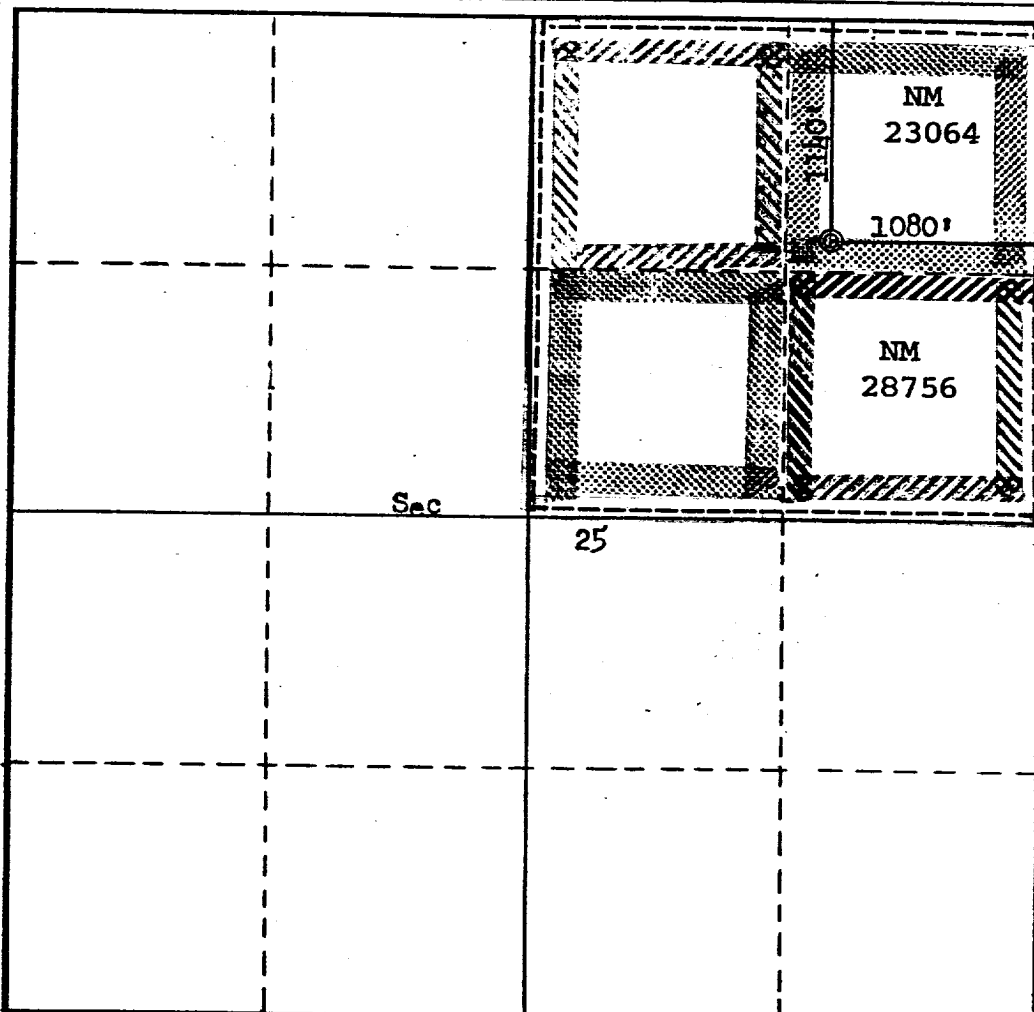

CERTIFICATION

I hereby certify that the information contained herein is true and complete to the best of my knowledge and belief.

For: Odessa Natural Corp.

Name **ORIGINAL SIGNED BY
EWELL N. WALSH**

Position **Ewell N. Walsh, P.E.
President, Walsh Engr.**

Company
& Production Corporation

Date **May 9, 1980**

I hereby certify that the well location shown on this plat was plotted from field notes of actual surveys made by me or under my supervision, and that the same is true and correct to the best of my knowledge and belief.

Date Surveyed
March 15, 1980

Registered Professional Engineer
and/or Land Surveyor

Fred B. Kern Jr.
Fred B. Kern Jr.

Certificate No. **3950**

