

UNITED STATES
DEPARTMENT OF THE INTERIOR
GEOLOGICAL SURVEY

APPLICATION FOR PERMIT TO DRILL, DEEPEN, OR PLUG BACK

1a. TYPE OF WORK DRILL <input checked="" type="checkbox"/> DEEPEN <input type="checkbox"/> PLUG BACK <input type="checkbox"/>			5. LEASE DESIGNATION AND SERIAL NO. 14-20-603-1449		
b. TYPE OF WELL OIL WELL <input type="checkbox"/> GAS WELL <input checked="" type="checkbox"/> OTHER <input type="checkbox"/> SINGLE ZONE <input checked="" type="checkbox"/> MULTIPLE ZONE <input type="checkbox"/>			6. IF INDIAN, ALLOTTEE OR TRIBE NAME Ka Gee Tah		
3. NAME OF OPERATOR Hixon Development Company			7. UNIT AGREEMENT NAME		
8. ADDRESS OF OPERATOR P. O. Box 2810, Farmington, New Mexico			8. FARM OR LEASE NAME Ka Gee Tah		
4. LOCATION OF WELL (Report location clearly and in accordance with any State requirements.) At surface 1550' FNL, 1850' FWL At proposed prod. zone			9. WELL NO. 1		
14. DISTANCE IN MILES AND DIRECTION FROM NEAREST TOWN OR POST OFFICE* Farmington - 25 miles			10. FIELD AND POOL, OR WILDCAT NIPP - PC <i>NYT</i>		
15. DISTANCE FROM PROPOSED* LOCATION TO NEAREST PROPERTY OR LEASE LINE, FT. (Also to nearest drlg. unit line, if any)			11. SEC., T., R., M., OR BLK. AND SURVEY OR AREA 10-25N-12W-NMPM		
16. NO. OF ACRES IN LEASE			12. COUNTY OR PARISH San Juan		
17. NO. OF ACRES ASSIGNED TO THIS WELL 160			13. STATE New Mexico		
18. DISTANCE FROM PROPOSED LOCATION* TO NEAREST WELL, DRILLING, COMPLETED, OR APPLIED FOR, ON THIS LEASE, FT.			20. ROTARY OR CABLE TOOLS Rotary		
19. PROPOSED DEPTH 1325'			22. APPROX. DATE WORK WILL START* July 1, 1977		
21. ELEVATIONS (Show whether DF, RT, GR, etc.) 6225' GL					

PROPOSED CASING AND CEMENTING PROGRAM

SIZE OF HOLE	SIZE OF CASING	WEIGHT PER FOOT	SETTING DEPTH	QUANTITY OF CEMENT
7 7/8"	5 1/2"	15.5	34'	5 sacks
4 3/4"	2 7/8"	6.4	1325'	75 sacks

It is planned to drill a 4 3/4" slimhole to test the Pictured Cliffs formation. The hole will be drilled with a portable rotary rig using mud. Because of low anticipated bottom hole pressure a BOP will not be used. A master casing valve and a stripper head will be used while completing the well. The well will be evaluated with open hole resistivity and porosity logs prior setting casing.

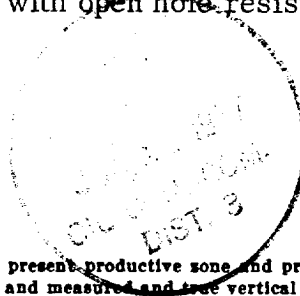

Gas is dedicated

IN ABOVE SPACE DESCRIBE PROPOSED PROGRAM: If proposal is to deepen or plug back, give data on present productive zone and proposed new productive zone. If proposal is to drill or deepen directionally, give pertinent data on subsurface locations and measured and true vertical depths. Give blowout preventer program, if any.

24. SIGNED Adrian H. Terrell TITLE Petroleum Engineer DATE June 9, 1977
(This space for Federal or State office use)

PERMIT NO. _____ APPROVAL DATE _____

APPROVED BY _____ TITLE _____ DATE _____
CONDITIONS OF APPROVAL, IF ANY:

albat

RECEIVED

JUN 13 1977

*See Instructions On Reverse Side

U. S. GEOLOGICAL SURVEY
FARMINGTON, N. M.

**NEW MEXICO OIL CONSERVATION COMMISSION
WELL LOCATION AND ACREAGE DEDICATION PLAT**

Form C-102
Supersedes C-128
Effective 1-1-65

All distances must be from the outer boundaries of the Section.

Operator Hixon Development Company			Lease Ka Gee Tah		Well No. 1
Unit Letter F	Section 10	Township 25 North	Range 12 West	County San Juan	
Actual Footage Location of Well: 1550 feet from the North line and 1850 feet from the West line					
Ground Level Elev. 6225	Producing Formation Pictured Cliffs		Pool NIPP - PC	Dedicated Acreage: 160 Acres	

1. Outline the acreage dedicated to the subject well by colored pencil or hachure marks on the plat below.
2. If more than one lease is dedicated to the well, outline each and identify the ownership thereof (both as to working interest and royalty).
3. If more than one lease of different ownership is dedicated to the well, have the interests of all owners been consolidated by communitization, unitization, force-pooling, etc?

☐ Yes ☒ No If answer is "yes," type of consolidation 1 - Lease

If answer is "no," list the owners and tract descriptions which have actually been consolidated. (Use reverse side of this form if necessary.) Southern Union farmout to Hixon Development Company

No allowable will be assigned to the well until all interests have been consolidated (by communitization, unitization, forced-pooling, or otherwise) or until a non-standard unit, eliminating such interests, has been approved by the Commission.

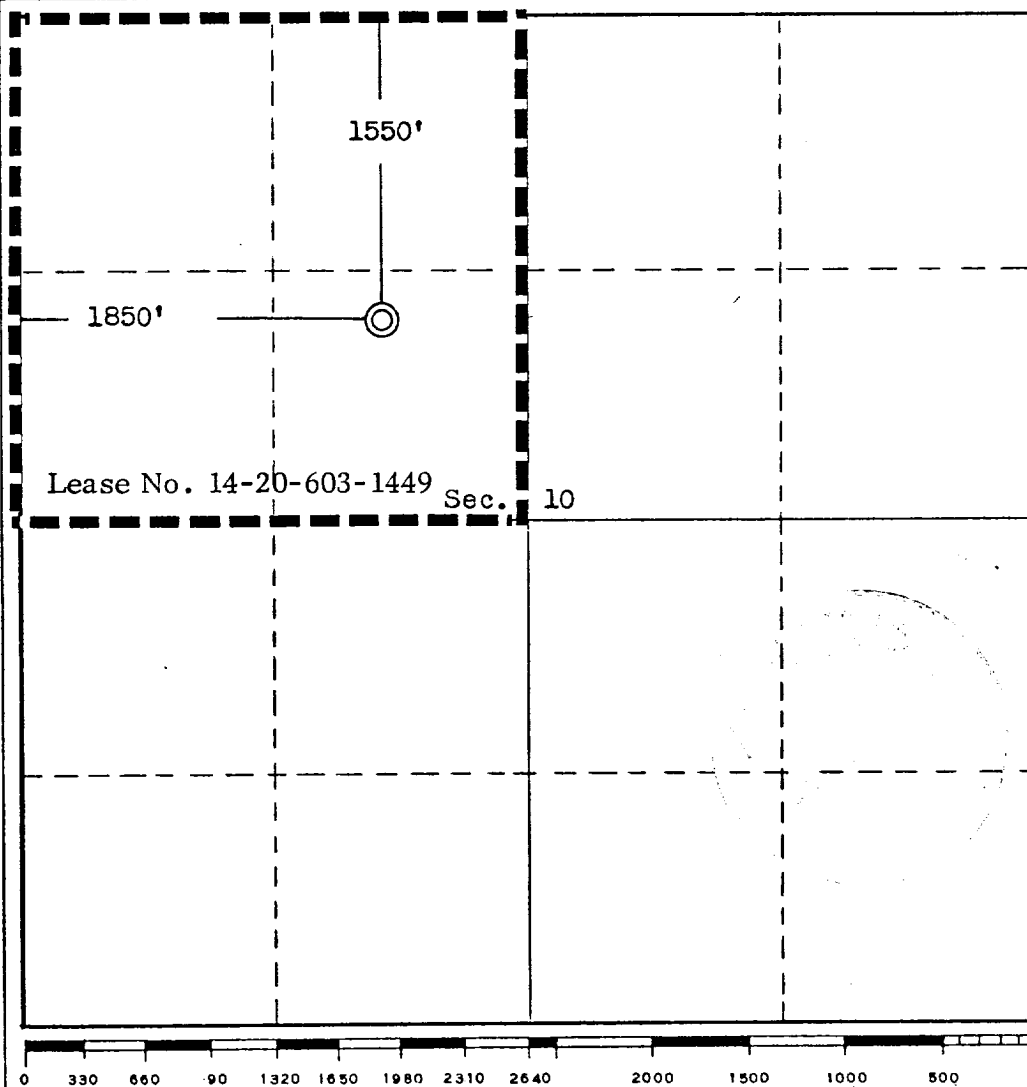

CERTIFICATION

I hereby certify that the information contained herein is true and complete to the best of my knowledge and belief.

Name

Aldrich L. Kuchera

Position

Petroleum Engineer

Company

Hixon Development Company

Date

June 9, 1977

I hereby certify that the well location shown on this plat was plotted from field notes of actual surveys made by me or under my supervision, and that the same is true and correct to the best of my knowledge and belief.

Date Surveyed

June 4, 1977

Registered Professional Engineer
and/or Land Surveyor

Edgar L. Risenhoover

Certificate No. 5979

Edgar L. Risenhoover, L.S.