

UNITED STATES  
DEPARTMENT OF THE INTERIOR  
GEOLOGICAL SURVEY

## APPLICATION FOR PERMIT TO DRILL, DEEPEN, OR PLUG BACK

## 1a. TYPE OF WORK

DRILL ☒DEEPEN ☐PLUG BACK ☐

## b. TYPE OF WELL

OIL  
WELL ☐GAS  
WELL ☒

OTHER

SINGLE  
ZONE ☒MULTIPLE  
ZONE ☐

## 2. NAME OF OPERATOR

Hixon Development Company

## 3. ADDRESS OF OPERATOR

P. O. Box 2810, Farmington, New Mexico

## 4. LOCATION OF WELL (Report location clearly and in accordance with any State requirements.)

At surface

790' FSL, 1000' FWL

Section 3-T25N-R12W

At proposed prod. zone

## 14. DISTANCE IN MILES AND DIRECTION FROM NEAREST TOWN OR POST OFFICE\*

Farmington - 24 miles

## 15. DISTANCE FROM PROPOSED\*

LOCATION TO NEAREST  
PROPERTY OR LEASE LINE, FT.  
(Also to nearest drlg. unit line, if any)

## 16. NO. OF ACRES IN LEASE

17. NO. OF ACRES ASSIGNED  
TO THIS WELL

160

18. DISTANCE FROM PROPOSED LOCATION\*  
TO NEAREST WELL, DRILLING, COMPLETED,  
OR APPLIED FOR, ON THIS LEASE, FT.

## 19. PROPOSED DEPTH

1325'

## 20. ROTARY OR CABLE TOOLS

Rotary

## 21. ELEVATIONS (Show whether DF, RT, GR, etc.)

6188' GL

## 22. APPROX. DATE WORK WILL START\*

## 23.

## PROPOSED CASING AND CEMENTING PROGRAM

| SIZE OF HOLE | SIZE OF CASING | WEIGHT PER FOOT | SETTING DEPTH | QUANTITY OF CEMENT |
|--------------|----------------|-----------------|---------------|--------------------|
| 7 7/8"       | 5 1/2"         | 15.5            | 34'           | 5 sacks            |
| 4 3/4"       | 2 7/8"         | 6.5             | 1325'         | 75 sacks           |

It is planned to drill a 4 3/4" slimhole to test the Pictured Cliffs formation. The hole will be drilled with a portable rotary rig using mud. Because of low anticipated bottom hole pressure a BOP will not be used. A master casing valve and a stripper head will be used while completing the well. The well will be evaluated with open hole resistivity and porosity logs prior setting casing.

IN ABOVE SPACE DESCRIBE PROPOSED PROGRAM: If proposal is to deepen or plug back, give data on present productive zone and proposed new productive zone. If proposal is to drill or deepen directionally, give pertinent data on subsurface locations and measured and true vertical depths. Give blowout preventer program, if any.

## 24.

SIGNED

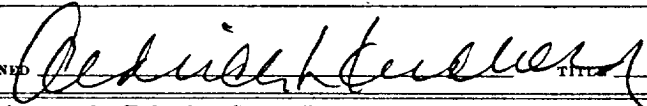

TITLE

Petroleum Engineer

DATE July 18, 1977

(This space for Federal or State office use)

PERMIT NO.

APPROVAL DATE

APPROVED BY

TITLE

CONDITIONS OF APPROVAL, IF ANY:

RECEIVED

DATE

JUL 21 1977

\*See Instructions On Reverse Side

U. S. GEOLOGICAL SURVEY  
FARMINGTON, N. M.

30-045-22675

5. LEASE DESIGNATION AND SERIAL NO.

14-20-603-1423

6. IF INDIAN, ALLOTTEE OR TRIBE NAME

Ka Da Pah

7. UNIT AGREEMENT NAME

8. FARM OR LEASE NAME

Ka Da Pah

9. WELL NO.

1

10. FIELD AND POOL, OR WILDCAT

NIPP - PC

11. SEC., T., R., M., OR BLK.  
AND SURVEY OR AREA

3-25N-12W - NMPM

12. COUNTY OR PARISH

San Juan

13. STATE

New Mexico

**NEW MEXICO OIL CONSERVATION COMMISSION  
WELL LOCATION AND ACREAGE DEDICATION PLAT**

Form C-102  
Supersedes C-128  
Effective 1-1-65

All distances must be from the outer boundaries of the Section.

|   |   |                             |                           |  |                      |
|---|---|-----------------------------|---------------------------|--|----------------------|
| Operator<br><b>Hixon Development Company</b>  |   |                             | Lease<br><b>Ka Da Pah</b> |  | Well No.<br><b>1</b> |
| Unit Letter<br><b>M</b>   | Section<br><b>3</b>                           | Township<br><b>25 North</b> | Range<br><b>12 West</b>   | County<br><b>San Juan</b>              |                      |
| Actual Footage Location of Well:<br><b>790</b> feet from the <b>South</b> line and <b>1000</b> feet from the <b>West</b> line |   |                             |                           |  |                      |
| Ground Level Elev.<br><b>6188</b>   | Producing Formation<br><b>Pictured Cliffs</b> | Pool<br><b>NIPP - PC</b>    |                           | Dedicated Acreage:<br><b>160</b> Acres |                      |

1. Outline the acreage dedicated to the subject well by colored pencil or hachure marks on the plat below.
2. If more than one lease is dedicated to the well, outline each and identify the ownership thereof (both as to working interest and royalty).
3. If more than one lease of different ownership is dedicated to the well, have the interests of all owners been consolidated by communitization, unitization, force-pooling, etc?

☐ Yes ☒ No If answer is "yes," type of consolidation 1 - Lease

If answer is "no," list the owners and tract descriptions which have actually been consolidated. (Use reverse side of this form if necessary.) \_\_\_\_\_

No allowable will be assigned to the well until all interests have been consolidated (by communitization, unitization, forced-pooling, or otherwise) or until a non-standard unit, eliminating such interests, has been approved by the Commission.

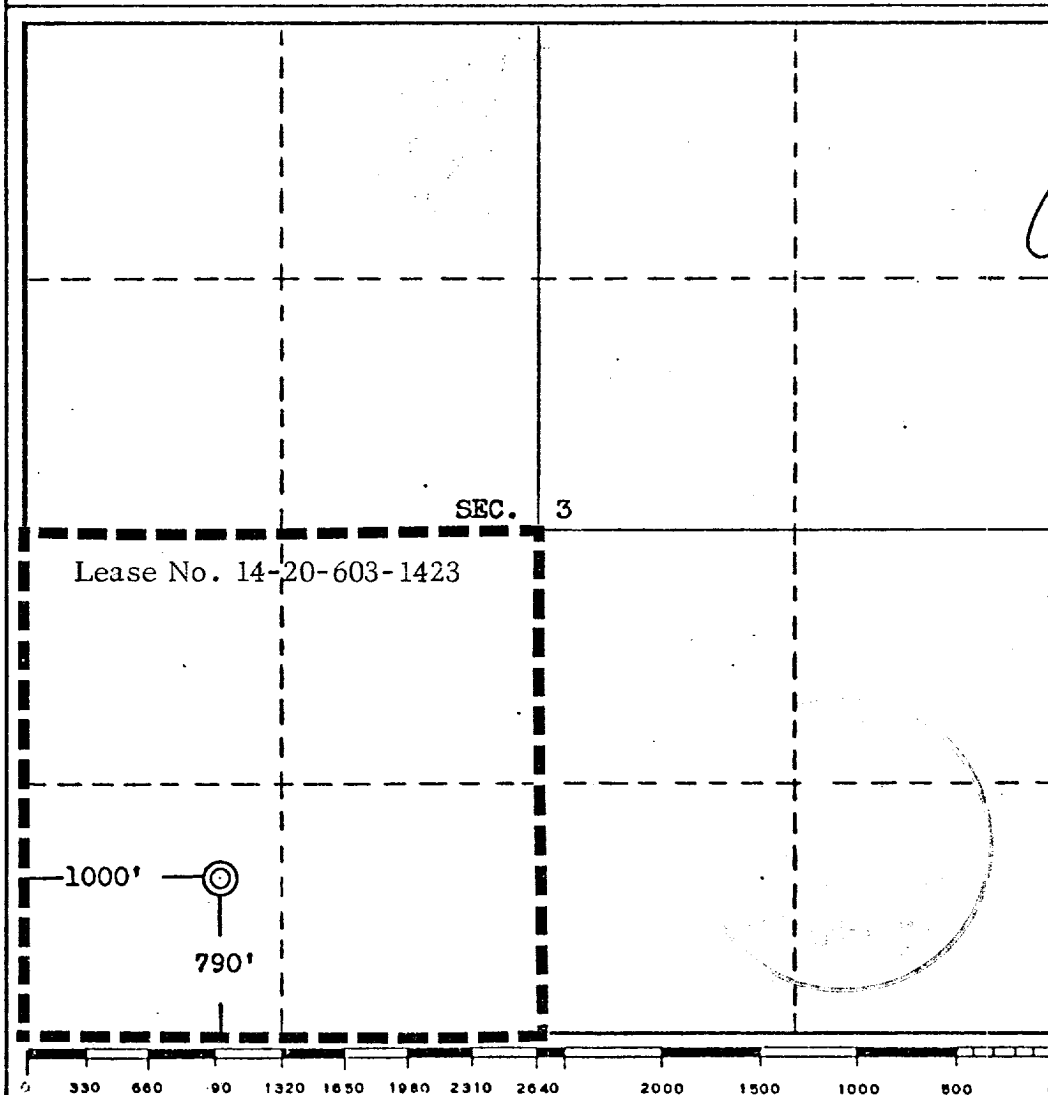

**CERTIFICATION**

I hereby certify that the information contained herein is true and complete to the best of my knowledge and belief.

*Aldrich L. Kuchera*

Name  
**Aldrich L. Kuchera**  
Position  
**Petroleum Engineer**  
Company  
**Hixon Development Company**  
Date  
**July 18, 1977**

I hereby certify that the well location shown on this plat was plotted from field notes of actual surveys made by me or under my supervision, and that the same is true and correct to the best of my knowledge and belief.

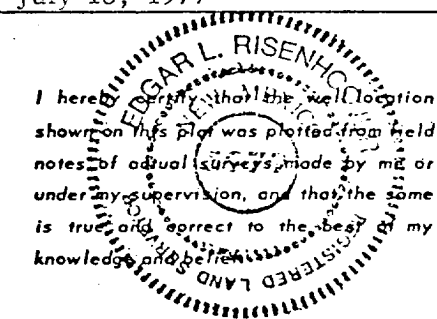

Date Surveyed  
**July 11, 1977**  
Registered Professional Engineer and/or Land Surveyor  
*Edgar L. Risenhoover*  
Certificate No. **5979**  
**Edgar L. Risenhoover, L.S.**

# HIXON DEVELOPMENT COM 4Y

PROJECT KA DA PAH NO. 1

JOB NO. \_\_\_\_\_

PURPOSE DRILLING SITE

SHEET \_\_\_\_\_ OF \_\_\_\_\_

COMPUTED BY ALK

CHECKED BY \_\_\_\_\_

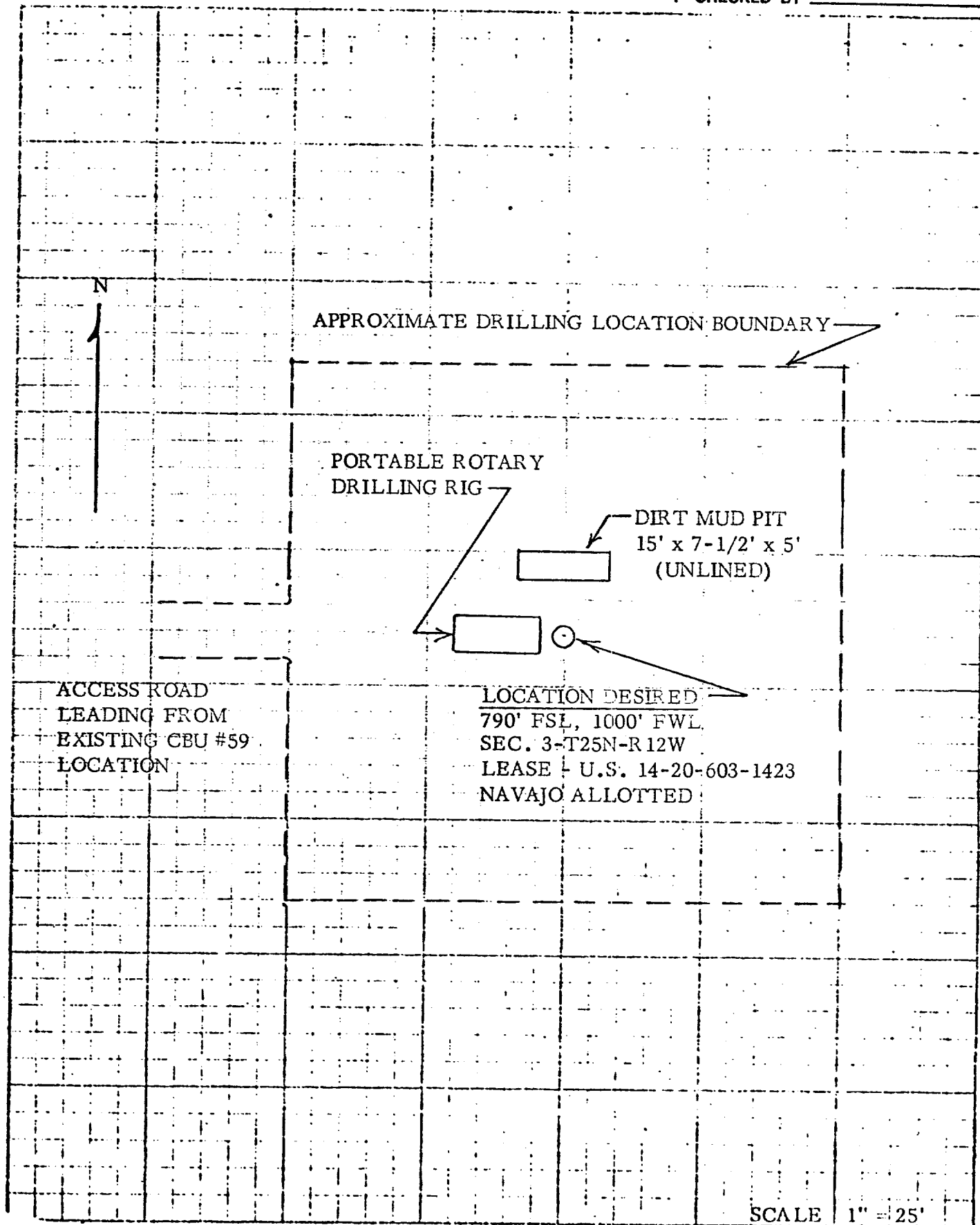

CENTRAL BISTI / CARSON UNIT. 1A  
SAN JUAN COUNTY, NEW MEXICO

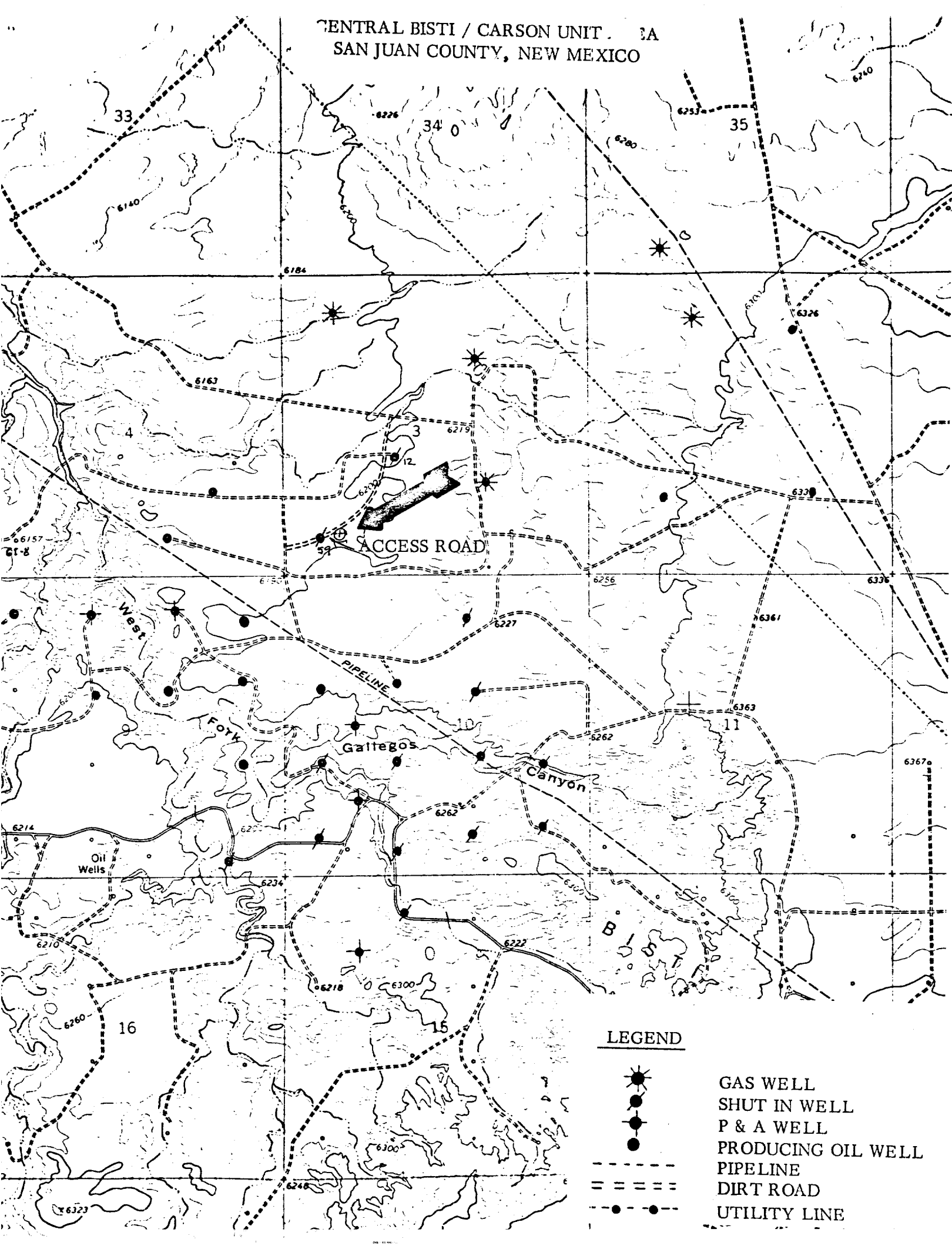

LEGEND



GAS WELL



SHUT IN WELL



P & A WELL



PRODUCING OIL WELL

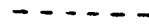

PIPELINE

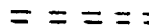

DIRT ROAD



UTILITY LINE

HIXON DEVELOPMENT COMPANY

P. O. BOX 2810

FARMINGTON, NEW MEXICO 87401

July 27, 1977

CERTIFICATION

I hereby certify that I, or persons under my direct supervision, have inspected the proposed drill site and access route; that I am familiar with the conditions which presently exist; that the statements made in this plan are, to the best of my knowledge, true and correct; and, that the work associated with the operations proposed herein will be performed by Hixon Development Company and its contractors and subcontractors in conformity with this plan and the terms and conditions under which it is approved.

July 27, 1977



Aldrich L. Kuchera  
Production Manager  
and Petroleum Engineer

ALK:km

Application for Permit to Drill  
Hixon Development Company  
Ka Da Pah No. 1 (Development Well)  
NIPP - PC Field  
SW/4 Section 3-T25N-R12W  
San Juan County, New Mexico

Recap of NTL-6 13-Point Outline (Supplement to Hixon Development Company's  
July 18, 1977 letter to Mr. P. T. McGrath, attached)

1. Existing Roads - Refer to attached topographic map. The proposed well site is located inside an existing 25 year old oil field. The field has an extensive lease road system tied to State Highway 173 south of Farmington.
2. Planned Access Roads - Construction of an access road will not be necessary. Per the attached map, an access road already exists to this well site.
3. Location of Existing Wells - (Refer to attached map)
4. Location of Tank Batteries, Production Facilities etc. - There are buried oil flowlines in the vicinity of the proposed well leading west from CBU Wells #12 and #59.

With the exception of a meter house and an El Paso gas line tiein, the proposed well site will not have any other facilities.

5. Location and Type of Water Supply - Will not be necessary. Any water used for workover purposes will be hauled in from a source well in Section 5, or else from Farmington.
6. Source of Construction Materials - None will be used.
7. Methods for Handling Waste Disposal - Any waste material incurred while drilling will be buried in the mud pits.
8. Ancillary Facilities - Will use existing Central Bisti Unit facilities.
9. Well Site Layout - Refer to plat attached.
10. Plans for Restoration of Surface - Area in the vicinity of well site is primarily sand. Very little of the well site area will be disturbed.
11. Other Information - Refer to Archaeological Report to be submitted to USGS.
12. Leasee's or Operator's Representative -

Aldrich L. Kuchera  
Telephone - 325-6984 - Office  
              - 325-3448 - Home  
              - 325-1873 - Unit 675 Car Telephone

13. See Attached

HIXON DEVELOPMENT COMPANY

P. O. BOX 2810

FARMINGTON, NEW MEXICO 87401

July 18, 1977

Mr. P. T. McGrath  
U. S. G. S.  
P. O. Box 959  
Farmington, New Mexico 87401

Re: Application for Permit to Drill  
Hixon Development Company  
Ka Da Pah No. 1 (NIPP - PC Field)  
Navajo Allotted  
SW/4 Sec. 3-T25N-R12W  
San Juan County, New Mexico

Dear Mr. McGrath,

We desire approval to drill the captioned slimhole shallow Pictured Cliffs gas NIPP - PC Field development well. The well is to be drilled to a TD of 1325' using a portable truck mounted rotary rig. Surface hole will be 7 7/8" with a 4 3/4" production hole. Casing size would be 5 1/2" 15.5# and 2 7/8" 6.5# respectively. Surface hole will be drilled with air and mud used to drill the 4 3/4" hole.

The proposed location is inside the Central Bisti Unit and would utilize established lease roads for access. Minimal well location work will be necessary. Mud pits are to be used per the attached location plat.

Water for drilling will be hauled from either the San Juan River or else from a Central Bisti Unit water supply well located in Sec. 5-25N-12W. Any waste will be disposed of by burial in the mud pit. There will not be any camp or airstrip associated with this facility. Existing Central Bisti Unit field facilities will be used for drilling personnel and for any logistics.

Tentative gas sales pipeline hookup would be to the EPNG gas pipeline located in Sec. 2 and Sec. 11, T25N, R12W per the attached topographic map.

Upon completion or abandonment of this well, the location will be cleaned, mud pits buried and leveled and dry hole marker placed if applicable. It should be noted that the Bisti Field area is sparsely populated, sandy semi-desert type environment. Archaeological clearance will be obtained prior drilling.

Hixon Development Company has a contract deadline of August 15 to spud this well. We would appreciate your earliest attention to this request.

Very truly yours,

Hixon Development Company

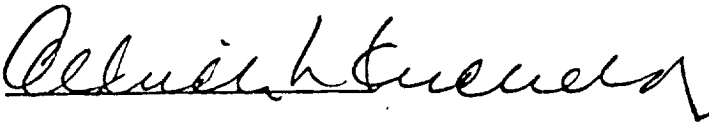
By 

Aldrich L. Kuchera  
Petroleum Engineer

ALK:km