

UNITED STATES
DEPARTMENT OF THE INTERIOR
GEOLOGICAL SURVEY

30-045-22740

5. LEASE DESIGNATION AND SERIAL NO.

14-20-603-1424

6. IF INDIAN, ALLOTTEE OR TRIBE NAME

In Ni Da Pah

7. UNIT AGREEMENT NAME

8. FARM OR LEASE NAME

In Ni Da Pah

9. WELL NO.

10. FIELD AND BLOCK OR WILDCAT

NIPP - PC

11. SEC., T., R., M., OR BLM.
AND SURVEY OR AREA

4-25N-12W NMPM

12. COUNTY OR PARISH 13. STATE

San Juan

New Mexico

APPLICATION FOR PERMIT TO DRILL, DEEPEN, OR PLUG BACK

1a. TYPE OF WORK

DRILL ☒DEEPEN ☐PLUG BACK ☐

1b. TYPE OF WELL

OIL
WELL ☐GAS
WELL ☒

OTHER

SINGLE
ZONE ☒MULTIPLE
ZONE ☐

2. NAME OF OPERATOR

Hixon Development Company

3. ADDRESS OF OPERATOR

P. O. Box 2810, Farmington, New Mexico

4. LOCATION OF WELL (Report location clearly and in accordance with any State requirements.)*

At surface

I 1775' FSL, 790' FEL, SEC. 4-25N-12W

At proposed prod. zone

14. DISTANCE IN MILES AND DIRECTION FROM NEAREST TOWN OR POST OFFICE*

Farmington - 24 miles

15. DISTANCE FROM PROPOSED*

LOCATION TO NEAREST
PROPERTY OR LEASE LINE, FT.
(Also to nearest oil, gas line, if any)

16. NO. OF ACRES IN LEASE

19. PROPOSED DEPTH

1300'

17. NO. OF ACRES ASSIGNED
TO THIS WELL

160

20. ROTARY OR CABLE TOOLS

Rotary

21. ELEVATION (Show whether DF, RT, GR, etc.)

6175' GL

22. APPROX. DATE WORK WILL START*

October 1, 1977

23. PROPOSED CASING AND CEMENTING PROGRAM

SIZE OF HOLE	SIZE OF CASING	WEIGHT PER FOOT	SETTING DEPTH	QUANTITY OF CEMENT
1 7/8"	5 1/2"	15.5#	3'	5 sacks
4 3/4"	2 7/8"	6.5#	1300'	

RECEIVED

SEP 20 1977

U. S. GEOLOGICAL SURVEY

It is planned to drill a 4 3/4" slimhole to test the Pictured Cliffs formation. The well will be drilled with a portable rotary rig using mud. Because of low anticipated bottom hole pressure a BOP will not be used. A master casing valve and a stripper head will be used while completing the well. The well will be evaluated with open-hole resistivity and porosity logs prior setting casing.

SEP 21 1977
OIL CON. COM.
DIST. 3

IN ABOVE SPACE DESCRIBE PROPOSED PROGRAM: If proposal is to deepen or plug back, give data on present productive zone and proposed new productive zone. If proposal is to drill or deepen directionally, give pertinent data on subsurface locations and measured and true vertical depths. Give blowout preventer program, if any.

24. Gas not dedicated
SIGNED Charles H. Lawrence TITLE Petroleum Engineer DATE 9/20/77

(This space for Federal or State office use)

PERMIT NO. _____ APPROVAL DATE _____

APPROVED BY _____ TITLE _____ DATE _____
CONDITIONS OF APPROVAL, IF ANY:Oban

*See Instructions On Reverse Side

NEW MEXICO OIL CONSERVATION COMMISSION
WELL LOCATION AND ACREAGE DEDICATION PLAT

Form C-102
Supersedes C-122
Effective 1-1-65

All distances must be from the outer boundaries of the Section.

Operator Hixon Development Company			Lease In Ni Da Pah		Well No. In Ni Da Pah #1
Unit Factor I	Section 4	Township 25 North	Range 12 West	County San Juan	
Actual Location of Well:					
1775 feet from the South line and		790 feet from the East line			
Ground Level Elev. 6175	Producing Formation Pictured Cliffs	Post NIPP - PC	Dedicated Acreage 160 Acres		

1. Outline the acreage dedicated to the subject well by colored pencil or hatchure marks on the plat below.
2. If more than one lease is dedicated to the well, outline each and identify the ownership thereof (both as to working interest and royalty).
3. If more than one lease of different ownership is dedicated to the well, have the interests of all owners been consolidated by communitization, unitization, force-pooling, etc?

☐ Yes ☒ No If answer is "yes," type of consolidation 1 - Owner Lease

If answer is "no," list the owners and tract descriptions which have actually been consolidated. (Use reverse side of this form if necessary.)

No allowable will be assigned to the well until all interests have been consolidated (by communitization, unitization, forced-pooling, or otherwise) or until a non-standard unit, eliminating such interests, has been approved by the Commission.

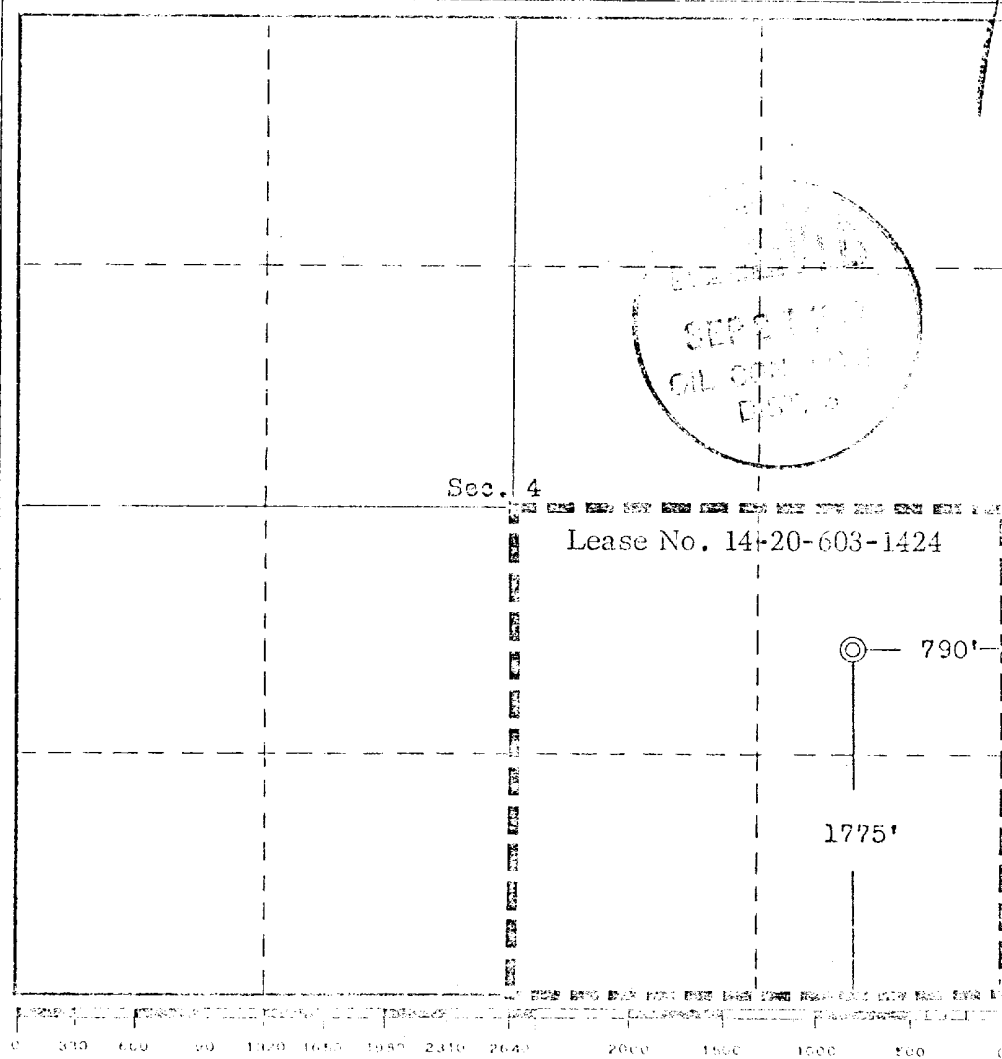

RECEIVED
CERTIFICATION

SEP 20 1977

I hereby certify that the information contained herein is true and complete to the best of my belief.

U. S. GEOLOGICAL SURVEY
FARMINGTON, N. M.

Name
Aldrich L. Kuchera
Position
Petroleum Engineer
Company
Hixon Development Company
Date
September 20, 1977

I hereby certify that the well location shown on this plat was plotted from field notes of actual surveys made by me or under my supervision, and that the same is true and correct to the best of my knowledge and belief.

Date Surveyed
September 18, 1977
Inspector of the Land Survey
and of Land Surveyor

Edgar L. Risenhoover, L.S.

Application for Permit to Drill
Hixon Development Company
In Ni Da Pali No. 1 (Development Well)
NIPP - PC Field
SE/4 Section 4-T25N-R12W
San Juan County, New Mexico

Recap of NTL-6 13-Point Outline is as follows:

1. Existing Roads - Refer to attached topographic map. The proposed well site is located inside an existing 25 year old oil field. The field has an extensive lease road system tied to State Highway 371 south of Farmington.
2. Planned Access Roads - Construction of an access road will not be necessary. Per the attached map, an access road already exists to this well site.
3. Location of Existing Wells - Refer to attached map.
4. Location of Tank Batteries, Production Facilities etc. - There is a buried oil flowline in the vicinity of the proposed well leading southwest from CBU Well #11.
5. Location and Type of Water Supply - Will not be necessary. Any water used for workover purposes will be hauled in from a source well in Section 5, or else from Farmington.
6. Source of Construction Materials - None will be used.
7. Methods for Handling Waste Disposal - Any waste material incurred while drilling will be buried in the mud pits.
8. Ancillary Facilities - Will use existing Central Bisti Unit facilities.
9. Well Site Layout - Refer to plat attached.
10. Plans for Restoration of Surface - Area in the vicinity of well site is primarily sand. Very little of the well site area will be disturbed.
11. Other Information - Refer to Archaeological Report to be submitted to USGS.
12. Leasee's or Operator's Representative -

Aldrich L. Kuchera
Telephone - 325-6984 - Office
 - 325-3448 - Home
 - 325-1873 - Unit 675 Car Telephone
13. See Attached

HIXON DEVELOPMENT COMPANY

PROJECT IN NI DA PAH NO. 1

JOB NO. _____

PURPOSE DRILLING SITE PLAT

SHEET _____ OF _____

COMPUTED BY ALK

CHECKED BY _____

PROPOSED DRILL SITE:



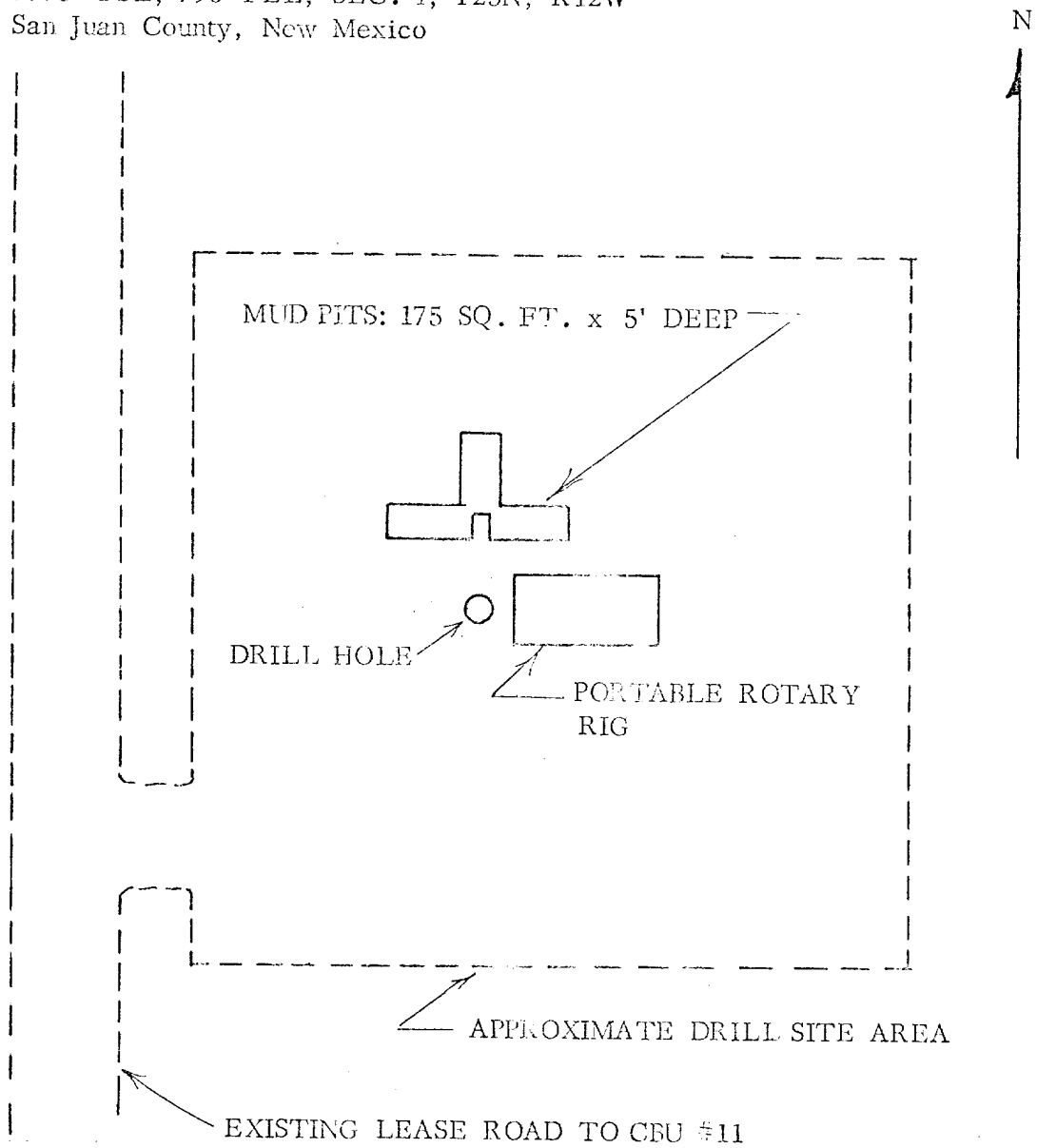

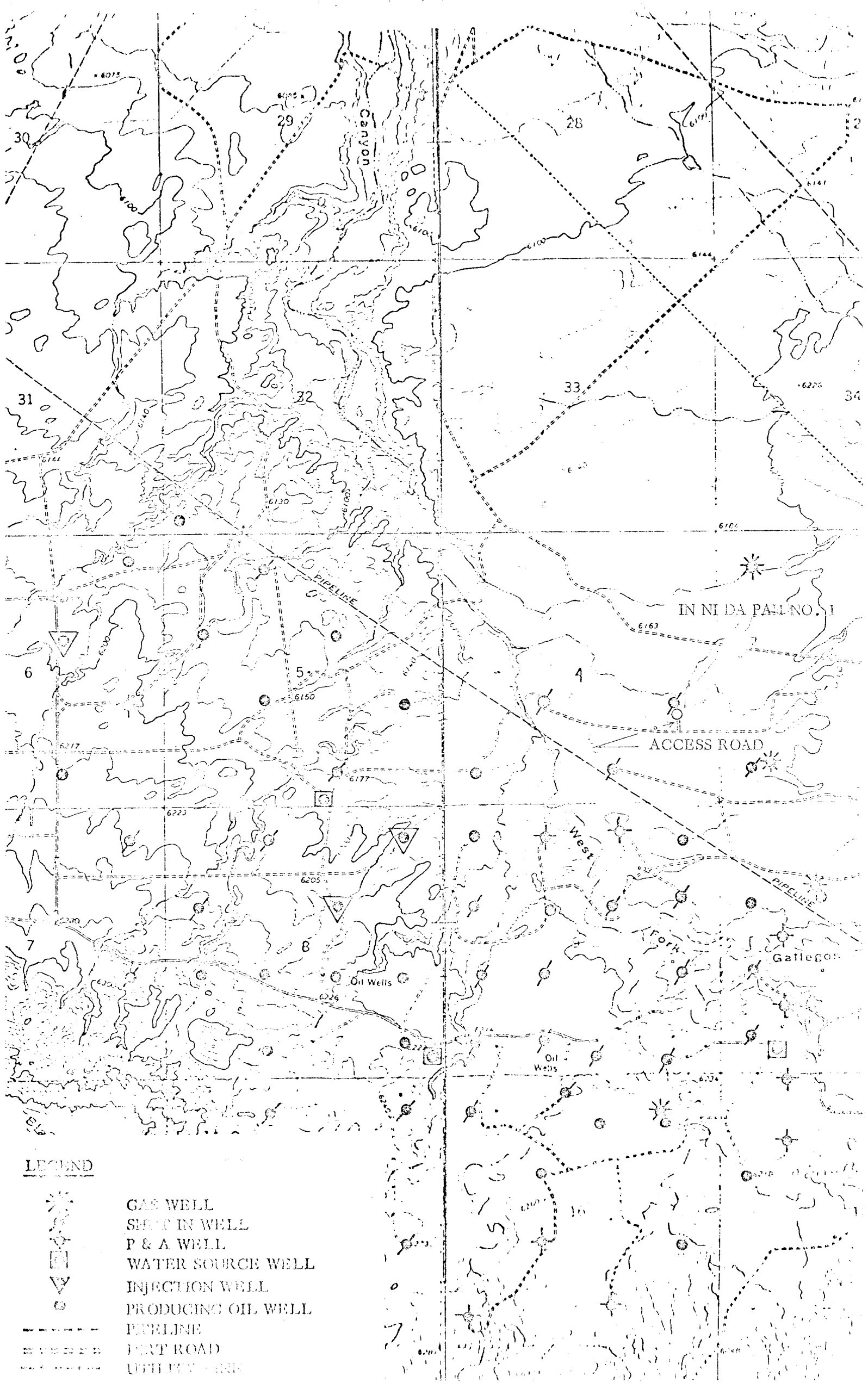

1775' FSL, 790' FEL, SEC. 4, T25N, R12W
San Juan County, New Mexico



SCALE: 1" = 25'

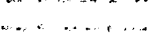
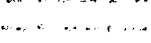
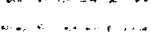

LEGEND

-  GAS WELL
-  SHUT IN WELL
-  P & A WELL
-  WATER SOURCE WELL
-  INJECTION WELL
-  PRODUCING OIL WELL
-  PIPELINE
-  DIRT ROAD
-  UTILITY LINE

HIXON DEVELOPMENT COMPANY

P. O. BOX 2810
FARMINGTON, NEW MEXICO 87401

CERTIFICATION

I hereby certify that I, or persons under my direct supervision, have inspected the proposed drill site and access route; that I am familiar with the conditions which presently exist; that the statements made in this plan are, to the best of my knowledge, true and correct; and, that the work associated with the operations proposed herein will be performed by Hixon Development Company and its contractors and subcontractors in conformity with this plan and the terms and conditions under which it is approved.

September 20, 1977

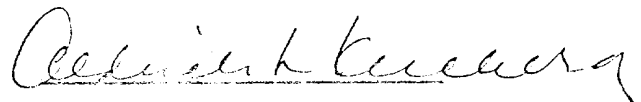

Aldrich L. Kuchera
Production Manager
and Petroleum Engineer

ALK:km