

UNITED STATES
DEPARTMENT OF THE INTERIOR

GEOLOGICAL SURVEY

APPLICATION FOR PERMIT TO DRILL, DEEPEN, OR PLUG BACK

1A. TYPE OF WORK

DRILL ☒DEEPEN ☐PLUG BACK ☐

B. TYPE OF WELL

OIL
WELL ☐GAS
WELL ☒

OTHER

SINGLE
ZONE ☒MULTIPLE
ZONE ☐

2. NAME OF OPERATOR

Hixon Development Company

3. ADDRESS OF OPERATOR

P. O. Box 2810, Farmington, New Mexico

4. LOCATION OF WELL (Report location clearly and in accordance with any State requirements.)*

At surface

1850' FNL, 1500' FEL
At proposed prod. zone

SEC. 4-25N-12W

14. DISTANCE IN MILES AND DIRECTION FROM NEAREST TOWN OR POST OFFICE*

Farmington - 24 miles

15. DISTANCE FROM PROPOSED*

LOCATION TO NEAREST
PROPERTY OR LEASE LINE, FT.
(Also to nearest drig. unit line, if any)18. DISTANCE FROM PROPOSED LOCATION*
TO NEAREST WELL, DRILLING, COMPLETED,
OR APPLIED FOR, ON THIS LEASE, FT.

16. NO. OF ACRES IN LEASE

19. PROPOSED DEPTH

1300'

17. NO. OF ACRES ASSIGNED
TO THIS WELL

160

20. ROTARY OR CABLE TOOLS

Rotary

21. ELEVATIONS (Show whether DF, RT, GR, etc.)

6159' GL

22. APPROX. DATE WORK WILL START*

December 15, 1977

23.

PROPOSED CASING AND CEMENTING PROGRAM

SIZE OF HOLE	SIZE OF CASING	WEIGHT PER FOOT	SETTING DEPTH	QUANTITY OF CEMENT
7 7/8"	5 1/2"	15.5#	34'	5 sacks
4 3/4"	2 7/8"	6.5#	1300'	75 sacks

It is planned to drill a 4 3/4" slimhole to test the Pictured Cliffs formation. The hole will be drilled with a portable rotary rig using mud. Because of low anticipated bottom hole pressure a BOP will not be used. A master casing valve and a stripper head will be used while completing the well. The well will be evaluated with open hole resistivity and porosity logs prior setting casing.

GAC No. 00000000

SEP 26 1977
OIL CON. COM.
DIST. 3

IN ABOVE SPACE DESCRIBE PROPOSED PROGRAM: If proposal is to deepen or plug back, give data on present productive zone and proposed new productive zone. If proposal is to drill or deepen directionally, give pertinent data on subsurface locations and measured and true vertical depths. Give blowout preventer program, if any.

24.

SIGNED

William H. T. ... Petroleum Engineer

DATE 9/21/77

(This space for Federal or State office use)

PERMIT NO. _____

APPROVAL DATE _____

APPROVED BY _____

TITLE _____

CONDITIONS OF APPROVAL, IF ANY:

RECEIVED

SEP 22 1977

*See Instructions On Reverse Side

U. S. GEOLOGICAL SURVEY

**NEW MEXICO OIL CONSERVATION COMMISSION
WELL LOCATION AND ACREAGE DEDICATION PLAT**

Form C-102
Supersedes C-128
Effective 1-1-65

All distances must be from the outer boundaries of the Section.

Operator Hixon Development Company			Lease Hixon Federal		Well No. Hixon Federal #1
Unit Letter G	Section 4	Township 25 North	Range 12 West	County San Juan	
Actual Footage Location of Well: 1850 feet from the North line and 1500 feet from the East line					
Ground Level Elev. 6159	Producing Formation Pictured Cliffs		Pool NIPP - PC	Dedicated Acreage: 160 Acres	

1. Outline the acreage dedicated to the subject well by colored pencil or hachure marks on the plat below.
2. If more than one lease is dedicated to the well, outline each and identify the ownership thereof (both as to working interest and royalty).
3. If more than one lease of different ownership is dedicated to the well, have the interests of all owners been consolidated by communitization, unitization, force-pooling, etc?

☐ Yes ☒ No If answer is "yes," type of consolidation 1 - Owner Lease

If answer is "no," list the owners and tract descriptions which have actually been consolidated. (Use reverse side of this form if necessary.) _____

No allowable will be assigned to the well until all interests have been consolidated (by communitization, unitization, forced-pooling, or otherwise) or until a non-standard unit, eliminating such interests, has been approved by the Commission.

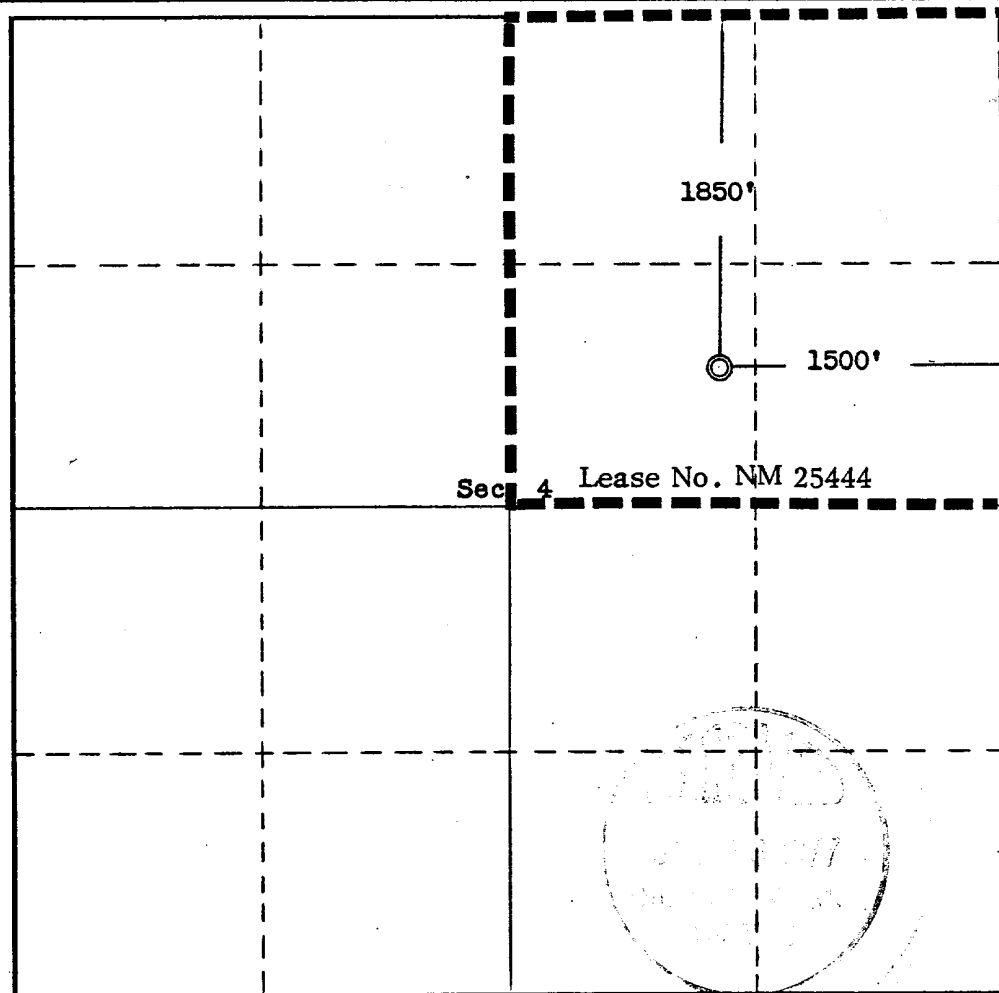

CERTIFICATION

I hereby certify that the information contained herein is true and complete to the best of my knowledge and belief.

Name Aldrich L. Kuchera
 Position Petroleum Engineer
 Company Hixon Development Company
 Date September 20, 1977

I hereby certify that the well location shown on this plat was plotted from field notes of actual surveys made by me or under my supervision, and that the same is true and correct to the best of my knowledge and belief.

Date Surveyed September 18, 1977
 Registered Professional Engineer and/or Land Surveyor

Edgar L. Risenhoover
 Certificate No. 5979

Edgar L. Risenhoover, L.S.

0 330 660 990 1320 1650 1980 2310 2640 2000 1500 1000 500 0

Application for Permit to Drill
Hixon Development Company
Hixon Federal No. 1 (Development Well)
NIPP-PC
NE/4 Section 4-T25N-R12W
San Juan County, New Mexico

Recap of NTL-6 13-Point Outline is as follows:

1. Existing Roads - Refer to attached topographic map. The proposed well site is located inside an existing 25 year old oil field. The field has an extensive lease road system tied to State Highway 371 south of Farmington.
2. Planned Access Roads - Construction of an access road will not be necessary. Per the attached map, an access road already exists to this well site.
3. Location of Existing Wells - Refer to attached map.
4. Location of Tank Batteries, Production Facilities etc. - There are none in this area.
5. Location and Type of Water Supply - Will not be necessary. Any water used for workover purposes will be hauled in from a source well in Section 5, or else from Farmington.
6. Source of Construction Materials - None will be used.
7. Methods for Handling Waste Disposal - Any waste material incurred while drilling will be buried in the mud pits.
8. Ancillary Facilities - Will use existing Central Bisti Unit facilities.
9. Well Site Layout - Refer to plat attached.
10. Plans for Restoration of Surface - Area in the vicinity of well site is primarily sand. Very little of the well site area will be disturbed.
11. Other Information - Refer to Archaeological Report to be submitted to USGS.
12. Leasee's or Operator's Representative -

Aldrich L. Kuchera
Telephone - 325-6984 - Office
 - 325-3448 - Home
 - 325-1873 - Unit 675 Car Telephone
13. See Attached

HIXON DEVELOPMENT COMPANY

PROJECT HIXON FEDERAL NO. 1

JOB NO. _____

PURPOSE DRILLING SITE

SHEET _____ OF _____





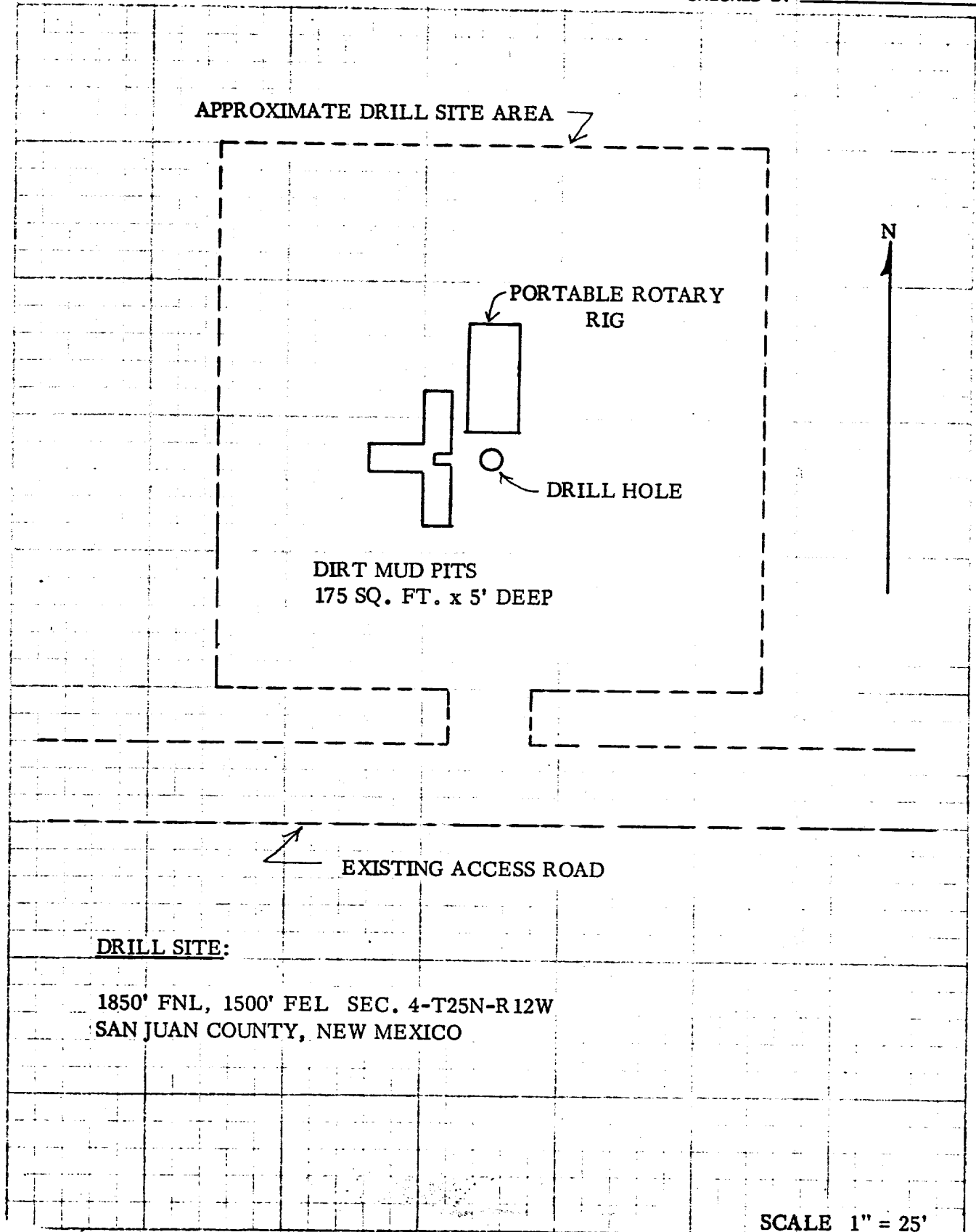

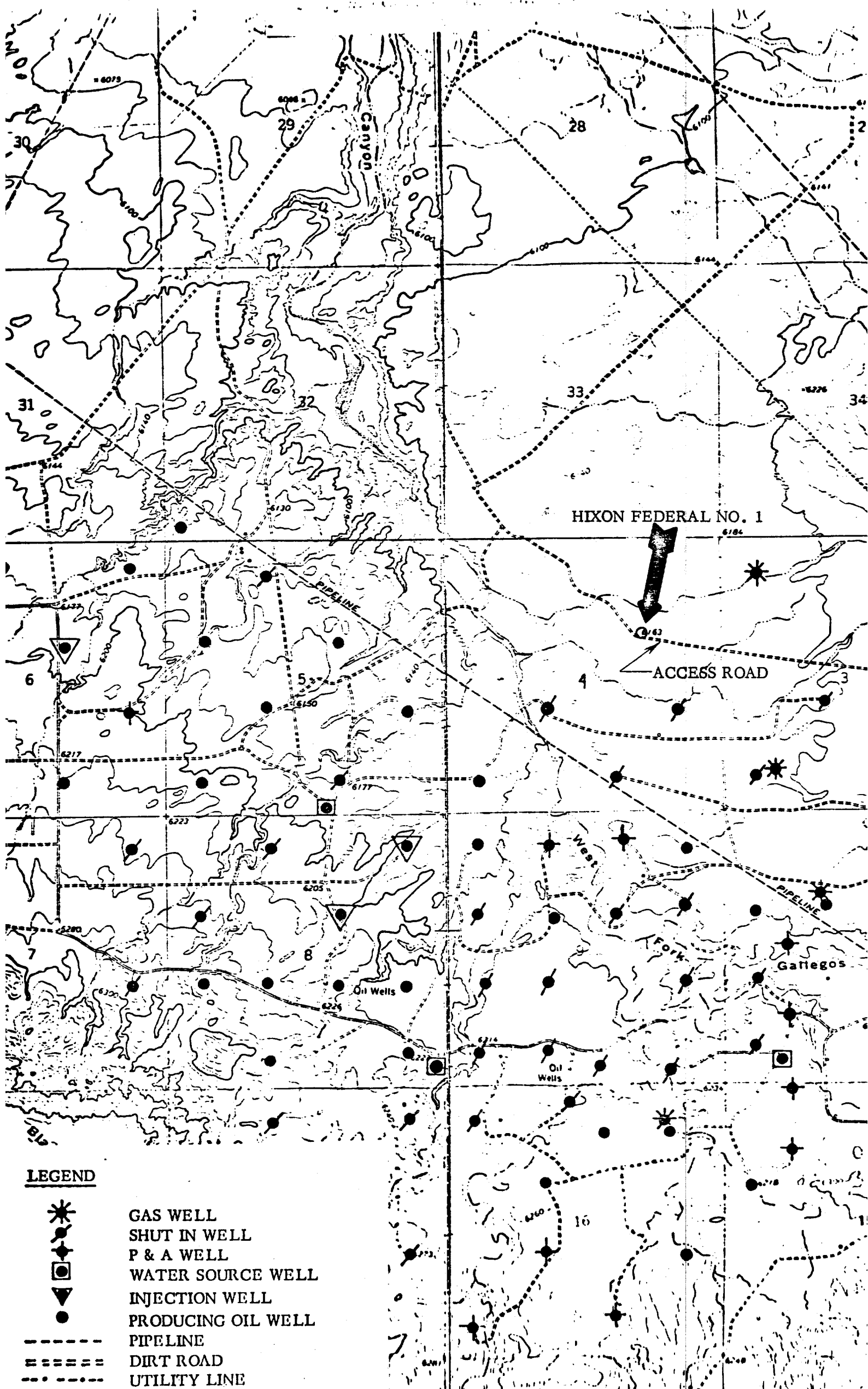

COMPUTED BY ALK

CHECKED BY _____



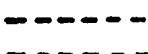
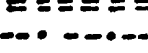

LEGEND

-  GAS WELL
-  SHUT IN WELL
-  P & A WELL
-  WATER SOURCE WELL
-  INJECTION WELL
-  PRODUCING OIL WELL
-  PIPELINE
-  DIRT ROAD
-  UTILITY LINE

HIXON DEVELOPMENT COMPANY

P.O. BOX 2810

FARMINGTON, NEW MEXICO 87401

September 21, 1977

CERTIFICATION

I hereby certify that I, or persons under my direct supervision, have inspected the proposed drill site and access route; that I am familiar with the conditions which presently exist; that the statements made in this plan are, to the best of my knowledge, true and correct; and, that the work associated with the operations proposed herein will be performed by Hixon Development Company and its contractors and subcontractors in conformity with this plan and the terms and conditions under which it is approved.

9/21/77

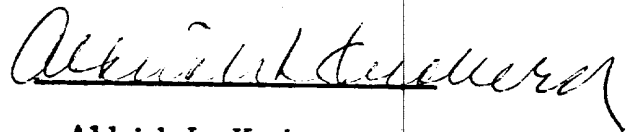

**Aldrich L. Kuchera
Production Manager
and Petroleum Engineer**

ALK:km