

Hixon Development Company

BLACK HILL MESA
NM-25445 SF-078058

Section	Township	Range	County
6	25 North	12 West	San Juan

Actual Footage Location of Well:

1650	feet from the North line and	1650	feet from the East line
Ground Level Elev.	Producing Formation	Pool	Dedicated Acreage:
6264	Lower Gallup	Bisti Lower Gallup	80

1. Outline the acreage dedicated to the subject well by colored pencil or hachure marks on the plat below.
2. If more than one lease is dedicated to the well, outline each and identify the ownership thereof (both as to working interest and royalty).
3. If more than one lease of different ownership is dedicated to the well, have the interests of all owners been consolidated by communitization, unitization, force-pooling, etc?

☒ Yes ☐ No If answer is "yes," type of consolidation Communitization Agreement

If answer is "no," list the owners and tract descriptions which have actually been consolidated. (Use reverse side of this form if necessary.)

No allowable will be assigned to the well until all interests have been consolidated (by communitization, unitization, forced-pooling, or otherwise) or until a non-standard unit, eliminating such interests, has been approved by the Commission.

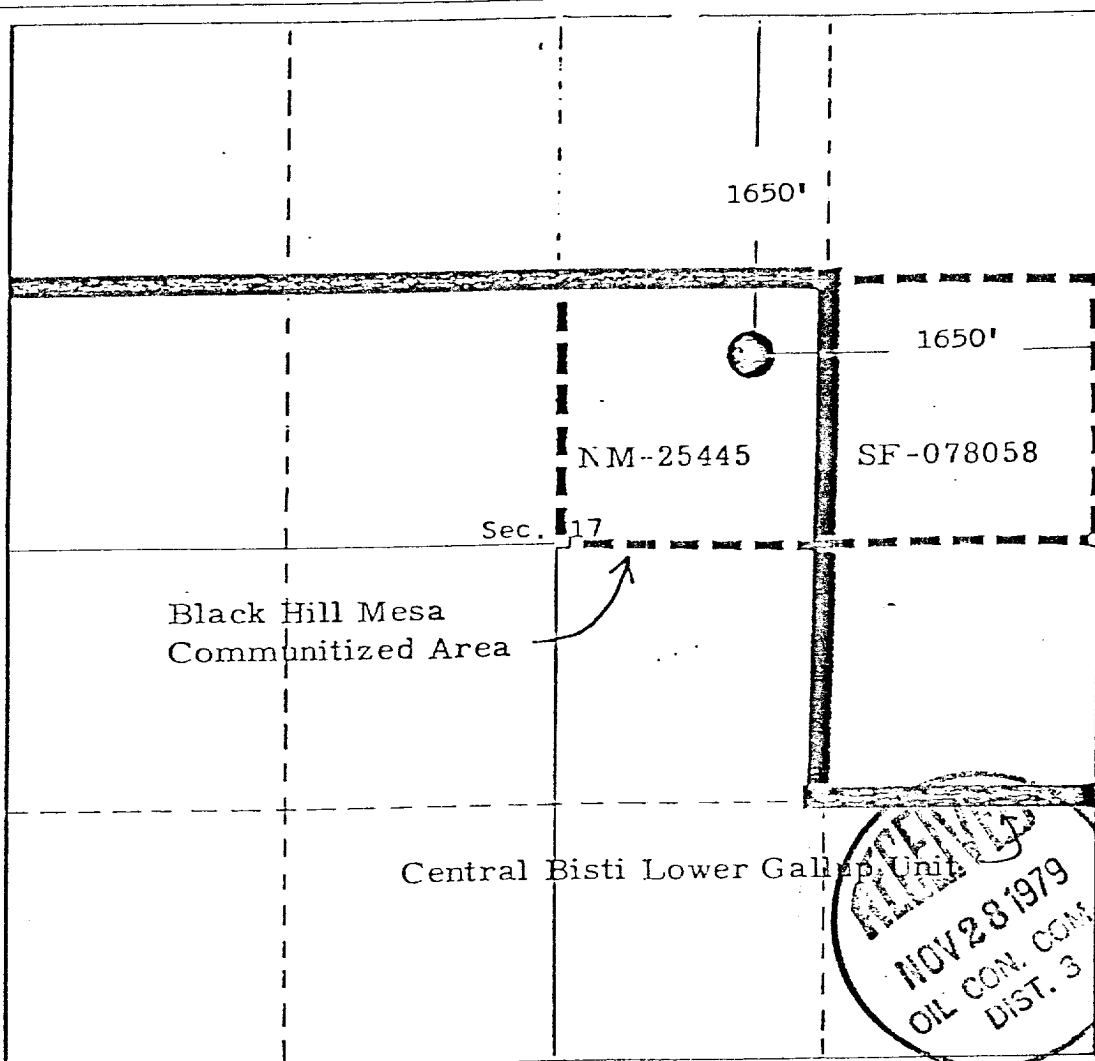

CERTIFICATION

I hereby certify that the information contained herein is true and complete to the best of my knowledge and belief.

Aldrich L. Kuchera
Name

Aldrich L. Kuchera

Petroleum Engineer

Hixon Development Co.

October 31st, 1978

I hereby certify that the location shown on this plat was plotted from field notes actual surveys made by me or under supervision, and that the same is true and correct to the best of my knowledge and belief.

October 27, 1978

Registered Professional Engineer and/or Land Surveyor

Edgar L. Risenhoover
Certificate No. 5979

Edgar L. Risenhoover, L.S.

NOV 28 1979
OIL CON. COM.
DIST. 3