

UNITED STATES
DEPARTMENT OF THE INTERIOR
GEOLOGICAL SURVEY30-095-2326-3
5. LEASE DESIGNATION AND SERIAL NO.

NM-25449

6. IF INDIAN, ALLOTTEE OR TRIBE NAME

7. UNIT AGREEMENT NAME

8. FARM OR LEASE NAME

Hunter Wash

9. WELL NO.

1

10. FIELD AND POOL, OR WILDCAT

Bisti Lower Gallup ext

11. SEC., T., R., M., OR BLK.
AND SURVEY OR AREA

Sec. 22-T25N-R12W

12. COUNTY OR PARISH 13. STATE

San Juan

NM

APPLICATION FOR PERMIT TO DRILL, DEEPEN, OR PLUG BACK

12. TYPE OF WORK

DRILL ☒DEEPEN ☐PLUG BACK ☐

13. TYPE OF WELL

OIL
WELL ☒GAS
WELL ☐

OTHER

SINGLE
ZONE ☒MULTIPLE
ZONE ☐

2. NAME OF OPERATOR

Hixon Development Company

3. ADDRESS OF OPERATOR

P.O. Box 2810, Farmington, NM 87401

4. LOCATION OF WELL (Report location clearly and in accordance with any State requirements.)

At surface

E 2250' FNL, 330' FWL Section 22-T25N-R12W

At proposed prod. zone

14. DISTANCE IN MILES AND DIRECTION FROM NEAREST TOWN OR POST OFFICE*

26 miles from Farmington

15. DISTANCE FROM PROPOSED*

LOCATION TO NEAREST
PROPERTY OR LEASE LINE, FT.
(Also to nearest drig. unit line, if any)

16. NO. OF ACRES IN LEASE

440

18. DISTANCE FROM PROPOSED LOCATION*
TO NEAREST WELL, DRILLING, COMPLETED,
OR APPLIED FOR, ON THIS LEASE, FT.

19. PROPOSED DEPTH

5000'

17. NO. OF ACRES ASSIGNED
TO THIS WELL

40

20. ROTARY OR CABLE TOOLS

rotary

21. ELEVATIONS (Show whether DF, RT, GR, etc.)

22. APPROX. DATE WORK WILL START*

1-2-79

23.

PROPOSED CASING AND CEMENTING PROGRAM

SIZE OF HOLE	SIZE OF CASING	WEIGHT PER FOOT	SETTING DEPTH	QUANTITY OF CEMENT
12-1/4"	8-5/8"	24#	200'	200 sacks
7-7/8"	4-1/2"	9.5#	TD	300 sacks

It is proposed to drill a Bisti Lower Gallup pool step-out well. The well will offset the Central Bisti Lower Gallup Unit and the Carson Lower Gallup Unit and will serve the purpose of delineating the reservoir. It will be evaluated on the basis of open hole logs, and perforated, fraced and put on pump into separate oil treating and storage facilities.

IN ABOVE SPACE DESCRIBE PROPOSED PROGRAM: If proposal is to deepen or plug back, give data on present productive zone and proposed new productive zone. If proposal is to drill or deepen directionally, give pertinent data on subsurface locations and measured and true vertical depths. Give blowout preventer program, if any.

24.

SIGNED

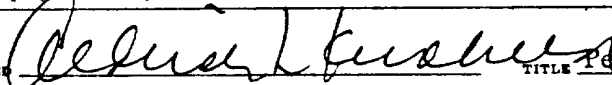

TITLE Petroleum Engineer

DATE October 31, 1978

(This space for Federal or State office use)

PERMIT NO.

APPROVAL DATE

APPROVED BY

TITLE

DATE

CONDITIONS OF APPROVAL, IF ANY:

Wab 100 per ok Frank
80 mag. bit

*See Instructions On Reverse Side

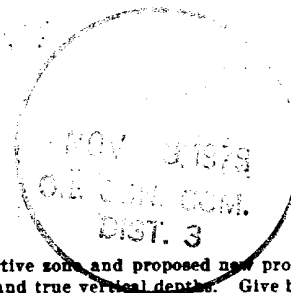

NEW MEXICO OIL CONSERVATION COMMISSION
WELL LOCATION AND ACREAGE DEDICATION PLAT

Form C-102
Supersedes C-128
Effective 1-1-65

All distances must be from the outer boundaries of the Section.

Operator Hixon Development Company		Lease Hunter Wash NM-25449		Well No. Hunter Wash #1
Unit Letter E	Section 22	Township 25 North	Range 12 West	County San Juan
Actual Footage Location of Well: 2250 feet from the North line and 330 feet from the West line				
Ground Level Elev. 6376	Producing Formation Lower Gallup	Pool Bisti Lower Gallup ext	Dedicated Acreage: 40 - Acres	

1. Outline the acreage dedicated to the subject well by colored pencil or hatchure marks on the plat below.

2. If more than one lease is dedicated to the well, outline each and identify the ownership thereof (both as to working interest and royalty).

3. If more than one lease of different ownership is dedicated to the well, have the interests of all owners been consolidated by communitization, unitization, force-pooling, etc?

☐ Yes ☒ No If answer is "yes," type of consolidation _____

If answer is "no," list the owners and tract descriptions which have actually been consolidated. (Use reverse side of this form if necessary.) one owner lease

No allowable will be assigned to the well until all interests have been consolidated (by communitization, unitization, forced-pooling, or otherwise) or until a non-standard unit, eliminating such interests, has been approved by the Commission.

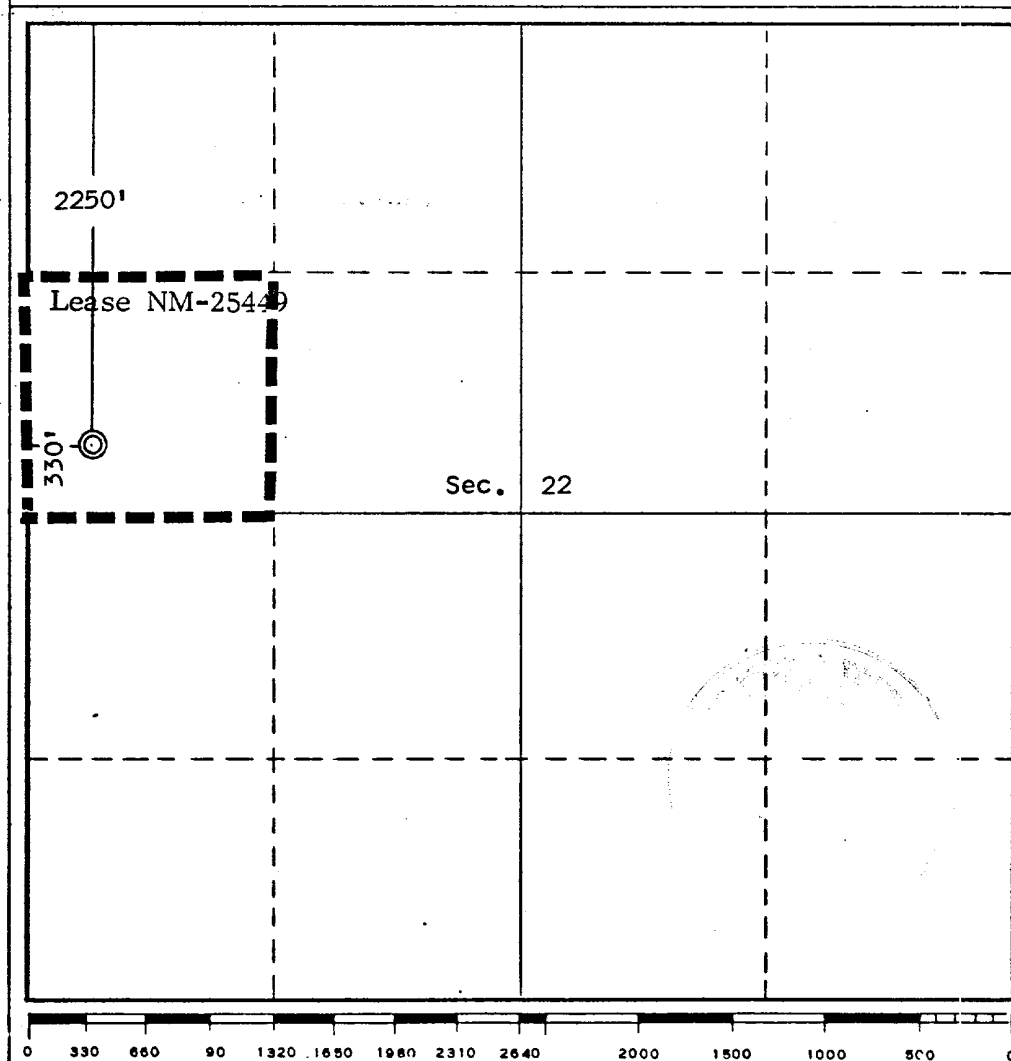

CERTIFICATION

I hereby certify that the information contained herein is true and complete to the best of my knowledge and belief.

Aldrich L. Kuchera
Name
Aldrich L. Kuchera

Position
Petroleum Engineer

Company
Hixon Development Co.

Date
November 2, 1978

I hereby certify that the information shown on this plat was plotted from field notes of actual surveys made by me or under my supervision and that the same is true and correct to the best of my knowledge and belief.

Edgar L. Risenhoover
Date Surveyed
October 27, 1978

Registered Professional Engineer
and/or Land Surveyor

Edgar L. Risenhoover
Certificate No. **5979**
Edgar L. Risenhoover

Application for Permit to Drill
Hixon Development Company
Hunter Wash No. 1
Bisti Lower Gallup Field
SW 1/4 of NW 1/4, Section 22-T25N-R12W
San Juan County, New Mexico

Recap of NTL-6 13-Point Outline is as follows:

1. Existing Roads - Refer to attached topographic map. The proposed well site is located adjacent to an existing 25 year old oil field. The field has an extensive lease road system tied to State Highway 371, south of Farmington.
2. Planned Access Roads - An 800' road will be constructed to provide access to the subject well per the attached topographic map. The proposed road will run due north and will consist of compacted sand with a maximum 2% grade. It will follow an existing fence right-of-way and be about 25' wide.
3. Location of Existing Wells - Refer to attached map.
4. Location of Tank Batteries, Production Facilities, and etc. - The proposed well is located in the vicinity of an extensive oil and gas flowline and water injection system. A 2" flowline for the proposed well would run west to a flowline manifold at CBU Well No. 51 or to a new tank battery located in Section 16-T25N-R12W.
5. Location and Type of Water Supply - Will not be necessary. Any water used for workover purposes will be hauled in from a source well in Section 5 or from Farmington.
6. Source of Construction Materials - Materials necessary for the construction of the access road and drilling pad will be obtained from the location.
7. Methods for Handling Waste Disposal - Any waste material incurred while drilling will be buried in the mud pits.
8. Ancillary Facilities - Will use existing Central Bisti Unit facilities.
9. Well Site Layout - Refer to attached plat.
10. Plans for Restoration of Surface - Area in the vicinity of the well site is primarily sand. Very little of the well site area will be disturbed.
11. Other Information - Refer to Archaeological Report to be submitted to the USGS.
12. See Attached.

Application for Permit to Drill
Hixon Development Company
Hunter Wash Well No. 1
Bisti Lower Gallup Field
SW 1/4 of NW 1/4, Section 22-T25N-R12W
San Juan County, New Mexico
Page 2

13. Leasee's or Operator's Representative -

Aldrich L Kuchera		
Telephone	325-6984	Office
	325-3448	Home
	325-1873	Unit #675 Car Telephone

Application for Permit to Drill
Hixon Development Company
Hunter Wash Well No. 1
Bisti Lower Gallup Field
SW 1/4 of NW 1/4, Section 22-T25N-R12W
San Juan County, New Mexico

Other NTL-6 pertinent data is as follows:

1. Estimated Log Tops:

Animas	Surface
Ojo Alamo	143'
Pictured Cliff	1202'
Lewis	1357'
Point Lookout	3607'
Mancos	3817'
Gallup	4717'
Lower Gallup	4792'

2. Estimated depths of water, oil and gas:

Fresh Water	143'-193'
Gas	1202'-1222'
Oil and Gas	4717'-TD

3. Weight and type of mud to be used - 9.0#-9.3#/gallon mud from below surface with low fluid loss - additives used across permeable zones.

4. Open hole logs to be used:

Induction Electric
Compensated Neutron - Density

5. Pressure control equipment will be a 10" Shaffer 3000 WP hydraulic BOP stack per the attached inventory sheet. Surface casing will be tested to 750 psi for 30 minutes prior drilling out cement. Production casing will be tested to 1000 psi for 30 minutes prior perforating.

6. On the basis of offset drilling data we do not foresee any drilling hazards such as high pressure gas zones, high temperatures, sour gas or other abnormal deviations.

7. Surface 8-5/8" 24# J-55 ST&C and production 4-1/2" 9.5# J-55 ST&C casing will be new and tested at the factory. Regular Class B cement will be used for the surface casing. Production casing will be cemented with Class B cement with 10# gilsonite per sack and 2% CaCl.

8. Duration of drilling activity from spud date to completion is expected to be about 15 days.

9. In the event that the well is a dry hole it will be plugged with prior USGS approval and the drilling site restored to its natural state.

HIXON DEVELOPMENT COMPANY

P. O. BOX 2810

FARMINGTON, NEW MEXICO 87401

October 31, 1978

CERTIFICATION

I, hereby certify that I, or persons under my direct supervision, have inspected the proposed drill site and access route; that I am familiar with the conditions which presently exist; that the statements made in this plan are, to the best of my knowledge, are true and correct; and, that the work associated with the operations proposed herein will be performed by Hixon Development Company and its contractors and subcontractors in conformity with this plan and the terms and conditions under which it is approved.

11/2/78

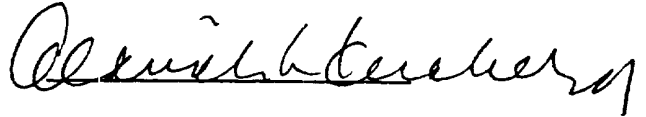

Aldrich L. Kuchera
Production Manager
Petroleum Engineer

ALK:dl

HIXON DEVELOPMENT COMPANY
DRILLING LOCATION PLAT AND RIG LAYOUT

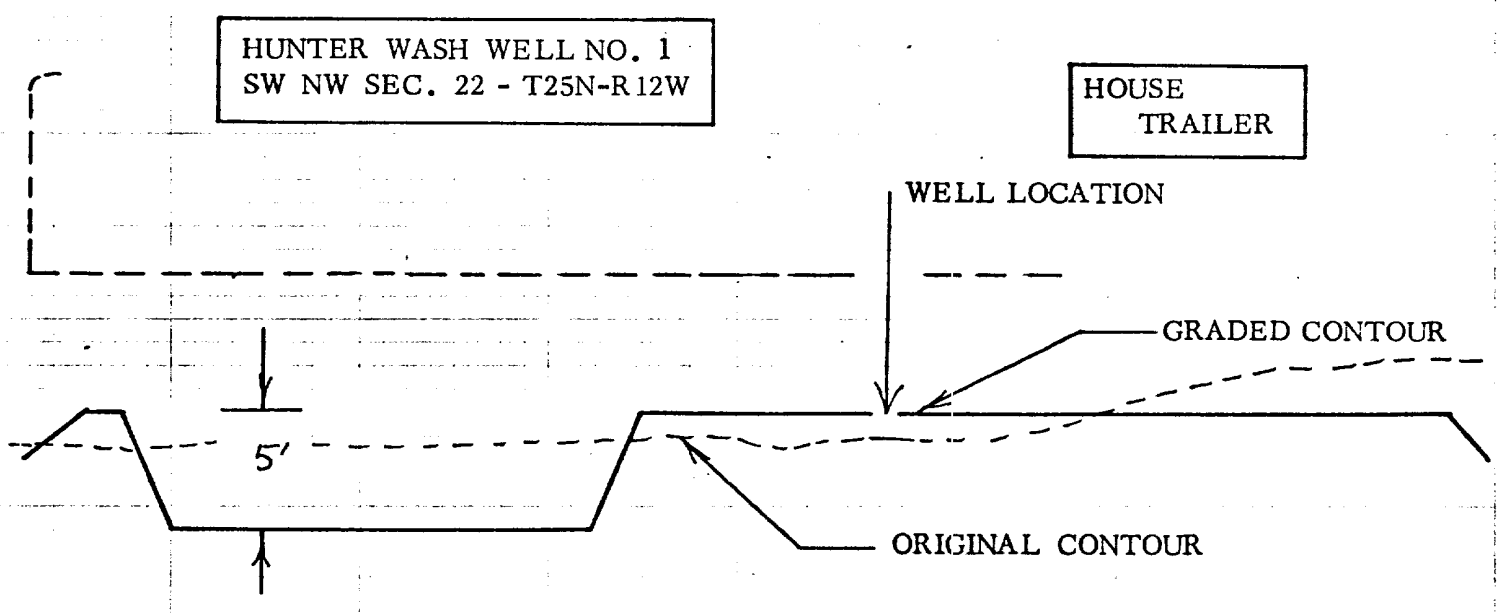
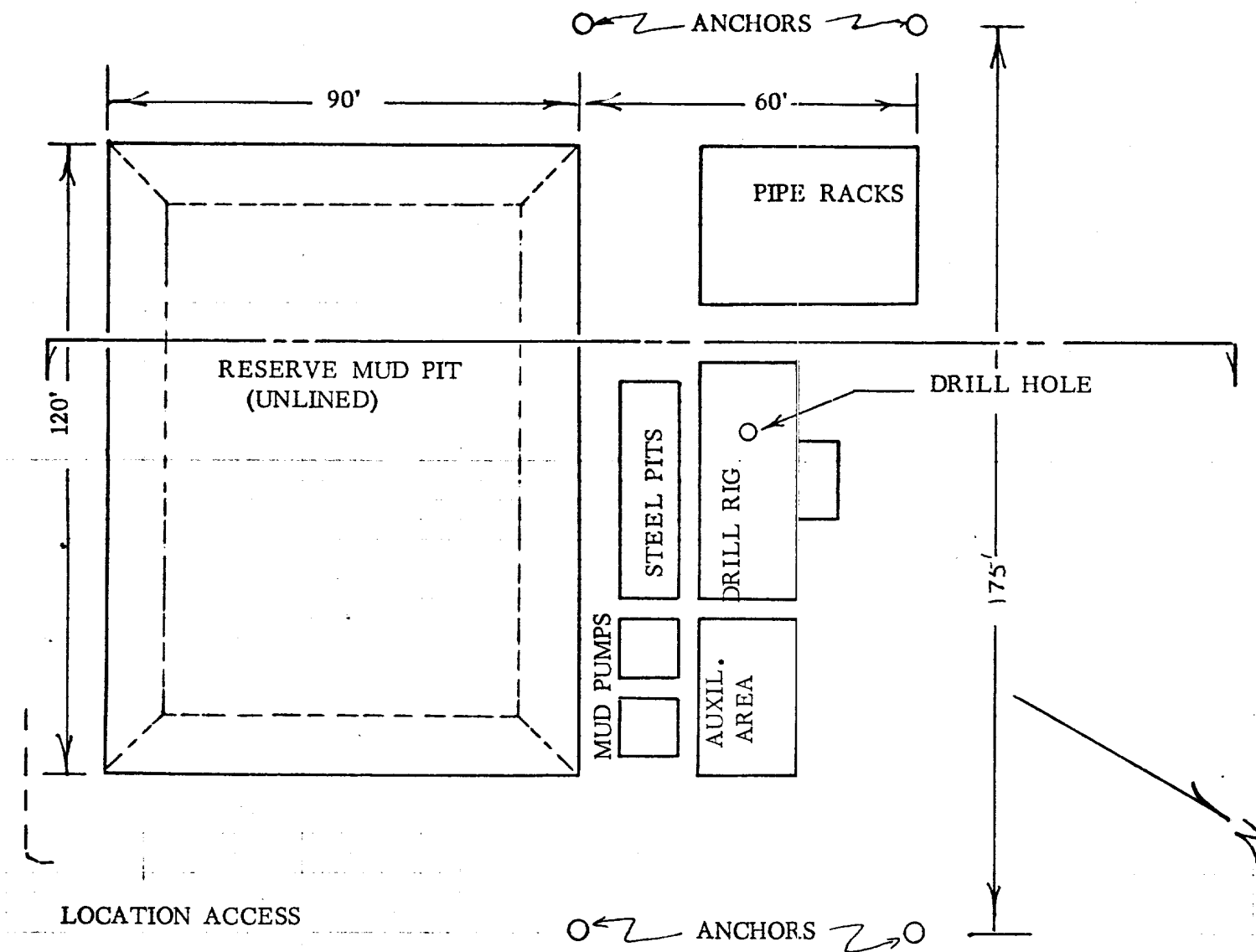

R 13 W R 12 W

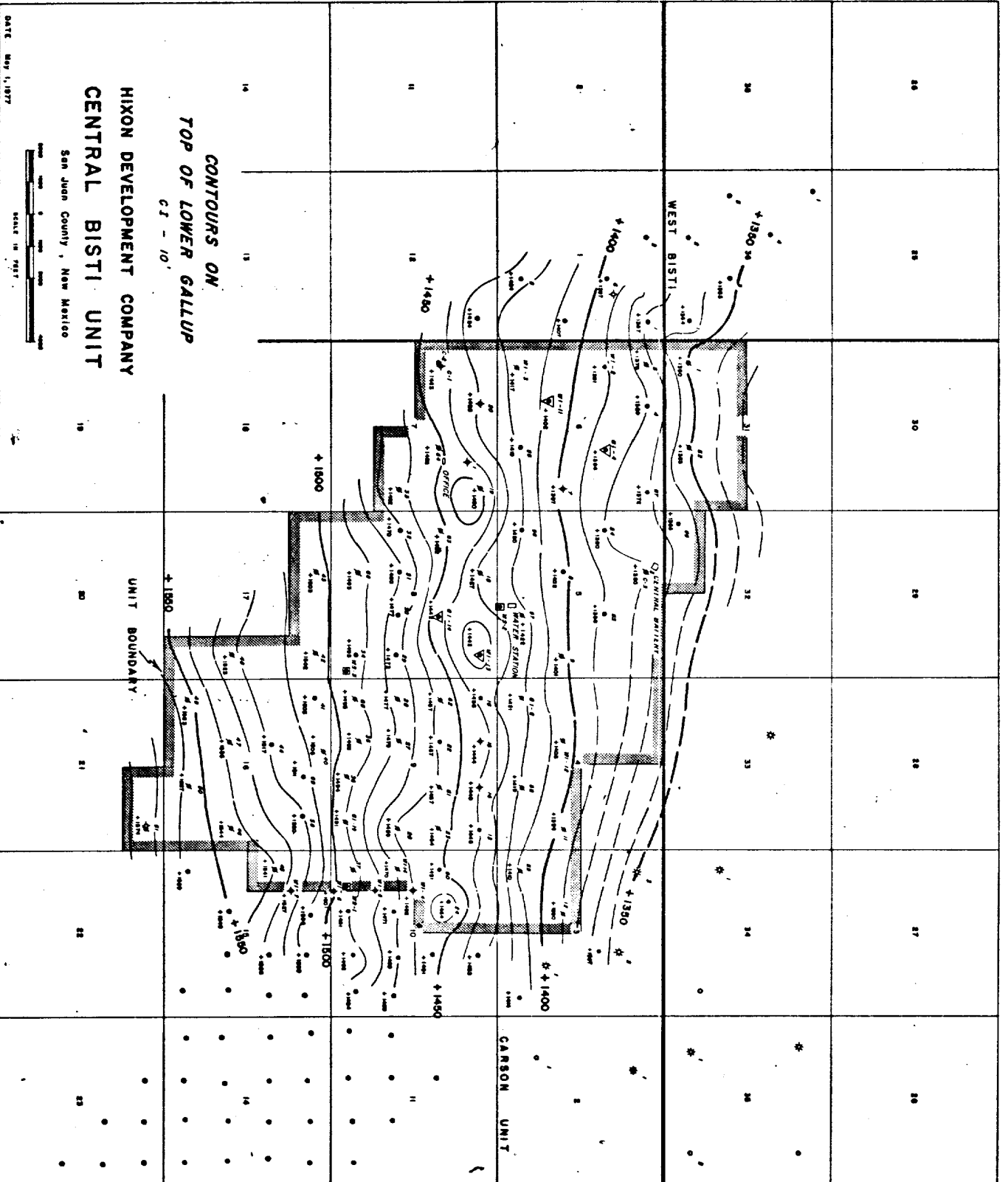

CONTOURS ON
TOP OF LOWER GALLUP
C-1 - 10'

HIXON DEVELOPMENT COMPANY
CENTRAL BISTI UNIT
San Juan County, New Mexico

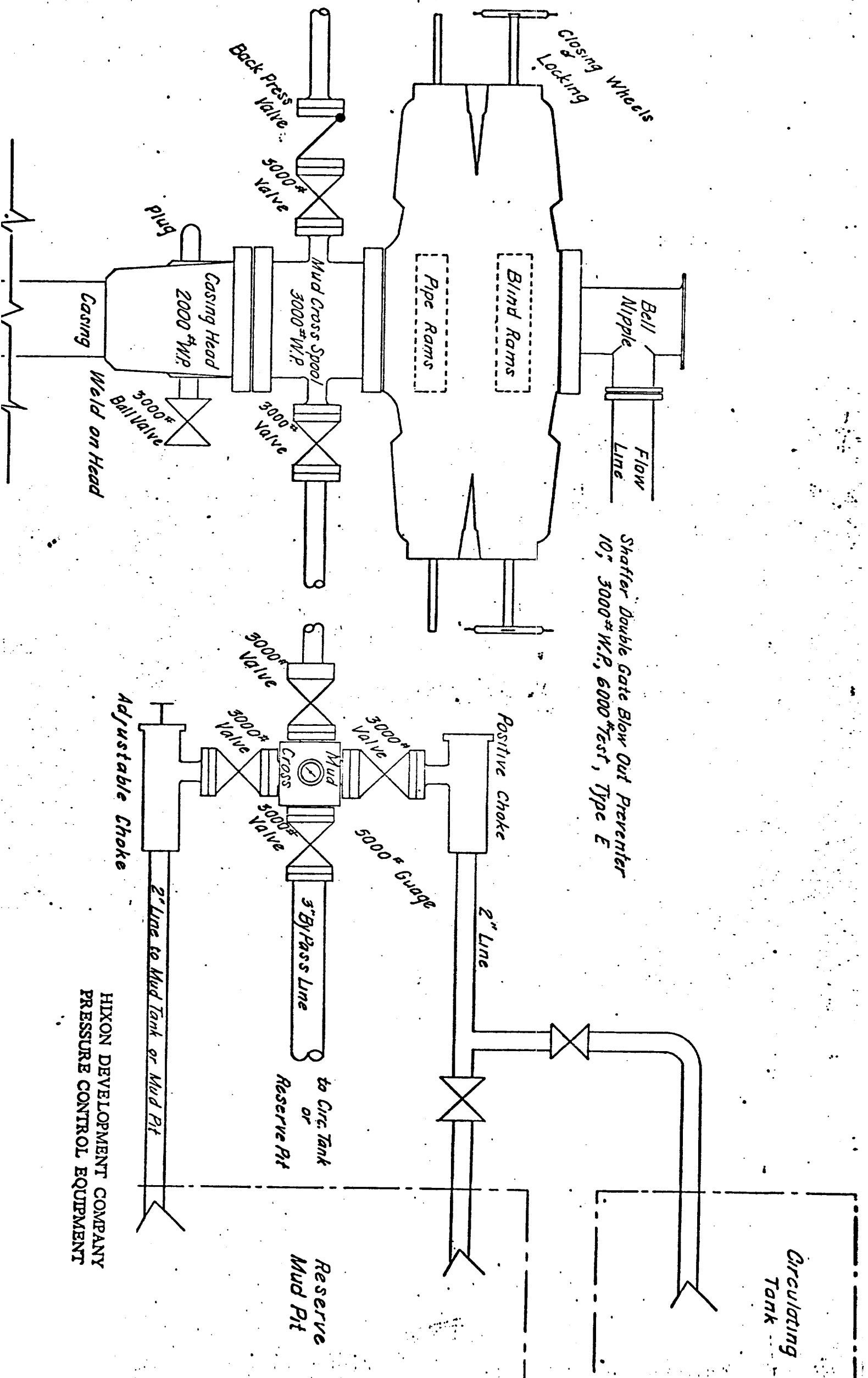

HIXON DEVELOPMENT COMPANY
 PRESSURE CONTROL EQUIPMENT

N MEXICO OIL CONSERVATION COMMISS.
WELL LOCATION AND ACREAGE DEDICATION PLAT

Form C-102
Supersedes C-128
Effective 1-1-65

All distances must be from the outer boundaries of the Section.

Operator Hixon Development Company			Lease Hunter Wash (NM-25449)		Well No. Hunter Wash #1
Unit Letter E	Section 22	Township 25 North	Range 12 West	County San Juan	
Actual Footage Location of Well: 2250 feet from the North line and 330 feet from the West line					
Ground Level Elev. 6376	Producing Formation Lower Gallup		Pool Bisti Lower Gallup		Dedicated Acreage: 80 Acres

1. Outline the acreage dedicated to the subject well by colored pencil or hatchure marks on the plat below.
2. If more than one lease is dedicated to the well, outline each and identify the ownership thereof (both as to working interest and royalty).
3. If more than one lease of different ownership is dedicated to the well, have the interests of all owners been consolidated by communitization, unitization, force-pooling, etc?

☐ Yes ☒ No If answer is "yes," type of consolidation _____

If answer is "no," list the owners and tract descriptions which have actually been consolidated. (Use reverse side of this form if necessary.) one owner lease

No allowable will be assigned to the well until all interests have been consolidated (by communitization, unitization, forced-pooling, or otherwise) or until a non-standard unit, eliminating such interests, has been approved by the Commission.

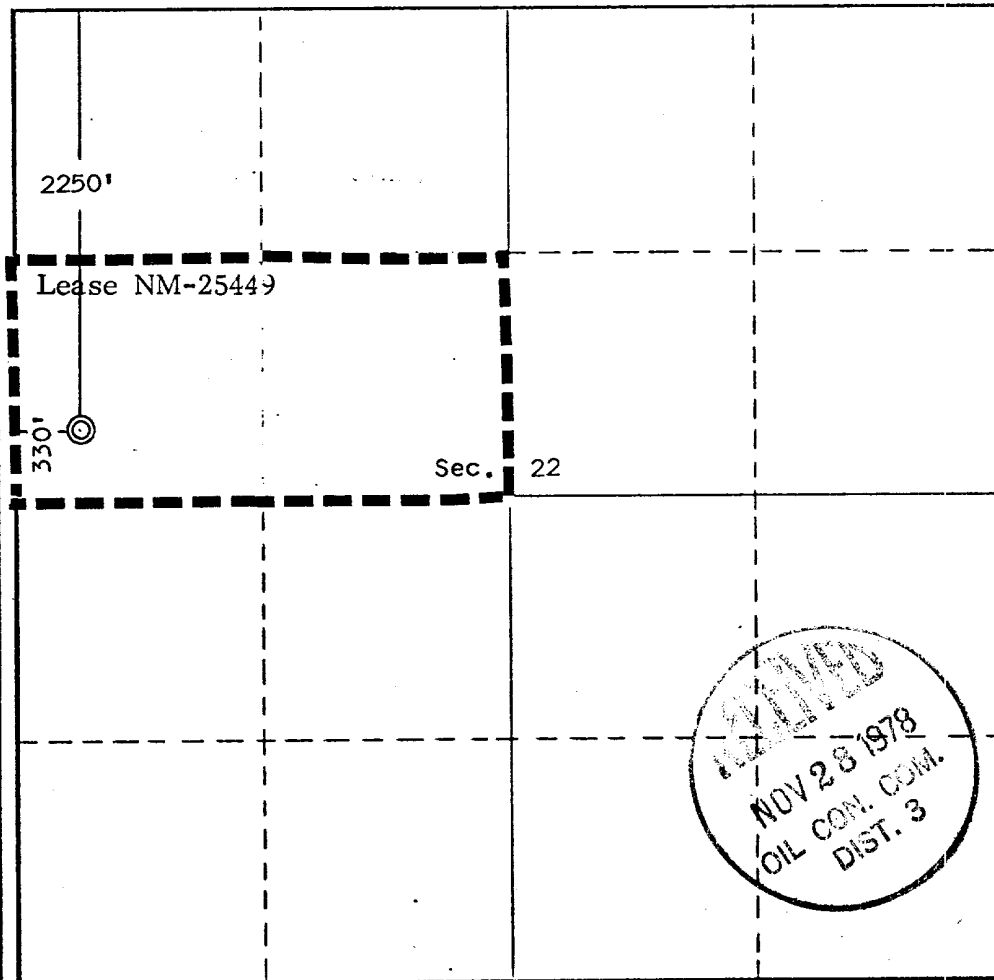

CERTIFICATION

I hereby certify that the information contained herein is true and complete to the best of my knowledge and belief.

Aldrich L. Kuchera
Name

Aldrich L. Kuchera

Position

Petroleum Engineer

Company

Hixon Development Co.

Date

November 2, 1978

I hereby certify that the information shown on this plat was plotted from field notes of actual surveys made by me or under my supervision and that the same is true and correct to the best of my knowledge and belief.

Date Surveyed

October 27, 1978

Registered Professional Engineer
and/or Land Surveyor

Edgar L. Risenhoover

Certificate No. **5979**

Edgar L. Risenhoover

0 330 660 990 1320 1650 1980 2310 2640 2000 1500 1000 500 0

UNITED STATES
DEPARTMENT OF THE INTERIOR
GEOLOGICAL SURVEY

SUBMIT IN TRIPLICATE*
(Other instructions on re-
verse side)

Form approved.
Budget Bureau No. 42-R1424.

SUNDRY NOTICES AND REPORTS ON WELLS

(Do not use this form for proposals to drill or to deepen or plug back to a different reservoir.
Use "APPLICATION FOR PERMIT—" for such proposals.)

1. OIL WELL <input checked="" type="checkbox"/> GAS WELL <input type="checkbox"/> OTHER <input type="checkbox"/>		5. LEASE DESIGNATION AND SERIAL NO. NM 25449
2. NAME OF OPERATOR Hixon Development Company		6. IF INDIAN, ALLOTTEE OR TRIBE NAME
3. ADDRESS OF OPERATOR P.O. Box 2810, Farmington, New Mexico 87401		7. UNIT AGREEMENT NAME
4. LOCATION OF WELL (Report location clearly and in accordance with any State requirements.* See also space 17 below.) At surface 2250' FNL, 330' FWL, Section 22-T25N-R12W		8. FARM OR LEASE NAME Hunter Wash
14. PERMIT NO.		9. WELL NO. 1
15. ELEVATIONS (Show whether DF, RT, GR, etc.) 6376'		10. FIELD AND POOL, OR WILDCAT Bisti Lower Gallup
		11. SEC., T., R., M., OR BLK. AND SURVEY OR AREA Section 22-25N-12W
		12. COUNTY OR PARISH San Juan
		13. STATE NM

16. Check Appropriate Box To Indicate Nature of Notice, Report, or Other Data

NOTICE OF INTENTION TO:

TEST WATER SHUT-OFF <input type="checkbox"/>	PULL OR ALTER CASING <input type="checkbox"/>
FRACTURE TREAT <input type="checkbox"/>	MULTIPLE COMPLETE <input type="checkbox"/>
SHOOT OR ACIDIZE <input type="checkbox"/>	ABANDON* <input type="checkbox"/>
REPAIR WELL <input type="checkbox"/>	CHANGE PLANS <input type="checkbox"/>
(Other) Acquire a 6-month extension <input checked="" type="checkbox"/>	

SUBSEQUENT REPORT OF:

WATER SHUT-OFF <input type="checkbox"/>	REPAIRING WELL <input type="checkbox"/>
FRACTURE TREATMENT <input type="checkbox"/>	ALTERING CASING <input type="checkbox"/>
SHOOTING OR ACIDIZING <input type="checkbox"/>	ABANDONMENT* <input type="checkbox"/>
(Other) <input type="checkbox"/>	
(NOTE: Report results of multiple completion on Well Completion or Recompletion Report and Log form.)	

17. DESCRIBE PROPOSED OR COMPLETED OPERATIONS (Clearly state all pertinent details, and give pertinent dates, including estimated date of starting any proposed work. If well is directionally drilled, give subsurface locations and measured and true vertical depths for all markers and zones pertinent to this work.)*

We request a six-month extension of time for the above described well.
This is for the purpose of drilling rig scheduling.

Extended to September 15, 1980, and will automatically expire at the end of the six month period

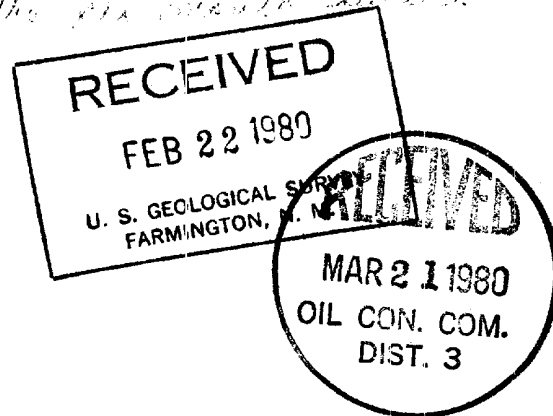

18. I hereby certify that the foregoing is true and correct

SIGNED William C. Turner TITLE Petroleum Engineer

DATE 2-15-80

(This space for Federal or State office use)

APPROVED BY ok Frank TITLE NMOCG
CONDITIONS OF APPROVAL, IF ANY:

*See Instructions on Reverse Side

APPROVED

MAR 20 1980
JAMES F. SIMS
DISTRICT OIL & GAS SUPERVISOR