

UNITED STATES  
DEPARTMENT OF THE INTERIOR  
GEOLOGICAL SURVEY

## APPLICATION FOR PERMIT TO DRILL, DEEPEN, OR PLUG BACK

## 1a. TYPE OF WORK

DRILL ☒DEEPEN ☐PLUG BACK ☐

## b. TYPE OF WELL

OIL  
WELL ☐GAS  
WELL ☒

OTHER

SINGLE  
ZONE ☒MULTIPLE  
ZONE ☐

## 2. NAME OF OPERATOR

Hixon Development Company

## 3. ADDRESS OF OPERATOR

P.O. Box 2810, Farmington, NM 87401

## 4. LOCATION OF WELL (Report location clearly and in accordance with any State requirements.)

At surface

F 1850' FNL, 1850' FWL, Section 6-T25N-R12W  
At proposed prod. zone

## 14. DISTANCE IN MILES AND DIRECTION FROM NEAREST TOWN OR POST OFFICE\*

25 miles from Farmington

## 15. DISTANCE FROM PROPOSED\*

LOCATION TO NEAREST  
PROPERTY OR LEASE LINE, FT.  
(Also to nearest drig. unit line, if any)18. DISTANCE FROM PROPOSED LOCATION\*  
TO NEAREST WELL, DRILLING, COMPLETED,  
OR APPLIED FOR, ON THIS LEASE, FT.

## 16. NO. OF ACRES IN LEASE

## 19. PROPOSED DEPTH

800'

17. NO. OF ACRES ASSIGNED  
TO THIS WELL

160

## 20. ROTARY OR CABLE TOOLS

rotary

## 21. ELEVATIONS (Show whether DF, RT, GR, etc.)

6193 GL

## 23.

## PROPOSED CASING AND CEMENTING PROGRAM

SIZE OF HOLE	SIZE OF CASING	WEIGHT PER FOOT	SETTING DEPTH	QUANTITY OF CEMENT
7-7/8"	5-1/2"	15.5#	36'	10 sacks
4-3/4"	2-7/8"	6.5#	800'	100 sacks

It is proposed to drill a 4-3/4" slimhole to test the Farmington Sand formation. The hole will be drilled with a portable rotary rig using mud. Because of low anticipated bottom hole pressures a BOP will not be used. A master casing valve and stripper head will be used while completing the well. The well will be evaluated with open hole resistivity and porosity logs prior setting casing.

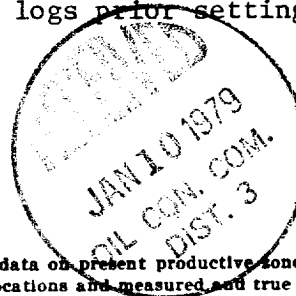
*gas not dedicated*

IN ABOVE SPACE DESCRIBE PROPOSED PROGRAM: If proposal is to deepen or plug back, give data on present productive zone and proposed new productive zone. If proposal is to drill or deepen directionally, give pertinent data on subsurface locations and measured and true vertical depths. Give blowout preventer program, if any.

## 24.

SIGNED

*[Signature]*

TITLE Petroleum Engineer

DATE January 4, 1979

(This space for Federal or State office use)

PERMIT NO.

APPROVAL DATE

APPROVED BY

TITLE

DATE

CONDITIONS OF APPROVAL, IF ANY:

*ok Enok*

\*See Instructions On Reverse Side

*ARMOSC*

**NEW MEXICO OIL CONSERVATION COMMISSION  
WELL LOCATION AND ACREAGE DEDICATION PLAT**

Form C-102  
Supersedes C-128  
Effective 1-1-65

All distances must be from the outer boundaries of the Section.

Operator <b>Hixon Development Company</b>			Lease <b>Federal "C"</b>		Well No. <b>5</b>
Unit Letter <b>F</b>	Section <b>6</b>	Township <b>25 North</b>	Range <b>12 West</b>	County <b>San Juan</b>	
Actual Footage Location of Well: <b>1850</b> feet from the <b>North</b> line and <b>1850</b> feet from the <b>West</b> line					
Ground Level Elev. <b>6193</b>	Producing Formation <b>Farmington Sand</b>	Pool <i>Walden</i>	Dedicated Acreage: <b>160</b> Acres		

1. Outline the acreage dedicated to the subject well by colored pencil or hachure marks on the plat below.
2. If more than one lease is dedicated to the well, outline each and identify the ownership thereof (both as to working interest and royalty).
3. If more than one lease of different ownership is dedicated to the well, have the interests of all owners been consolidated by communitization, unitization, force-pooling, etc?

☐ Yes ☒ No If answer is "yes," type of consolidation one owner lease

If answer is "no," list the owners and tract descriptions which have actually been consolidated. (Use reverse side of this form if necessary.) \_\_\_\_\_

No allowable will be assigned to the well until all interests have been consolidated (by communitization, unitization, forced-pooling, or otherwise) or until a non-standard unit, eliminating such interests, has been approved by the Commission.

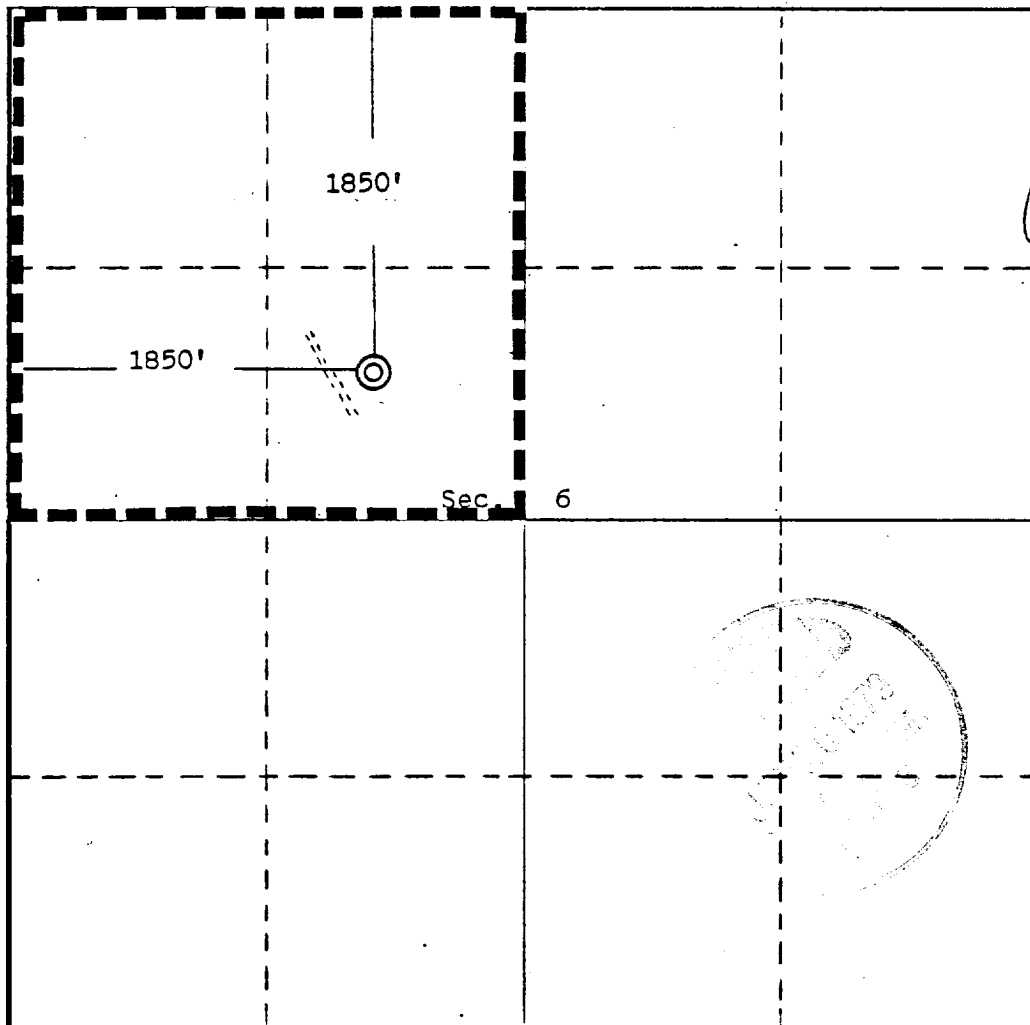

**CERTIFICATION**

I hereby certify that the information contained herein is true and complete to the best of my knowledge and belief.

*Aldrich L. Kuchera*  
Name

**Aldrich L. Kuchera**

Position

**Petroleum Engineer**

Company

**Hixon Development Co.**

Date

**January 5, 1979**

*Edgar L. Risenhoover*  
I hereby certify that the well location shown on this plat was plotted from field notes of actual surveys made by me or under my supervision, and that the same is true and correct to the best of my knowledge and belief.

Date Surveyed

**December 29, 1978**

Registered Professional Engineer and/or Land Surveyor

*Edgar L. Risenhoover*  
Certificate No. **5979**

**Edgar L. Risenhoover, L.S.**

Application for Permit to Drill  
Hixon Development Company  
Federal "C" Well No. 5  
1850' FNL, 1850' FWL  
Section 6-T25N-R12W  
San Juan County, New Mexico

Other NTL-6 pertinent data is as follows:

1. Estimated log tops:

Surface	McDermott
Ojo Alamo	20'
Kirtland	130'
TD	800'

2. Estimated depths of water, oil and gas:

Fresh water	20'-130'
Gas	270'-760'

3. Weight and type of mud to be used 9.0-9.3#/gallon mud from below surface with low fluid loss - additives used across permeable zone.

4. Open hole logs to be used:

Induction Electric  
Compensated Neutron - Density

5. Surface casing will be 36' 5-1/2" 15.5# K-55 ST&C. It will be cemented with 10 sacks Class B cement. Production casing will be 800' of 2-7/8" 6.5# K-55 EUE cemented with 100 sacks cement. It will be pressure tested to 1000 psi for 30 minutes prior perforating.

6. On the basis of offset drilling data we do not foresee any drilling hazards such as high pressure gas zones, high temperatures, sour gas or other abnormal deviations.

7. Surface 5-1/2" 15.5# K-55 ST&C and production 2-7/8" 6.5# K-55 casing will be new and tested at the factory.

8. Duration of drilling activity from spud date to completion is expected to be about 3 days.

9. In the event the well is a dry hole it will be plugged with prior USGS approval and the drill site restored.

Application for Permit to Drill  
Hixon Development Company  
Federal "C" Well No. 5  
1850' FNL, 1850' FWL  
NW/4 Section 6-T25N-R12W  
San Juan County, New Mexico







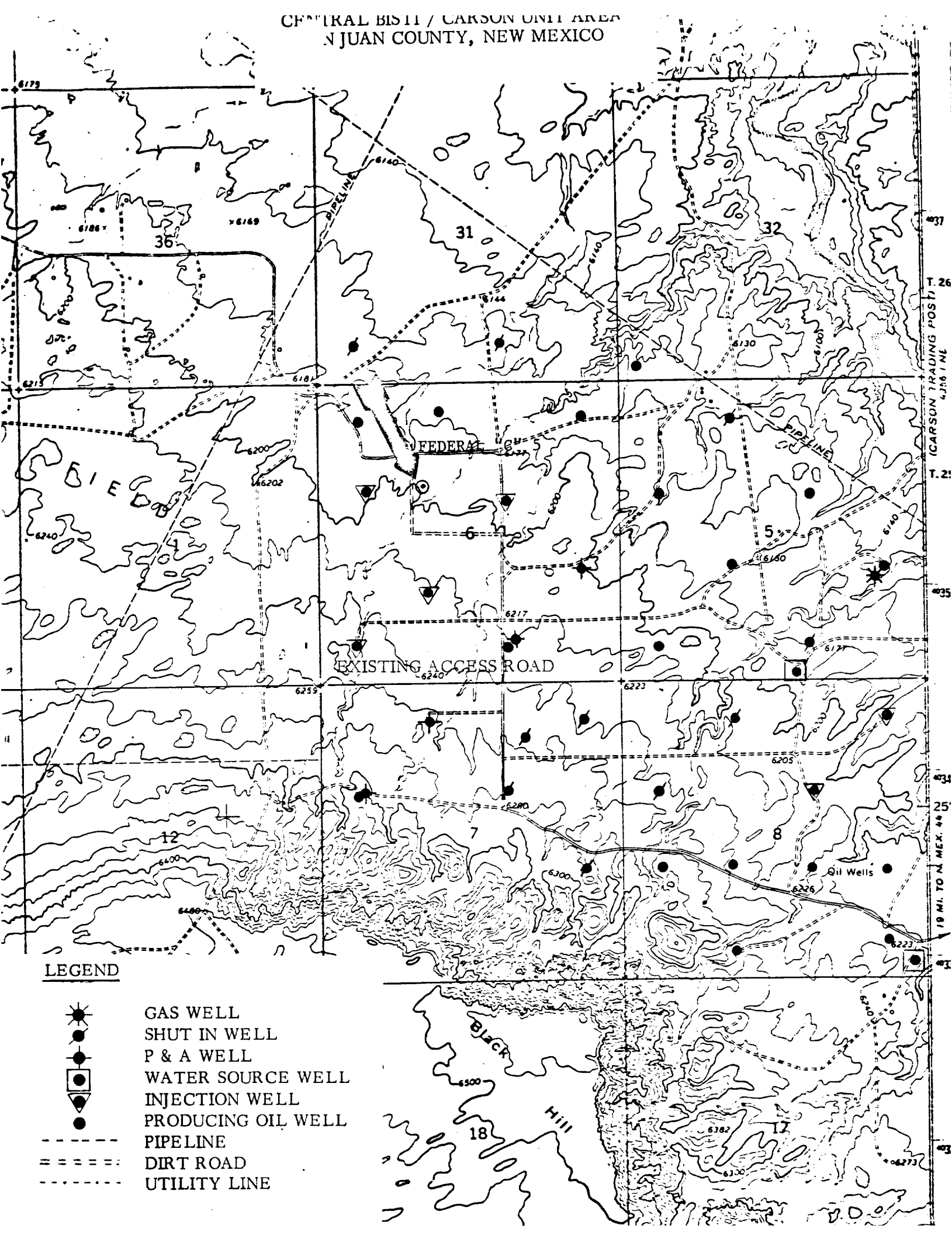

Recap of NTL-6 13-Point Outline is as follows:

1. Existing Roads - Refer to attached topographic map. The proposed well site is located inside an existing 25 year old oil field. The field has an extensive lease road system tied to State Highway 371 south of Farmington.
2. Planned Access Roads - Construction of an access road will not be necessary. Per the attached map, an access road already exists to this well site.
3. Location of Existing Wells - Refer to attached map.
4. Location of Tank Batteries, Production Facilities, etc. - The proposed well is located within an extensive oil and gas flowline and water injection system.
5. Location and Type of Water Supply - Will not be necessary. Any water used for workover purposes will be hauled in from a source well in Section 5, or from Farmington.
6. Source of Construction Materials - None will be used.
7. Methods for Handling Waste Disposal - Any waste material incurred while drilling will be buried in the mud pits.
8. Ancillary Facilities - Will use existing Central Bisti Unit facilities.
9. Well Site Layout - Refer to plat attached.
10. Plans for Restoration of Surface - Area in the vicinity of well site is primarily sand. Very little of the well site area will be disturbed.
11. Other Information - Refer to the Archaeological Report to be submitted to the USGS.
12. Leasee's or Operator's Representative -  
  
Aldrich L. Kuchera  
  
Telephone            325-6984      Office  
                         325-3448      Home  
                         325-1873      Unit #675    Car Telephone
13. See Attached

CENTRAL BISHOP / CARSON UNIT AREA  
SAN JUAN COUNTY, NEW MEXICO

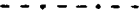

LEGEND

-  GAS WELL
-  SHUT IN WELL
-  P & A WELL
-  WATER SOURCE WELL
-  INJECTION WELL
-  PRODUCING OIL WELL
-  PIPELINE
-  DIRT ROAD
-  UTILITY LINE

HIXON DEVELOPMENT COMPANY  
DRILLING LOCATION PLAT  
FEDERAL "C" NO. 5

FEDERAL "C" WELL NO. 5  
1850' FWL, 1850' FNL  
Section 6-T25N-R12W

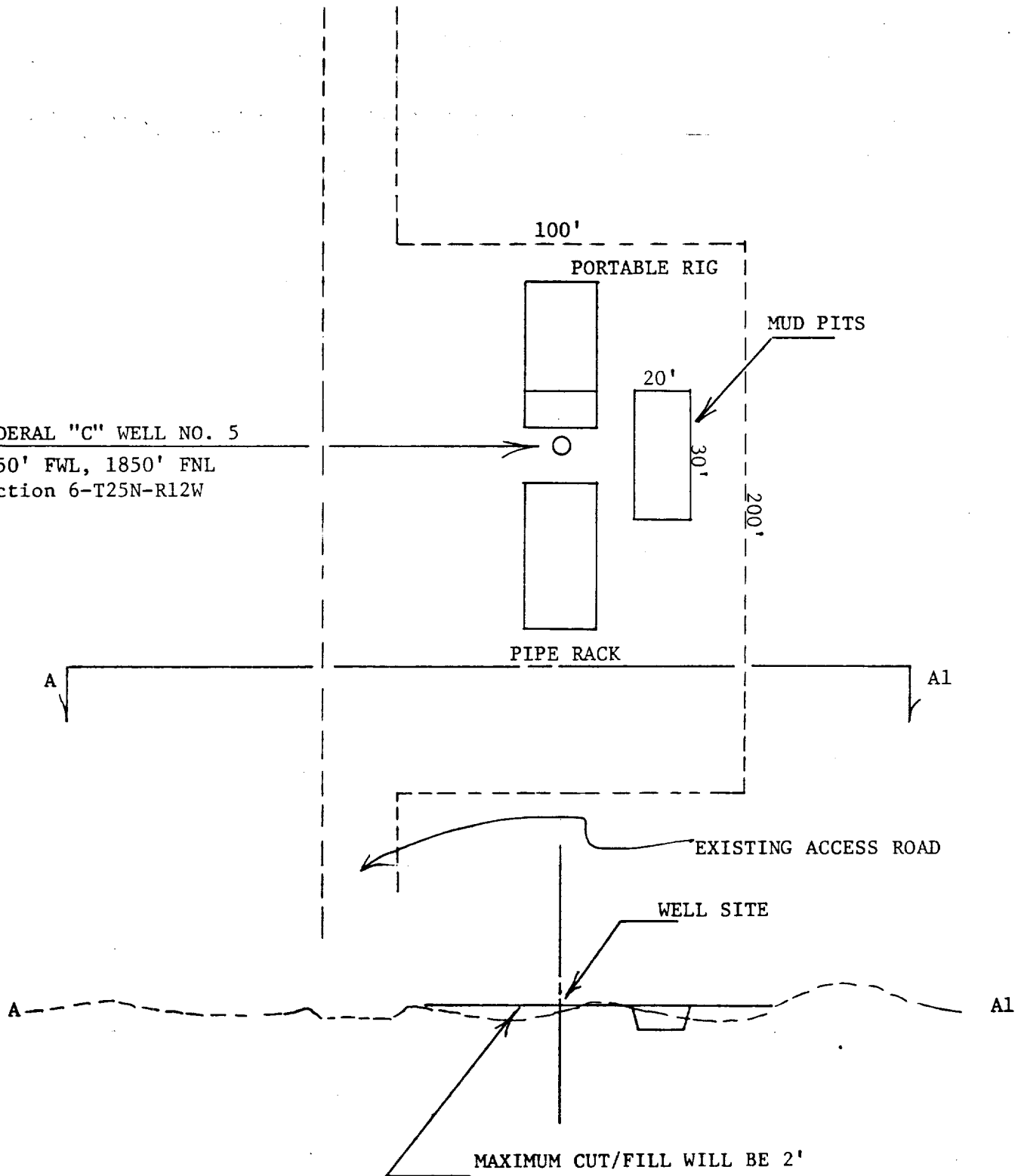

HIxon DEVELOPMENT COMPANY

P. O. BOX 2810

FARMINGTON, NEW MEXICO 87401

CERTIFICATION

I, hereby certify that I, or persons under my direct supervision, have inspected the proposed drill site and access route; that I am familiar with the conditions which presently exist; that the statements made in this plan are, to the best of my knowledge, true and correct; and that the work associated with the operations proposed herein will be performed by Hixon Development Company and its contractors and subcontractors in conformity with this plan and the terms and conditions under which it is approved.

1-5-79

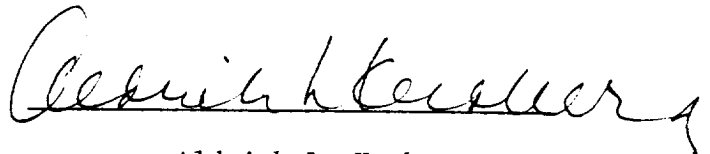

Aldrich L. Kuchera  
Production Manager  
Petroleum Engineer

ALK:dl