

OIL CONSERVATION DIVISION

STATE OF NEW MEXICO
ENERGY AND MINERALS DEPARTMENT

P. O. BOX 2088
SANTA FE, NEW MEXICO 87501

Form C-102
Revised 10-1-78

All distances must be from the outer boundaries of the Section.

Operator • SHELL OIL COMPANY		Lease CARSON UNIT			Well No. 202
Unit Letter A	Section 10	Township 25N	Range 12W	County San Juan	
Actual Footage Location of Well: 790 feet from the North line and 1100 feet from the East line					
Ground Level Elev. 6232	Producing Formation Picture & Cliffs		Pool WAW Fruit - P.C.	Dedicated Acreage: 160 Acres	

1. Outline the acreage dedicated to the subject well by colored pencil or hachure marks on the plat below.
2. If more than one lease is dedicated to the well, outline each and identify the ownership thereof (both as to working interest and royalty).
3. If more than one lease of different ownership is dedicated to the well, have the interests of all owners been consolidated by communitization, unitization, force-pooling, etc?

Yes No If answer is "yes," type of consolidation _____

If answer is "no," list the owners and tract descriptions which have actually been consolidated. (Use reverse side of this form if necessary.) _____

No allowable will be assigned to the well until all interests have been consolidated (by communitization, unitization, forced-pooling, or otherwise) or until a non-standard unit, eliminating such interests, has been approved by the Commission.

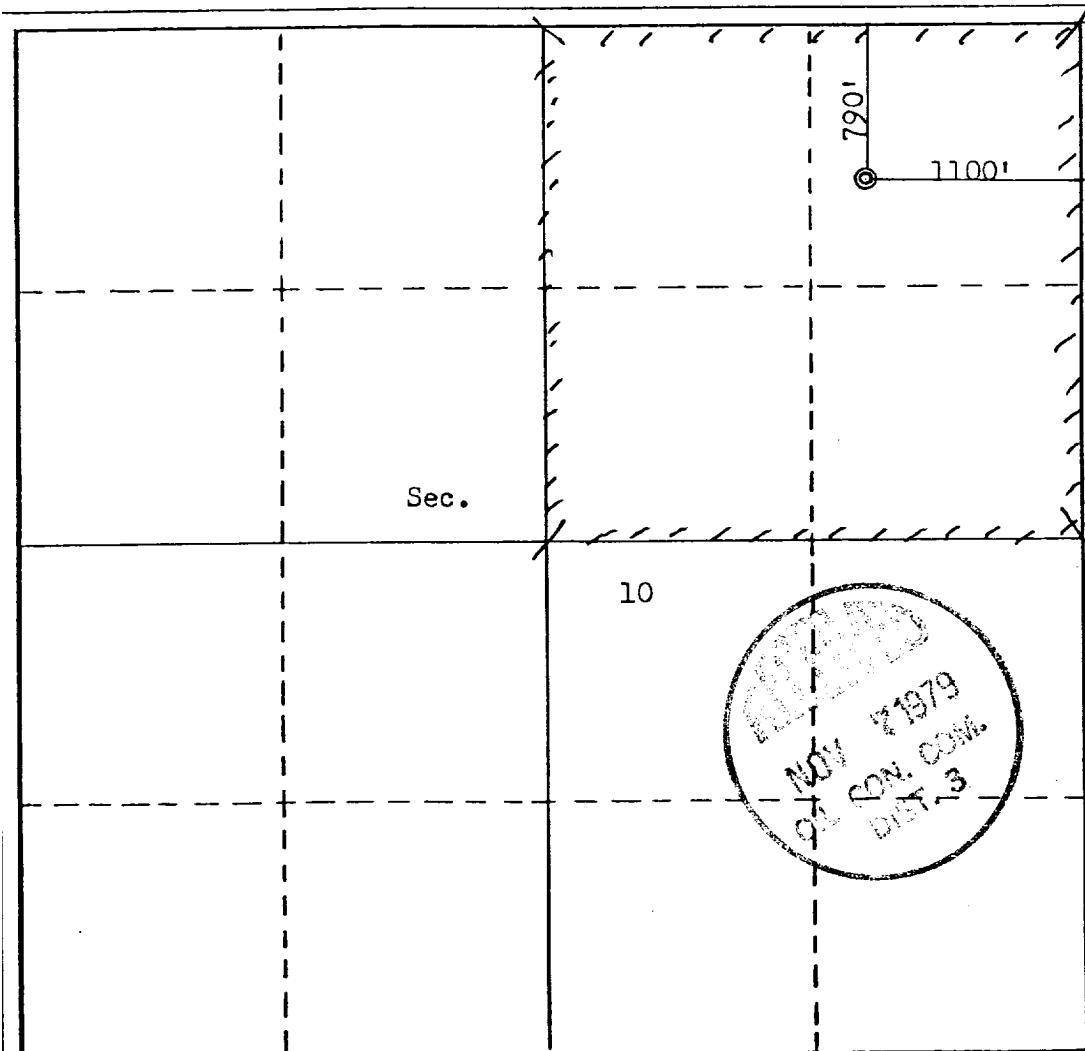

CERTIFICATION

I hereby certify that the information contained herein is true and complete to the best of my knowledge and belief.

S. M. Joda
Name
SUPERVISOR - R. PERMITS
Position
SHELL OIL
Company
11-1-79
Date

I hereby certify that the well location shown on this plat was plotted from field notes of actual surveys made by me or under my supervision, and that the same is true and correct to the best of my knowledge and belief.

Date Surveyed
October 20 No. 1979
Registered Professional Engineer and/or Land Surveyor
Fred B. ...
Fred B. ...
Certificate No.

3950

