

UNITED STATES
DEPARTMENT OF THE INTERIOR
BUREAU OF LAND MANAGEMENT

SUNDRY NOTICES AND REPORTS ON WELLS

(Do not use this form for proposals to drill or to deepen or plug back to a different reservoir.
Use "APPLICATION FOR PERMIT" for such proposals.)

OIL WELL <input type="checkbox"/> GAS WELL <input checked="" type="checkbox"/> OTHER		7. UNIT AGREEMENT NAME Navajo	
2. NAME OF OPERATOR El Paso Exploration company		8. FARM OR LEASE NAME Pah	
3. ADDRESS OF OPERATOR Box 4289, Farmington, New Mexico 87499		9. WELL NO. 1	
4. LOCATION OF WELL (Report location clearly and in accordance with any State requirements. See also space 17 below.) At surface 1020'S, 1730'W		10. FIELD AND POOL, OR WILDCAT Gallup Dufers Point Dakota	
14. PERMIT NO.		11. SEC., T., R., M., OR BLK. AND SURVEY OR AREA Sec. 6, T-25-N, R-8-W N.M.P.M.	
15. ELEVATIONS (Show whether DV, WT, GR, etc.) 6340' GL		12. COUNTY OR PARISH San Juan	13. STATE New Mexico

16. Check Appropriate Box To Indicate Nature of Notice, Report, or Other Data

NOTICE OF INTENTION TO:		SUBSEQUENT REPORT OF:	
TEST WATER SHUT-OFF <input type="checkbox"/>	PLUG OR ALTER CASING <input type="checkbox"/>	WATER SHUT-OFF <input type="checkbox"/>	REPAIRING WELL <input type="checkbox"/>
FRACTURE TREAT <input type="checkbox"/>	MULTIPLE COMPLETE <input type="checkbox"/>	FRACTURE TREATMENT <input type="checkbox"/>	ALTERING CASING <input type="checkbox"/>
SHOOT OR ACIDIZE <input type="checkbox"/>	ABANDON* <input type="checkbox"/>	SHOOTING OR ACIDIZING <input type="checkbox"/>	ABANDONMENT* <input type="checkbox"/>
REPAIR WELL <input type="checkbox"/>	CHANGE PLANS <input type="checkbox"/>	(Other) <u>Change in Dedicated Acreage</u>	
(Other) <input type="checkbox"/>		(Note: Report results of multiple completion on Well Completion or Recompletion Report and Log form.)	

17. DESCRIBE PROPOSED OR COMPLETED OPERATIONS (Clearly state all pertinent details, and give pertinent dates, including estimated date of starting any proposed work. If well is directionally drilled, give subsurface locations and measured and true vertical depths for all markers and zones pertinent to this work.)

Due to the change in the Dufers Point Gallup-Dakota Pool Rules this plat is re-issued to show a change in the dedicated acreage for this well.

RECEIVED
MAY 10 1984
OIL CON. DIV.
DIST. 3

RECEIVED
MAY 08 1984
BUREAU OF LAND MANAGEMENT
FARMINGTON RESOURCE AREA

18. I hereby certify that the foregoing is true and correct
SIGNED A. G. Busco TITLE Drilling Clerk DATE May 8, 1984
ACCEPTED FOR RECORD

(This space for Federal or State office use)
APPROVED BY _____ TITLE _____
CONDITIONS OF APPROVAL, IF ANY: _____ **MAY 09 1984**

*See Instructions on Reverse Side

FARMINGTON RESOURCE AREA
By RB

All distances must be from the outer boundaries of the Section

Operator EL PASO EXPLORATION CO.		Lease PAH (NOO-C-14-20-5006)		Well No.
Unit Letter N	Section 6	Township 25N	Range 8W	County San Juan
Actual Footage Location of Well: 1020 feet from the South line and 1730 feet from the West line				
Ground Level Elev. 6340	Producing Formation Dakota	Pool Dufers Point Dakota		Dedicated Acreage: 160.16 Acres

- Outline the acreage dedicated to the subject well by colored pencil or hachure marks on the plat below.
- If more than one lease is dedicated to the well, outline each and identify the ownership thereof (both as to working interest and royalty).
- If more than one lease of different ownership is dedicated to the well, have the interests of all owners been consolidated by communitization, unitization, force-pooling, etc?

Yes No If answer is "yes," type of consolidation Communitization

If answer is "no," list the owners and tract descriptions which have actually been consolidated. (Use reverse side of this form if necessary.)

No allowable will be assigned to the well until all interests have been consolidated (by communitization, unitization, forced-pooling, or otherwise) or until a non-standard unit, eliminating such interests, has been approved by the Division.

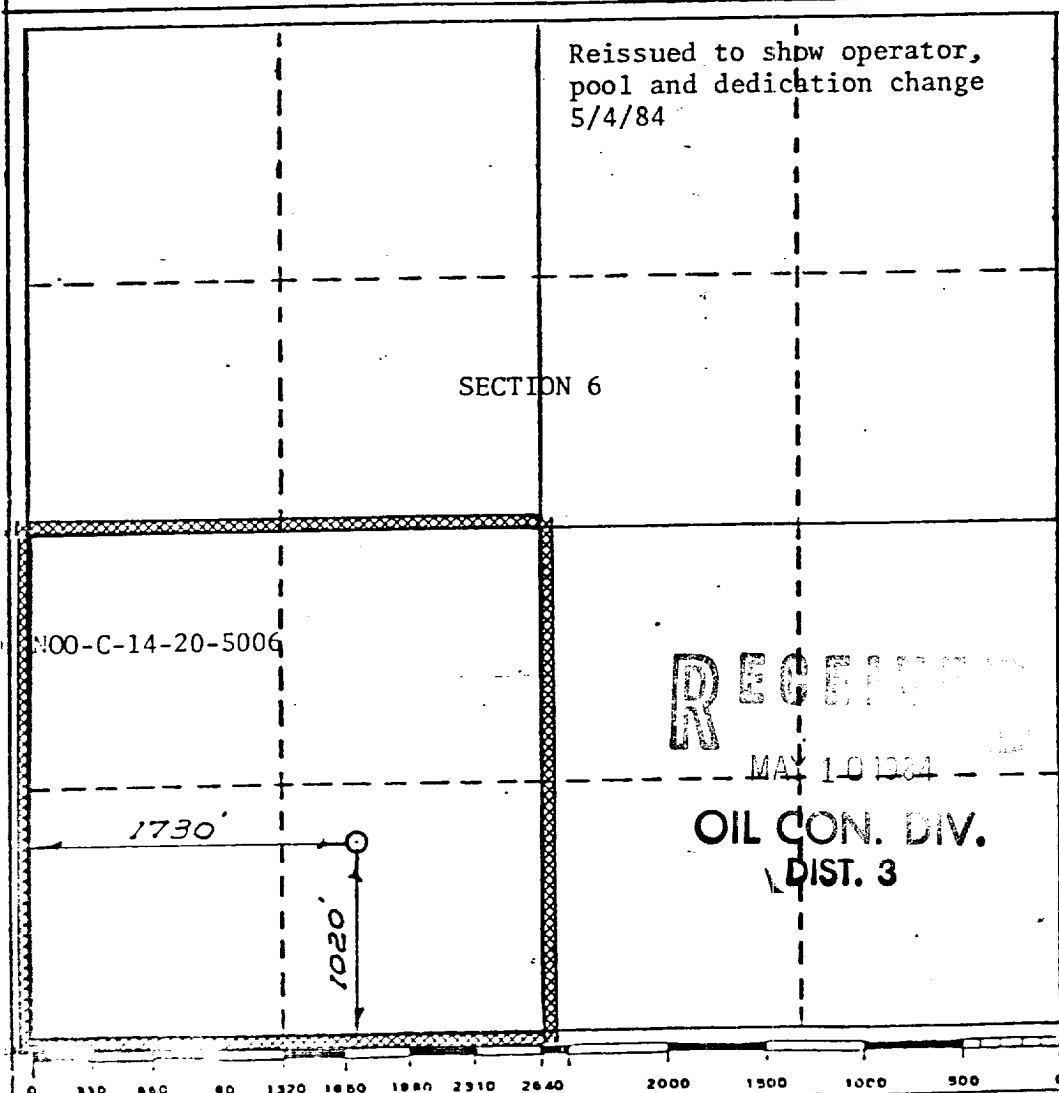

CERTIFICATION

I hereby certify that the information contained herein is true and complete to the best of my knowledge and belief.

A. G. Busco
Name
Drilling Clerk
Position
El Paso Exploration Company
Company
May 8, 1984
Date

I hereby certify that the well location shown on this plat was plotted from field notes of actual surveys made by me or under my supervision, and that the same is true and correct to the best of my knowledge and belief.

Date Surveyed
February 6, 1980
Registered Professional Engineer and/or Land Surveyor
Fred B. Kerr Jr.
Fred B. Kerr Jr.
Certificate No.
3950