

UNITED STATES  
DEPARTMENT OF THE INTERIOR  
GEOLOGICAL SURVEY

30-245-24469

5. LEASE DESIGNATION AND SERIAL NO.

NM-28756

6. IF INDIAN, ALLOTTEE OR TRUST NAME

7. UNIT AGREEMENT NAME

8. FARM OR LEASE NAME

Gulf Little Federal 25

9. WELL NO.

2

10. FIELD AND POOL, OR WILDCAT

Undesignated PC

11. SEC., T., E., M., OR BLK.

AND SURVEY OR AREA

Sec. 25-T25N-R10W

N.M.P.M.

12. COUNTY OR PARISH

San Juan

13. STATE

N.M.

14. DISTANCE IN MILES AND DIRECTION FROM NEAREST TOWN OR POST OFFICE\*

30 miles Northeast of Cuba, New Mexico

15. DISTANCE FROM PROPOSED\*

LOCATION TO NEAREST

PROPERTY OR LEASE LINE, FT.

(Also to nearest drg. unit line, if any)

790'

16. NO. OF ACRES IN LEASE

160

17. NO. OF ACRES ASSIGNED

TO THIS WELL

160

18. DISTANCE FROM PROPOSED LOCATION\*

TO NEAREST WELL, DRILLING, COMPLETED,

OR APPLIED FOR, ON THIS LEASE, FT.

2600'

19. PROPOSED DEPTH

1980'

20. ROTARY OR CABLE TOOLS

Rotary

21. ELEVATIONS (Show whether DF, RT, GR, etc.)

7007' GL

22. APPROX. DATE WORK WILL START\*

8/1/80

1a. TYPE OF WORK

DRILL ☒

DEEPEN ☐

PLUG BACK ☐

b. TYPE OF WELL

OIL

WELL ☐

GAS

WELL ☒

OTHER

SINGLE

ZONE ☐

MULTIPLE

ZONE ☐

2. NAME OF OPERATOR

ODESSA NATURAL CORPORATION Attn: J. Strojek

3. ADDRESS OF OPERATOR

P. O. Box 3908 Odessa, Texas 79760

4. LOCATION OF WELL (Report location clearly and in accordance with any State requirements.)\*

At surface

790'FNL, 1830'FWL

At proposed prod. zone

Same

14. DISTANCE IN MILES AND DIRECTION FROM NEAREST TOWN OR POST OFFICE\*

30 miles Northeast of Cuba, New Mexico

15. DISTANCE FROM PROPOSED\*

LOCATION TO NEAREST

PROPERTY OR LEASE LINE, FT.

(Also to nearest drg. unit line, if any)

790'

16. NO. OF ACRES IN LEASE

160

17. NO. OF ACRES ASSIGNED

TO THIS WELL

160

18. DISTANCE FROM PROPOSED LOCATION\*

TO NEAREST WELL, DRILLING, COMPLETED,

OR APPLIED FOR, ON THIS LEASE, FT.

2600'

19. PROPOSED DEPTH

1980'

20. ROTARY OR CABLE TOOLS

Rotary

21. ELEVATIONS (Show whether DF, RT, GR, etc.)

7007' GL

22. APPROX. DATE WORK WILL START\*

8/1/80

23. PROPOSED CASING AND CEMENTING PROGRAM

SIZE OF HOLE	SIZE OF CASING	WEIGHT PER FOOT	SETTING DEPTH	QUANTITY OF CEMENT
12-1/4"	8-5/8"	24.0	120'	125 sacks
7-7/8"	4-1/2"	10.50	1980'	280 sacks

This action is subject to administrative  
appeal pursuant to 50 CFR 290.

All producing intervals in Pictou Formation will be perforated  
and stimulated as necessary.

EXHIBITS:

- "A" Location and Elevation Plat
- "B" Ten Point Compliance Program
- "C" Blowout Preventer Diagram
- "D" Multi-Point Requirements for APD
- "E" Drilling Operations Authorized Are
- "F" Access Road to Location
- "G" Radiac Map of Field
- "H" Drill Rig Layout
- "I" General Requirements
- "J" Fracturing Program Layout

The gas from this well is committed.

The NW/4, Section 25, is dedicated to this well.

IN ABOVE SPACE DESCRIBE PROPOSED PROGRAM: If proposal is to deepen or plug back, give data on present productive zone and proposed new productive zone. If proposal is to drill or deepen directionally, give pertinent data on subsurface locations and measured and true vertical depths. Give blowout preventer program, if any.

24. FOR; ODESSA NATURAL CORP. President, Walsh Engr.  
Ewell N. Walsh, P.E. & Production Corp. 7/15/80

SIGNED

Ewell N. Walsh, P.E.

TITLE

DATE

(This space for Federal or State office use)

PERMIT NO.

APPROVAL DATE

APPROVED BY

CONDITIONS OF APPROVAL, IF ANY:

TITLE

DATE

\*See Instructions On Reverse Side

All distances must be from the outer boundaries of the Section

Operator <b>ODESSA NATURAL CORPORATION</b>			Lease <b>GULF-LITTLE-FEDERAL 25</b>		Well No. <b>2</b>
Unit Letter <b>C</b>	Section <b>25</b>	Township <b>25N</b>	Range <b>10W</b>	County <b>San Juan</b>	
Actual Footage Location of Well: <b>790</b> feet from the <b>North</b> line and <b>1830</b> feet from the <b>West</b> line					
Ground Level Elev. <b>6671</b>	Producing Formation <b>Pictured Cliffs</b>		Pool <b>Undesignated</b>		Dedicated Acreage: <b>160</b> Acres

1. Outline the acreage dedicated to the subject well by colored pencil or hachure marks on the plat below.
2. If more than one lease is dedicated to the well, outline each and identify the ownership thereof (both as to working interest and royalty).
3. If more than one lease of different ownership is dedicated to the well, have the interests of all owners been consolidated by communitization, unitization, force-pooling, etc?

☒ Yes ☐ No If answer is "yes," type of consolidation Communitization

If answer is "no," list the owners and tract descriptions which have actually been consolidated. (Use reverse side of this form if necessary.)

No allowable will be assigned to the well until all interests have been consolidated (by communitization, unitization, forced-pooling, or otherwise) or until a non-standard unit, eliminating such interests, has been approved by the Commission.

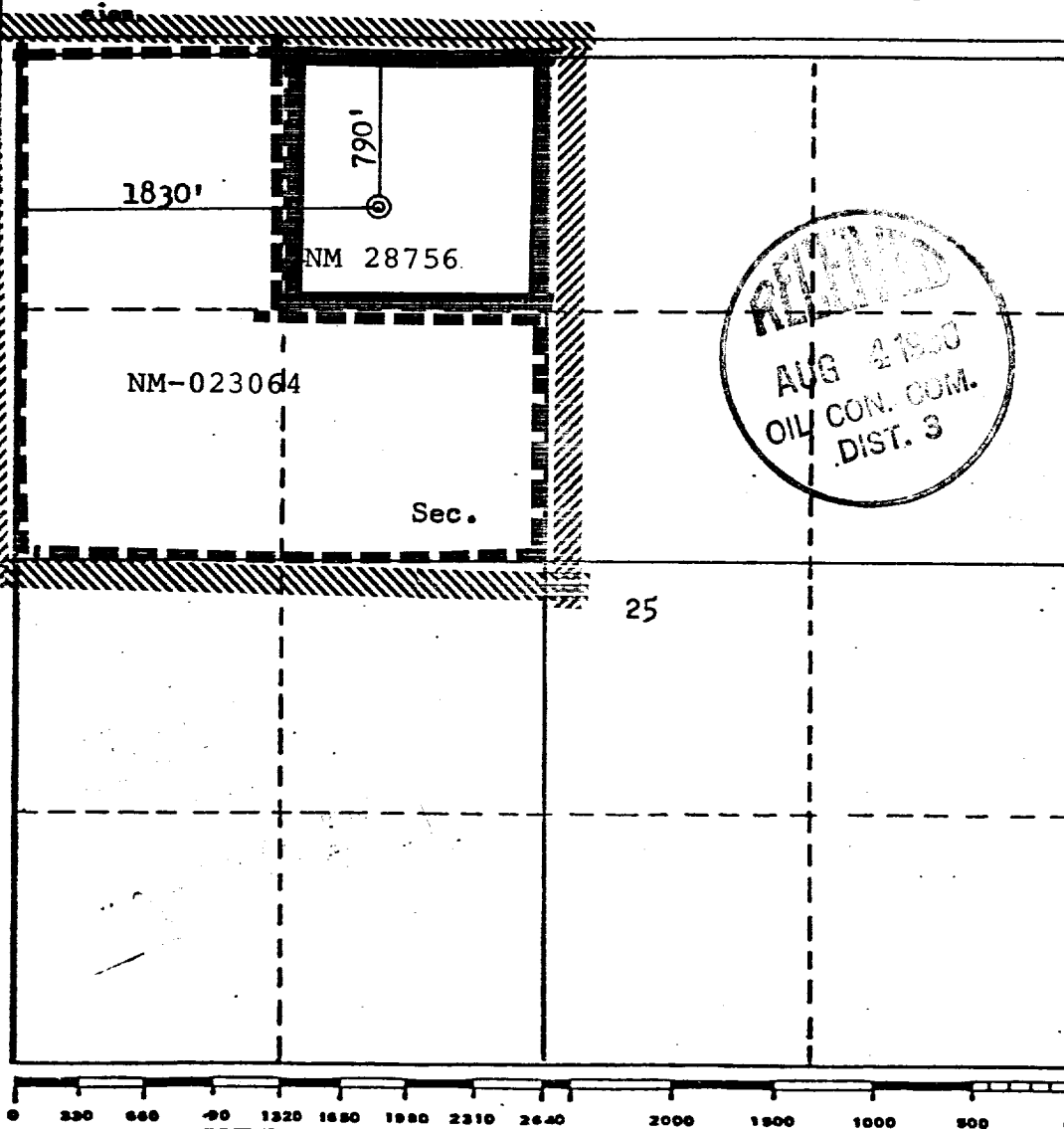

**CERTIFICATION**

I hereby certify that the information contained herein is true and complete to the best of my knowledge and belief.  
FOR: **ODESSA NATURAL CORP.**  
**ORIGINAL SIGNED BY**  
**EWELL N. WALSH**

Name  
**Ewell N. Walsh, P.E.**

Position  
**President**

Company  
**Walsh Engineering & Prod. Co.**

Date  
**7/15/80**

I hereby certify that the well location shown on this plat was plotted from field notes of actual surveys made by me or under my supervision, and that the same is true and correct to the best of my knowledge and belief.

Date Surveyed

**June 30, 1980**  
Registered Professional Engineer  
and Professional Surveyor  
**Fred N. East Jr.**  
Certified by New Mexico  
**39502 TERR. JR.**

EXHIBIT "B"

TEN-POINT COMPLIANCE PROGRAM

OF NTL-6 APPROVAL OF OPERATIONS

Attached to Form 9-331C

GULF LITTLE FEDERAL 25, NO. 2  
ODESSA NATURAL CORPORATION  
790'FNL, 1830'FWL, SECTION 25-T25N-R10W  
San Juan County, New Mexico

1. The Geologic Surface Formation  
Nacimiento

2. Estimated Tops of Important Geologic Markers

Ojo Alamo	940'
Kirtland	1170'
Fruitland	1530'
Pictured Cliffs	1780'
Lewis	1880'

3. Estimated Depths of Anticipated Water, Oil, Gas or Minerals

Ojo Alamo	940', Water
Fruitland	1530', Gas and Water
Pictured Cliffs	1780', Gas

4. The Proposed Casing Program

<u>Hole Size</u>	<u>Interval</u>	<u>Section Length</u>	<u>Size (OD)</u>	<u>Weight, Grade and Joint</u>	<u>New or Used</u>
12 $\frac{1}{4}$ "	0'-120'	120'	8-5/8"	24# K-55 8 round ST&C	New
7-7/8"	0'-1980'	1980'	4 $\frac{1}{2}$ ", 10.50#	K-55 8 round ST&C	New

## Cement Program

Surface - 8-5/8": 125 Sacks Class "B", 3%CaCl<sub>2</sub> & 1/4 lb. Flocele per sack.

Production - 4-1/2" 500 gallons mud flush followed by 280 sacks 50/50 Pozmix (2% Gel) with 6-1/4 lbs. Gilsonite and 6 lbs. salt per sack. Estimated top of cement surface.

## 5. The Operator's Minimum Specifications for Pressure Control

EXHIBIT "C" is a schematic diagram of the blowout preventer equipment. The BOP's will be hydraulically tested to the full working pressure after nipping up and after any use under pressure. Pipe rams will be operationally checked each 24-hour period, as will blind rams each time pipe is pulled out of the hole. Such checks of BOP will be noted on daily drilling reports.

Accessories to BOP will include floor safety valve, and choke manifold with pressure rating equivalent to the BOP stack.

## 6. The Type and Characteristics of the Proposed Circulating Muds

Mud system will be gel-chemical with adequate stocks of sorptive agents on site to handle possible spills of fuel and oil in the surface. Heavier muds will be on location to be added if pressure requires.

<u>Interval</u>	<u>Type</u>	<u>Weight/Gal.</u>	<u>Viscosity (Sec.)</u>	<u>Water Loss</u>	<u>Additives</u>
0'-120'	Gel-Water	9.0	60	--	Lime
120'-1980'	Benex & Water	8.8	34	8.0	Benex

## 7. The Auxiliary Equipment to be Used

- (a) A float will be used at the bit.
- (b) The mud system will be monitored visually.
- (c) A stabbing valve will be on the floor to be stabbed into the drill pipe when kelly is not in the string.

8. The Testing, Logging and Coring Programs to be Followed

(a) DST - None

(b) Logging - ISF 120' - T.D.; CNL-FDC 120'-T.D.

(c) Coring - None

9. Any Anticipated Abnormal Pressures or Temperatures

No abnormal pressures or temperatures have been noted or reported in wells drilled in the area nor at the depths anticipated in this well. Bottom hole pressure expected is 700 psig.

No hydrogen sulfide or other hazardous fluids or gases have been found, reported or known to exist at these depths in the area.

10. Anticipated Starting Date and Duration of the Operations

The anticipated starting date is set for August 1, 1980 or as soon as possible after examination and approval of drilling requirements. Operations should be completed within 5 days.

# Blowout Preventer Diagram

ODESSA NATURAL CORPORATION  
Gulf Little Federal 25, No. 2  
790'FNL, 1830'FWL, SEC. 25-T25N-R10W  
San Juan County, New Mexico

## PLAN VIEW - CHOKER MANIFOLD

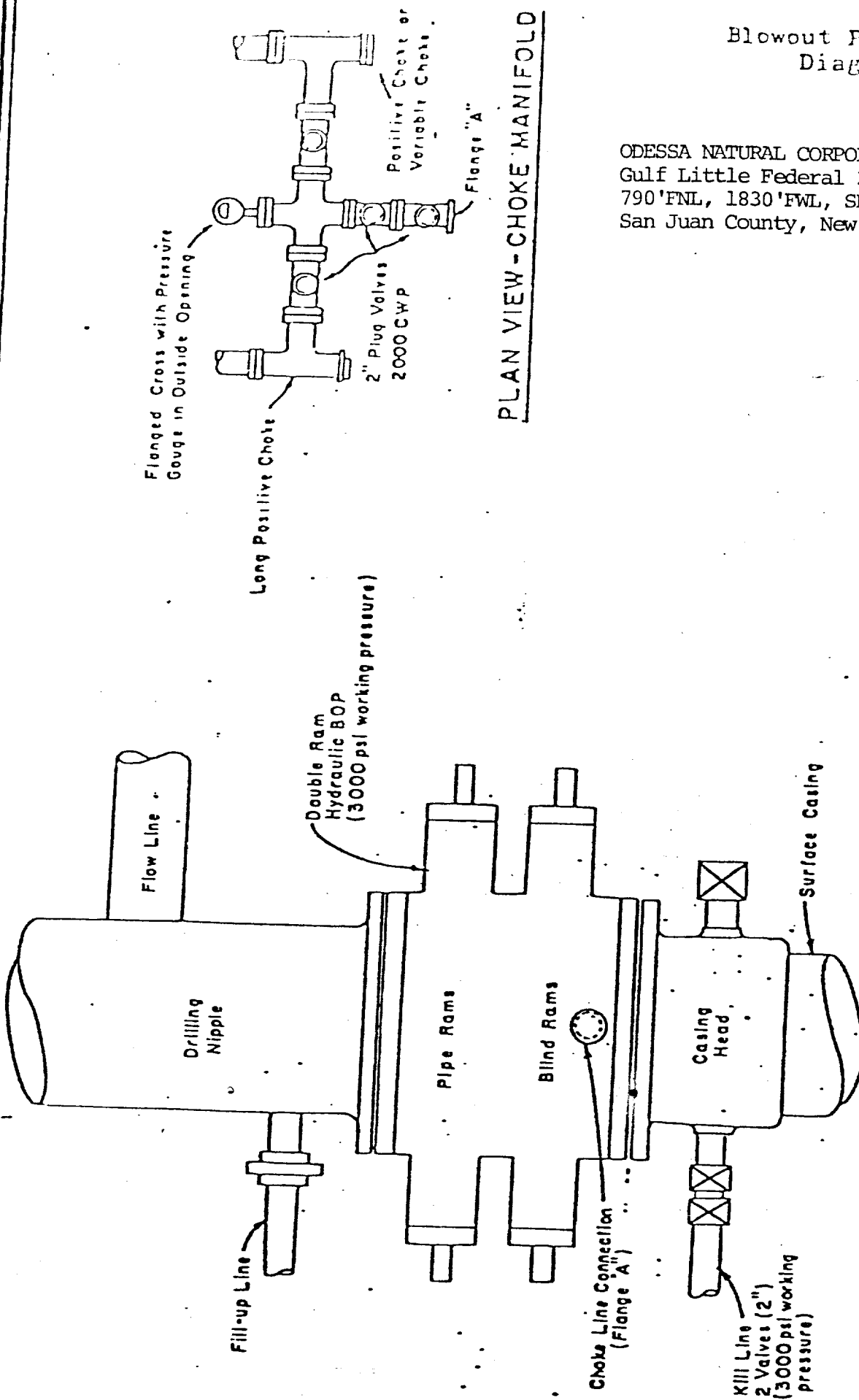

EXHIBIT "D"

MULTI-POINT REQUIREMENTS TO ACCOMPANY A.P.D.

Attached to Form 9-331C

ODESSA NATURAL CORPORATION  
Gulf Little Federal 25, No. 2  
790'FNL, 1830'FWL, SECTION 25-T25N-R10W  
San Juan County, New Mexico

1. Existing Roads

- A. The proposed well site and elevation plat is shown as EXHIBIT "A".
- B. Directions: South from Bloomfield, New Mexico on Highway 44 to Huerfano Trading Post. South on highway from Huerfano Trading Post 1.6 miles. Turn right onto dirt road. Go approximately 3/4 miles to location.
- C. All roads to location are indicated on Exhibit "E". Existing roads will be improved.
- D. Exploratory wells, existing roads: N/A
- E. Development wells, existing roads: See Exhibit "E"
- F. Improvement and maintenance: Existing roads need no improvement. Access road will be improved and maintenance will be performed as required.

2. Planned Access Roads

Exhibit "E " Access road, 1100', will have maximum width of 20'. No turn outs, culverts, gates, cattleguards or fence cuts. Surface material will be native soil.

3. Location of Existing Wells

For all existing wells within one mile radius of development well, see EXHIBIT "F".

- (1) There are none water wells within a one mile radius of this location.
- (2) There is one abandoned well in this one mile radius.

- (3) There are no temporarily abandoned wells.
- (4) There are no disposal wells.
- (5) There are no wells presently being drilled.
- (6) There are 3 producing wells within this one mile radius.
- (7) There are no shut-in wells.
- (8) There are no injection wells.
- (9) There are no monitoring or observation wells for other uses.

4. Location of Existing and/or Proposed Facilities

A. Within one mile radius of location, the following existing facilities are owned or controlled by lessee/operator:

- (1) Tank Batteries: None
- (2) Production Facilities: 1
- (3) Oil Gathering Lines: None
- (4) Gas Gathering Lines: None
- (5) Injection Lines: None
- (6) Disposal Lines: None

B. If production is obtained, new facilities will be as follows:

- (1) N/A production facilities will be located on the pad.
- (2) All well flow lines will be buried and will be on the well site and battery site.
- (3) Drill pad will be 275 feet long and 155 feet wide.
- (4) No construction materials for battery site and pad will be necessary.
- (5) Any necessary pits will be fenced and flagged to protect livestock and wildlife.
- (6) Rehabilitation whether well is productive or dry, will be made on all unused areas in accordance with BLM stipulations.



5. Location and Type of Water Source

- A. The source of water will be water well at Hilltop Store 8 miles South of Bloomfield, New Mexico
- B. Water will be transported by truck over existing roadways.
- C. No water well is to be drilled on this lease.

6. Construction Materials

- A. No construction materials are needed for drilling and access roads into the drilling location unless production is obtained. The surface soil materials will be sufficient or will be provided by the Dirt Contractor as needed.
- B. No construction materials will be taken off Federal or Indian Lands.
- C. All surface soil materials for construction of access roads are sufficient.
- D. All major access roads presently exist as shown on EXHIBIT "E".

7. Handling of Waste Materials and Disposal

- (1) Drill cuttings will be buried in the reserve pit and covered.
- (2) Drilling fluids will be handled in the reserve pit.
- (3) Any fluids provided during drilling test or while making production test will be collected in a test tank. If a test tank is not available during drilling, fluids will be handled in reserve pit. Any spills of oil, gas, salt waters or other noxious fluids will be cleaned up and removed.
- (4) Chemical facilities will be provided for human waste.
- (5) Garbage and non-flammable waste and salts and other chemicals produced during drilling or testing will be handled in trash pit. Flammable waste will be disposed of in burn pit. Drill fluids, water drilling mud and tailings will be kept in reserve pit, as shown on EXHIBIT "G". Reserve pit will be fenced on three sides and the fourth side fenced upon removal of the rig.
- (6) After the rig moves out, all materials will be cleaned up and no adverse materials will be left on location. Any dangerous open pit will be fenced during drilling and kept closed until such time as the pit is leveled.

8. Ancillary Facilities

No air strip, camp or other facilities will be built during drilling of this well.

9. Well Site Layout

- (1) EXHIBIT "G" is the Drill Pad Layout.

Topsoil, if removal required, will be stockpiled per specifications determined at time of pre-drill inspection.

- (2) EXHIBIT "G" is a plan diagram of the proposed rig and equipment reserve pit, burn and trash pit, pipe racks and mud tanks. No permanent living facilities are planned. There will be a trailer on site.

- (3) The reserve pits will not be lined. Steel mud tanks or dirt mud pits will be used during drilling operations.

10. Plans for Restoration

- (1) Backfilling, leveling and contouring are planned as soon as all pits have dried. Waste disposal and spoils materials will be buried or hauled away immediately after drilling is completed. If production is obtained, the unused area will be restored as soon as possible.

- (2) The soil banked material, if removal required, will be spread over the area. Revegetation will be accomplished by planting mixed grasses as per formula provided by the BLM.

- (3) Three sides of the reserve pit will be fenced during drilling operations. Prior to rig release, the reserve pit will be fenced on the fourth side to prevent livestock or wildlife from becoming entrapped; and the fencing will be maintained until leveling and cleanup is accomplished.

- (4) The rehabilitation operations will begin as soon as possible after the drilling rig is removed. Removal of oil or other adverse substances will begin immediately or area will be flagged and fenced. Other cleanup will be done as needed. Planting and revegetation is considered best from July 15 to September 15, unless requested otherwise.

11. Other Information

- (1) Soil: Sandy Clay Loam  
Vegetation: Sage Brush, snake weed and salt bush.
- (2) The primary surface use is for grazing. The surface is owned by the BLM.
- (3) The closest live water is the - None

The closest occupied dwellings - 1000'

There are no known archaeological, historical, or cultural heritages that will be disturbed by this drilling.

- (4) Restrictions: Operator has all rights from surface to base of Dakota.
- (5) Drilling is planned for on or about August 1, 1980 Operations should be completed within 5 days.

12. Lessee's or Operator's Representative

Ewell N. Walsh, P.E. President  
Walsh Engineering & Production Corporation  
P. O. Box 254  
Farmington, New Mexico 87401  
Telephone: (505) 327-4892, 24 hrs.

13. Certification

I hereby certify that I, or persons under my direct supervision, have inspected the proposed drillsite and access route; that I am familiar with the conditions which presently exist; that the statements made in this plan are, to the best of my knowledge, true and correct; and that the work associated with the operations proposed herein will be performed by and its contractors and subcontractors in coformity with this plan and the terms and conditions under which it is approved.

July 15, 1980

Date

ORIGINAL SIGNED BY  
EWELL N. WALSH

Ewell N. Walsh, P.E.  
President  
Walsh Engineering & Production Corp.

**Walsh** ENGINEERING & PRODUCTION CORP.





# EXHIBIT "G"

## Drill Rig Layout

ODESSA NATURAL CORPORATION  
Gulf Little Federal 25, No. 2  
790'FNL, 1830'FWL, SEC. 25-T25N-R10W  
San Juan County, New Mexico

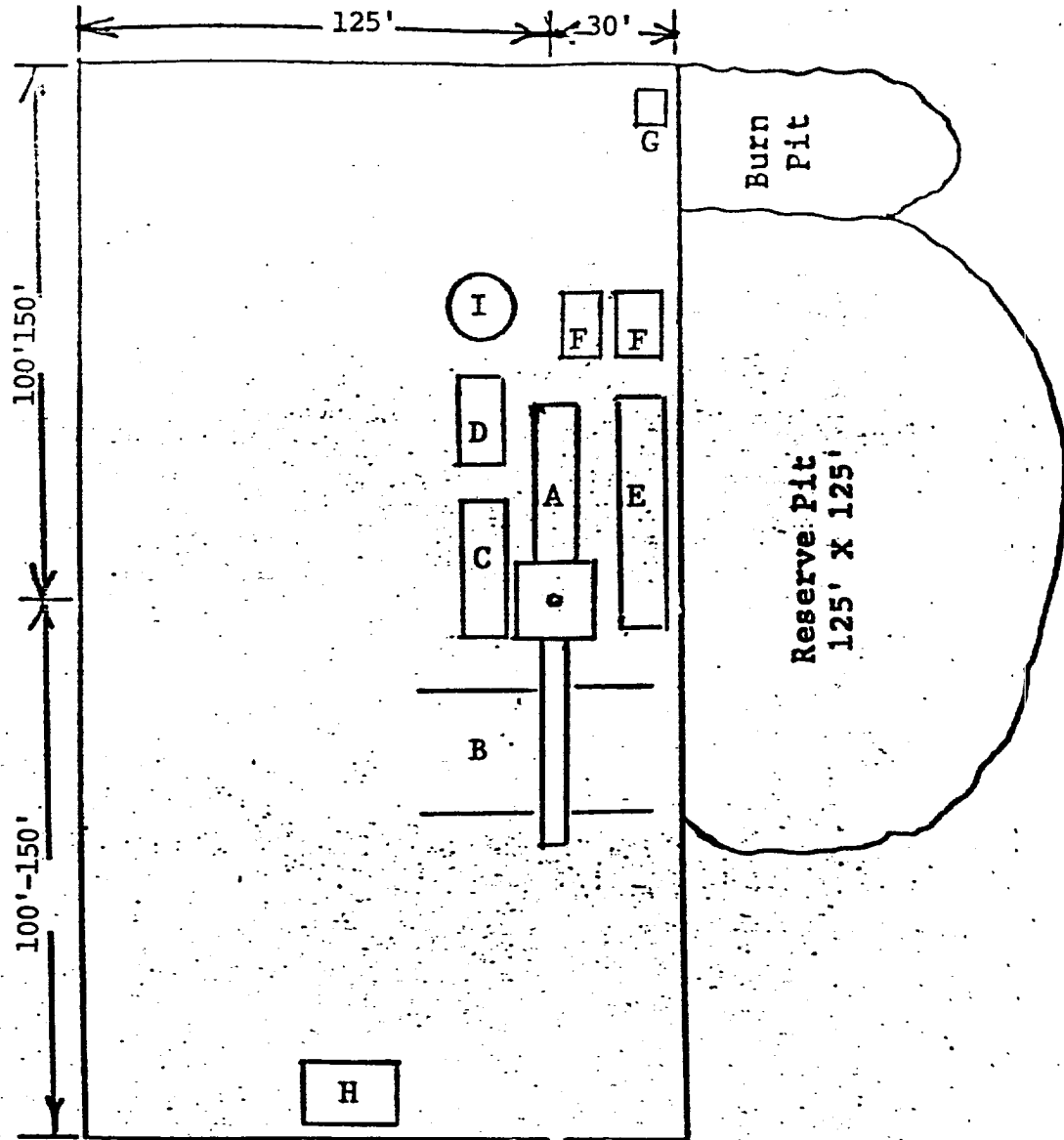

- A - Rig
- B - Piperacks
- C - Doghouse and Water Tank
- D - Fuel
- E - Mud Pit
- F - Pumps
- G - Toilet
- H - Trailer House
- I - Oil Storage

EXHIBIT "H"

Fracturing Program  
Layout

ODESSA NATURAL CORPORATION  
Gulf Little Federal 25, No. 2  
790'FNL, 1830'FWL, SEC. 25-T25N-R10W  
San Juan County, New Mexico

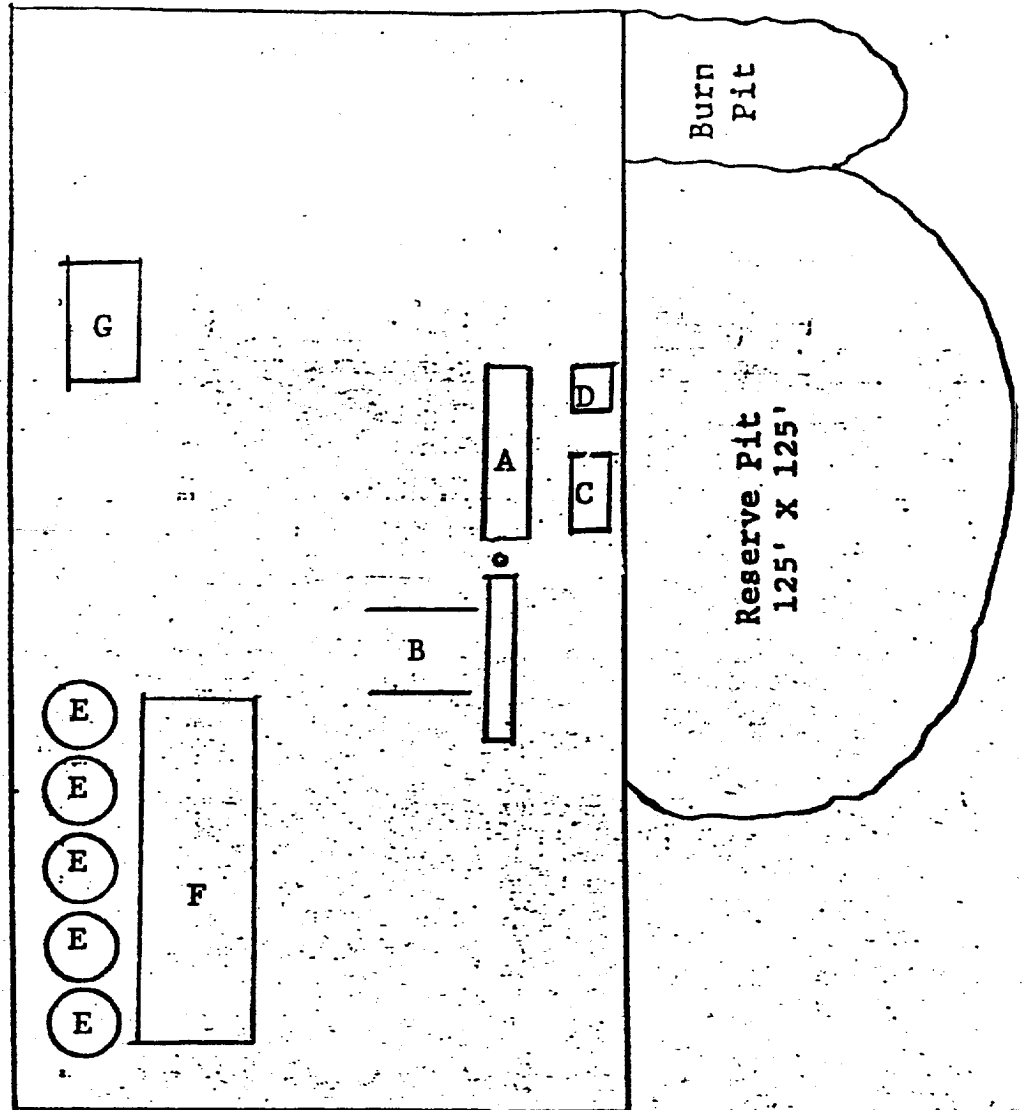

- A - Completion Rig
- B - Pipe Racks
- C - Circulating Pit
- D - Pump
- E - Frac Water Tanks
- F - Area Frac Equipment
- G - Trailer House