

UNITED STATES
DEPARTMENT OF THE INTERIOR
GEOLOGICAL SURVEY

APPLICATION FOR PERMIT TO DRILL, DEEPEN, OR PLUG BACK

1a. TYPE OF WORK
DRILL ☒ DEEPEN ☐ PLUG BACK ☐

b. TYPE OF WELL
OIL WELL ☐ GAS WELL ☒ OTHER ☐ SINGLE ZONE ☒ MULTIPLE ZONE ☐

2. NAME OF OPERATOR
Consolidated Oil & Gas, Inc.

3. ADDRESS OF OPERATOR
1860 Lincoln Street, Denver, Colorado 80295

4. LOCATION OF WELL (Report location clearly and in accordance with any State requirements.)*
At surface
790' FNL, 1833' FWL, Sec. 11, T25N, R10W
At proposed prod. zone
Same

14. DISTANCE IN MILES AND DIRECTION FROM NEAREST TOWN OR POST OFFICE*
1 1/2 miles north of Huerfano Trading Post, New Mexico

15. DISTANCE FROM PROPOSED*
LOCATION TO NEAREST
PROPERTY OR LEASE LINE, FT.
(Also to nearest drilg. unit line, if any) 790'

16. NO. OF ACRES IN LEASE
320

17. NO. OF ACRES ASSIGNED
TO THIS WELL
N/320 160

18. DISTANCE FROM PROPOSED LOCATION*
TO NEAREST WELL, DRILLING, COMPLETED,
OR APPLIED FOR, ON THIS LEASE, FT. 2750'

19. PROPOSED DEPTH
6875'

20. ROTARY OR CABLE TOOLS
Rotary

21. ELEVATIONS (Show whether DF, RT, GR, etc.)
6767' GR

22. APPROX. DATE WORK WILL START*

5. LEASE DESIGNATION AND SERIAL NO.
30-045-24522
14-20-603-1328 1371

6. IF INDIAN, ALLOTTEE OR TRIBE NAME
Navajo

7. UNIT AGREEMENT NAME
Navajo

8. FARM OR LEASE NAME
Navajo

9. WELL NO.
2-E

10. FIELD AND POOL, OR WILDCAT
Basin Dakota

11. SEC., T., E., M., OR BLK.
AND SURVEY OR AREA
Sec. 11, T25N, R10W

12. COUNTY OR PARISH
San Juan

13. STATE
New Mexico

PROPOSED CASING AND CEMENTING PROGRAM				
SIZE OF HOLE	SIZE OF CASING	WEIGHT PER FOOT	SETTING DEPTH	QUANTITY OF CEMENT
12-1/4"	8-5/8"	24#	250'	200 Sk.
7-7/8"	5-1/2"	15.5#	6875'	3 stages-850 total sk.

1. Drill 12-1/4" hole to 250'. Run and cement to surface 24# casing.
2. Install and test BOP and casinghead. Stand cemented total of 12 hrs.
3. Drill 7-7/8" hole to TD. Run electrical surveys.
4. Run 5-1/2", 15.5#, K-55 production casing and cement in 2 stages.
5. Perforate Dakota sand, stimulate and complete well with tubing.

IN ABOVE SPACE DESCRIBE PROPOSED PROGRAM: If proposal is to deepen or plug back, give data on present productive zone and proposed new productive zone. If proposal is to drill or deepen directionally, give pertinent data on subsurface locations and measured and true vertical depths. Give blowout preventer program, if any.

24. *gone drilled*

SIGNED John E. Wey TITLE Division Oper. Engineer DATE July 23, 1980

(This space for Federal or State office use)

PERMIT NO. AS AMENDED APPROVAL DATE AUG 28 1980

APPROVED BY James F. Sims TITLE DISTRICT ENGINEER

CONDITIONS OF APPROVAL, IF ANY

RECEIVED
OIL CON. COM.
DIST. 3

NEW MEXICO OIL CONSERVATION COMMISSION
WELL LOCATION AND ACREAGE DEDICATION PLAT

Form C-102
Supersedes C-128
Effective 1-1-65

All distances must be from the outer boundaries of the Section.

Operator CONSOLIDATED OIL & GAS, INC.			Lease NAVAJO		Well No. 2 - E
Unit Letter C	Section 11	Township 25 NORTH	Range 10 WEST	County SAN JUAN	
Actual Footage Location of Well: <div style="display: flex; justify-content: space-between;"> 790 feet from the NORTH line and 1833 feet from the WEST line </div>					
Ground Level Elev. 6767	Producing Formation Dakota		Pool Basin Dakota	Dedicated Acreage: 320 Acres	

1. Outline the acreage dedicated to the subject well by colored pencil or hatchure marks on the plat below.
2. If more than one lease is dedicated to the well, outline each and identify the ownership thereof (both as to working interest and royalty).
3. If more than one lease of different ownership is dedicated to the well, have the interests of all owners been consolidated by communitization, unitization, force-pooling, etc?

☐ Yes ☐ No If answer is "yes," type of consolidation _____

If answer is "no," list the owners and tract descriptions which have actually been consolidated. (Use reverse side of this form if necessary.) _____

No allowable will be assigned to the well until all interests have been consolidated (by communitization, unitization, forced-pooling, or otherwise) or until a non-standard unit, eliminating such interests, has been approved by the Commission.

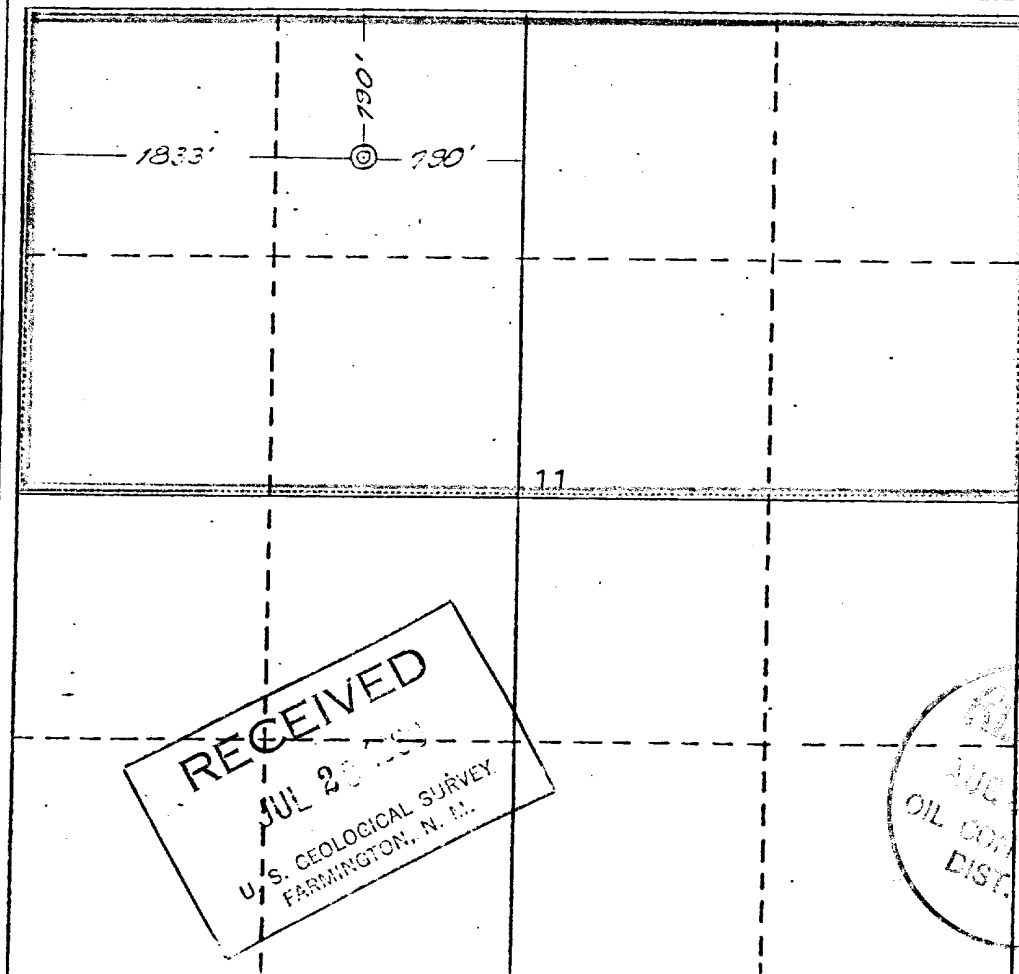

CERTIFICATION

I hereby certify that the information contained herein is true and complete to the best of my knowledge and belief.

John E. Wey
Name **John E. Wey**

Position
Division Operations Engr.

Company
Consolidated Oil & Gas, Inc.

Date
July 23, 1980

I hereby certify that the well location shown on this plat was plotted from field notes of actual surveys made by me or under my supervision, and that the same is true and correct to the best of my knowledge and belief.

James P. Leese
Date Surveyed
June 11, 1980
Registered Professional Engineer
and/or Land Surveyor
James P. Leese

Certificate No.

1463

0 330 660 990 1320 1650 1980 2310 2640 2000 1500 1000 500 0

DIAGRAM "A"

U.S.G.S. APPLICATION FOR PERMIT
TO DRILL

CONSOLIDATED OIL & GAS, INC - OPERATOR

NAVAJO No. 2-E

SWNENW Sec. 11, T25N, R10W,

San Juan County, New Mexico

Pressure Control Equipment (BOPE)

14-20-603-~~1328~~ 1371

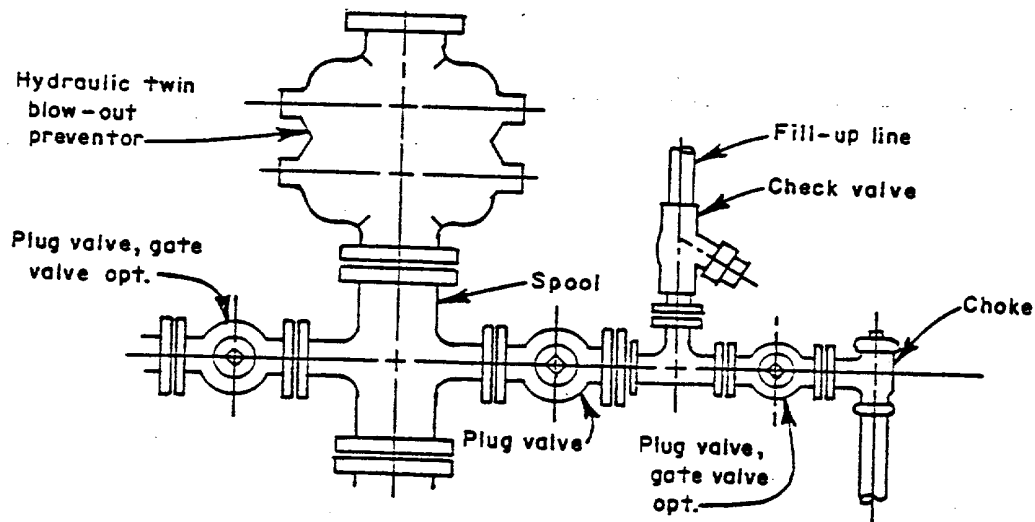

DEVELOPMENT PLAN FOR SURFACE USE

Consolidated Oil & Gas, Inc. - Operator

NAVAJO No. 2-E

SWNENW Sec. 11, T25N, R10W
San Juan County, New Mexico

14-20-603-~~1328~~ 1371

1. Existing Roads

See enclosed topographic map (Attachment "A") which shows existing improved and unimproved roads.

2. Planned Access Roads

Access is planned on a road approaching the location from the north. It will be approximately 20' wide and 2000' long.

3. Location of Existing Wells

See enclosed lease map (Attachment "B")

4. Location of Existing and/or Proposed Facilities

See enclosed lease map (Attachment "B") showing location of wells and facilities operated by Consolidated Oil & Gas, Inc. If production is encountered, the tank battery and other required producing equipment will be located per attached completion plat (Attachment "C").

5. Location and Type of Water Supply

Water for drilling will be trucked approximately fifteen miles from an irrigation canal in Aztec, New Mexico or purchased locally, if available, and transported via irrigation pipe.

6. Source of Construction Materials

No additional construction material will be required.

7. Methods of Handling Waste Disposal

All waste material will be contained by earthen and steel pits. Earthen pits will be subsequently backfilled and buried. A portable chemical toilet will be furnished for drilling personnel.

8. Ancillary Facilities

No separate drill campsites are proposed.

9. Wellsite Layout

The drilling site location will be graded and will approximate 200' x 250' with natural drainage to the west. Care will be taken while grading to control erosion. (See Attachment "D").

10. Plans for Restoration of Surface

- A. Following drilling and completion operations, all equipment and material not needed for operations will be removed. Pits containing fluid will be fenced until filled with any additional pits filled and the location cleaned of all trash and junk.
- B. After abandonment, any special rehabilitation and/or re-vegetation requirements (reseed with seed mixture No. 2) will be complied with and accomplished as expeditiously as possible. All pits should be filled and leveled within 90 days after abandonment.

1. Other Information

The location is on a rolling plain area, with sandy clay topsoil and vegetation consisting of scattered sagebrush, broom snakeweed, galleta and blue gamma. No residences or structures are nearby. The surface rights are owned by the Navajo Tribe. If, during operations, any historic or prehistoric ruin, monument or site, or any object of antiquity is discovered, work will be suspended and the discovery will be reported to the appropriate regulatory agency.

12. Operator's Representative

Consolidated Oil & Gas, Inc.
John E. Wey
Division Operations Engineer
1860 Lincoln Street
Denver, Colorado 80295
Phone (303) 861-5252

13. Certification

I hereby certify that I, or persons under my direct supervision, have inspected the proposed drillsite and access route; that I am familiar with the conditions which presently exist; that the statements made in this plan are, to the best of my knowledge, true and correct; and that the work associated with the operations proposed herein will be performed by Consolidated Oil & Gas, Inc. and its contractors and sub-contractors in conformity with this plan and the terms and conditions under which it is approved.

July 23, 1980

Date

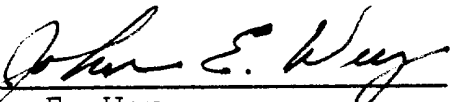

John E. Wey
Division Operations Engineer

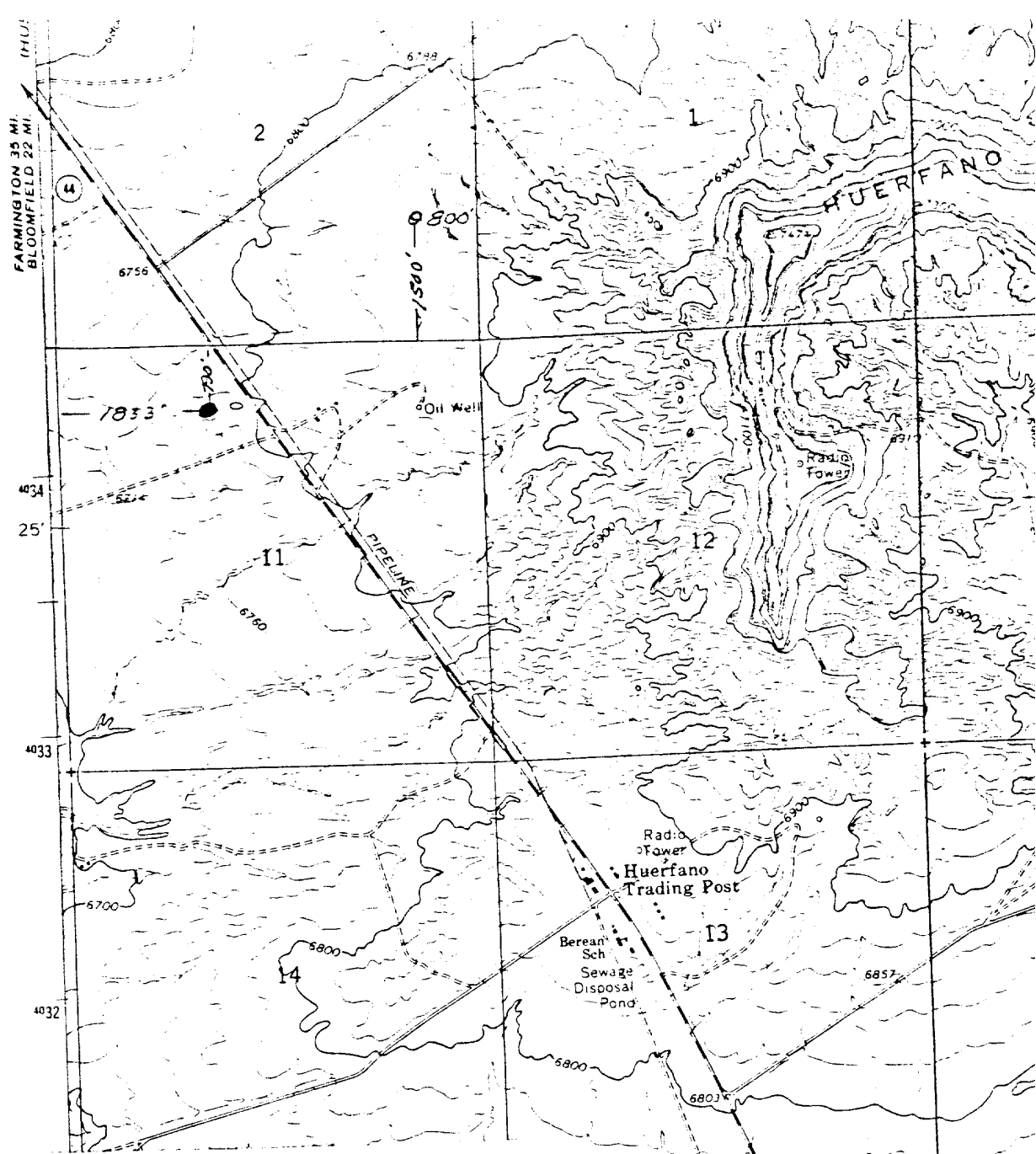

Consolidated Oil & Gas, Inc.
 NW $\frac{1}{4}$ Sec 11, T25N, R10W, N.M.P.M.
 San Juan County, New Mexico
 NAVAJO No. 2-E
 14-20-603-1328-1371

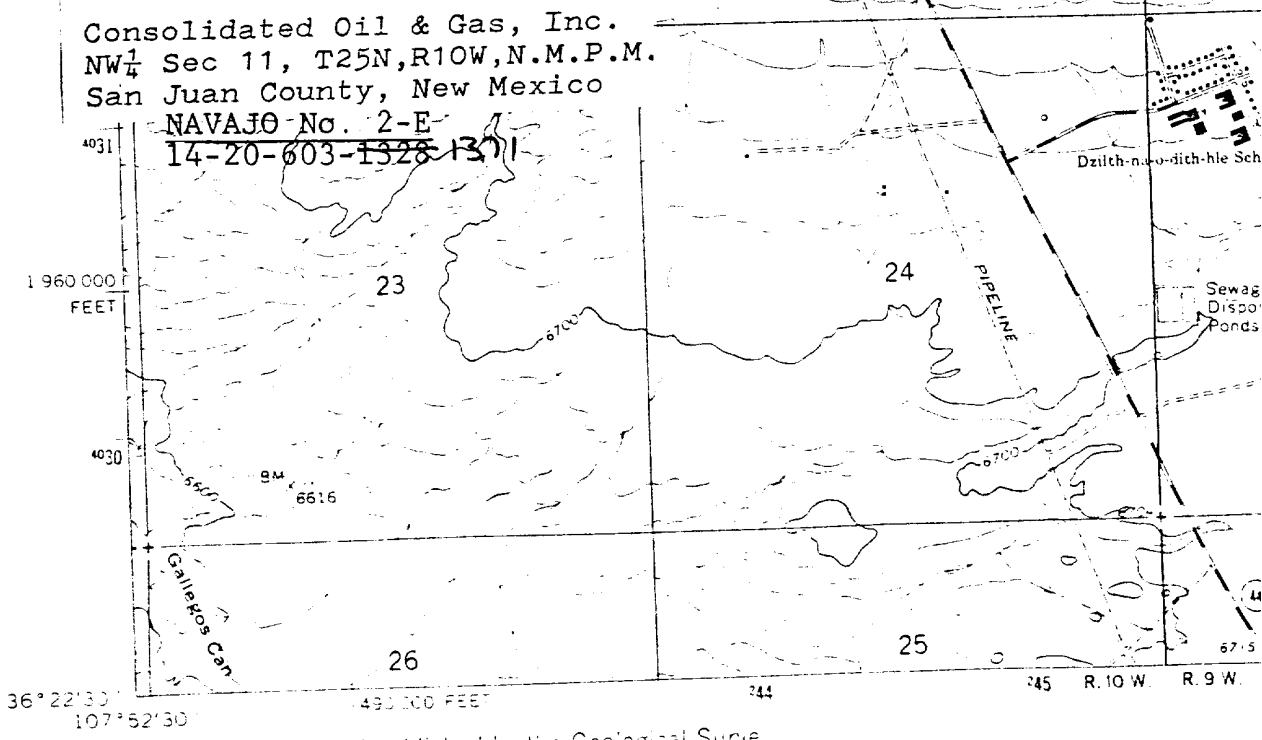

(HUERFANO
 TRADING POST SW)
 4035 14 SW

Mapped, edited, and published by the Geological Survey,
 Control by USGS and USCGS
 Topography by photogrammetric methods from aerial
 photographs taken 1965. Field checked 1967
 Polyconic projection, 1927 North American datum
 10,000-foot grid based on New Mexico coordinate system,
 west zone
 1000-meter Universal Transverse Mercator grid ticks,
 zone 13, shown in blue
 Fine red dashed lines indicate selected fence lines

UTM GRID AND 1967 MAGNETIC NORTH
 DECLINATION AT CENTER OF SHEET

ATTACHMENT "A"

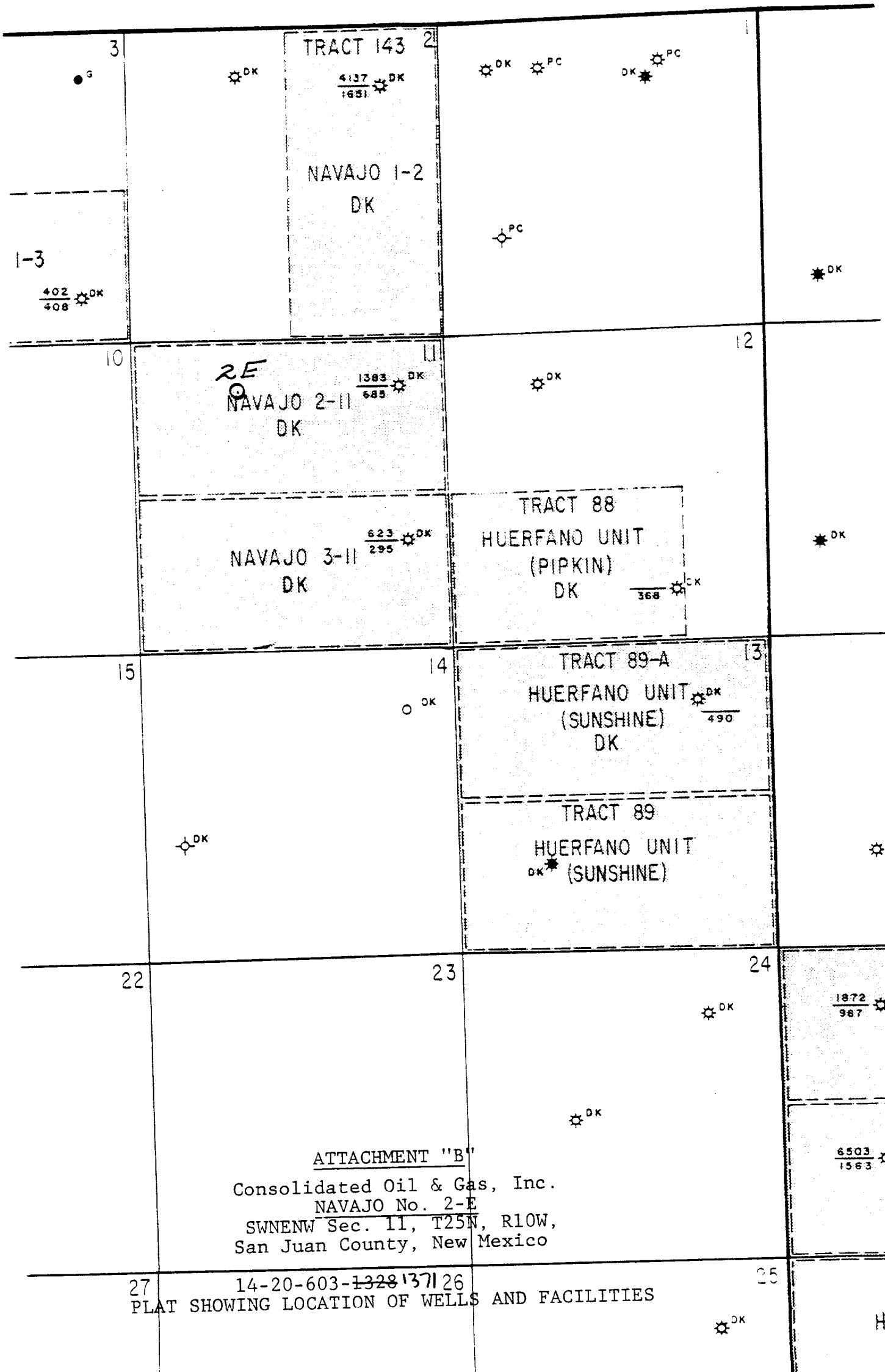

ATTACHMENT "C"

DEVELOPMENT PLAN FOR SURFACE USE

CONSOLIDATED OIL & GAS, INC. - OPERATOR

NAVAJO No. 2-E

SWNENW Sec. 11, T25N, R10W

San Juan County, New Mexico

14-20-603-1328 1371

1. Well
2. Dead Men
3. Prod. Unit
4. Water Pit
5. 300 bbl. Oil Tank
6. Water Pit
7. 2" Buried flow line
8. 1½" Oil Line
9. 1½" Water Line

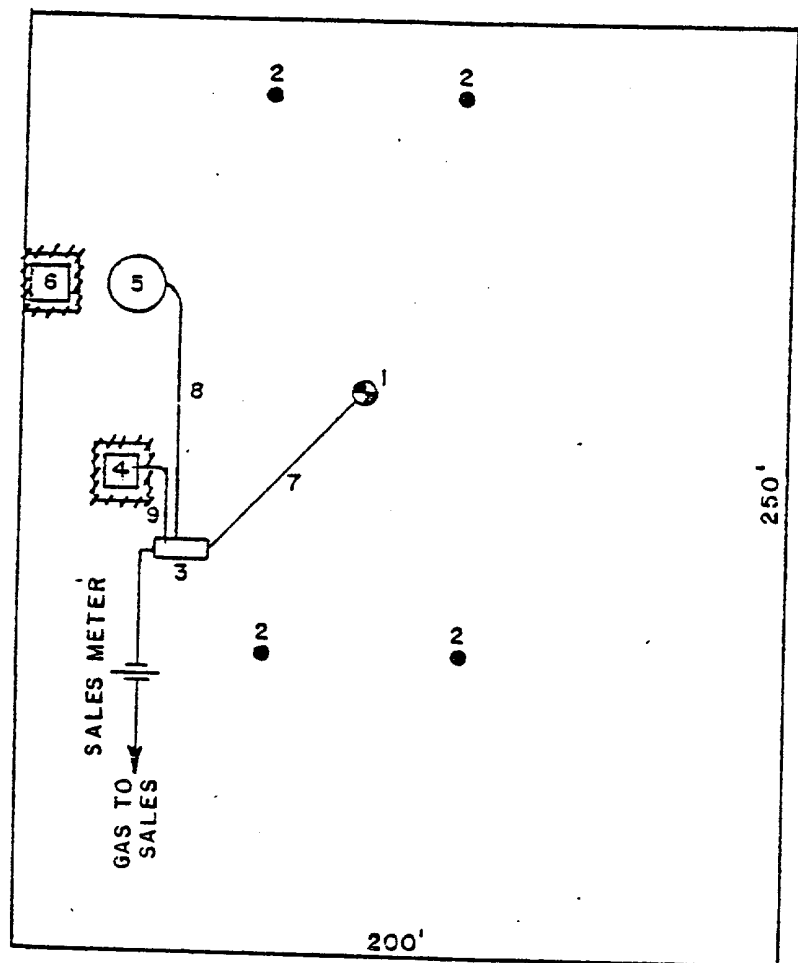

1" equals 50'

Fence - - - - -

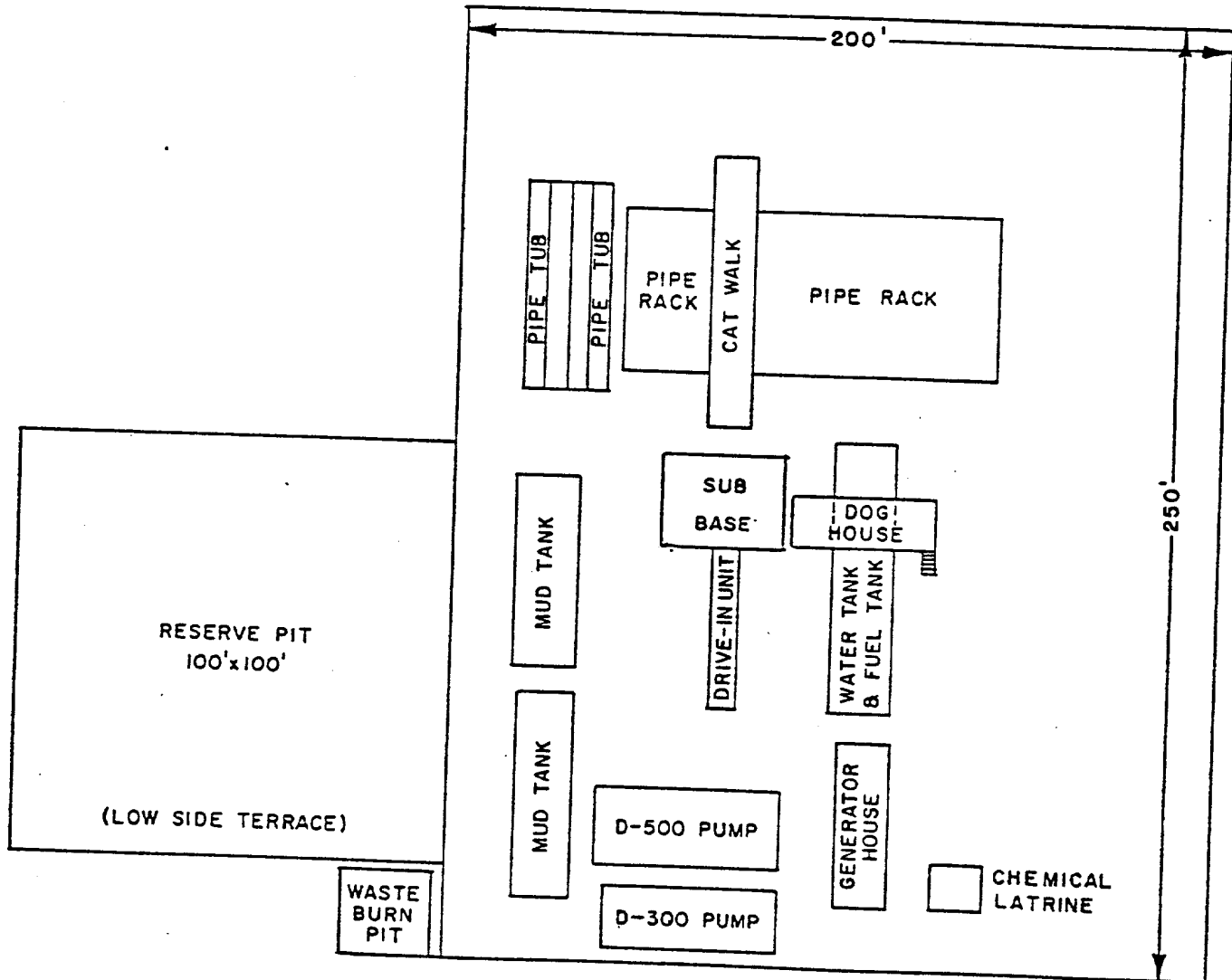

ATTACHMENT "D"

DEVELOPMENT PLAN FOR SURFACE USE

CONSOLIDATED OIL & GAS, INC. - OPERATOR

NAVAJO No. 2-E

SWNENW Sec. 11, T25N, R10W
 San Juan County, New Mexico
 14-20-603-~~1328~~-1371

RIG SITE LAYOUT



Consolidated Oil & Gas, Inc.

POWER BUILDING
LINCOLN STREET
COLORADO 80295
(303) 861-5252

July 23, 1980

U. S. Geological Survey
P. O. Box 959
Farmington, New Mexico 87401

Re: Application for Permit to Drill
Navajo No. 2-E
San Juan County, New Mexico
14-20-603-~~1328~~ 1371

Gentlemen:

Following is the information requested in NTL-6 to accompany the permit to drill:

1. Location: 790' FNL, 1833' FWL, "C", Sec. 11, T25N, R10W, San Juan County, New Mexico
2. Elevation of Unprepared Ground: 6767;
3. Geologic Name of Surface Formation: Nacimiento
4. Type of Drilling Tools: Rotary
5. Proposed Drilling Depth: 6875'
6. Estimated Geologic Markers:

Ojo Alamo	1150'	
Pictured Cliffs	2055'	
Pt. Lookout	4500'	X
Greenhorn	6410'	X
Dakota	6575'	X
7. Anticipated Gas & Oil
8. Casing Program and Setting Depth:

	<u>Size</u>	<u>Weight</u>	<u>Grade</u>	<u>Condition</u>	<u>Setting Depth</u>
Surface	8-5/8"	24.0#	K-55	New	250'
Production	5-1/2"	15.5#	K-55	New	6875'

9. Casing Setting Depth and Cementing:

Surface casing will be set at 250'. Cement will be circulated to surface with approximately 200 sx. Class "B" neat cement containing 2% CaCl_2 .

Cementing Prognosis:

Production casing will be run to total depth. One stage collar will be run in the casing string at approximately 1450'. The casing will be cemented in two stages as follows:

1st Stage: 60 sx. 65/35 Pozmix with 12% gel, tailed in with 160 sx. 50/50 Pozmix with 4% gel and 0.5% FLA

2nd Stage: 240 sx. 65/35 Pozmix with 12% gel, tailed in with 50 sx. 50/50 Pozmix with 2% gel and 0.4% FLA.

Note: Exact volume of cement to be determined after running Caliper log.

10. Pressure Control Equipment: See attached Diagram "A"

11. Circulating Media: 0-250' fresh water spud mud; 250'-TD fresh water, low solid mud with following properties:

Viscosity 32-28 sec., water loss 20-6 cc, weight 8.5-9.0 ppg with heavier weights if required by well conditions.

12. Testing, Logging and Coring Programs:

- a. Open hole logs will be run prior to running production casing.
- b. Coring is not planned.

13. Abnormal Pressure or Temperature and Hydrogen Sulfide Gas:

We do not anticipate abnormal pressure, temperature or hydrogen sulfide gas; however, a remote control blowout preventer as shown on attached Diagram "A" will be installed.

14. Anticipated Starting Date: Drilling operations should start within 60 days after approval.

15. Other Facets of the Proposed Operations: None

Yours very truly,

CONSOLIDATED OIL & GAS, INC.

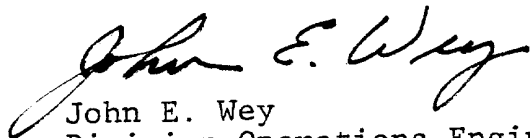

John E. Wey
Division Operations Engineer
Rocky Mountain Division

JEW:lt
Attach.