

UNITED STATES  
DEPARTMENT OF THE INTERIOR  
GEOLOGICAL SURVEY

APPLICATION FOR PERMIT TO DRILL, DEEPEN, OR PLUG BACK

1a. TYPE OF WORK

DRILL ☒

DEEPEN ☐

PLUG BACK ☐

b. TYPE OF WELL

OIL  
WELL ☒

GAS  
WELL ☐

OTHER

SINGLE  
ZONE ☒

MULTIPLE  
ZONE ☐

2. NAME OF OPERATOR

Shell Oil Company

3. ADDRESS OF OPERATOR

P. O. Box 831, Houston, Texas 77001 Attn. G. M. Jobe Rm 19104

4. LOCATION OF WELL (Report location clearly and in accordance with any State requirements.)

At surface

1500' FSL & 1520' FWL Section 13

At proposed prod. zone

14. DISTANCE IN MILES AND DIRECTION FROM NEAREST TOWN OR POST OFFICE\*

Approximately 24+ air miles southeast of Farmington, N. Mexico

15. DISTANCE FROM PROPOSED\*

LOCATION TO NEAREST  
PROPERTY OR LEASE LINE, FT.  
(Also to nearest drlg. unit line, if any)

990'

16. NO. OF ACRES IN LEASE

2560

17. NO. OF ACRES ASSIGNED  
TO THIS WELL

160

18. DISTANCE FROM PROPOSED LOCATION\*

TO NEAREST WELL, DRILLING, COMPLETED,  
OR APPLIED FOR, ON THIS LEASE, FT. Carson Unit 203

2,200'+ from

19. PROPOSED DEPTH

1291'+

20. ROTARY OR CABLE TOOLS

Rotary

21. ELEVATIONS (Show whether DF, RT, GR, etc.)

6391' GR

22. APPROX. DATE WORK WILL START\*

Upon permit approval

23.

PROPOSED CASING AND CEMENTING PROGRAM

SIZE OF HOLE	SIZE OF CASING	WEIGHT PER FOOT	SETTING DEPTH	QUANTITY OF CEMENT

ATTACHMENTS:

13 MULTI-POINT SURFACE USE PLAN  
TOPO & ROAD MAP - ATTACHMENT A  
VICINITY MAP - ATTACHMENT B  
SURVEY RECORD - ATTACHMENT C  
DRILLING PROGNOSIS - ATTACHMENT D  
BOP SCHEMATIC - ATTACHMENT E  
ARCHAEOLOGY REPORT COMPLETE - ATTACHMENT F

IN ABOVE SPACE DESCRIBE PROPOSED PROGRAM: If proposal is to deepen or plug back, give data on present productive zone and proposed new productive zone. If proposal is to drill or deepen directionally, give pertinent data on subsurface locations and measured and true vertical depths. Give blowout preventer program, if any.

24.

SIGNED

*G. M. Jobe*

TITLE

Supervisor Regulatory Permits

DATE

9/18/80

(This space for Federal or State office use)

*Bruce Handley*

PERMIT NO.

APPROVAL DATE

APPROVED BY

CONDITIONS OF APPROVAL, IF ANY:

TITLE

DATE

CC: OIL CONSERVATION DIVISION  
STATE OF NEW MEXICO

*ok 3m*

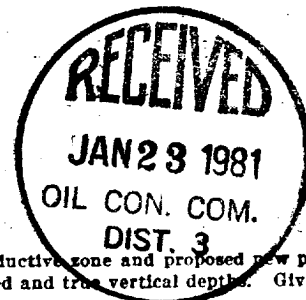

CARTON UNIT			Well No. 204
Range 17N	County San Juan		
Section 35E	Line 15E	Dedicated Acreage: 16.0 Acres	

- Outline the acreage dedicated to the subject well by colored pencil or machine marks on the plat below.
- If more than one lease is dedicated to the well, outline each and identify the ownership thereof (both as to working interest and royalty).
- If more than one lease of different ownership is dedicated to the well, have the interests of all owners been consolidated by communitization, unitization, forced-pooling, etc?  
☐ Yes   ☐ No   If answer is "yes," type of consolidation: \_\_\_\_\_

If answer is "no," list the owners and tract descriptions which have actually been consolidated. (Use reverse side of this form if necessary) \_\_\_\_\_

No allowable will be assigned to the well until all interests have been consolidated (by communitization, unitization, forced-pooling, or otherwise) or until a non-standard unit, eliminating such interests, has been approved by the Commission.

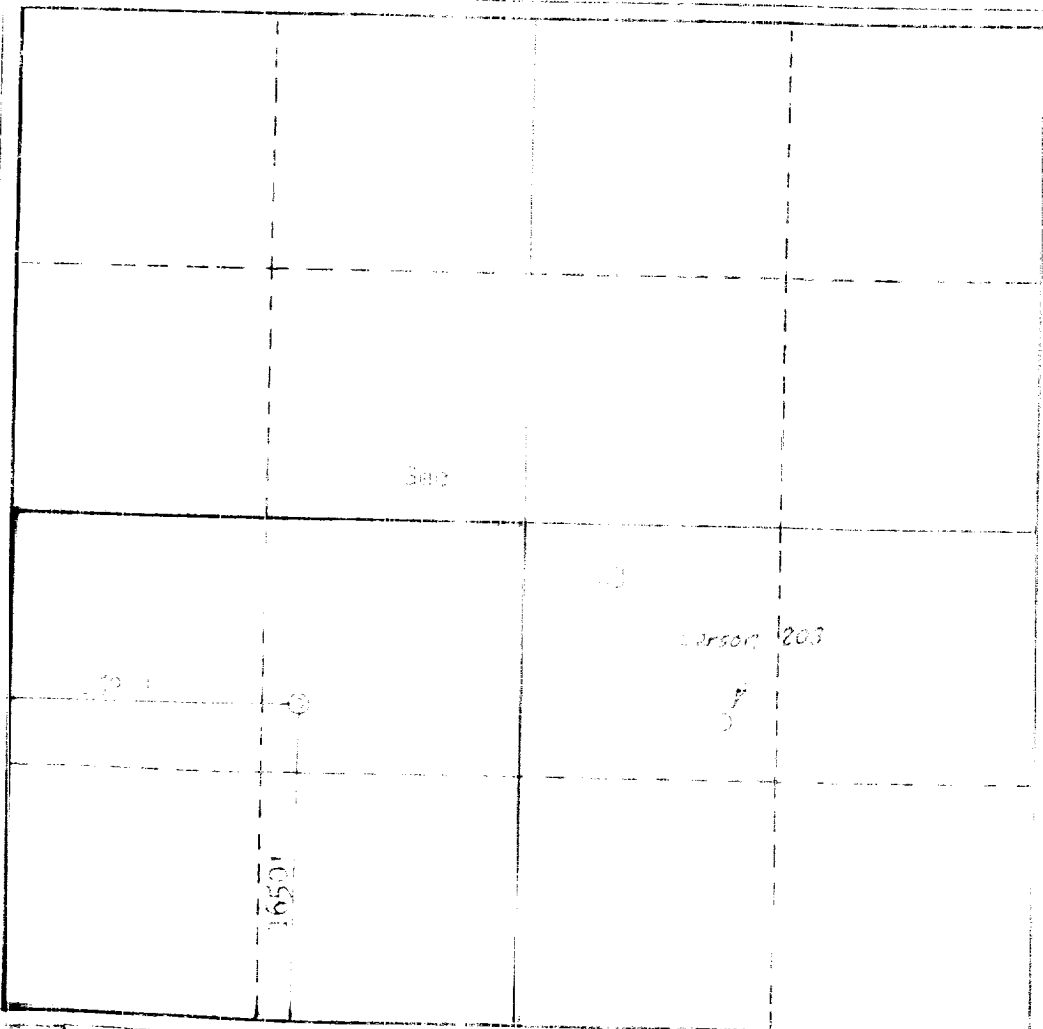

CERTIFICATION	
I hereby certify that the information contained herein is true and complete to the best of my knowledge and belief.	
Name <i>B. M. Kerr Jr.</i>	Position Supervisor Regulatory Permits
Company Shell Oil Company	
Date 1-24-80	
I hereby certify that the well location shown on this plat was plotted from field notes of actual surveys made by me or under my supervision, and that the same is true and correct to the best of my knowledge and belief.	
Date Surveyed March 21, 1980	
Registered Professional Engineer and/or Land Surveyor <i>Fred B. Kerr Jr.</i> Fred B. Kerr Jr.	
Certificate No. 3950	