

5253

30-045-25320

UNITED STATES
DEPARTMENT OF THE INTERIOR
GEOLOGICAL SURVEY

APPLICATION FOR PERMIT TO DRILL, DEEPEN, OR PLUG BACK

1a. TYPE OF WORK
 DRILL DEEPEN PLUG BACK

b. TYPE OF WELL
 OIL WELL GAS WELL OTHER SINGLE ZONE MULTIPLE ZONE

2. NAME OF OPERATOR
 Tenneco Oil Company

3. ADDRESS OF OPERATOR
 P. O. Box 3249, Englewood, CO 80155

4. LOCATION OF WELL (Report location clearly and in accordance with any State requirements.*)
 At surface 1660' FNL 2400' FEL
 At proposed prod. zone same as above

5. LEASE DESIGNATION AND SERIAL NO.
 SF-011254

6. IF INDIAN, ALLOTTEE OR TRIBE NAME
 Ken No To

7. UNIT AGREEMENT NAME

8. FARM OR LEASE NAME
 Navajo Ken No To

9. WELL NO.
 1

10. FIELD AND POOL, OR WILDCAT
 Bisti Gallup

11. SEC., T., R., M., OR BLK. AND SURVEY OR AREA
 G Sec. 26, T75N R11W

12. COUNTY OR PARISH
 San Juan

13. STATE
 New Mexico

14. DISTANCE IN MILES AND DIRECTION FROM NEAREST TOWN OR POST OFFICE*
 22.62 miles SW of Bloomfield, New Mexico

15. DISTANCE FROM PROPOSED* LOCATION TO NEAREST PROPERTY OR LEASE LINE, FT. (Also to nearest drig. unit line, if any) 1660'

16. NO. OF ACRES IN LEASE 160

17. NO. OF ACRES ASSIGNED TO THIS WELL
 S/A NE/4 80

18. DISTANCE FROM PROPOSED* LOCATION TO NEAREST WELL, DRILLING COMPLETED, OR APPLIED FOR, ON THIS LEASE, FT. ± 5200'

19. PROPOSED DEPTH ± 5200'

20. ROTARY OR CABLE TOOLS
 Rotary

21. ELEVATIONS (Show whether DF, RT, GR, etc.)
 6564' ground

22. APPROX. DATE WORK WILL START*
 ASAP

23. PROPOSED CASING AND CEMENTING PROGRAM

SIZE OF HOLE	SIZE OF CASING	WEIGHT PER FOOT	SETTING DEPTH	QUANTITY OF CEMENT
12-1/4"	9-5/8"	36#	± 350'	Circ cmt to surface
7-7/8"	5-1/2"	15.5#, 17#	± 5200'	2 stg cmt job, circ 2nd stage to surface

Gas is dedicated

See attached drilling procedures.

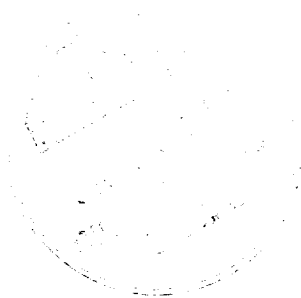

APPROVED
 AS AUTHORIZED
 JAN 25 1982
 Dean Elliott
 For JAMES F. LINDS
 DISTRICT ENGINEER

IN ABOVE SPACE DESCRIBE PROPOSED PROGRAM: If proposal is to deepen or plug back, give data on present productive zone and proposed new productive zone. If proposal is to drill or deepen directionally, give pertinent data on subsurface locations and measured and true vertical depths. Give blowout preventer program, if any.

24. SIGNED Don H. Morrison TITLE Production Analyst DATE 12/16/81
 (This space for Federal or State office use)

PERMIT NO. _____ APPROVAL DATE _____

APPROVED BY _____ TITLE _____ DATE _____

CONDITIONS OF APPROVAL, IF ANY:

DRILLING OPERATIONS AUTHORIZED ARE
SUBJECT TO COMPLIANCE WITH ATTACHED
"GENERAL REQUIREMENTS"

ch 2

NMOCC

OIL CONSERVATION DIVISION

STATE OF NEW MEXICO
 GEOLOGY AND MINERALS DEPARTMENT

P. O. BOX 2088
 SANTA FE, NEW MEXICO 87501

Form C-107
 Revised 10-1-78

All distances must be from the outer boundaries of the Section.

Operator TENNECO OIL COMPANY		Lease NAVAJO KEN-NO-TO			Well No. 1
Unit Letter G	Section 26	Township 25N	Range 11W	County San Juan	
Actual Footage Location of Well: 1660 feet from the North line and 2400 feet from the East line					
Ground Level Elev. 6564	Producing Formation Gallup		Pool Risti Gallup		Dedicated Acreage: S/2 NE/4 80 Acres

1. Outline the acreage dedicated to the subject well by colored pencil or hachure marks on the plat below.
2. If more than one lease is dedicated to the well, outline each and identify the ownership thereof (both as to working interest and royalty).
3. If more than one lease of different ownership is dedicated to the well, have the interests of all owners been consolidated by communitization, unitization, force-pooling, etc?

Yes No If answer is "yes," type of consolidation _____

If answer is "no," list the owners and tract descriptions which have actually been consolidated. (Use reverse side of this form if necessary.) _____

No allowable will be assigned to the well until all interests have been consolidated (by communitization, unitization, forced-pooling, or otherwise) or until a non-standard unit, eliminating such interests, has been approved by the Commission.

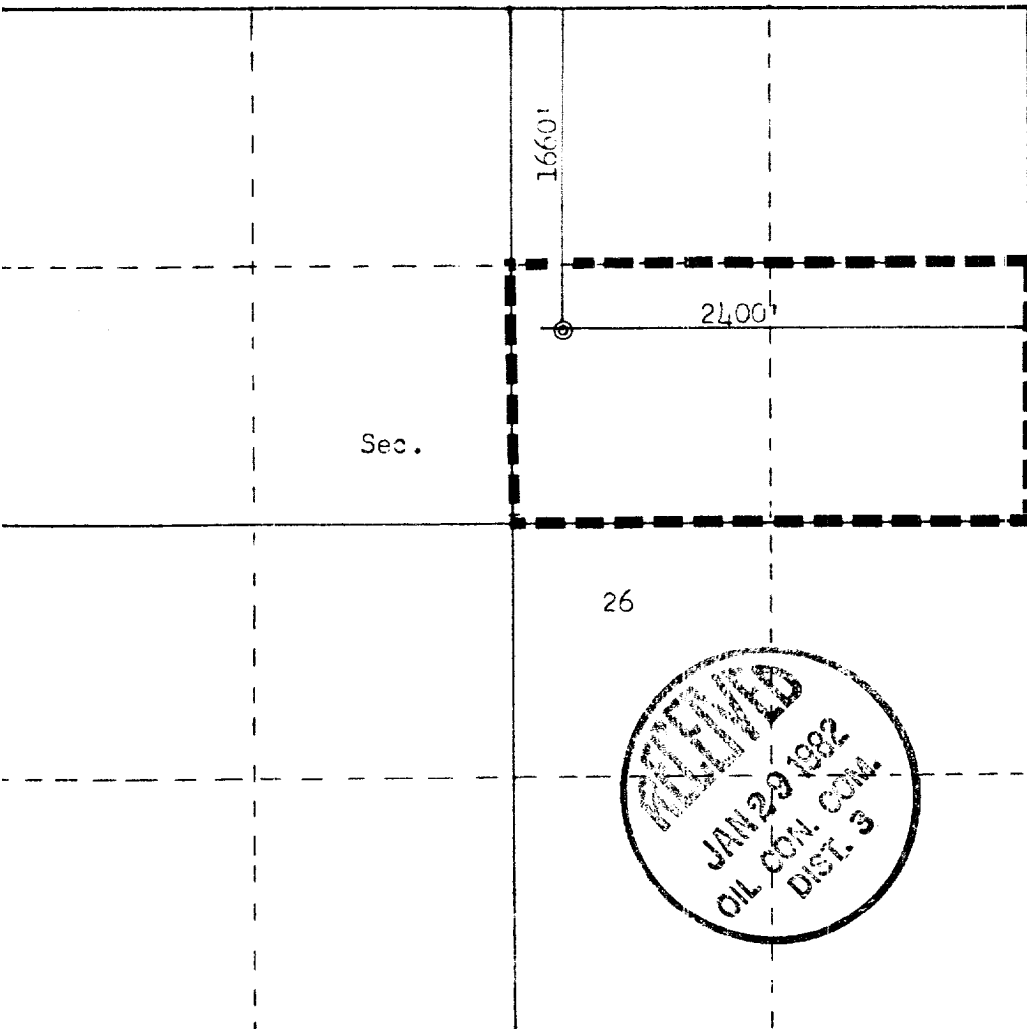

CERTIFICATION
I hereby certify that the information contained herein is true and complete to the best of my knowledge and belief.
Name <i>Don L. Morrison</i>
Position Production Analyst
Company Tenneco Oil Company
Date 10-13-81
I hereby certify that the well location shown on this plat was plotted from field notes of actual surveys made by me or under my supervision, and that the same is true and correct to the best of my knowledge and belief.
Date Surveyed September 27, 1981
Registered Professional Engineer and Land Surveyor <i>Fred B. Kern Jr.</i>
Certificate No. _____