

(May 1982)

**UNITED STATES  
DEPARTMENT OF THE INTERIOR  
GEOLOGICAL SURVEY**

(Other instructions on  
reverse side)

Budget Form No. 42 1-1425

**APPLICATION FOR PERMIT TO DRILL, DEEPEN, OR PLUG BACK**

1a. TYPE OF WORK

DRILL ☒DEEPEN ☐PLUG BACK ☐

b. TYPE OF WELL

OIL  
WELL ☐GAS  
WELL ☒

OTHER

SINGLE  
ZONE ☐MULTIPLE  
ZONE ☐

2. NAME OF OPERATOR

Hixon Development Company

3. ADDRESS OF OPERATOR

P.O. Box 2810, Farmington, New Mexico 87401

4. LOCATION OF WELL (Report location clearly and in accordance with any State requirements)

At surface

1650' FSL, 1650' FWL, Section 15, T25N, R12W

At proposed prod. zone

14. DISTANCE IN MILES AND DIRECTION FROM NEAREST TOWN OR POST OFFICE\*

24 miles south of Farmington

15. DISTANCE FROM PROPOSED\*

LOCATION TO NEAREST  
PROPERTY OR LEASE LINE, FT.  
(Also to nearest drilg. unit line, if any)

16. NO. OF ACRES OF LEASE

U. S. GEOLOGICAL SURVEY  
FARMINGTON, N. M.

17. NO. OF ACRES ASSIGNED

TO THIS WELL

160 acres

18. DISTANCE FROM PROPOSED LOCATION\*

TO NEAREST WELL, DRILLING, COMPLETED,  
OR APPLIED FOR, ON THIS LEASE, FT.

19. PROPOSED DEPTH

1300'

20. ROTARY OR CABLE TOOLS

Rotary

21. ELEVATIONS (Show whether DF, RT, GR, etc.)

6250' GLE

22. APPROX. DATE WORK WILL START\*

November 1, 1982

23. PROPOSED CASING AND CEMENTING PROGRAM

SIZE OF HOLE	SIZE OF CASING	WEIGHT PER FOOT	SETTING DEPTH	QUANTITY OF CEMENT
9-3/4"	7"	20#	90'	50 sacks (circulated)
5-1/4"	2-7/8"	6.5#	1300'	175 sacks (circulated)

It is planned to drill a slimhole shallow gas Pictured Cliffs test  
per the attached.

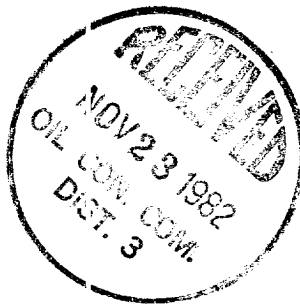

IN ABOVE SPACE DESCRIBE PROPOSED PROGRAM: If proposal is to deepen or plug back, give data on present productive zone and proposed new productive zone. If proposal is to drill or deepen directionally, give pertinent data on subsurface locations and measured and true vertical depths. Give blowout preventer program, if any.

24.

SIGNED

TITLE

Petroleum Engineer

DATE

10/12/82

(This space for Federal or State office use)

PERMIT NO.

APPROVAL DATE

APPROVED BY

TITLE

CONDITIONS OF APPROVAL, IF ANY:

**APPROVED  
AS AMENDED**

NOV 22 1982

JAMES F. SIMS  
DISTRICT ENGINEER

NMOCC

All distances must be from the outer boundaries of the Section

Operator Hixon Development Company		Carson Unit			Well No. 204
Unit Letter K	Section 15	Township 25 North	Range 12 West	County San Juan	
Actual Footage Location of Well: 1650 feet from the South line and 1650 feet from the West line					
Ground Level Elev. 6250	Producing Formation Pictured Cliffs	Pool WAW-Fruitland-PC	Dedicated Acreage: 160 Acres		Ext.

1. Outline the acreage dedicated to the subject well by colored pencil or hachure marks on the plat below.
2. If more than one lease is dedicated to the well, outline each and identify the ownership thereof (both as to working interest and royalty).
3. If more than one lease of different ownership is dedicated to the well, have the interests of all owners been consolidated by communitization, unitization, force-pooling, etc?

☐ Yes ☐ No If answer is "yes," type of consolidation \_\_\_\_\_

If answer is "no," list the owners and tract descriptions which have actually been consolidated. (Use reverse side of this form if necessary.) \_\_\_\_\_

No allowable will be assigned to the well until all interests have been consolidated (by communitization, unitization, forced-pooling, or otherwise) or until a non-standard unit, eliminating such interests, has been approved by the Division.

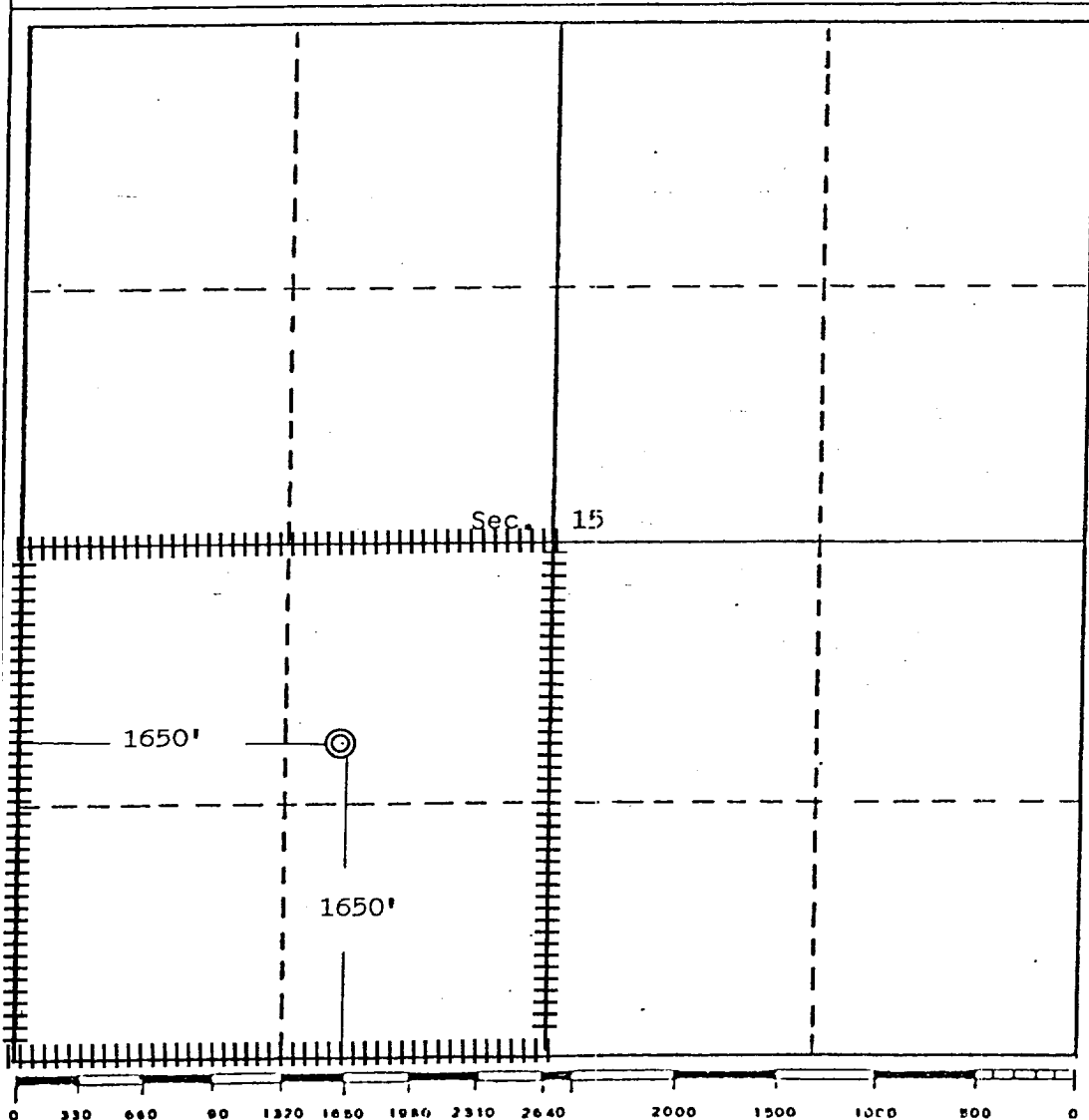

## CERTIFICATION

I hereby certify that the information contained herein is true and complete to the best of my knowledge and belief.

*Aldrich L. Kuchera*  
Name

Aldrich L. Kuchera

Position

Petroleum Engineer

Company

Hixon Development Company

Date

October 12, 1982

I hereby certify that the location shown on this plat is the location of the well shown on field notes of actual surveys made by me or under my supervision, and that the same is true and correct to the best of my knowledge and belief.



Date Surveyed

October 11, 1982

Registered Professional Engineer  
or d/or Land Surveyor

*Edgar L. Risenhoover*  
Certificate No. 5979

Edgar L. Risenhoover

