

UNITED STATES  
DEPARTMENT OF THE INTERIOR  
GEOLOGICAL SURVEY

30-045-25927

## APPLICATION FOR PERMIT TO DRILL, DEEPEN, OR PLUG BACK

1a. TYPE OF WORK DRILL <input checked="" type="checkbox"/> DEEPEN <input type="checkbox"/> PLUG BACK <input type="checkbox"/>		5. LEASE DESIGNATION AND SERIAL NO. NM 47169
b. TYPE OF WELL OIL WELL <input type="checkbox"/> GAS WELL <input checked="" type="checkbox"/> OTHER <input type="checkbox"/>		8. IF INDIAN, ALLOTTEE OR TRIBE NAME
2. NAME OF OPERATOR Merrion Oil & Gas Corporation		7. UNIT AGREEMENT NAME
3. ADDRESS OF OPERATOR P. O. Box 1017, Farmington, New Mexico 87401		6. FARM OR LEASE NAME SOB Federal
4. LOCATION OF WELL (Report location clearly and in accordance with any State requirements) At surface 1850 FNL & 990 FWL At proposed prod. zone Same		9. WELL NO. 1
14. DISTANCE IN MILES AND DIRECTION FROM NEAREST TOWN OR POST OFFICE		10. FIELD AND POOL, OR WILDCAT Dufers Point Gallup Dakota
15. DISTANCE FROM PROPOSED LOCATION TO NEAREST PROPERTY OR LEASE LINE, FT. (Also to nearest drlg. unit line, if any) 790 ft.		11. SEC. T., R., N., OR S.W. AND SURVEY OR AREA Section 8, T25N, R8W
16. NO. OF ACRES IN LEASE 790 ft.		12. COUNTY OR PARISH San Juan
17. NO. OF ACRES ASSIGNED TO THIS WELL 160		13. STATE New Mexico
18. DISTANCE FROM PROPOSED LOCATION TO NEAREST WELL, DRILLING, COMPLETED, OR APPLIED FOR, ON THIS LEASE, FT. N/A		20. ROTARY OR CABLE TOOLS Rotary
21. ELEVATIONS (Show whether DF, RT, GR, etc.) 6441' G.L.		22. APPROX. DATE WORK WILL START Spring, 1984

## PROPOSED CASING AND CEMENTING PROGRAM

SIZE OF HOLE	SIZE OF CASING	WEIGHT PER FOOT	SETTING DEPTH	QUANTITY OF CEMENT
12-1/4"	8-5/8"	20 #/ft J-55	200	175 SX (360.5 cu. ft.)
7-7/8"	4-1/2"	10.5 #/ft. J-55	6630	785 SX (950 cu. ft.)

Propose to drill 12-1/4" hole to 200'. Will set 200' 8-5/8" 20 #/ft surface casing w/175 sx 'B' 2% CACL<sub>2</sub>. Will drill 7-7/8" hole to 6,560 ft. Will run open hole logs. If app. productive will run new 4-1/2" 10.5 #/ft casing to TD and cement. 1st stage to cover Gallup and Dakota w/450 sx Class 'H' 2% gel. Will cement second stage to cover Mesaverde w/165 sx Class 'B' 2% D-79 followed by 50 sx 'H' 2% gel. Will cement third stage w/70 Class 'B' 2% D-79 followed by 50 sx Class 'H' 2% gel to cover Pictured Cliffs, Fruitland, Kirtland, and Ojo Alamo. Will perforate and frac as required. 10" 900 series double ram blowout preventers will be used on all drilling. 6" 900 series double ram blowout preventers will be used on completion.

## ESTIMATED TOPS

Ojo Alamo	1237	Mesaverde	3527
Kirtland	1357	Mancos	4637
Fruitland	1687	Gallup	5437
Pictured Cliff	1957	Greenhorn	6302
Lewis Shale	2152	Graneros	6387

(This is a re-submission of a rescinded APD.)

IN ABOVE SPACE DESCRIBE PROPOSED PROGRAM: If proposal is to deepen or plug back, give data on present productive zone and proposed new productive zone. If proposal is to drill or deepen directionally, give pertinent data on subsurface locations and measured and true vertical depths. Give blowout preventer program, if any.

SIGNED <u>[Signature]</u>	TITLE <u>Operations Manager</u>	<b>APPROVED</b> MAR 26 1984 <u>[Signature]</u> AREA MANAGER FARMINGTON RESOURCE AREA
(This space for Federal or State office use)		
PERMIT NO. <u>RECEIVED</u>	APPROVAL DATE <u>MAR 28 1984</u>	
APPROVED BY <u>[Signature]</u>	TITLE <u>Oil Con. Div.</u>	
CONDITIONS OF APPROVAL, IF ANY: OIL CON. DIV. DIST. 3		

NMOCC

All distances must be from the outer boundaries of the Section.

Operator <b>Merrion Oil &amp; Gas Corp.</b>			Lease <b>SOB Fed</b>		Well No. <b>1</b>
Unit Letter <b>E</b>	Section <b>8</b>	Township <b>25N</b>	Range <b>8W</b>	County <b>San Juan</b>	
Actual Footage Location of Well: <b>1850</b> feet from the <b>North</b> line and <b>990</b> feet from the <b>West</b> line					
Ground Level Elev. <b>6441</b>	Producing Formation <b>Dakota</b>		Pool <b>Dufers Point Gallup Dakota</b>		Dedicated Acreage: <b>160</b> Acres

1. Outline the acreage dedicated to the subject well by colored pencil or hachure marks on the plat below.
2. If more than one lease is dedicated to the well, outline each and identify the ownership thereof (both as to working interest and royalty).
3. If more than one lease of different ownership is dedicated to the well, have the interests of all owners been consolidated by communitization, unitization, force-pooling, etc?

☐ Yes ☐ No If answer is "yes," type of consolidation \_\_\_\_\_

If answer is "no," list the owners and tract descriptions which have actually been consolidated. (Use reverse side of this form if necessary.) \_\_\_\_\_

No allowable will be assigned to the well until all interests have been consolidated (by communitization, unitization, forced-pooling, or otherwise) or until a non-standard unit, eliminating such interests, has been approved by the Commission.

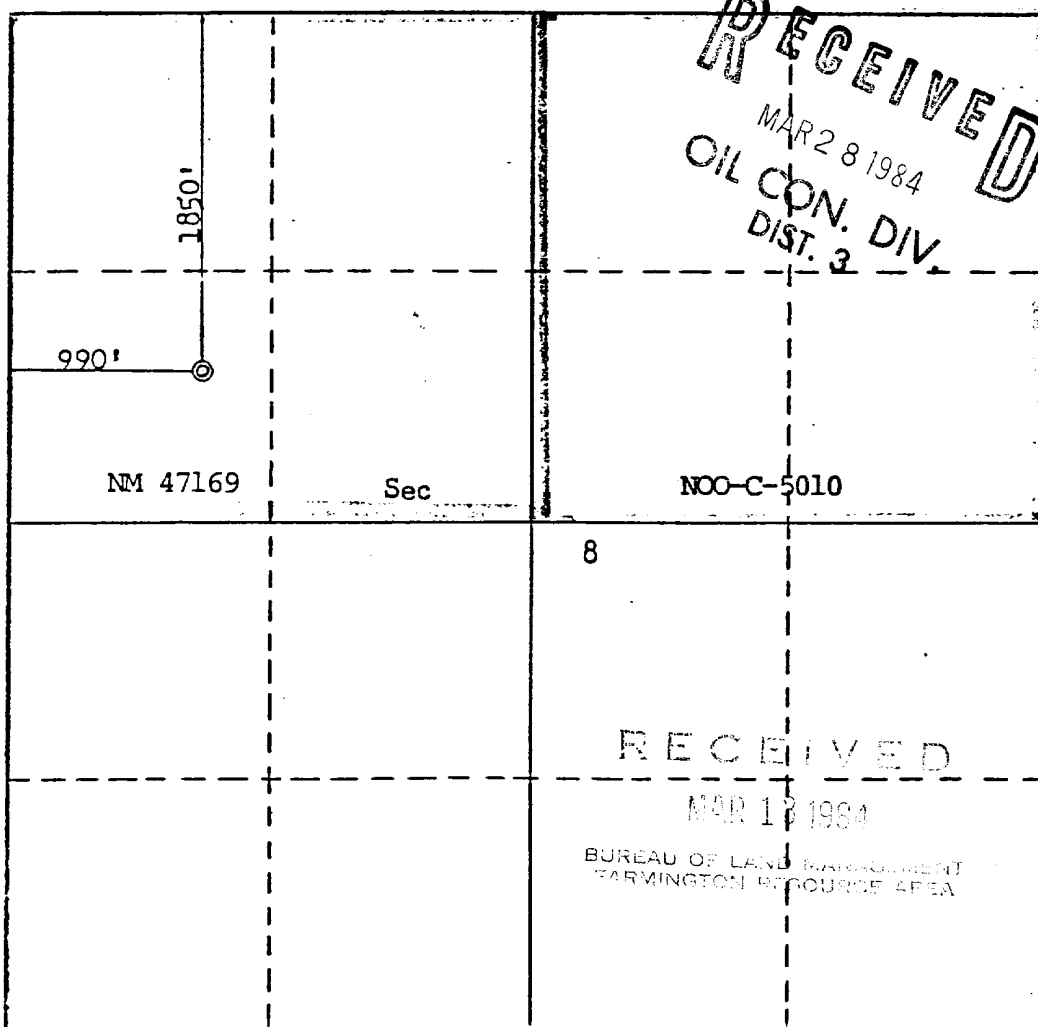

## CERTIFICATION

I hereby certify that the information contained herein is true and complete to the best of my knowledge and belief.

*Steve S. Dunn*  
Name  
**Steve S. Dunn**

Position  
**Operations Manager**

Company  
**Merrion Oil & Gas Corporation**

Date  
**3/12/82**

I hereby certify that the well location shown on this plat was plotted from field notes of actual surveys made by me or under my supervision, and that the same is true and correct to the best of my knowledge and belief.

Date Surveyed  
**March 9, 1982**

Registered Professional Engineer  
and/or Land Surveyor

*Fred E. Kerr Jr.*  
**Fred E. Kerr Jr.**

Certificate No.

**3950**

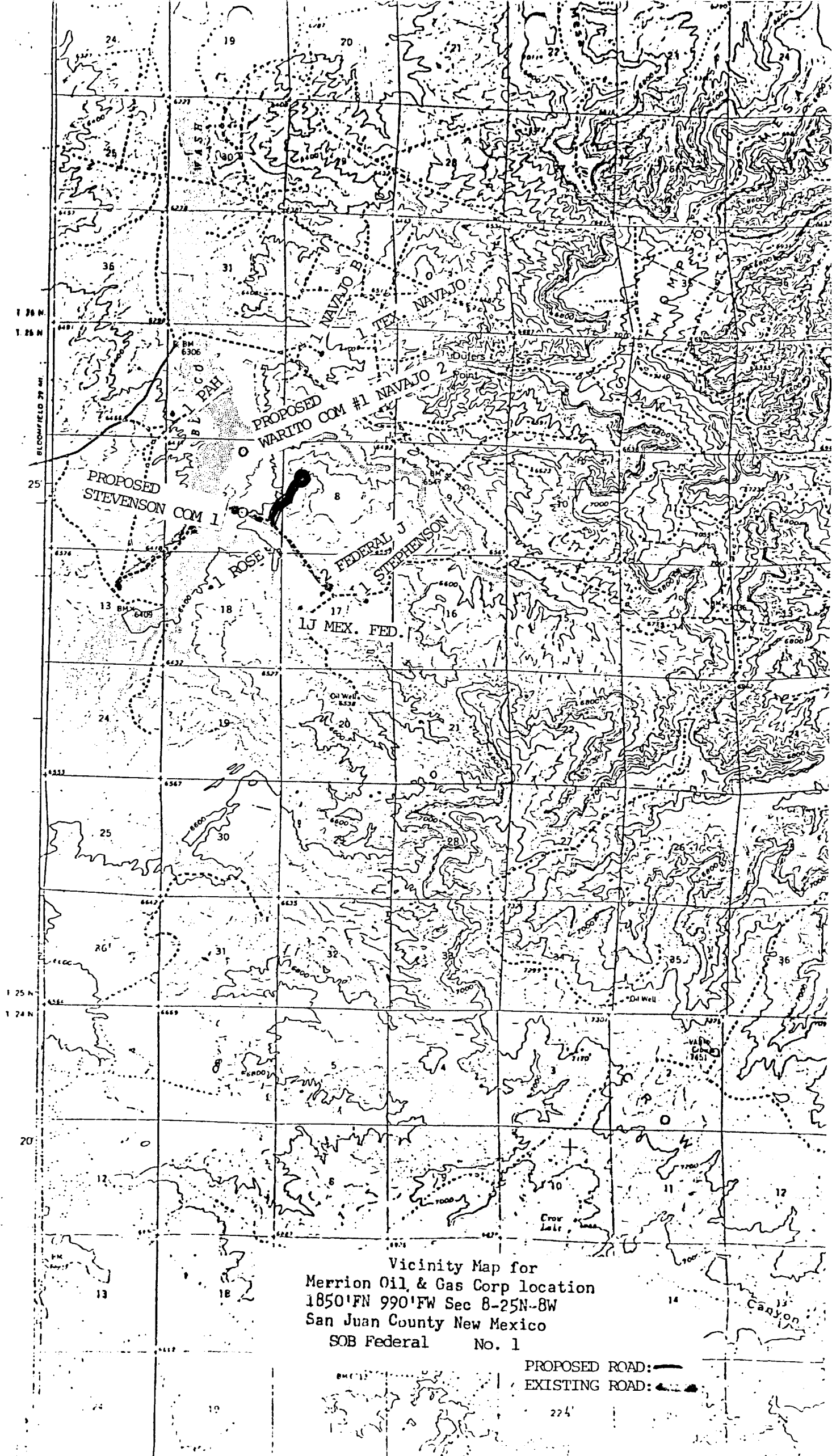

Vicinity Map for  
Merrion Oil & Gas Corp location  
1850'FN 990'FW Sec 8-25N-8W  
San Juan County New Mexico  
SOB Federal No. 1

PROPOSED ROAD: —  
EXISTING ROAD: - - -