

UNITED STATES  
DEPARTMENT OF THE INTERIOR  
GEOLOGICAL SURVEY

30-045-25933

APPLICATION FOR PERMIT TO DRILL, DEEPEN, OR PLUG BACK

1a. TYPE OF WORK  
DRILL ☒ DEEPEN ☐ PLUG BACK ☐

b. TYPE OF WELL  
OIL WELL ☒ GAS WELL ☐ OTHER ☐  
SINGLE ZONE ☐ MULTIPLE ZONE ☐

2. NAME OF OPERATOR  
HIXON DEVELOPMENT COMPANY

3. ADDRESS OF OPERATOR  
P.O. BOX 2810, FARMINGTON, NEW MEXICO, 87499

4. LOCATION OF WELL (Report location clearly and in accordance with any State requirements.\*)  
At surface  
1090' FSL, 1550' FWL, SEC. 15, T25N, R12W  
At proposed prod. zone

14. DISTANCE IN MILES AND DIRECTION FROM NEAREST TOWN OR POST OFFICE\*  
26 MILES SOUTH OF FARMINGTON

15. DISTANCE FROM PROPOSED\*  
LOCATION TO NEAREST  
PROPERTY OR LEASE LINE, FT.  
(Also to nearest drlg. unit line, if any)

18. DISTANCE FROM PROPOSED LOCATION\*  
TO NEAREST WELL, DRILLING, COMPLETED,  
OR APPLIED FOR, ON THIS LEASE, FT.

21. ELEVATIONS (Show whether DF, RT, GR, etc.)  
6259' GLE

23. DRILLING OPERATIONS AUTHORIZED ARE  
SUBJECT TO COMPLIANCE WITH ATTACHED  
"GENERAL REQUIREMENTS" AND CEMENTING PROGRAM

SIZE OF HOLE	SIZE OF CASING	WEIGHT PER FOOT	SETTING DEPTH	QUANTITY OF CEMENT
12-1/4"	8-5/8"	24#	200'	150 SACKS
7-7/8"	5-1/2"	15.5#	4930'	300 SACKS

IT IS PROPOSED TO DRILL THE SUBJECT BISTI LOWER GALLUP POOL INFILL WELL. IT WILL BE EVALUATED ON THE BASIS OF OPEN HOLE LOGS. PLEASE REFER TO THE ATTACHED NTL-6 DATA.

RECEIVED

MAR 29 1984

OIL CON. DIV.  
DIST. 3

IN ABOVE SPACE DESCRIBE PROPOSED PROGRAM: If proposal is to deepen or plug back, give data on present productive zone and proposed new productive zone. If proposal is to drill or deepen directionally, give pertinent data on subsurface locations and measured and true vertical depths. Give blowout preventer program, if any.

24. SIGNED *[Signature]* PETROLEUM ENGINEER

(This space for Federal or State office use)

PERMIT NO.

APPROVAL DATE

APPROVED BY

TITLE

CONDITIONS OF APPROVAL, IF ANY:

DATE 12/21/83

APPROVED  
AS AMENDED

DATE MAR 27 1984

*[Signature]*  
AREA MANAGER  
FARMINGTON RESOURCE AREA

NMOCC

## OIL CONSERVATION DIVISION

STATE OF NEW MEXICO  
ENERGY AND MINERALS DEPARTMENT

P. O. BOX 2088

SANTA FE, NEW MEXICO 87501

Form C-102  
Revised 10-1-78

All distances must be from the outer boundaries of the Section.

Operator <b>Hixon Development Company</b>			Lease <b>Carson Unit</b>		Well No. <b>24-15</b>
Unit Letter <b>N</b>	Section <b>15</b>	Township <b>25 North</b>	Range <b>12 West</b>	County <b>San Juan</b>	
Actual Footage Location of Well: <b>1090</b> feet from the <b>South</b> line and <b>1550</b> feet from the <b>West</b> line					
Ground Level Elev. <b>6257</b>	Producing Formation <b>Lower Gallup</b>		Pool <b>Bisti Lower Gallup</b>	Dedicated Acreage: <b>80</b> Acres	

1. Outline the acreage dedicated to the subject well by colored pencil or hatchure marks on the plat below.
2. If more than one lease is dedicated to the well, outline each and identify the ownership thereof (both as to working interest and royalty).
3. If more than one lease of different ownership is dedicated to the well, have the interests of all owners been consolidated by communitization, unitization, force-pooling, etc?

☐ Yes ☐ No If answer is "yes," type of consolidation \_\_\_\_\_

If answer is "no," list the owners and tract descriptions which have actually been consolidated. (Use reverse side of this form if necessary.) \_\_\_\_\_

No allowable will be assigned to the well until all interests have been consolidated (by communitization, unitization, forced-pooling, or otherwise) or until a non-standard unit, eliminating such interests, has been approved by the Division.

**RECEIVED**

MAR 29 1984

OIL CON. DIV.  
DIST. 3**RECEIVED**

FEB 18 1984

BUREAU OF LAND MANAGEMENT  
FARMINGTON DISTRICT OFFICE

Sec. 15

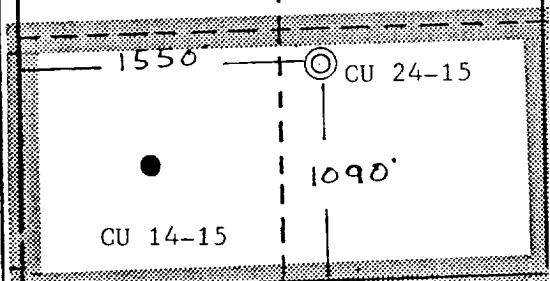

## CERTIFICATION

I hereby certify that the information contained herein is true and complete to the best of my knowledge and belief.

Name

Aldrich L. Kuchera

Position

Petroleum Engineer

Company

Hixon Development Company

Date

February 9, 1984

I hereby certify that the location shown on this plat was plotted from field notes of actual measurements made by me or under my supervision, and that the same is true and correct to the best of my knowledge and belief.

Date Surveyed

February 8, 1984

Registered Professional Engineer  
and/or Land Surveyor

Edgar L. Risenhoover

Certificate No. 5979

Edgar L. Risenhoover, L.S.

