

UNITED STATES
DEPARTMENT OF THE INTERIOR
GEOLOGICAL SURVEY

APPLICATION FOR PERMIT TO DRILL, DEEPEN, OR PLUG BACK

1a. TYPE OF WORK
DRILL ☒ DEEPEN ☐ PLUG BACK ☐

b. TYPE OF WELL
OIL WELL ☒ GAS WELL ☐ OTHER ☐ SINGLE ZONE ☐ MULTIPLE ZONE ☐

2. NAME OF OPERATOR
Hixon Development Company

3. ADDRESS OF OPERATOR
P.O. Box 2810, Farmington, New Mexico 87499

4. LOCATION OF WELL (Report location clearly and in accordance with any State requirements.)
At surface
990' FSL, 990' FWL, Section 8, T25N, R12W
At proposed prod. zone

5. LEASE DESIGNATION AND SERIAL NO.
14-20-603-324

6. IF INDIAN, ALLOTTEE OR TRIBE NAME
NAVAJO

7. UNIT AGREEMENT NAME
Central-Bisti Lower Gallup Unit

8. FARM OR LEASE NAME
↓

9. WELL NO.
91

10. FIELD AND POOL, OR WILDCAT
Bisti Lower Gallup

11. SEC., T., R., M., OR BLK.
AND SURVEY OR AREA
Sec. 8, T25N, R12W

12. COUNTY OR PARISH
San Juan

13. STATE
New Mexico

14. DISTANCE IN MILES AND DIRECTION FROM NEAREST TOWN OR POST OFFICE*
26 miles south of Farmington

15. DISTANCE FROM PROPOSED* LOCATION TO NEAREST PROPERTY OR LEASE LINE, FT.
(Also to nearest drlg. unit line, if any)

16. NO. OF ACRES IN LEASE

17. NO. OF ACRES ASSIGNED TO THIS WELL
5/80 joint #468

18. DISTANCE FROM PROPOSED LOCATION* TO NEAREST WELL, DRILLING COMPLETED, OR APPLIED FOR, ON THIS LEASE, FT.

19. PROPOSED DEPTH
5060'

20. ROTARY OR CABLE TOOLS
Rotary

21. ELEVATIONS (Show whether DF, RT, GR, etc.)
6310' GLE

22. APPROX. DATE WORK WILL START*
3/1/84

23. DRILLING OPERATIONS AUTHORIZED ARE SUBJECT TO COMPLIANCE WITH ATTACHED "GENERAL REQUIREMENTS".
PROPOSED CASING AND CEMENTING PROGRAM

This action is subject to administrative appeal pursuant to 30 CFR 290.

SIZE OF HOLE	SIZE OF CASING	WEIGHT PER FOOT	SETTING DEPTH	QUANTITY OF CEMENT
12-1/4"	8-5/8"	24#	200'	150 sacks
7-7/8"	5-1/2"	15.5#	5060'	300 sacks

It is proposed to drill the subject Bisti Lower Gallup pool infill well. It will be evaluated on the basis of open hole logs. Please refer to the attached NTL-6 Data.

RECEIVED
APR 06 1984
OIL CON. DIV.
DIST. 3

IN ABOVE SPACE DESCRIBE PROPOSED PROGRAM: If proposal is to deepen or plug back, give data on present productive zone and proposed new productive zone. If proposal is to drill or deepen directionally, give pertinent data on subsurface locations and measured and true vertical depths. Give blowout preventer program, if any.

24. SIGNED _____ TITLE Petroleum Engineer

(This space for Federal or State office use)

PERMIT NO. _____ APPROVAL DATE _____

APPROVED BY _____ TITLE _____

CONDITIONS OF APPROVAL, IF ANY:

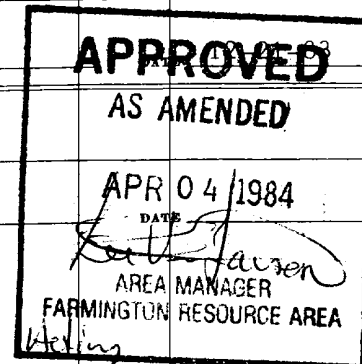

NMOCC

STATE OF NEW MEXICO
ENERGY AND MINERALS DEPARTMENT

LAND CONSERVATION DIVISION

P. O. BOX 2088

SANTA FE, NEW MEXICO 87501

Form C-102
Revised 10-1-78

All distances must be from the outer boundaries of the Section.

Operator Hixon Development Company			Lease Central Bisti Unit		Well No. 91
Unit Letter M	Section 8	Township 25 North	Range 12 West	County San Juan	
Actual Footage Location of Well: 990 feet from the South line and 990 feet from the West line					
Ground Level Elev. 6310	Producing Formation Lower Gallup		Pool Bisti Lower Gallup		Dedicated Acreage: 80 Acres

1. Outline the acreage dedicated to the subject well by colored pencil or hachure marks on the plat below.
2. If more than one lease is dedicated to the well, outline each and identify the ownership thereof (both as to working interest and royalty).
3. If more than one lease of different ownership is dedicated to the well, have the interests of all owners been consolidated by communitization, unitization, force-pooling, etc?

☐ Yes ☐ No If answer is "yes," type of consolidation _____

If answer is "no," list the owners and tract descriptions which have actually been consolidated. (Use reverse side of this form if necessary.) _____

No allowable will be assigned to the well until all interests have been consolidated (by communitization, unitization, forced-pooling, or otherwise) or until a non-standard unit, eliminating such interests, has been approved by the Division.

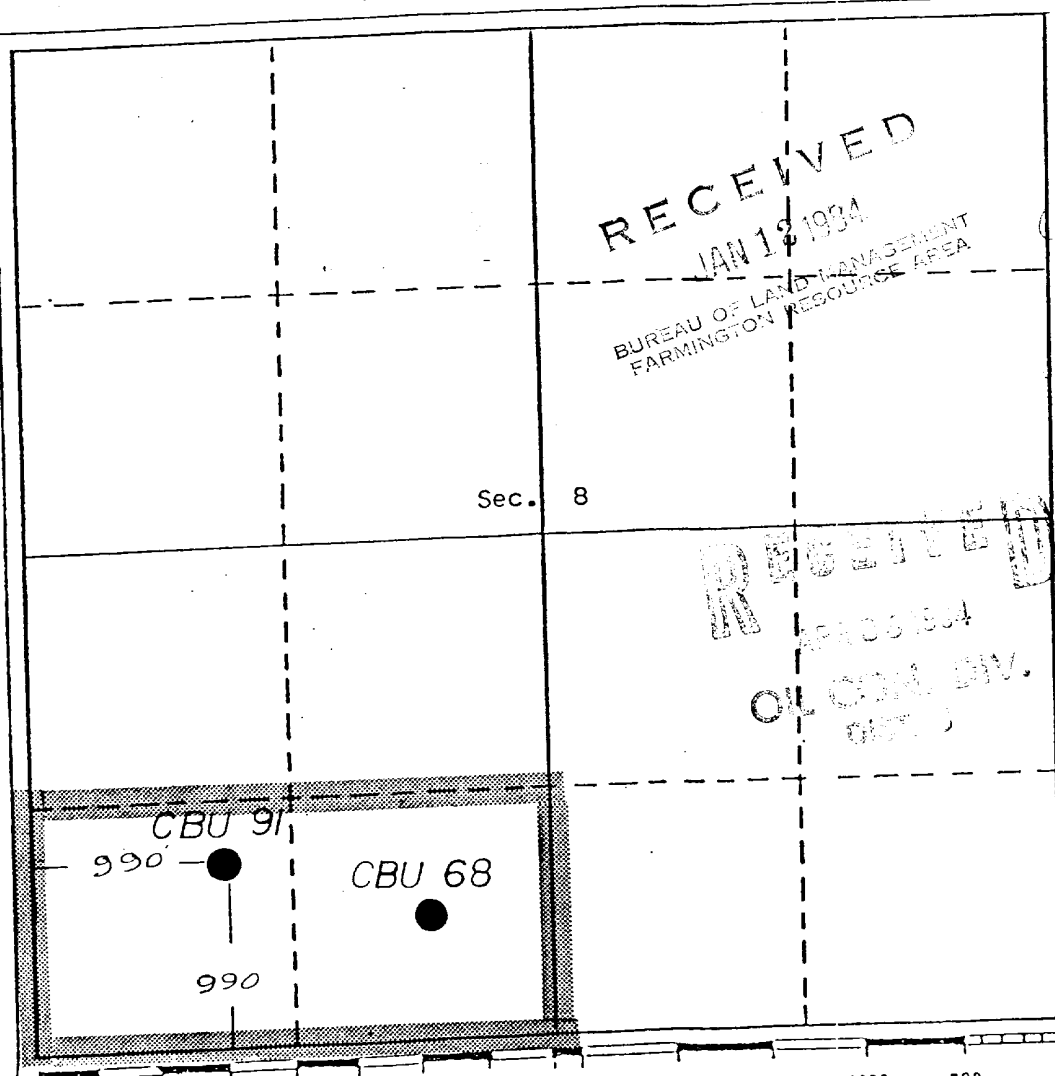

CERTIFICATION

I hereby certify that the information contained herein is true and complete to the best of my knowledge and belief.

Name
Aldrich L. Kuchera

Position
Petroleum Engineer

Company
Hixon Development Company

Date
December 21, 1983

I hereby certify that the location shown on this plat was plotted in the field notes of actual surveys made by me or under my supervision, and that the same is true and correct to the best of my knowledge and belief.

Date Surveyed
December 5, 1983

Registered Professional Engineer
and/or Land Surveyor

Edgar L. Risenhoover
Certificate No. 5979
Edgar L. Risenhoover, L.S.

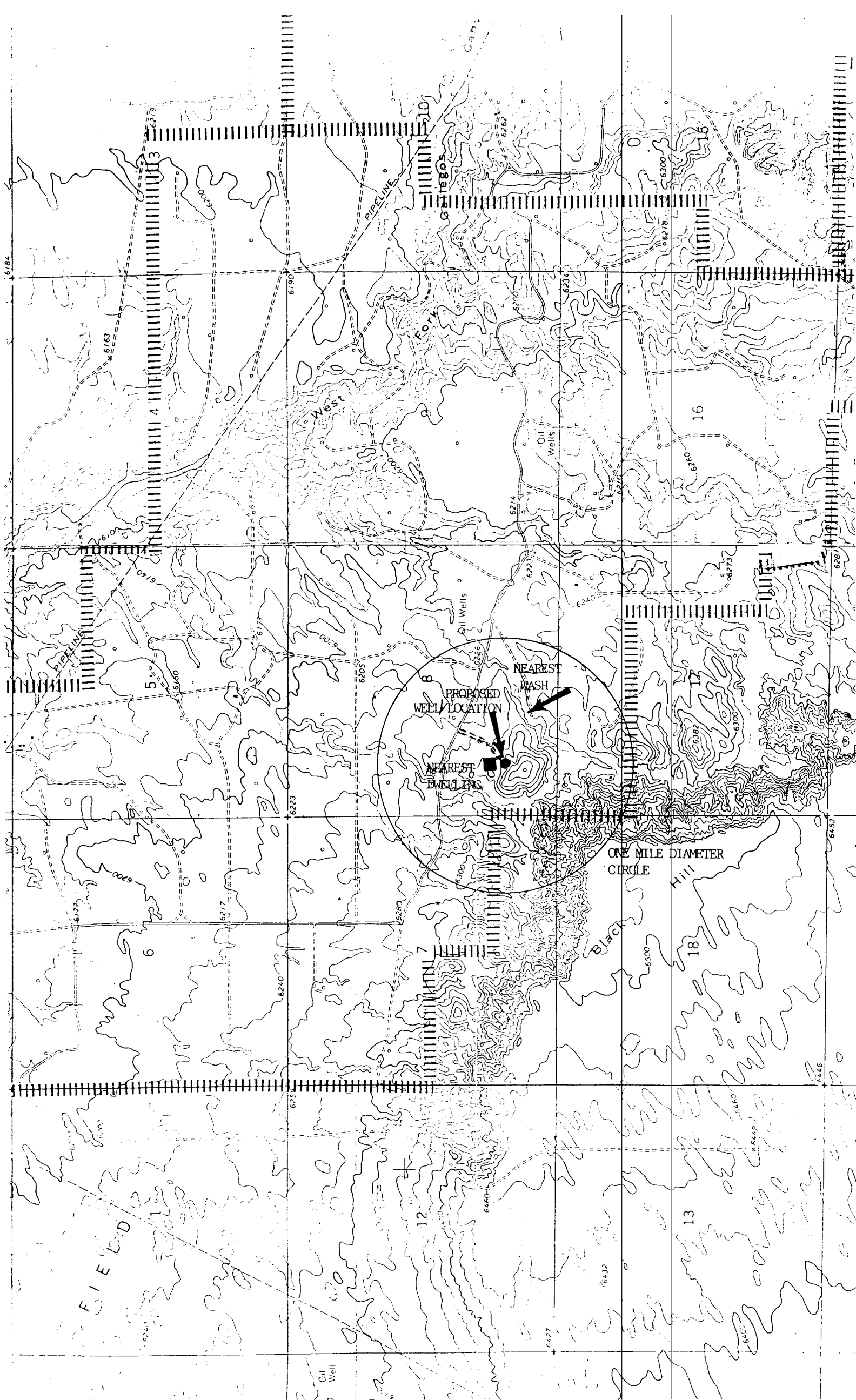

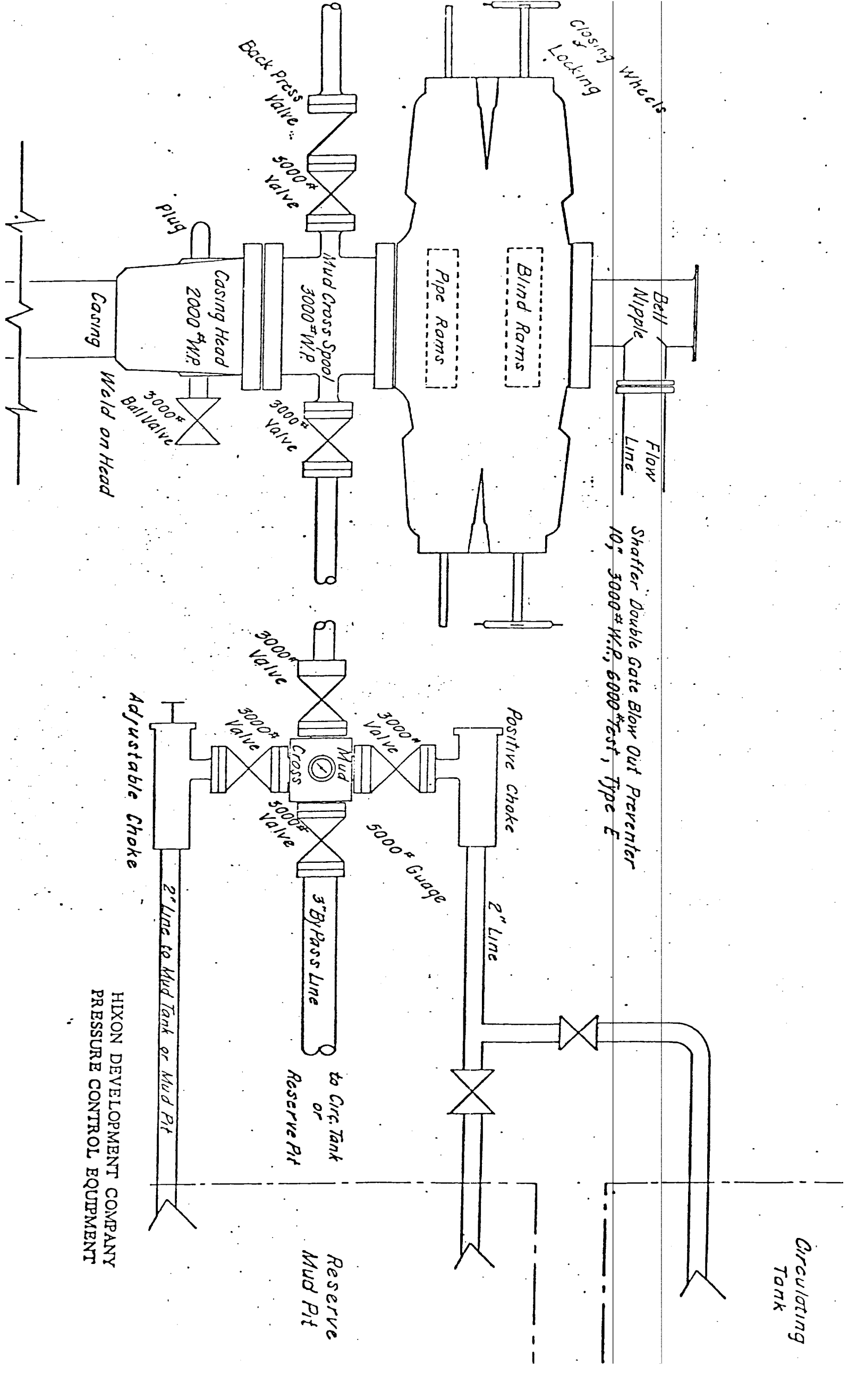

HIKON DEVELOPMENT COMPANY
PRESSURE CONTROL EQUIPMENT