

UNITED STATES  
DEPARTMENT OF THE INTERIOR  
BUREAU OF LAND MANAGEMENT

APPLICATION FOR PERMIT TO DRILL, DEEPEN, OR PLUG BACK

1a. TYPE OF WORK  
DRILL ☒ DEEPEN ☐ PLUG BACK ☐

b. TYPE OF WELL  
OIL WELL ☒ GAS WELL ☐ OTHER ☐  
SINGLE ZONE ☐ MULTIPLE ZONE ☐

2. NAME OF OPERATOR

Hixon Development Company

3. ADDRESS OF OPERATOR

P.O. Box 2810, Farmington, New Mexico 87499

4. LOCATION OF WELL (Report location clearly and in accordance with any State requirements.)\*

At surface

660' FNL, 1980' FEL, Section 27, T25N, R12W

At proposed prod. zone

14. DISTANCE IN MILES AND DIRECTION FROM NEAREST TOWN OR POST OFFICE\*

28 miles south-southeast of Farmington

15. DISTANCE FROM PROPOSED\*

LOCATION TO NEAREST  
PROPERTY OR LEASE LINE, FT.  
(Also to nearest drlg. unit line, if any)

660'

16. NO. OF ACRES IN LEASE

4903'

18. DISTANCE FROM PROPOSED LOCATION\*

TO NEAREST WELL, DRILLING, COMPLETED,  
OR APPLIED FOR, ON THIS LEASE, FT.

19. PROPOSED DEPTH

21. ELEVATIONS (Show whether DF, RT, GR, etc.)

6338' GLE

23.

PROPOSED CASING AND CEMENTING PROGRAM

SIZE OF HOLE	SIZE OF CASING	WEIGHT PER FOOT	SETTING DEPTH	QUANTITY OF CEMENT
12-1/4"	8-5/8"	24#	240'	130 Sacks
7-7/8"	5-1/2"	15.5#	4920'	600 Sacks

It is proposed to drill the subject Bisti Lower Gallup well. It will be evaluated on the basis of open hole logs. Please see attached Onshore Oil & Gas Order #1 data.

CONFIDENTIAL

IN ABOVE SPACE DESCRIBE PROPOSED PROGRAM: If proposal is to deepen or plug back, give data on present productive zone and proposed new productive zone. If proposal is to drill or deepen directionally, give pertinent data on subsurface locations and measured and true vertical depths. Give blowout preventer program, if any.

24.

SIGNED

*Stan McKee*

Petroleum Engineer

DATE November 20, 1984

(This space for Federal or State office use)

PERMIT NO.

APPROVAL DATE

APPROVED BY

TITLE

CONDITIONS OF APPROVAL, IF ANY:

NMOCC

APPROVED

AS AMENDED

MAR 19 1985

Stan McKee

AREA MANAGER  
FARMINGTON RESOURCE AREA

\*See Instructions On Reverse Side

## OIL CONSERVATION DIVISION

STATE OF NEW MEXICO  
ENERGY AND MINERALS DEPARTMENTP. O. BOX 2088  
SANTA FE, NEW MEXICO 87501Form C-102  
Revised 10-1-78

All distances must be from the outer boundaries of the Section.

Operator <b>Hixon Development Company</b>			Lease <b>Polly Turpin</b>		Well No. <b>1</b>
Unit Letter <b>B</b>	Section <b>27</b>	Township <b>25 North</b>	Range <b>12 West</b>	County <b>San Juan</b>	
Actual Footage Location of Well: <b>660</b> feet from the <b>North</b> line and <b>1980</b> feet from the <b>East</b> line					
Ground Level Elev. <b>6338</b>	Producing Formation <b>Gallup</b>	Pool <b>Bisti Lower Gallup</b>		Dedicated Acreage: <b>80</b> Acres	

1. Outline the acreage dedicated to the subject well by colored pencil or hachure marks on the plat below.
2. If more than one lease is dedicated to the well, outline each and identify the ownership thereof (both as to working interest and royalty).
3. If more than one lease of different ownership is dedicated to the well, have the interests of all owners been consolidated by communitization, unitization, force-pooling, etc?

☐ Yes ☐ No If answer is "yes," type of consolidation \_\_\_\_\_

If answer is "no," list the owners and tract descriptions which have actually been consolidated. (Use reverse side of this form if necessary.) \_\_\_\_\_

No allowable will be assigned to the well until all interests have been consolidated (by communitization, unitization, forced-pooling, or otherwise) or until a non-standard unit, eliminating such interests, has been approved by the Division.

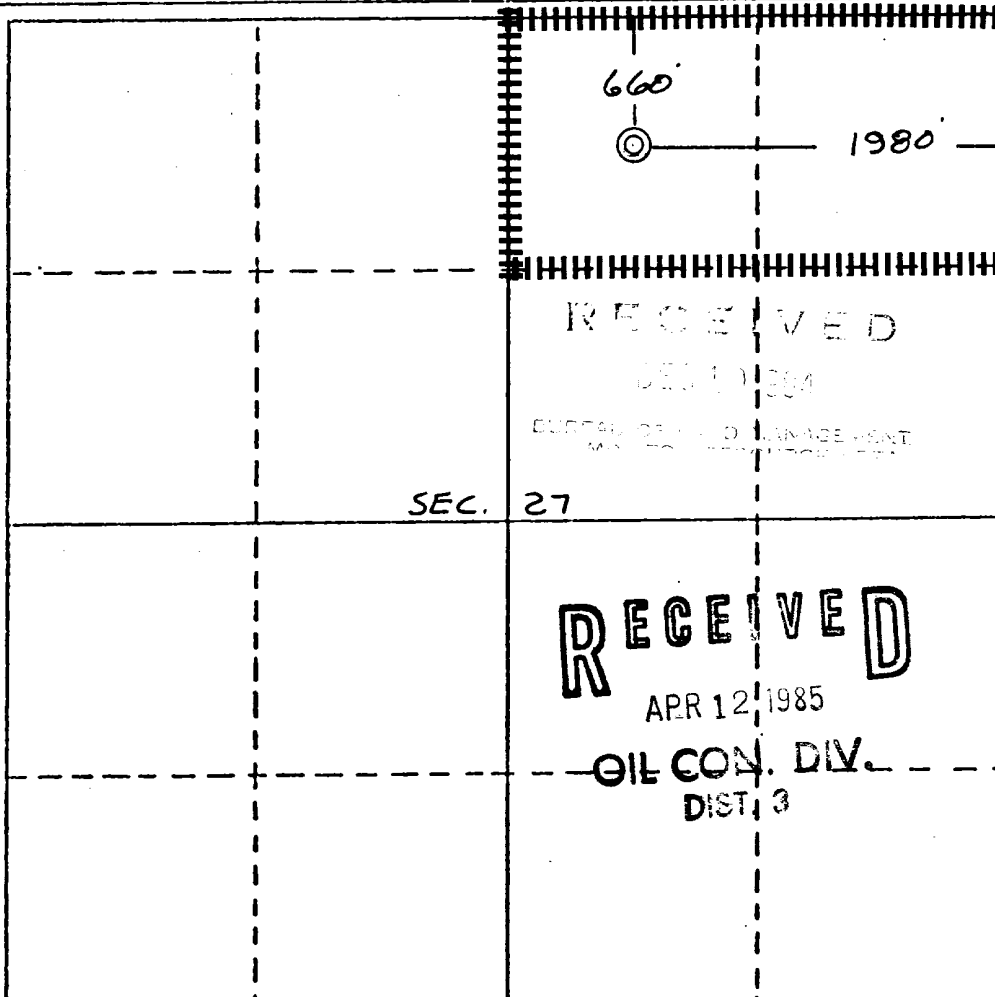
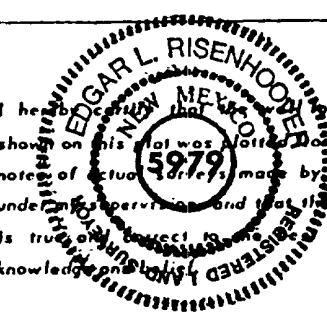
		CERTIFICATION	
		I hereby certify that the information contained herein is true and complete to the best of my knowledge and belief.	
<p>RECEIVED DEC 10 1984 BUREAU OF LAND MANAGEMENT MEXICO CITY, MEXICO</p> <p>SEC. 27</p> <p>RECEIVED APR 12 1985 OIL CON. DIV. DIST. 3</p>		Name <i>Aldrich L. Kuchera</i>	
		Position <b>Petroleum Engineer</b>	
		Company <b>Hixon Development Company</b>	
		Date _____	
		I hereby certify that the information shown on this plat was plotted from field notes of actual surveys made by me or under my supervision and that the same is true and correct to the best of my knowledge and belief.	
		Date Surveyed <b>November 14, 1984</b>	
		Registered Professional Engineer and/or Land Surveyor <i>Edgar L. Risenhoover</i>	
		Certificate No. <b>5979</b> <b>Edgar L. Risenhoover, L.S.</b>	

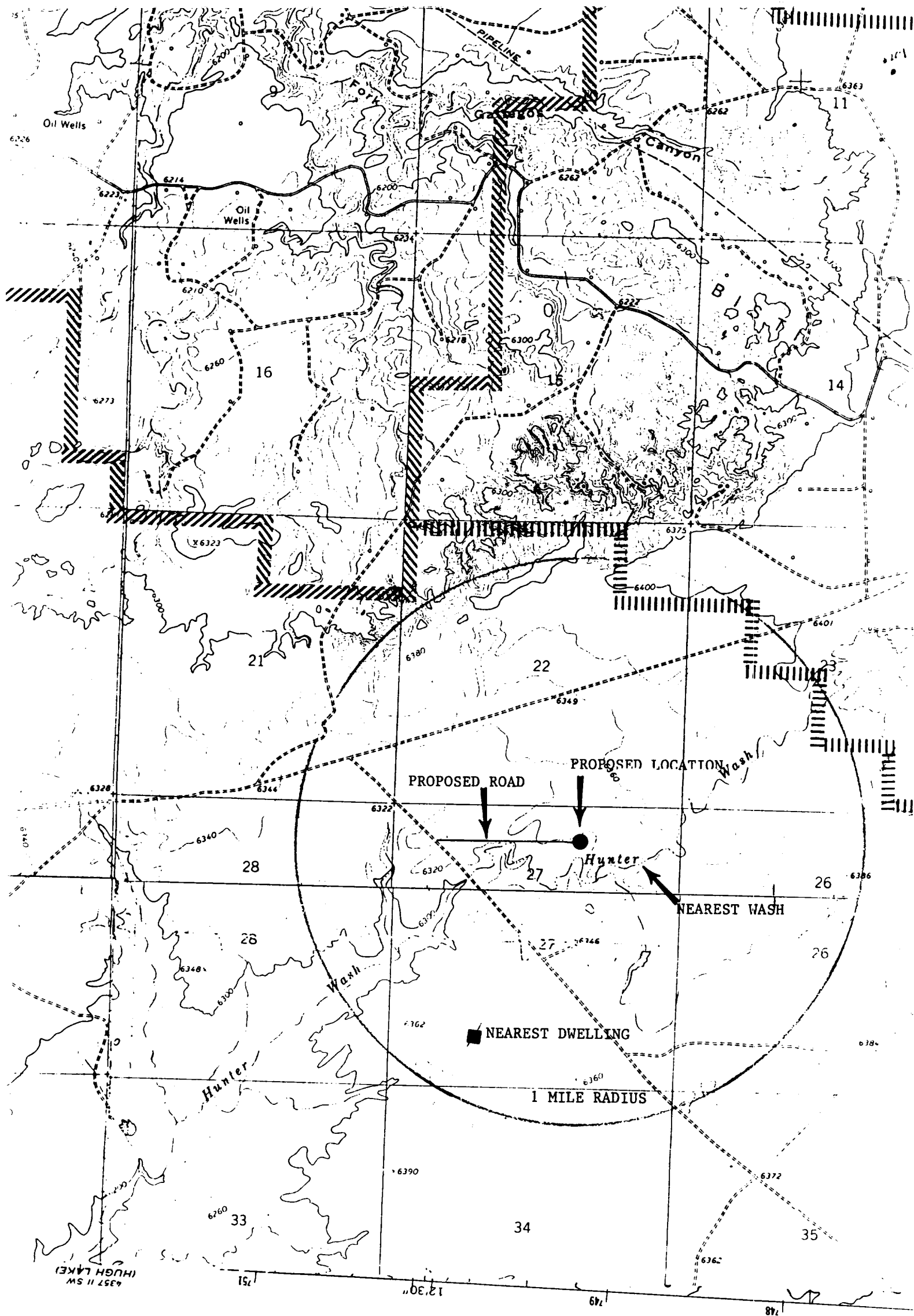

STATES  
THE INTERIOR  
SURVEY