

UNITED STATES
DEPARTMENT OF THE INTERIOR
BUREAU OF LAND MANAGEMENT

SUBMIT IN TRIPLICATE*
(Other instructions on
reverse side)

Form approved.
Budget Bureau No. 1004-0136
Expires August 31, 1985

50-045-26758

APPLICATION FOR PERMIT TO DRILL, DEEPEN, OR PLUG BACK

1a. TYPE OF WORK
DRILL ☒ DEEPEN ☐ PLUG BACK ☐

b. TYPE OF WELL
OIL WELL ☒ GAS WELL ☐ OTHER ☐ SINGLE ZONE ☒ MULTIPLE ZONE ☐

2. NAME OF OPERATOR
Hixon Development Company

3. ADDRESS OF OPERATOR
P. O. Box 2810, Farmington, New Mexico 87499

4. LOCATION OF WELL (Report location clearly and in accordance with any State requirements.)
At surface 990' FNL, 1980' FWL, Sec. 31-T25N-R11W
At proposed prod. zone same

5. LEASE DESIGNATION AND SERIAL NO.
NM 29005

6. IF INDIAN, ALLOTTEE OR TRIBE NAME

7. UNIT AGREEMENT NAME

8. FARM OR LEASE NAME
Ando Hixon

9. WELL NO.
1

10. FIELD AND POOL, OR WILDCAT
Bisti Lower Gallup EXT

11. SEC., T., R., M., OR BLK.
AND SURVEY OR AREA
C 31-T25N-R11W

12. COUNTY OR PARISH
San Juan

13. STATE
NM

14. DISTANCE IN MILES AND DIRECTION FROM NEAREST TOWN OR POST OFFICE*
35 miles south of Farmington

15. DISTANCE FROM PROPOSED* 660' (lease line) 3600' (unit line)
LOCATION TO NEAREST PROPERTY OR LEASE LINE, FT. (Also to nearest drlg. unit line, if any)

16. NO. OF ACRES IN LEASE
80 200

17. NO. OF ACRES ASSIGNED TO THIS WELL
80

18. DISTANCE FROM PROPOSED LOCATION* TO NEAREST WELL, DRILLING, COMPLETED, OR APPLIED FOR, ON THIS LEASE, FT.
N/A

19. PROPOSED DEPTH
4975'

20. ROTARY OR CABLE TOOLS
Rotary

21. ELEVATIONS (Show whether DF, RT, GR, etc.)
6435' GR DRILLING OPERATIONS AUTHORIZED ARE

22. APPROX. DATE WORK WILL START*
12/1/86

23. PROPOSED CASING AND CEMENTING PROGRAM
GENERAL REQUIREMENTS

SIZE OF HOLE	SIZE OF CASING	WEIGHT PER FOOT	SETTING DEPTH	QUANTITY OF CEMENT
12-1/4"	8-5/8"	24#	440	240 sks 283 cu. ft.
7-7/8"	5-1/2"	15.5#	4975	600 sks 1796 cu. ft.

It is proposed to drill the subject Bisti Lower Gallup Pool oil well. It will be evaluated on the basis of open hole logs. Please see attached Onshore Oil and Gas Order No. 1 data.

RECEIVED
NOV 20 1986
OIL & GAS DIV
DIST. 3

IN ABOVE SPACE DESCRIBE PROPOSED PROGRAM: If proposal is to deepen or plug back, give data on present productive zone and proposed new productive zone. If proposal is to drill or deepen directionally, give pertinent data on subsurface locations and measured and true vertical depths. Give blowout preventer program, if any.

24. SIGNED R. P. Tuttle TITLE Geologist DATE October 22, 1986

(This space for Federal or State office use)

PERMIT NO. APPROVAL DATE

APPROVED BY TITLE DATE NOV 18 1986

CONDITIONS OF APPROVAL, IF ANY:

Hold C-104 for Standup 80
exception to rules 150

NMOCC

*See Instructions On Reverse Side

/s/ J. Stan McKee

FOR AREA MANAGER

OIL CONSERVATION DIVISION

STATE OF NEW MEXICO
ENERGY AND MINERALS DEPARTMENTP. O. BOX 2088
SANTA FE, NEW MEXICO 87501Form C-102
Revised 10-1-78

All distances must be from the outer boundaries of the Section.

Operator Hixon Development Company			Lease Ando Hixon		Well No. 1
Unit Letter C	Section 31	Township 25 North	Range 11 West	County San Juan	
Actual Postage Location of Well: 990 feet from the North line and 1980 feet from the West line					
Ground Level Elev. 6435	Producing Formation Gallup	Pool Bisti Lower Gallup <i>Ext</i>		Dedicated Acreage: 80 Acres	

1. Outline the acreage dedicated to the subject well by colored pencil or hachure marks on the plat below.
2. If more than one lease is dedicated to the well, outline each and identify the ownership thereof (both as to working interest and royalty).
3. If more than one lease of different ownership is dedicated to the well, have the interests of all owners been consolidated by communitization, unitization, force-pooling, etc?

☐ Yes ☐ No If answer is "yes," type of consolidation _____

If answer is "no," list the owners and tract descriptions which have actually been consolidated. (Use reverse side of this form if necessary.) _____

No allowable will be assigned to the well until all interests have been consolidated (by communitization, unitization, forced-pooling, or otherwise) or until a non-standard unit, eliminating such interests, has been approved by the Division.

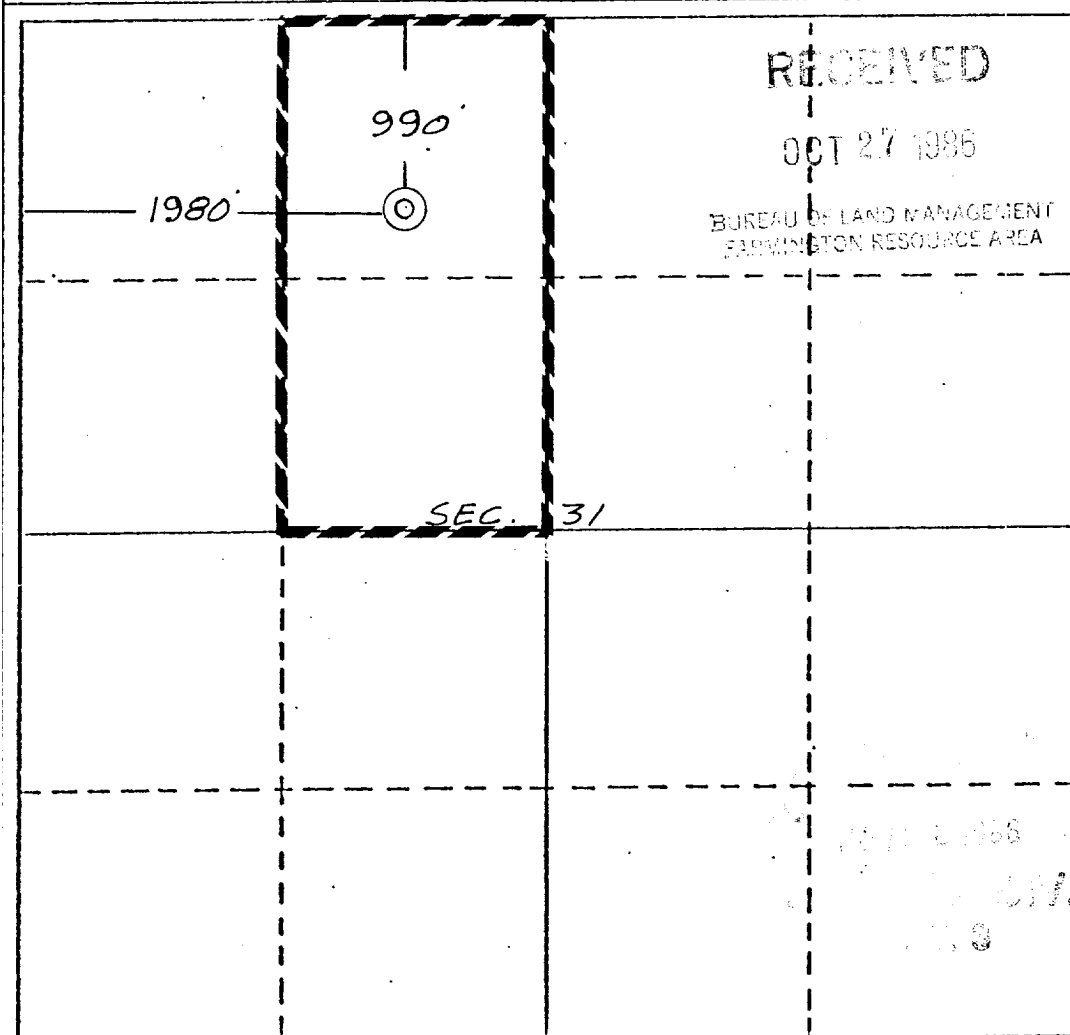

CERTIFICATION

I hereby certify that the information contained herein is true and complete to the best of my knowledge and belief.

R. P. Tuttle

Name

R. P. Tuttle

Position

Geologist

Company

Hixon Development Company

Date

October 20, 1986

I have personally surveyed the location shown on this plat and the survey was made by me or under my supervision and that the same is true and correct to the best of my knowledge and belief.

Date Surveyed

October 16, 1986

Registered Professional Engineer
and/or Land Surveyor

Edgar L. Risenhoover

Certificate No. 5979

Edgar L. Risenhoover, L.S.

