

UNITED STATES
DEPARTMENT OF THE INTERIOR
BUREAU OF LAND MANAGEMENT

APPLICATION FOR PERMIT TO DRILL, DEEPEN, OR PLUG BACK

1a. TYPE OF WORK
DRILL ☒ DEEPEN ☐ PLUG BACK ☐

b. TYPE OF WELL
OIL WELL ☒ GAS WELL ☐ OTHER ☐
SINGLE ZONE ☒ MULTIPLE ZONE ☐

2. NAME OF OPERATOR
Hixon Development Company

3. ADDRESS OF OPERATOR
P. O. Box 2810, Farmington, New Mexico 87499

4. LOCATION OF WELL (Report location clearly and in accordance with any State requirements.)
At surface
990' FSL, 2310' FWL, Sec. 25, T25N, R12W
At proposed prod. zone
same

14. DISTANCE IN MILES AND DIRECTION FROM NEAREST TOWN OR POST OFFICE
35 miles south of Farmington

10. DISTANCE FROM PROPOSED* LOCATION TO NEAREST PROPERTY OR LEASE LINE, FT.
330' (lease line)
2970 (unit line)
(Also to nearest drig. unit line, if any)

13. DISTANCE FROM PROPOSED LOCATION* TO NEAREST WELL, DRILLING, COMPLETED, OR APPLIED FOR, ON THIS LEASE, FT.
2200'

21. ELEVATIONS (Show whether DF, RT, GR, etc.)
6398 GR

23. PROPOSED CASING AND CEMENTING PROGRAM

SIZE OF HOLE	SIZE OF CASING	WEIGHT PER FOOT	SETTING DEPTH	AMOUNT OF CEMENT
12-1/4"	8-5/8"	24#	250	140 sks 165 cu. ft.
7-7/8"	5-1/2"	15.5#	4935	600 sks 1796 cu. ft.

5. LEASE DESIGNATION AND SERIAL NO.
NM-51014
6. IF INDIAN, ALLOTTED OR TRIBE NAME
7. UNIT AGREEMENT NAME
8. FARM OR LEASE NAME
Tono Hixon
9. WELL NO.
1
10. FIELD AND POOL, OR WILDCAT
Bisti Lower Gallup Ext
11. SEC., T., R., M., OR BLK. AND SURVEY OR AREA
25-T25N-R12W
12. COUNTY OR PARISH
San Juan
13. STATE
NM

22. APPROX. DATE WORK WILL START*
3/1/87

This action is subject to the provisions of the Federal Oil and Gas Lease Act, 30 U.S.C. 181, and appeal procedures.

It is proposed to drill the subject Bisti Lower Gallup Pool oil well. It will be evaluated on the basis of open hole logs. Please see attached Onshore Oil and Gas Order No. 1 data.

IN ABOVE SPACE DESCRIBE PROPOSED PROGRAM: If proposal is to deepen or plug back, give data on present productive zone and proposed new productive zone. If proposal is to drill or deepen directionally, give pertinent data on subsurface locations and measured and true vertical depths. Give blowout preventer program, if any.

24. SIGNED R. P. Tuttle TITLE Geologist DATE February 1, 1987
(This space for Federal or State office use)

PERMIT NO. _____ APPROVAL DATE _____

"Approval of this action does not warrant that the applicant holds legal or equitable rights or title to this lease."
*See Instructions On Reverse Side
FEB 26 1987
AREA MANAGER

OIL CONSERVATION DIVISION

STATE OF NEW MEXICO
ENERGY AND MINERALS DEPARTMENTP. O. BOX 2088
SANTA FE, NEW MEXICO 87501Form C-102
Revised 10-1-79

All distances must be from the outer boundaries of the Section.

Operator Hixon Development Company		Lease Tono Hixon		Well No. 1
Unit Letter N	Section 25	Township 25 North	Range 12 West	County San Juan
Actual Footage Location of Well: 990 feet from the South line and 2310 feet from the West line				
Ground Level Elev. 6398	Producing Formation Gallup	Pool Bisti Lower Gallup <i>Ext</i>	Dedicated Acreage: 80 Acres	

1. Outline the acreage dedicated to the subject well by colored pencil or hatchure marks on the plat below.
2. If more than one lease is dedicated to the well, outline each and identify the ownership thereof (both as to working interest and royalty).
3. If more than one lease of different ownership is dedicated to the well, have the interests of all owners been consolidated by communitization, unitization, force-pooling, etc?

☐ Yes ☐ No If answer is "yes," type of consolidation _____

If answer is "no," list the owners and tract descriptions which have actually been consolidated. (Use reverse side of this form if necessary.) _____

No allowable will be assigned to the well until all interests have been consolidated (by communitization, unitization, forced-pooling, or otherwise) or until a non-standard unit, eliminating such interests, has been approved by the Division.

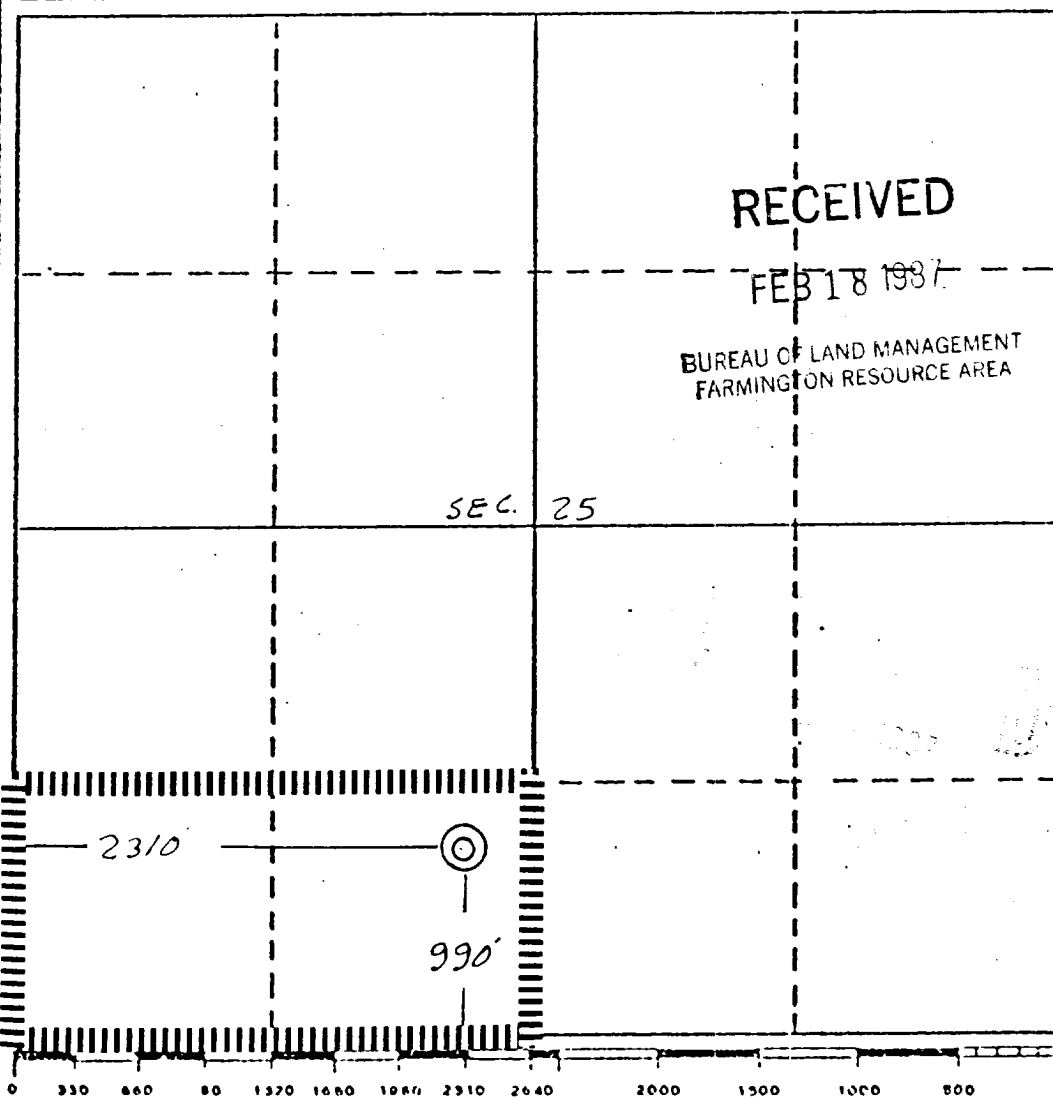

CERTIFICATION

I hereby certify that the information contained herein is true and complete to the best of my knowledge and belief.

R. P. Tuttle

Name
R. P. Tuttle
Position
Geologist
Company
Hixon Development Company
Date
February 1, 1987

I hereby certify that the location shown on this plat was plotted from field notes of actual surveys made by me or under my supervision, and that the same is true and correct to the best of my knowledge and belief.

Date Surveyed
January 15, 1987
Registered Professional Engineer and/or Land Surveyor

Edgar L. Risenhoover
Certificate No. 5979
Edgar L. Risenhoover, L.S.

