

## OIL CONSERVATION DIVISION

P. O. BOX 2088

SANTA FE, NEW MEXICO 87501

30-045-27209  
Form C-101  
Revised 10-1-78

|                        |  |
|------------------------|--|
| NO. OF COPIES RECEIVED |  |
| DISTRIBUTION           |  |
| SANTA FE               |  |
| FILE                   |  |
| U.S.G.S.               |  |
| LAND OFFICE            |  |
| OPERATOR               |  |

|   |                              |
|---|------------------------------|
| 5A. Indicate Type of Lease                |                              |
| STATE <input checked="" type="checkbox"/> | FEE <input type="checkbox"/> |
| 5. State Oil & Gas Lease No.<br>B 10894   |                              |

## APPLICATION FOR PERMIT TO DRILL, DEEPEN, OR PLUG BACK

|   |  |   |  |
|---|--|---|--|
| 1a. Type of Work  |  | 7. Unit Agreement Name  |  |
| b. Type of Well<br>DRILL <input checked="" type="checkbox"/> DEEPEN <input type="checkbox"/> PLUG BACK <input type="checkbox"/><br>OIL WELL <input checked="" type="checkbox"/> GAS WELL <input type="checkbox"/> OTHER <input type="checkbox"/> SINGLE ZONE <input checked="" type="checkbox"/> MULTIPLE ZONE <input type="checkbox"/> |  | 8. Farm or Lease Name<br>Yomamasan                              |  |
| 2. Name of Operator<br>Hixon Development Company  |  | 9. Well No.<br>1  |  |
| 3. Address of Operator<br>P.O. Box 2810, Farmington, N.M. 87499   |  | 10. Field and Pool, or Wildcat <b>EXT</b><br>Bisti Lower Gallup |  |
| 4. Location of Well<br>UNIT LETTER <u>N</u> LOCATED <u>740</u> FEET FROM THE <u>South</u> LINE<br>AND <u>1820</u> FEET FROM THE <u>West</u> LINE OF SEC. <u>32</u> TWP. <u>25N</u> RGE. <u>11W</u> NMPM   |  | 12. County<br>San Juan  |  |
| 11. Elevations (Show whether DF, RT, etc.)<br>6445' GLE   |  | 19. Proposed Depth<br><del>5000'</del> 4960'                    | 19A. Formation<br>Gallup                             |
| 21A. Kind & Status Plug. Bond   |  | 21B. Drilling Contractor<br>Unknown                             | 22. Approx. Date Work will start<br>February 1, 1989 |
| 23. PROPOSED CASING AND CEMENT PROGRAM  |  | 20. Rotary or C.T.<br>Rotary                                    |  |

| SIZE OF HOLE | SIZE OF CASING | WEIGHT PER FOOT | SETTING DEPTH | SACKS OF CEMENT | EST. TOP |
|--------------|----------------|-----------------|---------------|-----------------|----------|
| 12-1/4"      | 8-5/8"         | 24#             | 300'          | 250 sks.        | surface  |
| 7-7/8"       | 5-1/2"         | 15.5#           | 4960'         | 600 sks.        | surface  |
|              |                |                 |               |                 |          |

It is proposed to drill the subject Bisti Lower Gallup oil well.  
It will be evaluated on the basis of open hole logs. Storage  
facilities will be located on the site. A BOP will be used during  
drilling operations.

APPROVAL EXPIRES 7-5-89  
UNLESS DRILLING IS COMMENCED.  
SPUD NOTICE MUST BE SUBMITTED  
WITHIN 10 DAYS.

RECEIVED  
JAN 4 - 1989  
OIL CON. DIV.  
DIST. 3

ABOVE SPACE DESCRIBE PROPOSED PROGRAM; IF PROPOSAL IS TO DEEPEN OR PLUG BACK, GIVE DATA ON PRESENT PRODUCTIVE ZONE AND PROPOSED NEW PRODUCTIVE ZONE. GIVE BLOWOUT PREVENTER PROGRAM, IF ANY.

I hereby certify that the information above is true and complete to the best of my knowledge and belief.

Signed Charles E. Harraden Title Geologist Date January 3, 1989  
(This space for State Use)

APPROVED BY Emil Busch TITLE DEPUTY OIL & GAS INSPECTOR, DIST. #3 DATE JAN 05 1989  
CONDITIONS OF APPROVAL, IF ANY:

## OIL CONSERVATION DIVISION

STATE OF NEW MEXICO  
ENERGY AND MINERALS DEPARTMENTP. O. BOX 2088  
SANTA FE, NEW MEXICO 87501Form C-102  
Revised 10-1-78

All distances must be from the outer boundaries of the Section.

|   |                               |                                |                                |                    |  |
|---|-------------------------------|--------------------------------|--------------------------------|--------------------|--|
| Operator<br>Hixon Development Company   |                               | Lease<br>Yomamasan             |                                | Well No.<br>1      |  |
| Unit Letter<br>N  | Section<br>32                 | Township<br>25 North           | Range<br>11 West               | County<br>San Juan |  |
| Actual Footage Location of Well:<br>740 feet from the South line and 1820 feet from the West line |                               |                                |                                |                    |  |
| Ground Level Elev.<br>6445  | Producing Formation<br>Gallup | Pool<br>Bisti Lower Gallup EXT | Dedicated Acreage:<br>80 Acres |                    |  |

1. Outline the acreage dedicated to the subject well by colored pencil or hachure marks on the plat below.
2. If more than one lease is dedicated to the well, outline each and identify the ownership thereof (both as to working interest and royalty).
3. If more than one lease of different ownership is dedicated to the well, have the interests of all owners been consolidated by communitization, unitization, force-pooling, etc?

☐ Yes ☐ No If answer is "yes," type of consolidation \_\_\_\_\_

If answer is "no," list the owners and tract descriptions which have actually been consolidated. (Use reverse side of this form if necessary.) \_\_\_\_\_

No allowable will be assigned to the well until all interests have been consolidated (by communitization, unitization, forced-pooling, or otherwise) or until a non-standard unit, eliminating such interests, has been approved by the Division.

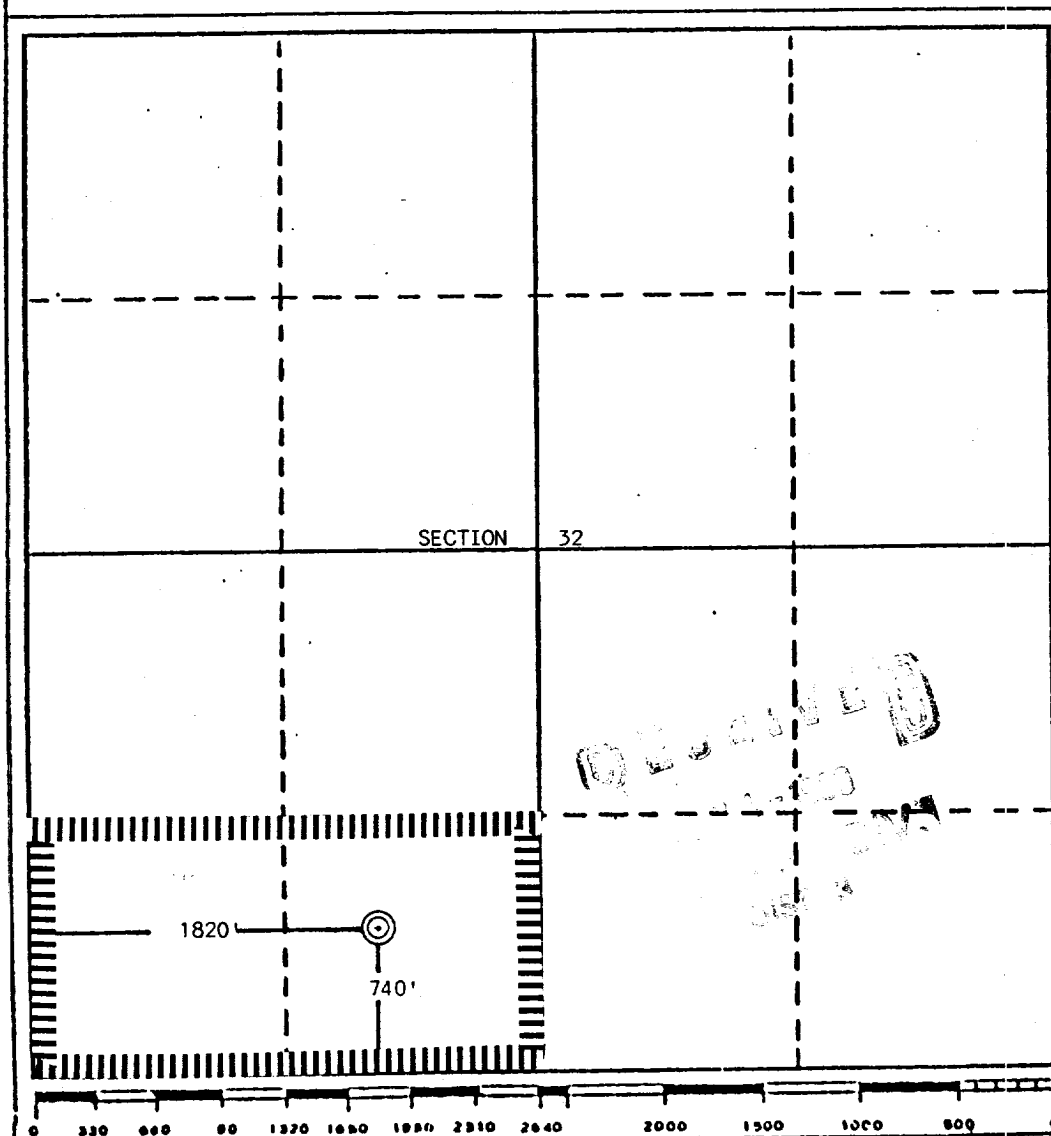

## CERTIFICATION

I hereby certify that the information contained herein is true and complete to the best of my knowledge and belief.

*John C. Corbett*  
Name  
John C. Corbett  
Position  
Vice President - Exploration  
Company  
Hixon Development Company

Date  
1/3/89

EDGAR L. RISENHOVER  
NEW MEXICO  
15979  
I, EDGAR L. RISENHOVER, a duly licensed Professional Engineer and Land Surveyor, certify that the location shown on this plat was plotted from field notes of actual surveys made by me or under my supervision, and that the same is true and correct to the best of my knowledge and belief.

Date Surveyed  
November 23, 1988

Registered Professional Engineer  
and/or Land Surveyor

*Edgar L. Risenhover*  
Certificate No. 5979  
Edgar L. Risenhover, L.S.