

Submit to Appropriate  
District Office  
State Lease -- 6 copies  
Fee Lease -- 5 copies

State of New Mexico  
Energy, Minerals and Natural Resources Department

Form C-101  
Revised 1-1-89

OIL CONSERVATION DIVISION

DISTRICT I  
P.O. Box 1980, Hobbs, NM 88240

DISTRICT II  
P.O. Drawer DD, Artesia, NM 88210

DISTRICT III  
1000 Rio Brazos Rd., Aztec, NM 87410

P.O. Box 2088

Santa Fe, New Mexico 87504-2088

API NO. (assigned by OCD on New Wells)

30-045-27556

5. Indicate Type of Lease

STATE ☒

FEE ☐

6. State Oil & Gas Lease No.  
V-2260

APPLICATION FOR PERMIT TO DRILL, DEEPEN, OR PLUG BACK

1a. Type of Work:

DRILL ☒

RE-ENTER ☐

DEEPEN ☐

PLUG BACK ☐

b. Type of Well:

OIL  
WELL ☐

GAS  
WELL ☒

OTHER

SINGLE  
ZONE ☒

MULTIPLE  
ZONE ☐

7. Lease Name or Unit Agreement Name

State 36

2. Name of Operator

Hixon Development Company

8. Well No.

1

3. Address of Operator

P. O. Box 2810, Farmington, New Mexico 87499

9. Pool name or Wildcat

Basin Fruitland Coal

4. Well Location

Unit Letter A : 1165 Feet From The North Line and 1220 Feet From The East Line

Section 36

Township 25 North

Range 12 West

NMPM

San Juan

County

10. Proposed Depth

1275

11. Formation

Fruitland

12. Rotary or C.T.

Rotary

13. Elevations (Show whether DF, RT, GR, etc.)

6401' GLE

14. Kind & Status Plug. Bond

15. Drilling Contractor

Unknown

16. Approx. Date Work will start

January 1, 1990

17. PROPOSED CASING AND CEMENT PROGRAM

SIZE OF HOLE	SIZE OF CASING	WEIGHT PER FOOT	SETTING DEPTH	SACKS OF CEMENT	EST. TOP
12 - $\frac{1}{4}$ "	8 - $\frac{5}{8}$ "	24 #	110'	60 sks (1.18 ft <sup>3</sup> per sk)	to surface
6 - $\frac{1}{4}$ "	4 - $\frac{1}{2}$ "	10.5#	1275'	140 sks	to surface

(75 sks - 2.06 ft<sup>3</sup>/sk)

(65 sks - 1.18 ft<sup>3</sup>/sk)

It is proposed to drill the subject Basin Fruitland Coal well. It will be evaluated on the basis of open hole logs. A BOP will be used during drilling operations.

APPROVAL EXPIRES 6-19-90  
UNLESS DRILLING IS COMMENCED.  
SPUD NOTICE MUST BE SUBMITTED  
WITHIN 10 DAYS

RECEIVED

DEC 18 1989

OIL CON. DIV.  
DIST. 3

IN ABOVE SPACE DESCRIBE PROPOSED PROGRAM: IF PROPOSAL IS TO DEEPEN OR PLUG BACK, GIVE DATA ON PRESENT PRODUCTIVE ZONE AND PROPOSED NEW PRODUCTIVE ZONE. GIVE BLOWOUT PREVENTER PROGRAM, IF ANY.

I hereby certify that the information above is true and complete to the best of my knowledge and belief.

SIGNATURE John C. Corbett TITLE Vice President-Exploration DATE December 15, 1989

TYPE OR PRINT NAME John C. Corbett

TELEPHONE NO. 505-326-3325

(This space for State Use)

APPROVED BY Ernie Burch

DEPUTY OIL & GAS INSPECTOR, DIST. #3

DATE DEC 19 1989

CONDITIONS OF APPROVAL, IF ANY:

Submit to Appropriate  
District Office  
State Lease - 4 copies  
Fee Lease - 3 copies

State of New Mexico  
Energy, Minerals and Natural Resources Department

Form C-102  
Revised 1-1-89

**OIL CONSERVATION DIVISION**

**DISTRICT I**  
P.O. Box 1980, Hobbs, NM 88240

**DISTRICT II**  
P.O. Drawer DD, Artesia, NM 88210

**DISTRICT III**  
1000 Rio Brazos Rd., Aztec, NM 87410

P.O. Box 2088  
Santa Fe, New Mexico 87504-2088

**WELL LOCATION AND ACREAGE DEDICATION PLAT**

All Distances must be from the outer boundaries of the section

Operator Hixon Development Company			Lease State 36		Well No. 1
Unit Letter A	Section 36	Township 25 North	Range 12 West	County San Juan	
Actual Footage Location of Well: 1165 feet from the North line and 1220 feet from the East line					
Ground level Elev. 6401	Producing Formation Fruitland		Pool Basin Fruitland Coal		Dedicated Acreage: 320 Acres

1. Outline the acreage dedicated to the subject well by colored pencil or hatchure marks on the plat below.
2. If more than one lease is dedicated to the well, outline each and identify the ownership thereof (both as to working interest and royalty).
3. If more than one lease of different ownership is dedicated to the well, have the interest of all owners been consolidated by communitization, unitization, force-pooling, etc?  
☐ Yes ☐ No If answer is "yes" type of consolidation \_\_\_\_\_  
If answer is "no" list the owners and tract descriptions which have actually been consolidated. (Use reverse side of this form if necessary).  
No allowable will be assigned to the well until all interests have been consolidated (by communitization, unitization, forced-pooling, or otherwise) or until a non-standard unit, eliminating such interest, has been approved by the Division.

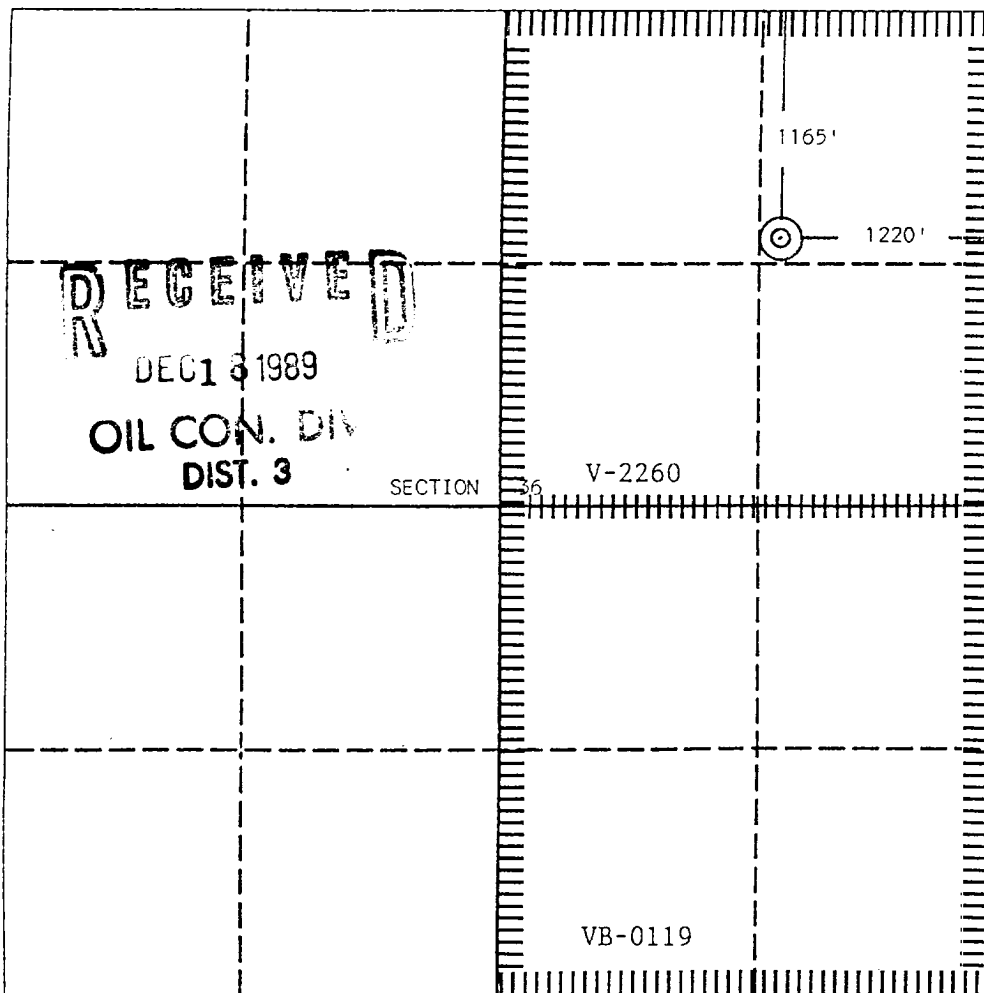

**OPERATOR CERTIFICATION**

I hereby certify that the information contained herein is true and complete to the best of my knowledge and belief.

Signature  
*John C. Corbett*  
Printed Name  
John C. Corbett  
Position  
Vice President-Exploration  
Company  
Hixon Development Company  
Date  
December 15, 1989

**SURVEYOR CERTIFICATION**

I hereby certify that the well location shown on this plat was plotted from field notes of actual surveys made by me or under my supervision, and that the same is true and correct to the best of my knowledge and belief.

Date Surveyed  
December 8, 1989  
Signature & Seal of Professional Surveyor  
*Edgar L. Risenhoover*  
Certification No. 5979  
Edgar

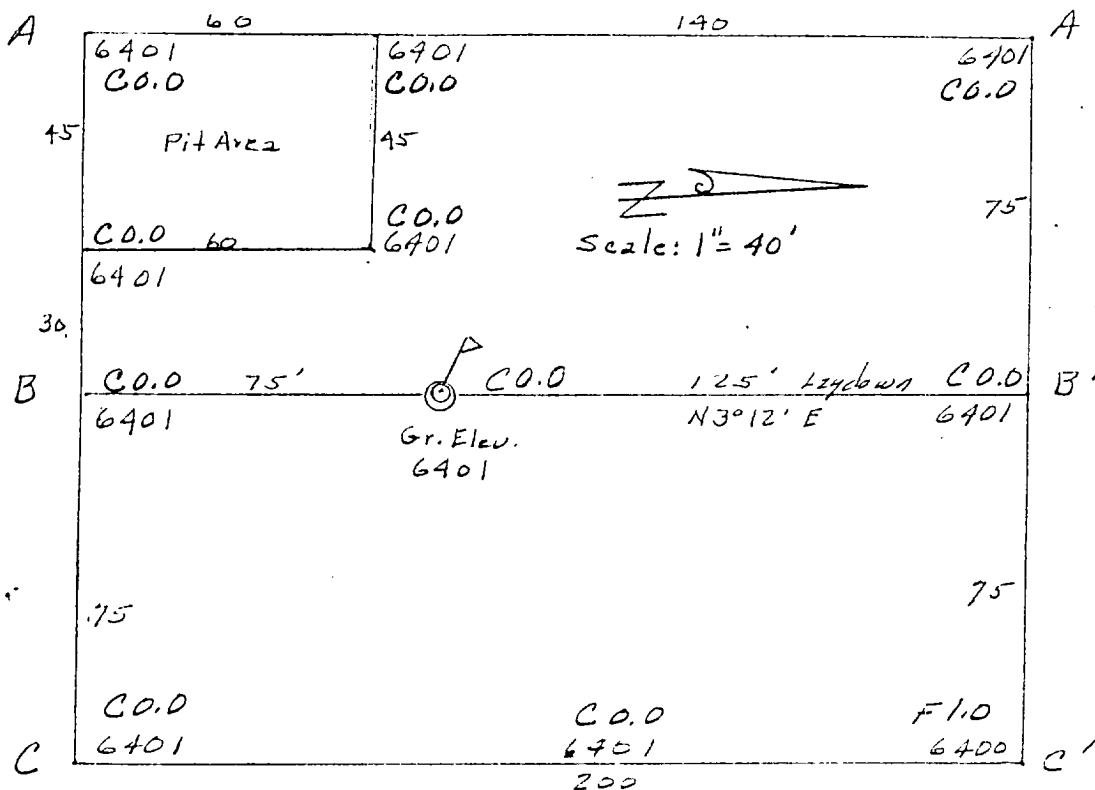

Hixon Development Co.

OPERATOR

State 36 #1

WELL NAME & NO.

1165' F/NL 1220' F/EL

FOOTAGES

36 25N 12W

SEC. TWP. RGE.

Sar Juan, NM

COUNTY

December 8, 1989

DATE

A - A'

6410					
6400	▽	▽	▽	▽	FG 6401

Horz. 1" = 40'  
Vert. 1" = 30'

B - B'

6410					
6400	▽	▽	▽	▽	FG 6401

C - C'

6410					
6400	▽	▽	▽	▽	FG 6401