

Submit to Appropriate
District Office
State Lease - 4 copies
Fee Lease - 3 copies

State of New Mexico
Energy, Minerals and Natural Resources Department

Form C-102
Revised 1-1-89

OIL CONSERVATION DIVISION

P.O. Box 2088
Santa Fe, New Mexico 87504-2088

DISTRICT I
P.O. Box 1980, Hobbs, NM 88240

DISTRICT II
P.O. Drawer DD, Artesia, NM 88210

DISTRICT III
1030 Rio Brazos Rd., Aztec, NM 87410

WELL LOCATION AND ACREAGE DEDICATION PLAT

All Distances must be from the outer boundaries of the section

Operator Giant Exploration & Production Company			Lease Debra Geiger		Well No. 1
Unit Letter P	Section 32	Township 25 North	Range 11 West	County San Juan	
Actual Footage Location of Well: 101 feet from the South line and 172 feet from the East line					
Ground level Elev. 6685 Est.	Producing Formation Gallup	Pool Bisti Lower Gallup		Dedicated Acreage: 482.64 Acres	

1. Outline the acreage dedicated to the subject well by colored pencil or hatchure marks on the plat below.

2. If more than one lease is dedicated to the well, outline each and identify the ownership thereof (both as to working interest and royalty).

3. If more than one lease of different ownership is dedicated to the well, have the interest of all owners been consolidated by communitization, unitization, force-pooling, etc.?

☐ Yes ☐ No If answer is "yes" type of consolidation _____

If answer is "no" list the owners and tract descriptions which have actually been consolidated. (Use reverse side of this form if necessary.) _____

No allowable will be assigned to the well until all interests have been consolidated (by communitization, unitization, forced-pooling, or otherwise) or until a non-standard unit, eliminating such interest, has been approved by the Division.

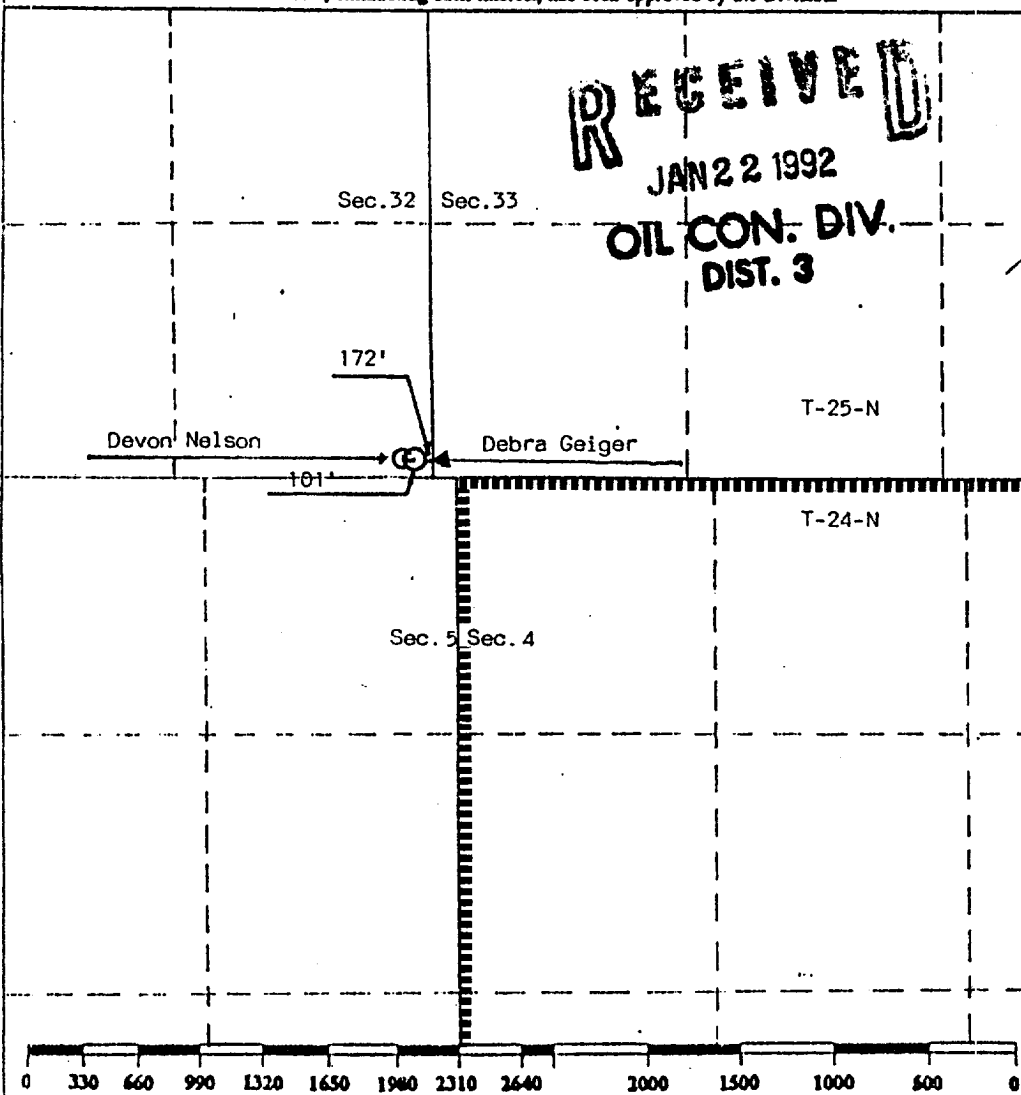

OPERATOR CERTIFICATION

I hereby certify that the information contained herein is true and complete to the best of my knowledge and belief.

Signature

Printed Name

John C. Corbett

Position

Vice President

Company

Giant Exploration & Production Co

Date

January 20, 1992

SURVEYOR CERTIFICATION

I hereby certify that the well location shown on this plat was plotted from field notes of actual surveys made by me or under my supervision, and that the same is true and correct to the best of my knowledge and belief.

Date Surveyed

November 8, 1991

Signature & Seal of
Professional Surveyor

EDGAR L. RISENHOOVER
NEW MEXICO
5979
Edgar L. Risenhoover, P.S.

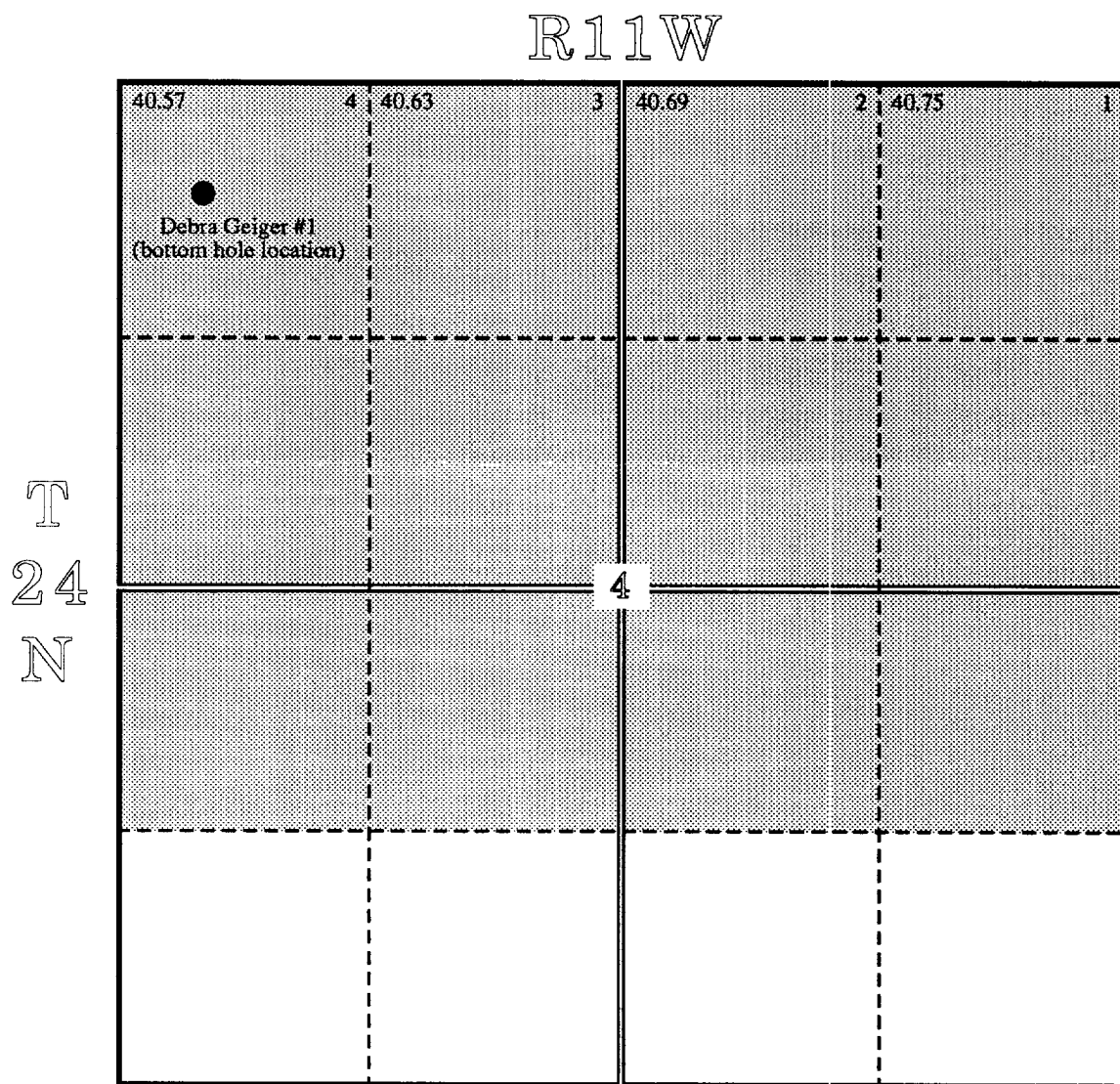

Surface Location of Debra Geiger #1 Well 101' FSL, 172' FEL
32-T25N-R11W, N.M.P.M.

Bottom Hole Location of Debra Geiger #1 Well 620' FNL, 470' FWL
4-T24N-R11W, N.M.P.M.

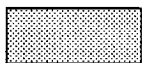

482.64 acre Spacing Unit
comprised of Lots 1 - 4, S/2N/2,
N/2S/2. Established pursuant to
Order #R-9340

Debra Geiger #1 Well
San Juan County, New Mexico
(Plat not drawn to scale)

GIANT
EXPLORATION & PRODUCTION COMPANY