

Submit to Appropriate
District Office
State Lease -- 6 copies
Fee Lease -- 5 copies

State of New Mexico
Energy, Minerals and Natural Resources Department

Form C-101
Revised 1-1-89

OIL CONSERVATION DIVISION

DISTRICT I
P.O. Box 1980, Hobbs, NM 88240

DISTRICT II
P.O. Drawer DD, Artesia, NM 88210

DISTRICT III
1000 Rio Brazos Rd., Alamo, NM 87410

P.O. Box 2083
Santa Fe, New Mexico 87504-2088

API NO. (assigned by OCD on New Wells)

30-045-28670

5. Indicate Type of Lease

STATE ☒ FEE ☐

6. State Oil & Gas Lease No.

VA-143

7. Lease Name or Unit Agreement Name

Frank Foster 13782

8. Well No.

2 E/320

9. Pool name or Wildcat

Basin Fruitland Coal 7/6/29

APPLICATION FOR PERMIT TO DRILL, DEEPEN, OR PLUG BACK

1a. Type of Work:

DRILL ☒ RE-ENTER ☐ DEEPEN ☐ PLUG BACK ☐

b. Type of Well:

OIL WELL ☐ GAS WELL ☒ OTHER ☐ SINGLE ZONE ☒ MULTIPLE ZONE ☐

2. Name of Operator

Giant Exploration & Production Company 82891

3. Address of Operator

P.O. Box 2810, Farmington, NM 87499

4. Well Location

Unit Letter A : 790 Feet From The North Line and 790 Feet From The East Line

Section 32 Township 25N Range 12W NMPM San Juan County

10. Proposed Depth

1200'

11. Formation

Fruitland

12. Rotary or C.T.

Rotary

13. Elevations (Show whether DF, KT, GR, etc.)

GLE - 6250'

14. Kind & Status Plug. Bolt

15. Drilling Contractor

Unknown

16. Approx. Date Work will start

As soon as permitted

17. PROPOSED CASING AND CEMENT PROGRAM

SIZE OF HOLE	SIZE OF CASING	WEIGHT PER FOOT	SETTING DEPTH	SACKS OF CEMENT	EST. TOP
8-3/4"	7"	20#	110'	60 sks (1.18 ft ³ /sk)	Surface
6-1/4"	4-1/2"	9.5#	1200'	125 sks (75 sks - 2.06 ft ³ /sk) (50 sks - 1.18 ft ³ /sk)	Surface

It is proposed to drill the subject Basin Fruitland Coal well. It will be evaluated on the basis of open hole logs. A BOP will be used during drilling operations.

APPROVAL EXPIRES 11-26-92
UNLESS DRILLING IS COMMENCED.
SPUD NOTICE MUST BE SUBMITTED
WITHIN 10 DAYS.

RECEIVED
MAY 22 1992

OIL CON. DIV
DIST. 3

IN ABOVE SPACE DESCRIBE PROPOSED PROGRAM: IF PROPOSAL IS TO DEEPEN OR PLUG BACK, GIVE DATA ON PRESENT PRODUCTIVE ZONE AND PROPOSED NEW PRODUCTIVE ZONE. GIVE BLOWOUT PREVENTER PROGRAM, IF ANY.

I hereby certify that the information above is true and complete to the best of my knowledge and belief.

SIGNATURE

John C. Corbett

TITLE

Vice President

DATE

5/19/92
(505)

TYPE OR PRINT NAME

John C. Corbett

TELEPHONE NO. 326-3325

(This space for State Use)

APPROVED BY

Emmie Burch

DEPUTY OIL & GAS INSPECTOR, DIST. #3

TITLE

DATE

MAY 26 1992

CONDITIONS OF APPROVAL, IF ANY:

Submit to Appropriate
District Office
State Lease - 4 copies
Fee Lease - 3 copies

State of New Mexico
Energy, Minerals and Natural Resources Department

Form C-102
Revised 1-1-89

OIL CONSERVATION DIVISION

P.O. Box 2088

Santa Fe, New Mexico 87504-2088

DISTRICT I

P.O. Box 1980, Hobbs, NM 88240

DISTRICT II

P.O. Drawer DD, Artesia, NM 88210

DISTRICT III

1000 Rio Brazos Rd., Aztec, NM 87410

WELL LOCATION AND ACREAGE DEDICATION PLAT

All Distances must be from the outer boundaries of the section

Operator Giant Exploration & Production Company			Lease Frank Foster		Well No. 2
Unit Letter A	Section 32	Township 25 North	Range 12 West	County San Juan	
Actual Footage Location of Well: 790 feet from the North line and 790 feet from the East line					
Ground level Elev. 6250	Producing Formation Fruitland		Pool Basin Fruitland Coal		Dedicated Acreage: 32.0 Acres

- Outline the acreage dedicated to the subject well by colored pencil or hatchure marks on the plat below.
- If more than one lease is dedicated to the well, outline each and identify the ownership thereof (both as to working interest and royalty).
- If more than one lease of different ownership is dedicated to the well, have the interest of all owners been consolidated by communitization, unitization, force-pooling, etc.?
☐ Yes ☐ No If answer is "yes" type of consolidation _____
If answer is "no" list the owners and tract descriptions which have actually been consolidated. (Use reverse side of this form if necessary.) _____
No allowable will be assigned to the well until all interests have been consolidated (by communitization, unitization, forced-pooling, or otherwise) or until a non-standard unit, eliminating such interest, has been approved by the Division.

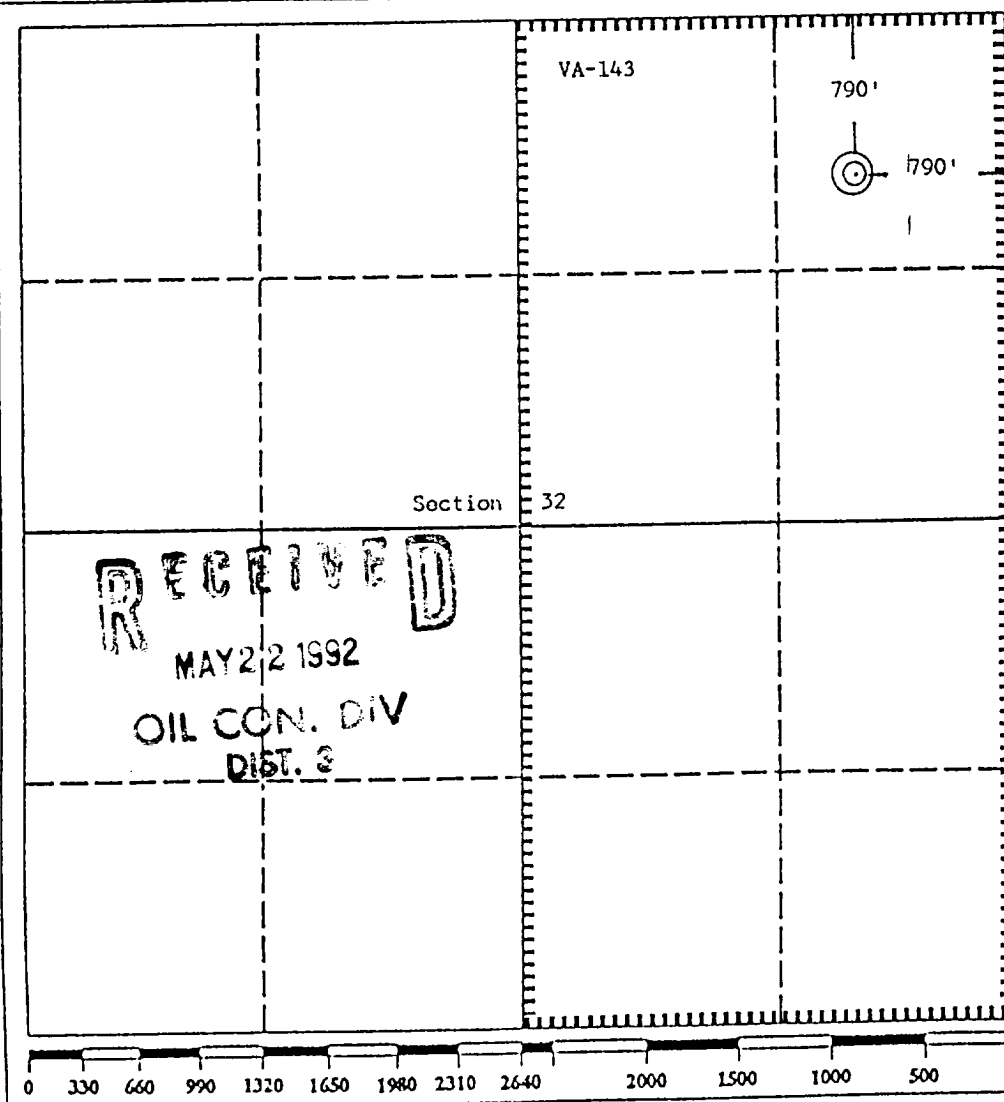

OPERATOR CERTIFICATION

I hereby certify that the information contained herein is true and complete to the best of my knowledge and belief.

Signature
John C. Corbett
Printed Name
John C. Corbett
Position
Vice President
Company
Giant Exploration & Production Co.
Date
May 20, 1992

SURVEYOR CERTIFICATION

I hereby certify that the well location shown on this plat was plotted from field notes of actual surveys made by me or under my supervision, and that the same is true and correct to the best of my knowledge and belief.

Date Surveyed
July 27, 1990

Signature & Seal of Professional Surveyor
Edgar L. Risenhoover
Edgar L. Risenhoover
5979
REGISTERED L.S.

OPERATOR

Frank Foster #2

WELL NAME and NUMBER

790' F/NL 790' F/EL

FOOTAGES

32	25N	12W
SEC.	TWP.	RGE.

San Juan, NM

COUNTY

July 27, 1990

DATE

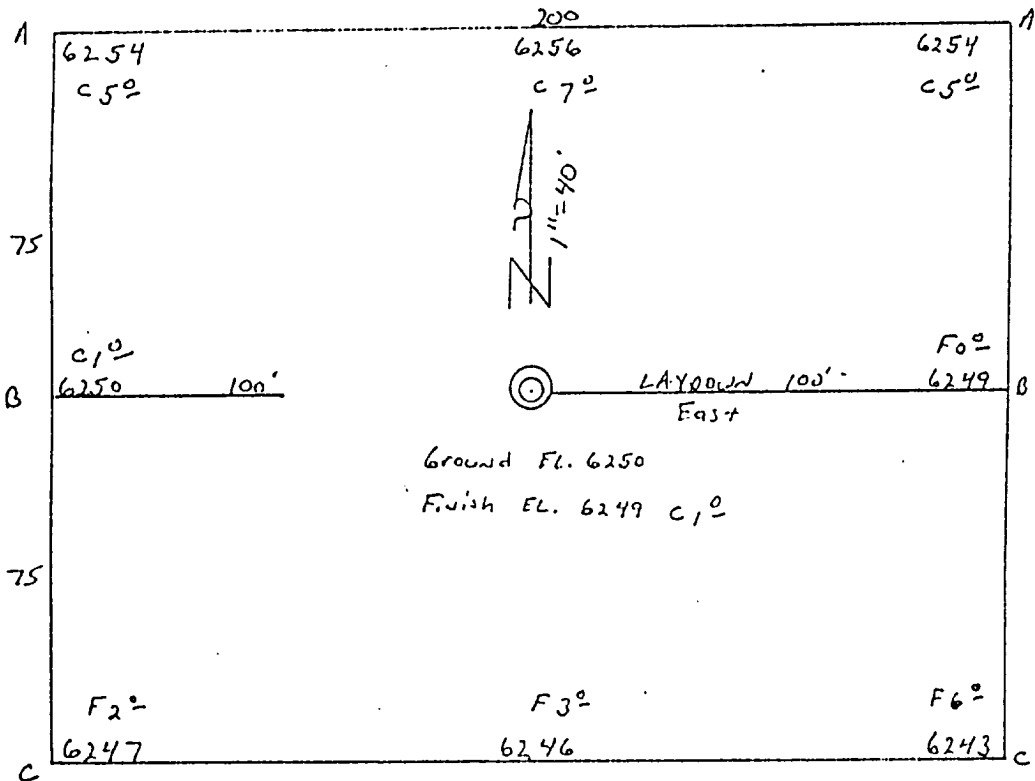

A	6250	---	---	---	---	---
	6240	---	---	---	---	6249
		---	---	---	---	
A'		---	---	---	---	

Horiz 1"=40'

Vert 1"=30'

B	6250	---	---	---	---	6249
	6240	---	---	---	---	
		---	---	---	---	
B'		---	---	---	---	

C	6250	---	---	---	---	6249
	6240	---	---	---	---	
		---	---	---	---	
C'		---	---	---	---	

DISTRICT I
P.O. Box 1980, Hobbs, NM 88240

DISTRICT II
P.O. Drawer DD, Artesia, NM 88210

DISTRICT III
1000 Rio Brazos Rd., Aztec, NM 87410

OIL CONSERVATION DIVISION
P.O. Box 2088
Santa Fe, New Mexico 87504-2088

WELL API NO. 30-045-28670
5. Indicate Type of Lease STATE <input checked="" type="checkbox"/> FEE <input type="checkbox"/>
6. State Oil & Gas Lease No. VA-143
7. Lease Name or Unit Agreement Name Frank Foster W 2
8. Well No. 2
9. Pool name or Wildcat Basin Fruitland Coal
10. Elevation (Show whether DF, RKB, RT, GR, etc.)

SUNDRY NOTICES AND REPORTS ON WELLS
(DO NOT USE THIS FORM FOR PROPOSALS TO DRILL OR TO DEEPEN OR PLUG BACK TO A DIFFERENT RESERVOIR. USE "APPLICATION FOR PERMIT" (FORM C-101) FOR SUCH PROPOSALS.)

1. Type of Well: OIL WELL <input type="checkbox"/> GAS WELL <input checked="" type="checkbox"/> OTHER
2. Name of Operator Giant Exploration & Production Company
3. Address of Operator P.O. Box 2810, Farmington, N.M. 87499
4. Well Location Unit Letter <u>A</u> : <u>790</u> Feet From The <u>North</u> Line and <u>790</u> Feet From The <u>East</u> Line Section <u>32</u> Township <u>25N</u> Range <u>12W</u> NMPM <u>San Juan</u> County

11. Check Appropriate Box to Indicate Nature of Notice, Report, or Other Data	
NOTICE OF INTENTION TO:	SUBSEQUENT REPORT OF:
PERFORM REMEDIAL WORK <input type="checkbox"/>	REMEDIAL WORK <input type="checkbox"/>
TEMPORARILY ABANDON <input type="checkbox"/>	ALTERING CASING <input type="checkbox"/>
PULL OR ALTER CASING <input type="checkbox"/>	COMMENCE DRILLING OPNS. <input type="checkbox"/>
OTHER: <input type="checkbox"/>	PLUG AND ABANDONMENT <input type="checkbox"/>
	CASING TEST AND CEMENT JOB <input type="checkbox"/>
	OTHER: <u>Spud Notice</u> <input checked="" type="checkbox"/>

12. Describe Proposed or Completed Operations (Clearly state all pertinent details, and give pertinent dates, including estimated date of starting any proposed work) SEE RULE 1103.

The above referenced well was spudded at 11:50 a.m. on September 19, 1992.

I hereby certify that the information above is true and complete to the best of my knowledge and belief.

SIGNATURE Jeffrey R. Vaughan TITLE Engineering Manager DATE SEP 21 1992
TYPE OR PRINT NAME Jeffrey R. Vaughan TELEPHONE NO. 326-3325

(This space for State Use)

APPROVED BY Original Signed by FRANK T. CHAVEZ TITLE SUPERVISOR DISTRICT # 3 DATE SEP 21 1992
CONDITIONS OF APPROVAL, IF ANY:

RECEIVED
SEP 22 1992
OIL CON. DIV.
SEP 21 1992

Submit 3 Copies
to Appropriate
District Office

State of New Mexico
Energy, Minerals and Natural Resources Department

Form C-103
Revised 1-1-89

DISTRICT I
P.O. Box 1980, Hobbs, NM 88240

DISTRICT II
P.O. Drawer DD, Artesia, NM 88210

DISTRICT III
1000 Rio Brazos Rd., Aztec, NM 87410

OIL CONSERVATION DIVISION
P.O. Box 2088
Santa Fe, New Mexico 87504-2088

WELL API NO. 30-045-28670
5. Indicate Type of Lease STATE <input checked="" type="checkbox"/> FEE <input type="checkbox"/>
6. State Oil & Gas Lease No. VA-143
7. Lease Name or Unit Agreement Name Frank Foster
8. Well No. 2
9. Pool name or Wildcat Basin Fruitland Coal
10. Elevation (Show whether DF, RKB, RT, GR, etc.) 6250' GLE

SUNDRY NOTICES AND REPORTS ON WELLS
(DO NOT USE THIS FORM FOR PROPOSALS TO DRILL OR TO DEEPEN OR PLUG BACK TO A
DIFFERENT RESERVOIR. USE "APPLICATION FOR PERMIT"
(FORM C-101) FOR SUCH PROPOSALS.)

1. Type of Well: OIL WELL <input type="checkbox"/> GAS WELL <input checked="" type="checkbox"/> OTHER
2. Name of Operator Giant Exploration & Production Company
3. Address of Operator P.O. Box 2810, Farmington, N.M. 87401
4. Well Location Unit Letter <u>A</u> : <u>790</u> Feet From The <u>North</u> Line and <u>790</u> Feet From The <u>East</u> Line Section <u>32</u> Township <u>25N</u> Range <u>12W</u> NMPM <u>San Juan</u> County

11. Check Appropriate Box to Indicate Nature of Notice, Report, or Other Data
NOTICE OF INTENTION TO:
PERFORM REMEDIAL WORK <input type="checkbox"/> PLUG AND ABANDON <input type="checkbox"/>
TEMPORARILY ABANDON <input type="checkbox"/> CHANGE PLANS <input type="checkbox"/>
PULL OR ALTER CASING <input type="checkbox"/>
OTHER: <input type="checkbox"/>
SUBSEQUENT REPORT OF:
REMEDIAL WORK <input type="checkbox"/> ALTERING CASING <input type="checkbox"/>
COMMENCE DRILLING OPNS. <input type="checkbox"/> PLUG AND ABANDONMENT <input type="checkbox"/>
CASING TEST AND CEMENT JOB <input type="checkbox"/>
OTHER: <u>Drilling Progress</u> <input checked="" type="checkbox"/>

12. Describe Proposed or Completed Operations (Clearly state all pertinent details, and give pertinent dates, including estimated date of starting any proposed work) SEE RULE 1103.

Drilled 8-3/4" hole to 124'. Ran 3 jts (123.95') of 7", 20#, J-55, 8rd, ST&C casing. Casing set at 123.45'. Mixed and pumped 92 sks (108 cu ft) Class "B" cement containing 2% CaCl₂ and 1/4 #/sk cellophane flakes. Pressure tested to 600 psi for 30 minutes; test okay.

I hereby certify that the information above is true and complete to the best of my knowledge and belief.

SIGNATURE Jeffrey R. Vaughan TITLE Engineering Manager DATE SEP 25 1992

TYPE OR PRINT NAME Jeffrey R. Vaughan TELEPHONE NO 326-3325

(This space for State Use)

APPROVED BY Original Signed by FRANK T. CHAVEZ TITLE Engineering Manager DATE SEP 28 1992

CONDITIONS OF APPROVAL, IF ANY:

DISTRICT I
P.O. Box 1980, Hobbs, NM 88240

DISTRICT II
P.O. Drawer DD, Artesia, NM 88210

DISTRICT III
1000 Rio Brazos Rd., Aztec, NM 87410

OIL CONSERVATION DIVISION

P.O. Box 2088
Santa Fe, New Mexico 87504-2088

WELL API NO. 30-045-28670
5. Indicate Type of Lease STATE <input checked="" type="checkbox"/> FEE <input type="checkbox"/>
6. State Oil & Gas Lease No. VA-143
7. Lease Name or Unit Agreement Name Frank Foster
8. Well No. 2
9. Pool name or Wildcat Basin Fruitland Coal

SUNDRY NOTICES AND REPORTS ON WELLS (DO NOT USE THIS FORM FOR PROPOSALS TO DRILL OR TO DEEPEN OR PLUG BACK TO A DIFFERENT RESERVOIR. USE "APPLICATION FOR PERMIT" (FORM C-101) FOR SUCH PROPOSALS.)	
1. Type of Well: OIL WELL <input type="checkbox"/> GAS WELL <input checked="" type="checkbox"/> OTHER	
2. Name of Operator Giant Exploration & Production Company	
3. Address of Operator P.O. Box 2810, Farmington, NM 87499	
4. Well Location Unit Letter <u>A</u> : <u>790</u> Feet From The <u>North</u> Line and <u>790</u> Feet From The <u>East</u> Line Section <u>32</u> Township <u>25N</u> Range <u>12W</u> NMPM <u>San Juan</u> County	
10. Elevation (Show whether DF, RKB, RT, GR, etc.)	

11. Check Appropriate Box to Indicate Nature of Notice, Report, or Other Data	
NOTICE OF INTENTION TO: PERFORM REMEDIAL WORK <input type="checkbox"/> TEMPORARILY ABANDON <input type="checkbox"/> PULL OR ALTER CASING <input type="checkbox"/> OTHER: <u>OIL CON. DIV.</u> <input type="checkbox"/>	SUBSEQUENT REPORT OF: REMEDIAL WORK <input type="checkbox"/> COMMENCE DRILLING OPNS. <input type="checkbox"/> CASING TEST AND CEMENT JOB <input type="checkbox"/> OTHER: <u>Drilling Program</u> <input checked="" type="checkbox"/>

12. Describe Proposed or Completed Operations (Clearly state all pertinent details, and give pertinent dates, including estimated date of starting any proposed work) SEE RULE 1103.

Drilled out from under casing with 6-1/4" bit September 20, 1992. Ran Compensated Density-Neutron logs with caliper and Gamma Ray. Log tops as follows: Fruitland - 861', Basal Fruitland Coal - 1060', and Pictured Cliffs - 1152'. Ran 29 jts (1249.54') of 4-1/2", 9.5#, J-55, 8RD, ST & C casing. Bakerloked cement nosed guide shoe on bottom and insert flapper float on top of 1st jt. Ran centralizers on top of 1st, 3rd, 5th, 7th, and 9th jts. Casing set at 1245.14', PBD at 1201.22'. Mixed and pumped 75 sks (154 cu ft) Class "B" cement containing 2% Thriftyment and 1/4 #/sk cellophane flakes. Tailed in with 70 sks (82 cu ft) Class "B" cement containing 2% CaCl₂ and 1/4 #/sk cellophane flakes. Circulated cement to surface. Pressure tested casing to 3500 psi for 15 minutes. Waiting on completion.

I hereby certify that the information above is true and complete to the best of my knowledge and belief.

FRW SIGNATURE Jeffrey R. Vaughan TITLE Engineering Manager DATE OCT - 2 1992
TYPE OR PRINT NAME Jeffrey R. Vaughan TELEPHONE NO.

(This space for State Use)

APPROVED BY Original Signed by FRANK T. CHAVEZ TITLE DATE OCT 05 1992
CONDITIONS OF APPROVAL, IF ANY:

GIANT EXPLORATION & PRODUCTION COMPANY
FRANK FOSTER WELL NO. 2
790' FNL, 790' FEL
SEC. 32, T25N, R12W
SAN JUAN COUNTY, NEW MEXICO
LEASE NO. VA-143
DEVIATION SURVEY

RECEIVED

OCT 08 1992

OIL CON. DIV
DIST. 2

<u>DATE</u>	<u>DEPTH</u>	<u>INCLINATION</u>
09-19-92	128'	1/4 degree
09-21-92	1160'	1/2 degree

By:

John C. Corbett
John C. Corbett
Vice President

Date:

10/6/92

State of New Mexico
County of San Juan

The foregoing instrument was acknowledged before me this
6th day of October, 1992 by John C. Corbett.

Lisa L. Sullivan
Notary Public

My commission expires: 8/7/94