

UNITED STATES  
DEPARTMENT OF THE INTERIOR  
BUREAU OF LAND MANAGEMENT

**SUNDRY NOTICES AND REPORTS ON WELLS**

Do not use this form for proposals to drill or to deepen or reentry to a different reservoir.  
Use "APPLICATION FOR PERMIT—" for such proposals

FORM APPROVED

Budget Bureau No. 1004-0135

Expires: March 31, 1993

5. Lease Designation and Serial No.

NM-86493

6. If Indian, Allottee or Tribe Name

N/A

7. If Unit or CA, Agreement Designation

N/A

8. Well Name and No.

WILLOW FLATS #3

9. API Well No.

30-045-28688

10. Field and Pool, or Exploratory Area

Basin Fruitland Coal

11. County or Parish, State

San Juan Co., N.M.

**SUBMIT IN TRIPLICATE**

1. Type of Well

☐ Oil Well ☒ Gas Well ☐ Other

2. Name of Operator

SPEEREX LIMITED PARTNERSHIP (PH. 505-325-7789)

3. Address and Telephone No.

P.O. BOX 255, FARMINGTON, N.M. 87499

4. Location of Well (Footage, Sec., T., R., M., or Survey Description)

1359 ft. fs1, 993 ft. fw1 (NWSW)

L-34-25N-12W

12. CHECK APPROPRIATE BOX(s) TO INDICATE NATURE OF NOTICE, REPORT, OR OTHER DATA

TYPE OF SUBMISSION

- ☒ Notice of Intent  
☐ Subsequent Report  
☐ Final Abandonment Notice

TYPE OF ACTION

- ☐ Abandonment  
☐ Recompletion  
☐ Plugging Back  
☐ Casing Repair  
☐ Altering Casing  
☐ Other Change in dedicated  
drilling block
- ☐ Change of Plans  
☐ New Construction  
☐ Non-Routine Fracturing  
☐ Water Shut-Off  
☐ Conversion to Injection  
☐ Dispose Water

(Note: Report results of multiple completion on Well Completion or Recompletion Report and Log form.)

13. Describe Proposed or Completed Operations (Clearly state all pertinent details, and give pertinent dates, including estimated date of starting any proposed work. If well is directionally drilled, give subsurface locations and measured and true vertical depths for all markers and zones pertinent to this work.)

Speerex Ltd. Partnership proposes to change the 320 acre drilling block dedicated to the well from the approved west half of section 34, T25N-R12W, NMPM. to the south half of the same section. Speerex Ltd. holds a federal lease, NM-86493, which covers the entire south half of the subject section.

**RECEIVED**

JAN 2 1993

OIL CON. DIST.

14. I hereby certify that the foregoing is true and correct.

Signed William R. Speer Title General Partner Date Jan. 11, 1993

(This space for Federal or State office use)

Approved by \_\_\_\_\_ Title \_\_\_\_\_ Date \_\_\_\_\_  
Conditions of approval, if any:

Title 18 U.S.C. Section 1001, makes it a crime for any person knowingly and willfully to make to any department or agency of the United States any false, fictitious or fraudulent statements or representations as to any matter within its jurisdiction.

\*See Instruction on Reverse Side

Submit to Appropriate  
District Office  
State Lease - 4 copies  
Fee Lease - 3 copies

STATE OF NEW MEXICO  
Energy, Minerals and Natural Resources Department

Form C-102  
Revised 1-1-89

OIL CONSERVATION DIVISION

P.O. Box 2088

Santa Fe, New Mexico 87504-2088

DISTRICT I

P.O. Box 1980, Hobbs, NM 88240

DISTRICT II

P.O. Drawer DD, Artesia, NM 88210

DISTRICT III

1000 Rio Brazos Rd., Aztec, NM 87410

WELL LOCATION AND ACREAGE DEDICATION PLAT

All Distances must be from the outer boundaries of the section

Operator Speerex, Ltd.		Lease Willow Flats		Well No. 3
Unit Letter L	Section 34	Township 25 North	Range 12 West	County San Juan
Actual Footage Location of Well: 1359 feet from the South line and 993 feet from the West line				
Ground level Elev. 6392 Est.	Producing Formation Fruitland Coal	Pool Basin Fruitland Coal	Dedicated Acreage: 320 Acres	

1. Outline the acreage dedicated to the subject well by colored pencil or hatchure marks on the plat below.

2. If more than one lease is dedicated to the well, outline each and identify the ownership thereof (both as to working interest and royalty).

3. If more than one lease of different ownership is dedicated to the well, have the interest of all owners been consolidated by communitization, unitization, force-pooling, etc.?

☐ Yes ☐ No If answer is "yes" type of consolidation

If answer is "no" list the owners and tract descriptions which have actually been consolidated. (Use reverse side of this form if necessary.)

No allowable will be assigned to the well until all interests have been consolidated (by communitization, unitization, forced-pooling, or otherwise) or until a non-standard unit, eliminating such interest, has been approved by the Division.

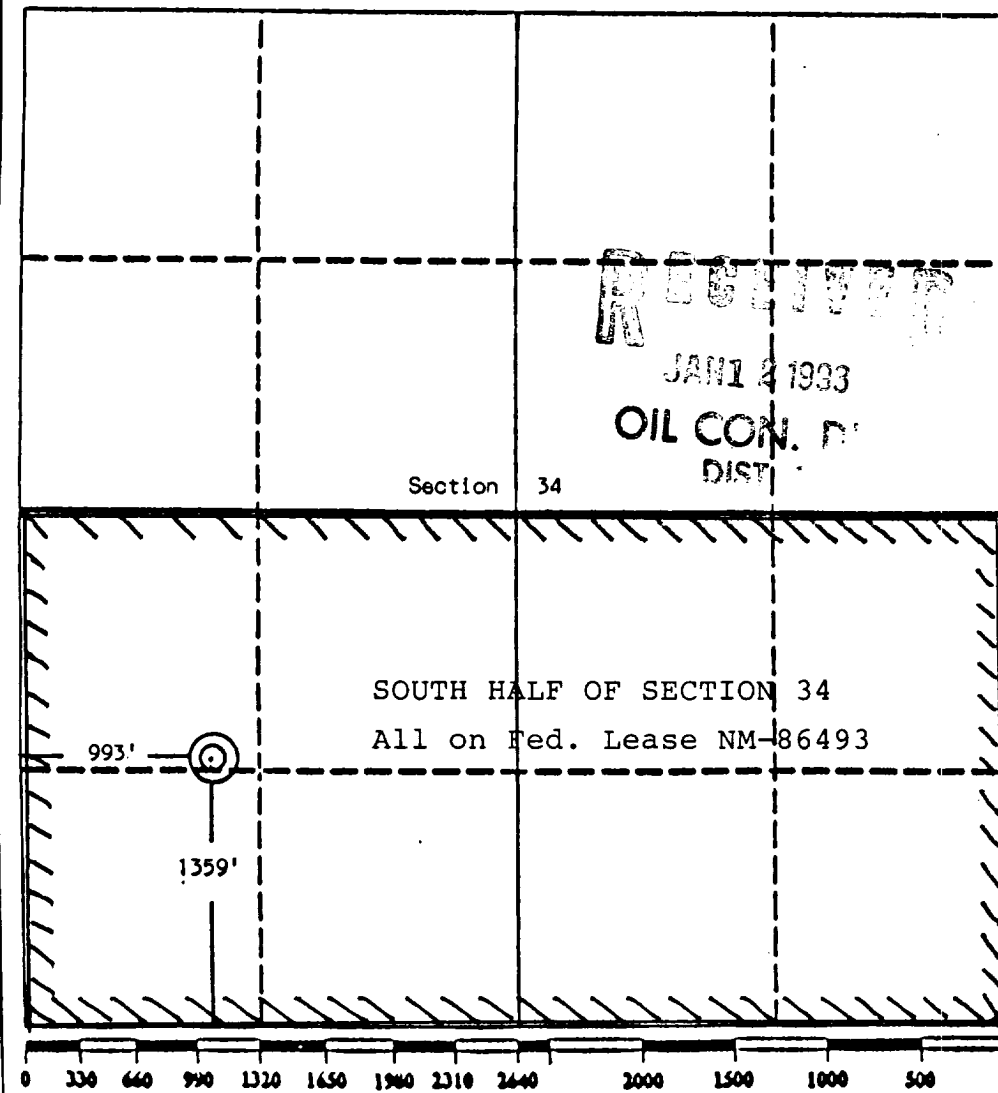

OPERATOR CERTIFICATION

I hereby certify that the information contained herein is true and complete to the best of my knowledge and belief.

Signature

William R. Speer

Printed Name

William R. Speer

Position

General Partner

Company

Speerex Ltd. Partnership

Date

January 11, 1993

SURVEYOR CERTIFICATION

I hereby certify that the well location shown on this plat was plotted from field notes of actual surveys made by me or under my supervision, and that the same is true and correct to the best of my knowledge and belief.

Date Surveyed

April 14, 1992

Signature & Seal of Professional Surveyor

EDGAR L. RISENHOVER  
NEW MEXICO  
Edgar L. Risenhoover  
Certificate No. 5979  
Edgar L. Risenhoover, P.S.