

Please use updated form!

STAMP IN TRIPLICATE*
(Other instruction on
reverse side)

Form approved
Budget Bureau No. 1004-0136
Expires August 31, 1985

UNITED STATES
DEPARTMENT OF THE INTERIOR

BUREAU OF LAND MANAGEMENT

APPLICATION FOR PERMIT TO DRILL, DEEPEN, OR PLUG BACK

1a. TYPE OF WORK

DRILL ☒

DEEPEN ☐

PLUG BACK

b. TYPE OF WELL

OIL
WELL ☐

GAS
WELL ☒

OTHER

SINGLE
ZONE ☒

MULTIPLE
ZONE ☐

2. NAME OF OPERATOR

Pro New Mexico

18118

3. ADDRESS OF OPERATOR

460 St. Michael's Drive, Suite 402 Santa Fe, NM 87505

4. LOCATION OF WELL (Report location clearly and in accordance with any State requirements.)*

At surface

1710' FSL, 940' FWL

At proposed prod. zone

Same

14. DISTANCE IN MILES AND DIRECTION FROM NEAREST TOWN OR POST OFFICE*

Seven miles west of Carson Trading Post.

15. DISTANCE FROM PROPOSED*

LOCATION TO NEAREST
PROPERTY OR LEASE LINE, FT.
(Also to nearest drlg. unit line, if any)

940'

16. NO. OF ACRES IN LEASE

320

18. DISTANCE FROM PROPOSED LOCATION*

TO NEAREST WELL, DRILLING, COMPLETED,
OR APPLIED FOR, ON THIS LEASE, FT.

806'

19. PROPOSED DEPTH

1672'

21. ELEVATIONS (Show whether DF, RT, GR, etc.)

6757' GR

5. LEASE DESIGNATION AND SERIAL NO.

NMNM036252

6. IF INDIAN, ALLOTTEE OR TRIBE NAME

7. UNIT AGREEMENT NAME

8. FARM OR LEASE NAME

21562 Gracia Federal 26 #1

9. WELL NO.

API

30-045-29489

10. FIELD AND POOL, OR WILDCAT

22319 Basin Fruitland Coal

11. SEC., T., R., M., OR BLK.

AND SURVEY OR AREA

L Sec. 26, T 25 N, R 11 W

12. COUNTY OR PARISH

San Juan

13. STATE

New Mexico

17. NO. OF ACRES ASSIGNED
TO THIS WELL

W/ 320

20. ROTARY OR CABLE TOOLS

Rotary

22. APPROX. DATE WORK WILL START*

As soon as permitted

23.

PROPOSED CASING AND CEMENTING PROGRAM

SIZE OF HOLE	SIZE OF CASING	WEIGHT PER FOOT	SETTING DEPTH	QUANTITY OF CEMENT
8 3/4"	7"	20#	120'	70 sx (83 cf) Class B cement with 2% CaCl and 1/4 #/sk cello flakes
6 1/4"	4 1/2"	10.50#	1672'	150 sx (309 cf) Class B with 2% Sodium Metasilicate and 1/4 #/sk cello flakes
				followed by 150 sx (177 cf) Class B with 2% CaCl and 1/4 #/sk cello flakes

This action is subject to technical and
procedural review pursuant to 43 CFR 3165.3
and appeal pursuant to 43 CFR 3165.4.

DRILLING OPERATIONS AUTHORIZED ARE
SUBJECT TO COMPLIANCE WITH ATTACHED
"GENERAL REQUIREMENTS"

RECEIVED
SEP 15 1997

OIL CON. DIV.
PMT 3

070 PRODUCTION, NM

SEP 11 PM 2:24

RECEIVED
PMT

IN ABOVE SPACE DESCRIBE PROPOSED PROGRAM: If proposal is to deepen or plug back, give data on present productive zone and proposed new productive zone. If proposal is to drill or deepen directionally, give pertinent data on subsurface locations and measured and true vertical depths. Give blowout preventer program, if any.

24.

SIGNED Dana S. Duane

TITLE Agent

DATE 11-Aug-97

(This space for Federal or State office use)

PERMIT NO.

APPROVAL DATE

APPROVED BY /S/ Duane W. Spencer

TITLE

DATE SEP 12 1997

CONDITIONS OF APPROVAL, IF ANY:

*See Instructions On Reverse Side

Title 18 U.S.C. Section 1001, makes it a crime for any person knowingly and willfully to make to any department or agency of the United States any false, fictitious or fraudulent statements or representations as to any matter within its jurisdiction.

NMOCD

Instructions on back
Submit to Appropriate District Office
State Lease - 4 Copies
Fee Lease - 3 Copies

Santa Fe, NM 87504-2088

☐ AMENDED REPORT

57 AUG 11 PM 2:24

Basin Fruitland Coal

11 Bottom Hole Location If Different From Surface

13 Dedicated Acres	14 Joint or Infill	15 Consolidation Code	16 Order No.
320	N		

NO ALLOWABLE WILL BE ASSIGNED TO THIS COMPLETION UNTIL ALL INTERESTS HAVE BEEN CONSOLIDATED
OR A NON-STANDARD UNIT HAS BEEN APPROVED BY THE DIVISION

RECEIVED
SEP 15 1967
OIL CONL DIV.
DIST. 3

17 OPERATOR CERTIFICATION

I hereby certify that the information contained herein is true and complete to the best of my knowledge and belief

Dana L. Delventhal
Signature

Dana L. Delventhal

Printed Name _____

Agent

Title

August 11, 1997
Date

18 SURVEYOR CERTIFICATION

I hereby certify that the well location shown on this plat was plotted from field notes of actual surveys made by me or under my supervision, and that the same is true and correct to the best of my belief.

8-7-9
Date of Survey

Signature and Seal of Professional Surveyor

10

RE 8894

6119 8834

100

U.S. DEPARTMENT OF THE INTERIOR
BUREAU OF LAND MANAGEMENT

PROFESSIONAL

8894

Certificate Number

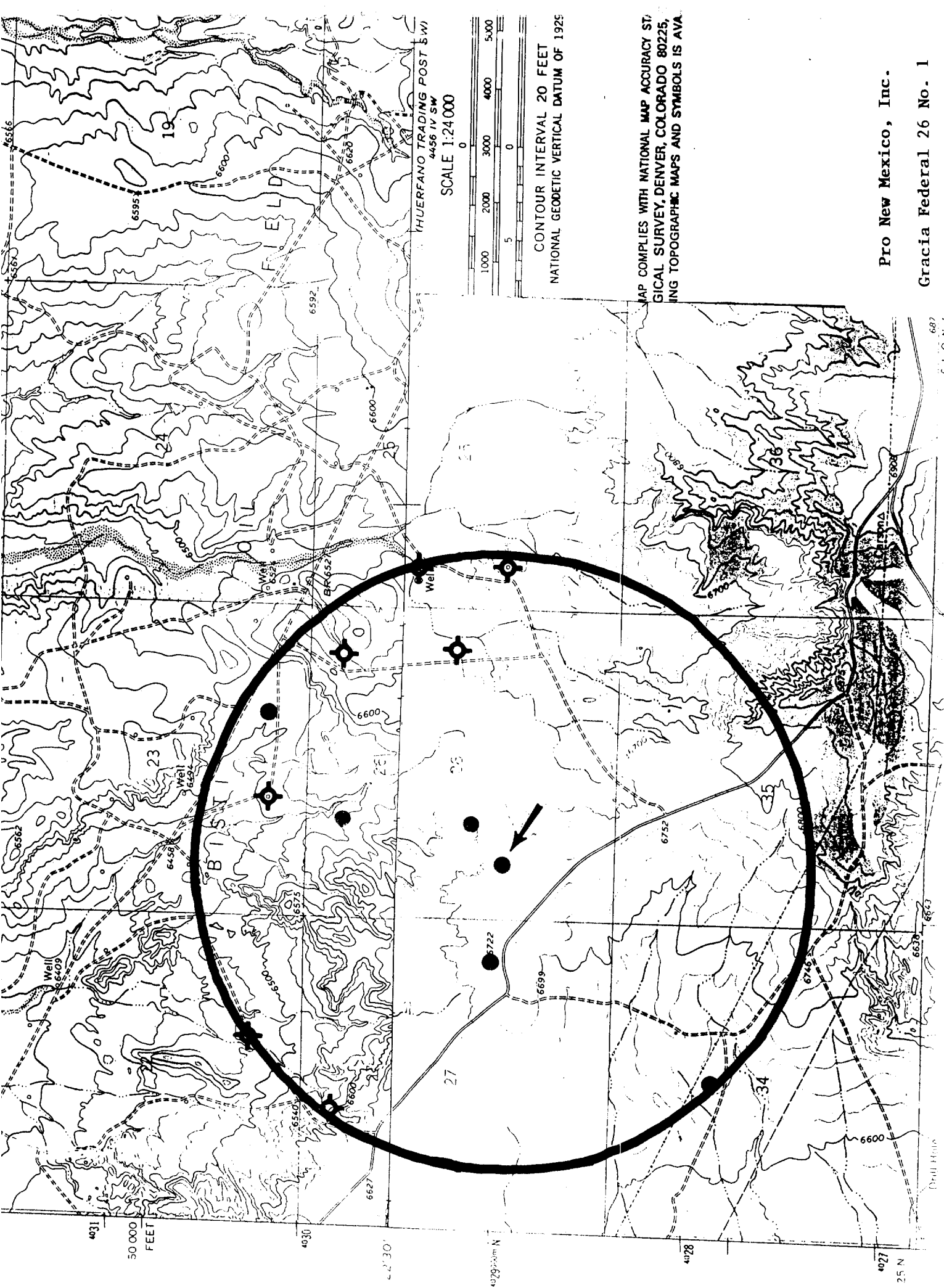

SCALE 1:24 000

CONTOUR INTERVAL 20 FEET
NATIONAL GEODETIC VERTICAL DATUM OF 1929

MAP COMPLIES WITH NATIONAL MAP ACCURACY STANDARDS
FEDERAL SURVEY, DENVER, COLORADO 80225,
USING TOPOGRAPHIC MAPS AND SYMBOLS IS AVAILABLE

Pro New Mexico, Inc.

Gracia Federal 26 No. 1