

(SUBMIT IN TRIPLICATE)

UNITED STATES
DEPARTMENT OF THE INTERIOR
GEOLOGICAL SURVEY

Land Office Santa Fe
Lease No. 075048
Unit Hughes

SUNDRY NOTICES AND REPORTS ON WELLS

NOTICE OF INTENTION TO DRILL.....	<input checked="" type="checkbox"/>	SUBSEQUENT REPORT OF WATER SHUT-OFF.....	
NOTICE OF INTENTION TO CHANGE PLANS.....		SUBSEQUENT REPORT OF SHOOTING OR ACIDIZING.....	
NOTICE OF INTENTION TO TEST WATER SHUT-OFF.....		SUBSEQUENT REPORT OF ALTERING CASING.....	
NOTICE OF INTENTION TO RE-DRILL OR REPAIR WELL.....		SUBSEQUENT REPORT OF RE-DRILLING OR REPAIR.....	
NOTICE OF INTENTION TO SHOOT OR ACIDIZE.....		SUBSEQUENT REPORT OF ABANDONMENT.....	
NOTICE OF INTENTION TO PULL OR ALTER CASING.....		SUPPLEMENTARY WELL HISTORY.....	
NOTICE OF INTENTION TO ABANDON WELL.....			

(INDICATE ABOVE BY CHECK MARK NATURE OF REPORT, NOTICE, OR OTHER DATA)

November 7, 1950

Well No. 2-30 is located 1135 ft. from [N] line and 1625 ft. from [E] line of sec. 30
NE section 30 20N 1W 1904M
($\frac{1}{4}$ Sec. and Sec. No.) (Twp.) (Range) (Meridian)
Ballard P.C. Exl. Rio Arriba New Mexico
(Field) (County or Subdivision) (State or Territory)

The elevation of the derrick floor above sea level is 6291 ft.

DETAILS OF WORK

(State names of and expected depths to objective sands; show sizes, weights, and lengths of proposed casings; indicate mudding jobs, cementing points, and all other important proposed work)

It is intended to drill a well thru the Pictured Cliff formation using rotary tools and to perforate and water fracture possible producing zones. Estimated T.D. 2300'.

Casing Program:

9 5/8" at 1200' with 125 sacks regular cement circulated to surface.
5 1/2" at 2300' with 75 sacks regular cement, 75 sacks Pozmix.

The NE $\frac{1}{4}$ of section 30 is dedicated to this well.
NE $\frac{1}{4}$ of 075048.

I understand that this plan of work must receive approval in writing by the Geological Survey before operation may be commenced.

Company El Paso Natural Gas Company

Address Box 997

Farmington, New Mexico



Original Signed EWELL N. WALSH
By _____

Title Petroleum Engineer

ILLEGIBLE

NEW MEXICO
OIL CONSERVATION COMMISSION

Form C-128

WELL LOCATION AND/OR GAS PRORATION PLAT

DATE November 7, 1956

OPERATOR EL PASO NATURAL GAS CO. LEASE HUGHES

WELL NO. 2 - 30 SECTION 30 TOWNSHIP 26 NORTH RANGE 7 WEST NMPM

LOCATED 1165 FEET FROM the NORTH LINE 1625 FEET FROM the EAST LINE

RIO ARRIBA COUNTY, NEW MEXICO G.L. ELEVATION 6281.0 UNGRADED.

NAME OF PRODUCING FORMATION Pictured Cliff POOL Millard Est. DEDICATED ACREAGE 160

Note: All distances must be from outer boundaries of section.

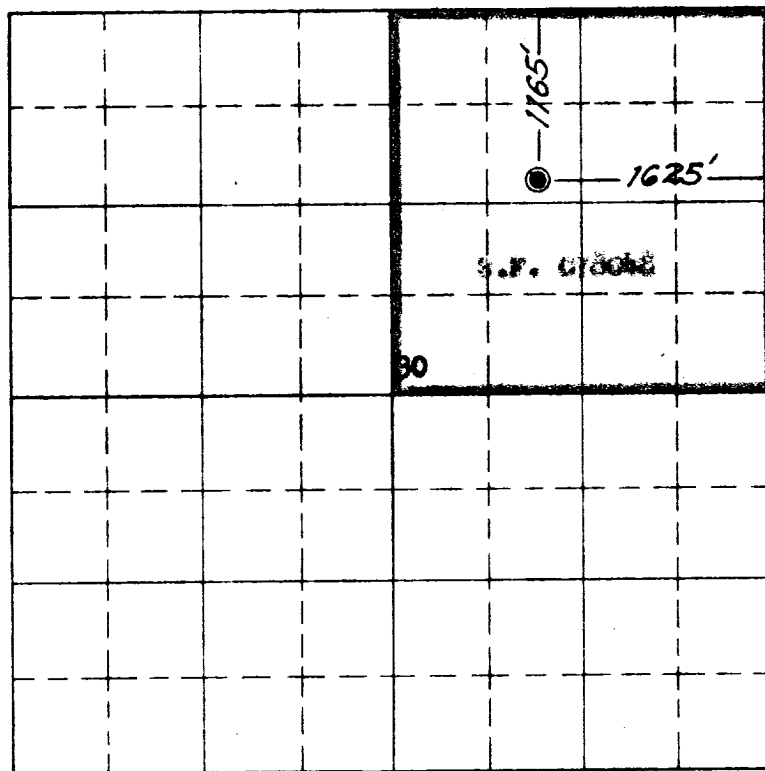

Scale 4 inches equal 1 mile

RECEIVED
NOV 7 1956
U. S. GEOLOGICAL SURVEY
FARMINGTON, NEW MEXICO

NOTE

This section of
form is to be used
for gas wells only

This is to certify that the above plat was prepared from
field notes of actual surveys made by me or under my
supervision and that the same are true and correct to the
best of my knowledge and belief.

Date Surveyed 29 APRIL 1956

James P. Leese
Registered Professional Engineer and/or Land Surveyor
James P. Leese
N. Mex. Reg. No. 1463

1. Is this well a Dual Comp. 2

Yes _____ No _____

2. If the answer to Question 1
is yes, are there any other dually
completed wells within the
dedicated acreage.

Yes _____ No _____

Original Signed EWELL N. WALSH
Name _____

Position Petroleum Engineer

El Paso Natural Gas Co.

Representing Box 997, Farmington, N.M.

Address _____