

(SUBMIT IN TRIPLICATE)

UNITED STATES  
DEPARTMENT OF THE INTERIOR  
GEOLOGICAL SURVEY

Land Office Santa Fe  
Lease No. 067998  
Unit \_\_\_\_\_

X			

## SUNDRY NOTICES AND REPORTS ON WELLS

NOTICE OF INTENTION TO DRILL.....	X	SUBSEQUENT REPORT OF WATER SHUT-OFF.....	
NOTICE OF INTENTION TO CHANGE PLANS.....		SUBSEQUENT REPORT OF SHOOTING OR ACIDIZING.....	
NOTICE OF INTENTION TO TEST WATER SHUT-OFF.....		SUBSEQUENT REPORT OF ALTERING CASING.....	
NOTICE OF INTENTION TO RE-DRILL OR REPAIR WELL.....		SUBSEQUENT REPORT OF RE-DRILLING OR REPAIR.....	
NOTICE OF INTENTION TO SHOOT OR ACIDIZE.....		SUBSEQUENT REPORT OF ABANDONMENT.....	
NOTICE OF INTENTION TO PULL OR ALTER CASING.....		SUPPLEMENTARY WELL HISTORY.....	
NOTICE OF INTENTION TO ABANDON WELL.....			

(INDICATE ABOVE BY CHECK MARK NATURE OF REPORT, NOTICE, OR OTHER DATA)

\_\_\_\_\_ January 2, 19 62

USA  
T. J. Foster  
Well No. 2 is located 860 ft. from (N) line and 1010 ft. from (W) line of sec. 18

NW/4 Sec. 18 26 N 7 W N.M.P.M.  
(1/4 Sec. and Sec. No.) (Twp.) (Range) (Meridian)

Basin Dakota San Juan New Mexico  
(Field) (County or Subdivision) (State or Territory)

The elevation of the ground level ~~casings~~ above sea level is 6139 ft.

### DETAILS OF WORK

(State names of and expected depths to objective sands; show sizes, weights, and lengths of proposed casings; indicate mudding jobs, cementing points, and all other important proposed work)

We propose to drill subject well as follows:

1. Drill 12-1/4" hole to 250'. Run 8-5/8" OD, 24#, J-55, STAC casing to 250' and cement with sufficient volume to circulate cement.
2. WOC 12 hours. Pressure test casing after WOC 8 hours.
3. Drill 7-7/8" hole to TD of approximately 7000'.
4. At TD run MS-Induction and Gamma Ray-Sonic logs.
5. Run 5-1/2" casing with cement stage collar 50' below the base of the Pictured Cliff and cement in two stages.
6. Run tubing, potential well and clean location.

I understand that this plan of work must receive approval in writing by the Geological Survey before operations may be commenced.

Company Tenneco Oil Company

Address P. O. Box 1714

Durango, Colorado

By L. B. Plumb L. B. Plumb  
Title District Production Superintendent

NUMBER OF COPIES RECEIVED	
DISTRIBUTION	
SANTO FE	
FILE	
U.S.G.S.	
LAND OFFICE	
TRANSPORTER	OIL GAS
PROBATION OFFICE	
OPERATOR	

FORM C-128  
Revised 5/1/57

# NEW MEXICO OIL CONSERVATION COMMISSION WELL LOCATION AND ACREAGE DEDICATION PLAT SEE INSTRUCTIONS FOR COMPLETING THIS FORM ON THE REVERSE SIDE

## SECTION A

Operator <b>Tenneco Oil Company</b>		Lease <del>USA</del> <b>T. J. Foster</b>		Well No. <b>2</b>
Unit Letter <b>D</b>	Section <b>18</b>	Township <b>26 North</b>	Range <b>7 West</b>	County <b>Rio Arriba</b>
Actual Footage Location of Well: <b>860</b> feet from the <b>North</b> line and <b>1010</b> feet from the <b>West</b> line				
Ground Level Elev. <b>6158.7' ungrded</b>	Producing Formation <b>Dakota</b>	Pool <b>Basin Dakota</b>	Dedicated Acreage: <b>380 4.719.72</b> Acres	

1. Is the Operator the only owner in the dedicated acreage outlined on the plat below? YES ☒ NO \_\_\_\_ . ("Owner" means the person who has the right to drill into and to produce from any pool and to appropriate the production either for himself or for himself and another. (65-3-29 (e) NMSA 1935 Comp.)
2. If the answer to question one is "no," have the interests of all the owners been consolidated by communitization agreement or otherwise? YES \_\_\_\_ NO \_\_\_\_ . If answer is "yes," Type of Consolidation \_\_\_\_
3. If the answer to question two is "no," list all the owners and their respective interests below:

Owner	Land Description

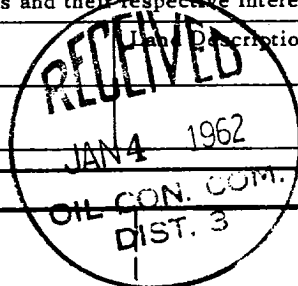

## SECTION B

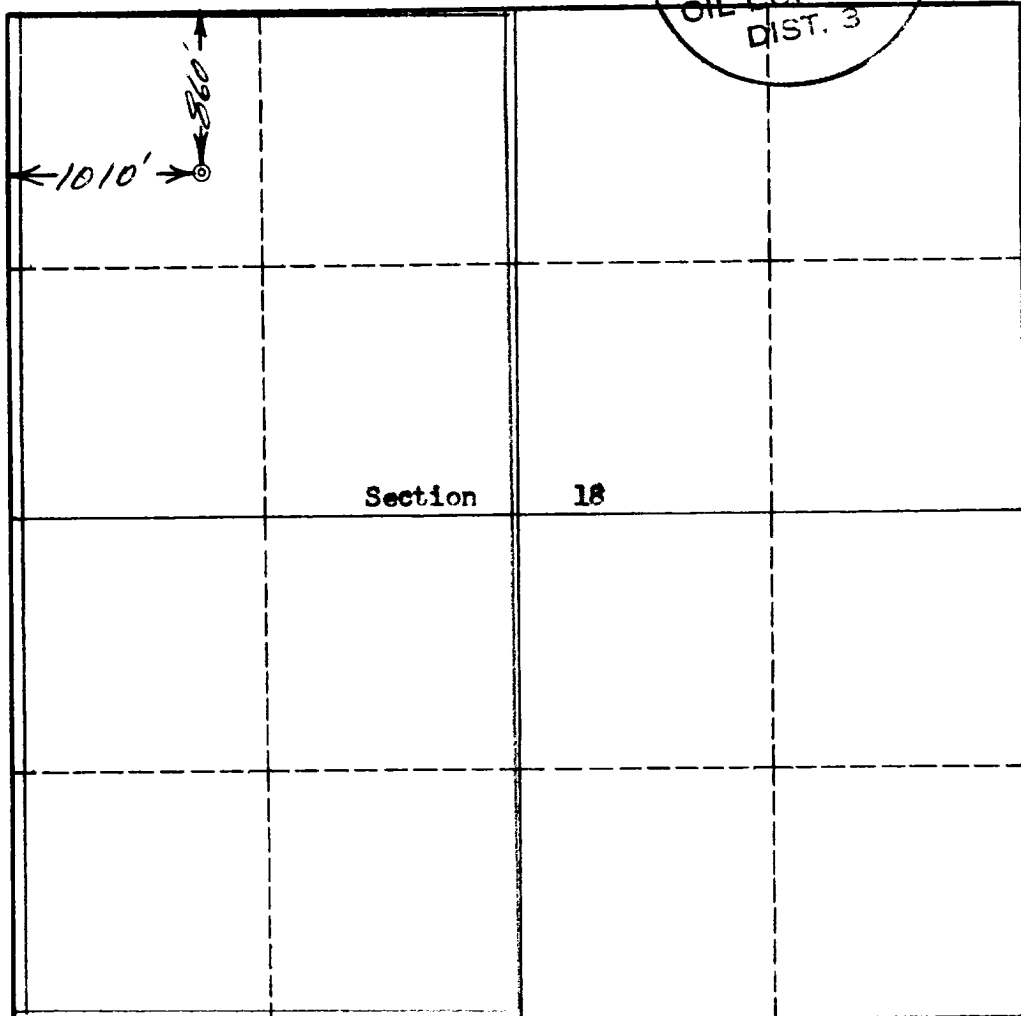

## CERTIFICATION

I hereby certify that the information in SECTION A above is true and complete to the best of my knowledge and belief.

Name <b>L. B. Flumb</b>
Position <b>Dist. Production Supt.</b>
Company <b>Tenneco Oil Company</b>
Date <b>January 2, 1962</b>

I hereby certify that the well location shown on the plat in SECTION B was plotted from field notes of actual surveys made by me or under my supervision, and that the same is true and correct to the best of my knowledge and belief.

Date Surveyed <b>26 December 1961</b>
Registered Professional Engineer and/or Land Surveyor <b>Robert H. Farris</b> <b>San Juan Engineering Co.</b>
Certificate No. <b>PE &amp; LS 2463</b>

0 330 660 990 1320 1650 1980 2310 2640 2000 1500 1000 500

## INSTRUCTIONS FOR COMPLETION OF FORM C-128

1. Operator shall furnish and certify to the information called for in Section A.
2. Operator shall outline the dedicated acreage for *both* oil and gas wells on the plat in Section B.
3. A registered professional engineer or land surveyor registered in the State of New Mexico or approved by the Commission shall show on the plat the location of the well and certify this information in the space provided.
4. All distances shown on the plat must be from the outer boundaries of the Section.
5. If additional space is needed for listing owners and their respective interests as required in question 3 of Section A, please use space below.