



COPY TO O.C.C.

UNITED STATES
DEPARTMENT OF THE INTERIOR
GEOLOGICAL SURVEY
P. O. Box 965
Farmington, New Mexico

IN REPLY REFER TO:

April 11, 1956

El Paso Natural Gas Company
Box 997
Farmington, New Mexico

Re: Santa Fe 079360

Gentlemen:

Receipt is acknowledged of your "Notice of Intention to Drill" dated April 9, 1956 covering your well No. 66 Hincen Unit in NE $\frac{1}{4}$ sec. 22, T. 27 N., R. 7 W., N. M. P. M., Rio Arriba County, New Mexico, So. Blanco P.C.

Your proposed work is hereby approved subject to compliance with the provisions of the "Oil and Gas Operating Regulations" revised May 25, 1942, a copy of which will be sent to you on request, and subject to the following conditions:

1. Drilling operations so authorized are subject to the attached sheet for general conditions of approval.
2. Furnish copies of all logs.

Very truly yours,

(Orig. Sgd.) P. T. McGrath

P. T. McGrath
District Engineer

PTMcGrath:ac

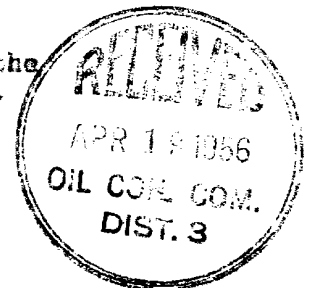

IN REPLY TO

UNITED STATES
DEPARTMENT OF THE INTERIOR
GEOLOGICAL SURVEY

WASHINGTON, D. C.
1900

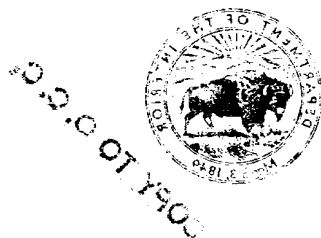

TO THE
DIRECTOR

FROM

DATE

REPLY TO LETTER OF THE DIRECTOR
OF THE GEOLOGICAL SURVEY
DATED JANUARY 1, 1900

THE FOLLOWING IS A SUMMARY
OF THE RESULTS OF THE
EXPLORATIONS MADE BY THE
GEOLOGICAL SURVEY

IN THE TERRITORY OF
ARIZONA, DURING THE
YEAR 1900

BY
J. W. GOWENLOCK

(Ung. 264) P. T. M. 1900

1900

(SUBMIT IN TRIPLICATE)

UNITED STATES
DEPARTMENT OF THE INTERIOR
GEOLOGICAL SURVEY

Land Office Santa Fe
Lease No. 079360
Unit Bincon Unit

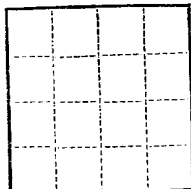

SUNDRY NOTICES AND REPORTS ON WELLS

NOTICE OF INTENTION TO DRILL	<input checked="" type="checkbox"/>	SUBSEQUENT REPORT OF WATER SHUT-OFF	
NOTICE OF INTENTION TO CHANGE PLANS		SUBSEQUENT REPORT OF SHOOTING OR ACIDIZING	
NOTICE OF INTENTION TO TEST WATER SHUT-OFF		SUBSEQUENT REPORT OF ALTERING CASING	
NOTICE OF INTENTION TO RE-DRILL OR REPAIR WELL		SUBSEQUENT REPORT OF RE-DRILLING OR REPAIR	
NOTICE OF INTENTION TO SHOOT OR ACIDIZE		SUBSEQUENT REPORT OF ABANDONMENT	
NOTICE OF INTENTION TO PULL OR ALTER CASING		SUPPLEMENTARY WELL HISTORY	
NOTICE OF INTENTION TO ABANDON WELL			

(INDICATE ABOVE BY CHECK MARK NATURE OF REPORT, NOTICE, OR OTHER DATA)

April 9, 1956

Well No. 66 is located 1045 ft. from [N] line and 990 ft. from [E] line of sec. 22

NE Section 22
(¼ Sec. and Sec. No.)

27N
(Twp.)

7W
(Range)

R4PM
(Meridian)

So. Blanco P.C.
(Field)

Rio Arriba
(County or Subdivision)

New Mexico
(State or Territory)

The elevation of the derrick floor above sea level is 6559 ft.

DETAILS OF WORK

(State names of and expected depths to objective sands; show sizes, weights, and lengths of proposed casings; indicate mudding jobs, cementing points, and all other important proposed work)

It is intended to drill a well thru the Pictured Cliff formation using rotary tools to the casing point and to drill the pay section with cable tools and to water fracture the entire pay section. Est. T.D. 3080'.

Casing Program:

9 5/8" at 120' with 125 sacks regular cement circulated to surface.
5 1/2" at 3010' with 75 sacks regular cement, 75 sacks Pozmix.

The NE/4 of Section 22 is dedicated to this well.
(NE/4) of 079360.

I understand that this plan of work must receive approval in writing by the Geological Survey before operations may be commenced.

Company El Paso Natural Gas Company

Address Box 997

Farmington, New Mexico

By [Signature]
Title Petroleum Engineer

OIL CONSERVATION COMMISSION

WELL LOCATION AND/OR GAS PRODUCTION PLAT

DATE MARCH 14, 1956OPERATOR EL PASO NATURAL GAS COMPANY LEASE RINCON SF 079360WELL NO. 66 SECTION 22 TOWNSHIP 27-N RANGE 7-W NMMNLOCATED 1645 FEET FROM NORTH LINE 990 FEET FROM EAST LINERIO ARriba COUNTY, NEW MEXICO G. L. ELEVATION 6549NAME OF PRODUCING FORMATION PICTURED CLIFF POOL SO. BLANCO DEDICATED ACREAGE 160
(1882 PLAT)

Note: All distances must be from outer boundaries of section.

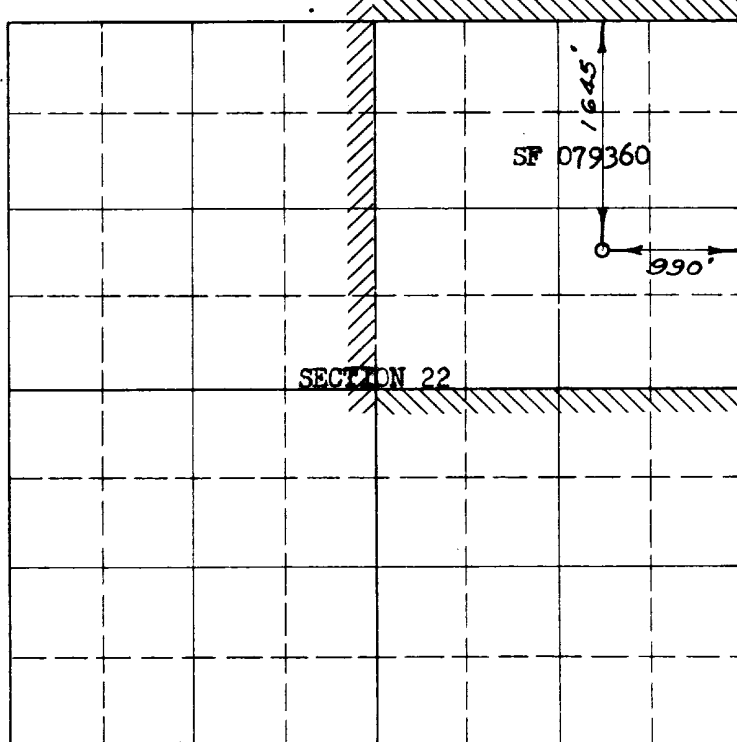

Scale 4 inches equal 1 mile

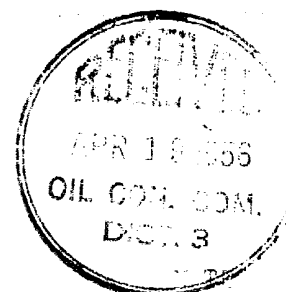

This section of
form is to be used
for platting only

This is to certify that the above plat was prepared from field notes of actual surveys made by me or under my supervision and that the same are true and correct to the best of my knowledge and belief.

Date Surveyed MARCH 7, 1956

E. O. Walker
Registered Professional Engineer and/or
Land Surveyor

Coal

Farmington, New Mexico

1. Is this well a Dual Comp.
Yes No
2. If the answer to question 1
is yes, are there any other
dualy completed wells within
the dedicated group.
Yes No

Name Will W. WalkerPosition Petroleum EngineerRepresenting El Paso Natural GasAddress Box 997, Farmington, N.M.