

(SUBMIT IN TRIPLICATE)

UNITED STATES  
DEPARTMENT OF THE INTERIOR  
GEOLOGICAL SURVEY

Land Office Santa Fe  
Lease No. 080670  
Unit San Juan 27-4 Unit  
14-08-001-1054

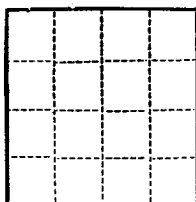

## SUNDRY NOTICES AND REPORTS ON WELLS

|   |                                     |   |  |
|---|-------------------------------------|---|--|
| NOTICE OF INTENTION TO DRILL.....                   | <input checked="" type="checkbox"/> | SUBSEQUENT REPORT OF WATER SHUT-OFF.....        |  |
| NOTICE OF INTENTION TO CHANGE PLANS.....            |                                     | SUBSEQUENT REPORT OF SHOOTING OR ACIDIZING..... |  |
| NOTICE OF INTENTION TO TEST WATER SHUT-OFF.....     |                                     | SUBSEQUENT REPORT OF ALTERING CASING.....       |  |
| NOTICE OF INTENTION TO RE-DRILL OR REPAIR WELL..... |                                     | SUBSEQUENT REPORT OF RE-DRILLING OR REPAIR..... |  |
| NOTICE OF INTENTION TO SHOOT OR ACIDIZE.....        |                                     | SUBSEQUENT REPORT OF ABANDONMENT.....           |  |
| NOTICE OF INTENTION TO PULL OR ALTER CASING.....    |                                     | SUPPLEMENTARY WELL HISTORY.....                 |  |
| NOTICE OF INTENTION TO ABANDON WELL.....            |                                     |   |  |

(INDICATE ABOVE BY CHECK MARK NATURE OF REPORT, NOTICE, OR OTHER DATA)

May 20, 1960

Well No. 20 is located 860 ft. from 100 line and 790 ft. from 150 line of sec. 31  
S. W. Sec. 31 (1/4 Sec. and Sec. No.) 27 N 4 W H.M.P.M.  
(Twp.) (Range) (Meridian)  
Blanco Mesa Verde Rio Arriba New Mexico  
(Field) (County or Subdivision) (State or Territory)

The elevation of the derrick floor above sea level is 732 ft.

### DETAILS OF WORK

(State names of and expected depths to objective sands; show sizes, weights, and lengths of proposed casings; indicate mudding jobs, cementing points, and all other important proposed work)

It is intended to drill a well with rotary tools thru the Mesa Verde formation. Mud circulation will be used thru the Pictured Cliffs and set intermediate casing. Gas circulation will be used thru the Mesa Verde and production liner will be set. Possible productive intervals will be perforated and fractured. Estimated T.D. 6500'.

#### Casing Program:

10 3/4" at 170', with 150 sacks cement circulated to the surface.  
7 5/8" at 4300' with 250 sacks cement.  
5 1/2" liner at 6500' with 300 sacks cement.

The W/2 of Section 31 is dedicated to this well.

W/2 S.F. 080670

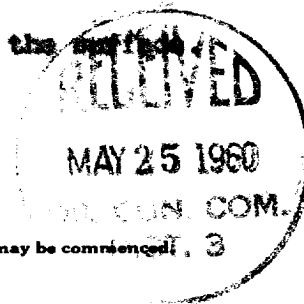

I understand that this plan of work must receive approval in writing by the Geological Survey before operations may be commenced.

Company El Paso Natural Gas Company

Address Box 907

Farmington, New Mexico

By ORIGINAL SIGNED J.J. TILLERSON

Title Petroleum Engineer

## NEW MEXICO OIL CONSERVATION COMMISSION

Well Location and Acreage Dedication Plat

Section A.

Date **MAY 10, 1960**

Operator **EL PASO NATURAL GAS COMPANY** Lease **SAN JUAN 27-4 UNIT** SF **080670**  
 Well No. **26** Unit Letter **M** Section **31** Township **27-N** Range **4-W** NMPM  
 Located **860** Feet From **SOUTH** Line, **790** Feet From **WEST** Line  
 County **RIO ARriba** G. L. Elevation **7352** Dedicated Acreage **323.16** Acres  
 Name of Producing Formation **MESA VERDE** Pool **BLANCO MESA VERDE**

1. Is the Operator the only owner in the dedicated acreage outlined on the plat below?  
 Yes \_\_\_\_\_ No **X**
2. If the answer to question one is "no", have the interests of all the owners been consolidated by communization agreement or otherwise? Yes **X** No \_\_\_\_\_. If answer is "yes", Type of Consolidation.  
**Unit Agreement**

3. If the answer to question two is "no", list all the owners and their respective interests below:

OwnerLand Description

Section B.

This is to certify that the information in Section A above is true and complete to the best of my knowledge and belief.

**El Paso Natural Gas Company**

(Operator)

**ORIGINAL SIGNED J.J. TILLERSON**

(Representative)

**Box 997**

(Address)

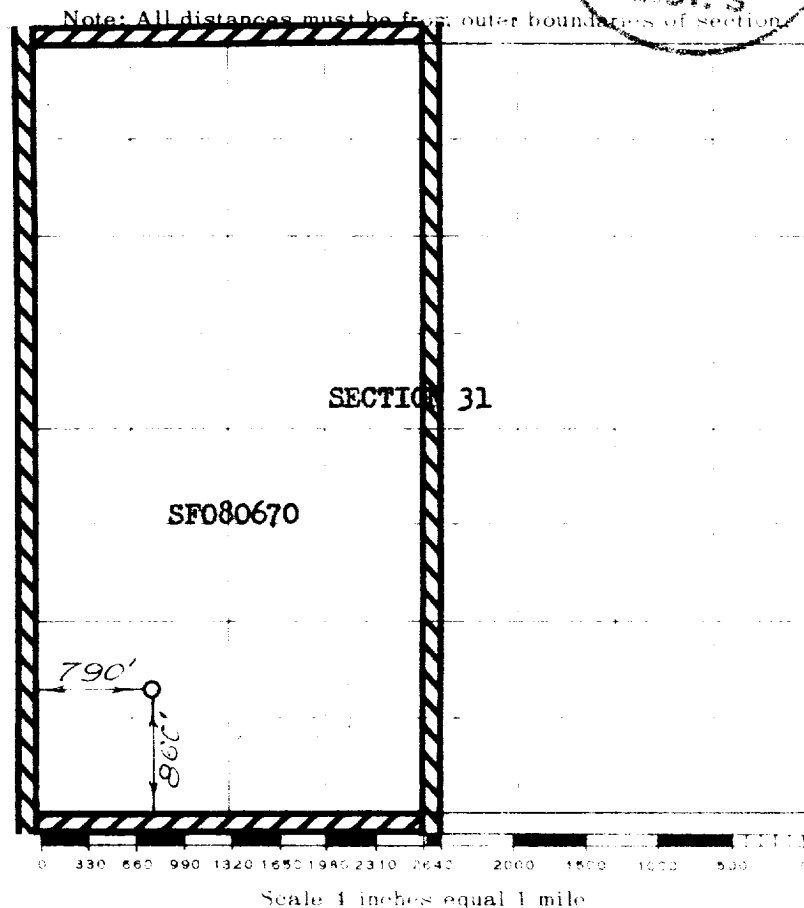
**Farmington, New Mexico**

This is to certify that the above plat was prepared from field notes of actual surveys made by me or under my supervision and that the same are true and correct to the best of my knowledge and belief.

(Seal)

Date Surveyed **APRIL 13, 1960**

*David C. Tiller*  
 Registered Professional Engineer and Land Surveyor

Farmington, New Mexico