

L

(SUBMIT IN TRIPLICATE)

UNITED STATES
DEPARTMENT OF THE INTERIOR
GEOLOGICAL SURVEY

Land Office Santa Fe

Lease No. 030670

Unit San Juan 27-4 Unit
14-05-001-1054

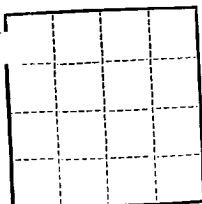

SUNDRY NOTICES AND REPORTS ON WELLS

NOTICE OF INTENTION TO DRILL	<input checked="" type="checkbox"/>	SUBSEQUENT REPORT OF WATER SHUT-OFF	
NOTICE OF INTENTION TO CHANGE PLANS		SUBSEQUENT REPORT OF SHOOTING OR ACIDIZING	
NOTICE OF INTENTION TO TEST WATER SHUT-OFF		SUBSEQUENT REPORT OF ALTERING CASING	
NOTICE OF INTENTION TO RE-DRILL OR REPAIR WELL		SUBSEQUENT REPORT OF RE-DRILLING OR REPAIR	
NOTICE OF INTENTION TO SHOOT OR ACIDIZE		SUBSEQUENT REPORT OF ABANDONMENT	
NOTICE OF INTENTION TO PULL OR ALTER CASING		SUPPLEMENTARY WELL HISTORY	
NOTICE OF INTENTION TO ABANDON WELL			

(INDICATE ABOVE BY CHECK MARK NATURE OF REPORT, NOTICE, OR OTHER DATA)

September 1, 1961

Well No. 30 is located 800 ft. from S line and 1450 ft. from W line of sec. 32
SW/4 Sec. 32 27N 4W N.M.P.M.
(1/4 Sec. and Sec. No.) (Twp.) (Range) (Meridian)
Basin Dakota Rio Arriba New Mexico
(Field) (County or Subdivision) (State or Territory)

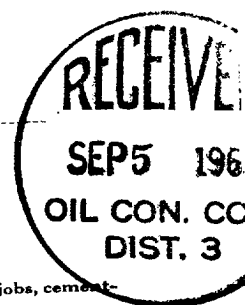

The elevation of the derrick floor above sea level is 7173 ft.

DETAILS OF WORK

(State names of and expected depths to objective sands; show sizes, weights, and lengths of proposed casings; indicate mudding jobs, cementing points, and all other important proposed work)

It is intended to drill a well with rotary tools thru the Dakota formation and to perforate and fracture possible producing zones. Est. T. D. 8473'.

Casing Program:

10 3/4" at 280' with 220 sacks cement circulated to surface.
4 1/2" at 8473' cemented in three stages.

First Stage - 230 sacks cement - 411 cu. ft. slurry - 50% excess to cover 100' above Gallup top.

Second Stage - 225 sacks cement - 392 cu. ft. slurry - 50% excess to cover 100' above Cliff House top.

Third Stage - 180 sacks cement - 460 cu. ft. slurry - 50% excess to cover 100' above Ojo Alamo Top.

The W/2 of Section 32 is dedicated to this well.

I understand that this plan of work must receive approval in writing by the Geological Survey before operations may be commenced.

Company El Paso Natural Gas Company

Address Box 990

Farmington, New Mexico

By ORIGINAL SIGNED A.M. SMITH

Title Petroleum Engineer

NEW MEXICO OIL CONSERVATION COMMISSION

Well Location and Acreage Dedication Plat

Section A.

Date **AUGUST 31, 1961**

Operator **EL PASO NATURAL GAS COMPANY** Lease **SAN JUAN 27-4 UNIT** SF **080670**
 Well No. **30** Unit Letter **N** Section **32** Township **27-N** Range **4-W** NMPM
 Located **800** Feet From **SOUTH** Line, **1450** Feet From **WEST** Line
 County **RIO ARriba** G. L. Elevation **7168** Dedicated Acreage **320** Acres
 Name of Producing Formation **DAKOTA** Pool **BASIN DAKOTA**

1. Is the Operator the only owner in the dedicated acreage outlined on the plat below?

Yes _____ No **X** _____2. If the answer to question one is "no", have the interests of all the owners been consolidated by communization agreement or otherwise? Yes **X** No _____ If answer is "yes", Type of Consolidation.**Unit Agreement**

3. If the answer to question two is "no", list all the owners and their respective interests below:

Owner

Land Description



Section B.

This is to certify that the information in Section A above is true and complete to the best of my knowledge and belief

El Paso Natural Gas Company
 (Operator)
ORIGINAL SIGNED A.M. SMITH
 (Representative)

Box 990
 (Address)
Farmington, New Mexico

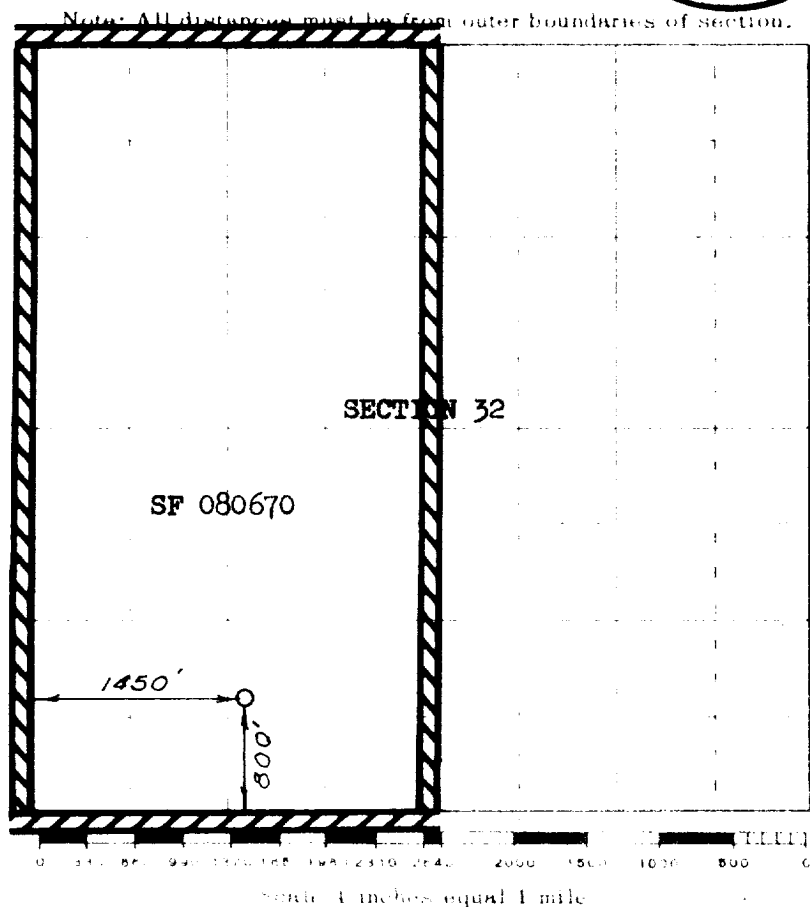

This is to certify that the above plat was prepared from field notes of actual surveys made by me or under my supervision and that the same are true and correct to the best of my knowledge and belief.

(Seal)

Date Surveyed **JULY 11, 1961**

Farmington, New Mexico

Registered Professional Engineer and/or Land Surveyor