

(SUBMIT IN TRIPLICATE)

UNITED STATES
DEPARTMENT OF THE INTERIOR
GEOLOGICAL SURVEY

Land Office Santa Fe
Lease No. 079364
Unit Rincon Unit

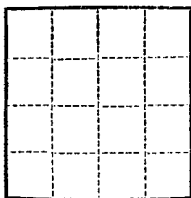

SUNDRY NOTICES AND REPORTS ON WELLS RECEIVED

NOTICE OF INTENTION TO DRILL	SUBSEQUENT REPORT OF WATER SHUT-OFF	AUG 22 1958 U.S. GEOLOGICAL SURVEY SANTA FE, NEW MEXICO
NOTICE OF INTENTION TO CHANGE PLANS	SUBSEQUENT REPORT OF SHOOTING OR ACIDIZING	
NOTICE OF INTENTION TO TEST WATER SHUT-OFF	SUBSEQUENT REPORT OF ALTERING CASING	
NOTICE OF INTENTION TO RE-DRILL OR REPAIR WELL	SUBSEQUENT REPORT OF RE-DRILLING OR REPAIR	
NOTICE OF INTENTION TO SHOOT OR ACIDIZE	SUBSEQUENT REPORT OF ABANDONMENT	
NOTICE OF INTENTION TO PULL OR ALTER CASING	SUPPLEMENTARY WELL HISTORY	
NOTICE OF INTENTION TO ABANDON WELL		

(INDICATE ABOVE BY CHECK MARK NATURE OF REPORT, NOTICE, OR OTHER DATA)

Well No. 1 is located 1523 ft. from 1304 line and 1019 ft. from E line of sec. 31
SE Sec. 31 27N 5W R.M.P.M.
(1/4 Sec. and Sec. No.) (Twp.) (Range) (Meridian)
So. Blanco P.C. Rio Arriba New Mexico
(Field) (County or Subdivision) (State or Territory)

The elevation of the derrick floor above sea level is 6605 ft.

DETAILS OF WORK

(State names of and expected depths to objective sands; show sizes, weights, and lengths of proposed casings; indicate mudding jobs, cementing points, and all other important proposed work)

This plat is released to show correct location from recent United States Cadastral Survey. This is a completed well.

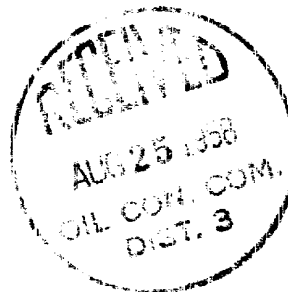

I understand that this plan of work must receive approval in writing by the Geological Survey before operations may be commenced.

Company El Paso Natural Gas Company
Address Box 977
Farmington, New Mexico
By Original Signed C. D. COX
Title Petroleum Engineer

NEW MEXICO OIL CONSERVATION COMMISSION

Well Location and Acreage Dedication Plat

Section A.

Date AUGUST 5, 1958

Operator EL PASO NATURAL GAS COMPANY Lease RINCON UNIT SF 079364
 Well No. 4 Unit Letter I Section 31 Township 27-N Range 6-W NMPM
 Located 1529 Feet From SOUTH Line 1019 Feet From EAST Line
 County RIO ARriba G. L. Elevation 6595 Dedicated Acreage 160 Acres
 Name of Producing Formation PICTURED CLIFF Pool SOUTH BLANCO PICTURED CLIFF

1. Is the Operator the only owner in the dedicated acreage outlined on the plat below?

Yes XX No2. If the answer to question one is "no", have the interests of all the owners been consolidated by communitization agreement or otherwise? Yes X No

If answer is "yes", Type of Consolidation.

Unit Operating Agreement

3. If the answer to question two is "no", list all the owners and their respective interests below:

Owner

Land Description

RECEIVED

AUG 22 1958

U. S. GEOLOGICAL SURVEY
FARMINGTON, NEW MEXICO

Section B.

Note: All distances must be from outer boundaries of section.

This is to certify that the information
in Section A above is true and complete
to the best of my knowledge and belief.

El Paso Natural Gas Company(Operator)
Original Signed **C. D. COX**

(Representative)

Box 997

(Address)

Farmington, New Mexico

NOTE: THIS PLAT IS REISSUED TO SHOW
CORRECT LOCATION FROM RECENT
UNITED STATES CADASTRAL SURVEY.
THIS IS A COMPLETED WELL.

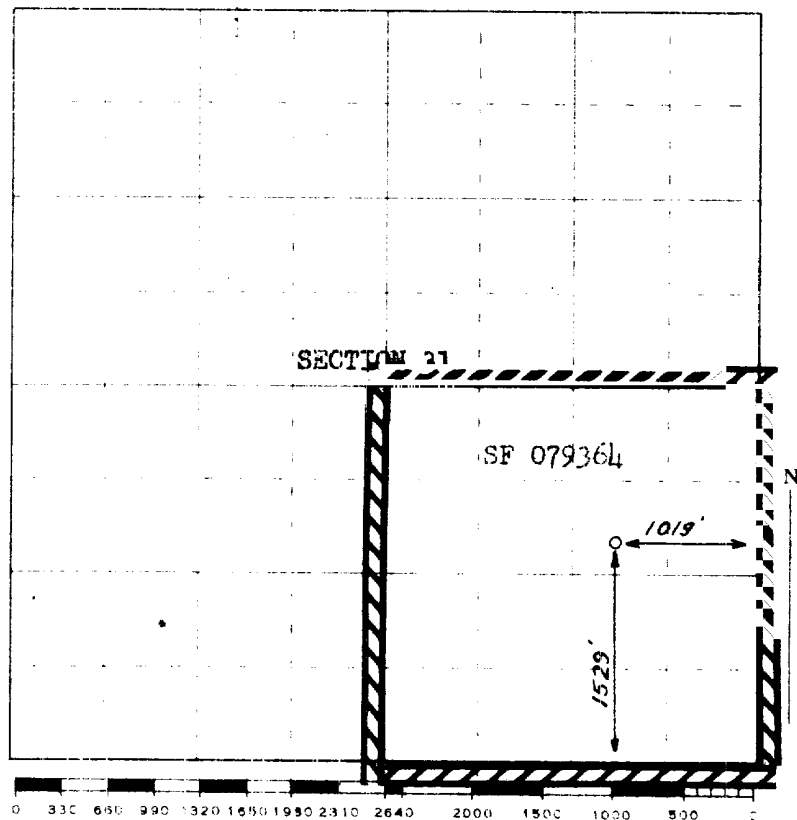

Scale 4 inches equal 1 mile

This is to certify that the above plat was prepared from field notes of actual surveys
made by me or under my supervision and that the same are true and correct to the best
of my knowledge and belief.

(Seal)

Farmington, New Mexico

Date Surveyed 1953

David O. Wilson
Registered Professional Engineer and/or Land Surveyor