



COPY TO O.C.G.

IN REPLY REFER TO:

UNITED STATES  
DEPARTMENT OF THE INTERIOR  
GEOLOGICAL SURVEY  
P. O. Box 965  
Farmington, New Mexico

June 20, 1956

El Paso Natural Gas Company  
Box 997  
Farmington, New Mexico

Re: Santa Fe 080213

Gentlemen:

Receipt is acknowledged of your "Notice of Intention to Drill" dated June 18, 1956 covering your well No. 72 Rincon Unit in SE $\frac{1}{4}$  sec. 33, T. 27 N., R. 7 W., N. M. P. M., Rio Arriba County, New Mexico, So. Blanco pool.

Your proposed work is hereby approved subject to compliance with the provisions of the "Oil and Gas Operating Regulations" revised May 25, 1942, a copy of which will be sent to you on request, and subject to the following conditions:

1. Drilling operations so authorized are subject to the attached sheet for general conditions of approval.
2. Furnish copies of all logs.

Very truly yours,

(Orig. Sgd.) P. T. McGRATH

P. T. McGrath  
District Engineer

PTMcGrath:ac



UNITED STATES  
DEPARTMENT OF THE INTERIOR  
GEOLOGICAL SURVEY



COPY TO O.C.G.

1914

1914

1914

1914

1914

1914

1914

1914

1914

1914

1914

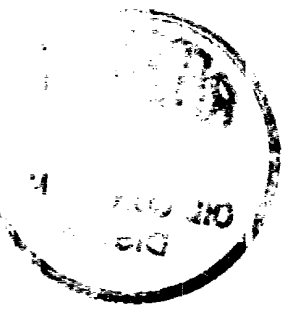

(SUBMIT IN TRIPLICATE)

UNITED STATES  
DEPARTMENT OF THE INTERIOR  
GEOLOGICAL SURVEY

Land Office Santa Fe  
Lease No. 050213  
Unit Rincon Unit

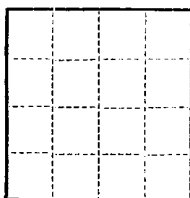

SUNDRY NOTICES AND REPORTS ON WELLS

|  |                                     |  |  |
|--|-------------------------------------|--|--|
| NOTICE OF INTENTION TO DRILL                   | <input checked="" type="checkbox"/> | SUBSEQUENT REPORT OF WATER SHUT-OFF        |  |
| NOTICE OF INTENTION TO CHANGE PLANS            |                                     | SUBSEQUENT REPORT OF SHOOTING OR ACIDIZING |  |
| NOTICE OF INTENTION TO TEST WATER SHUT-OFF     |                                     | SUBSEQUENT REPORT OF ALTERING CASING       |  |
| NOTICE OF INTENTION TO RE-DRILL OR REPAIR WELL |                                     | SUBSEQUENT REPORT OF RE-DRILLING OR REPAIR |  |
| NOTICE OF INTENTION TO SHOOT OR ACIDIZE        |                                     | SUBSEQUENT REPORT OF ABANDONMENT           |  |
| NOTICE OF INTENTION TO PULL OR ALTER CASING    |                                     | SUPPLEMENTARY WELL HISTORY                 |  |
| NOTICE OF INTENTION TO ABANDON WELL            |                                     |  |  |

(INDICATE ABOVE BY CHECK MARK NATURE OF REPORT, NOTICE, OR OTHER DATA)

June 18, 1956

Well No. 72 is located 990 ft. from S line and 550 ft. from E line of sec. 33  
SE Section 33 27N 7W 104N  
 (1/4 Sec. and Sec. No.) (Twp.) (Range) (Meridian)  
Co. Blando Rio Arriba New Mexico  
 (Field) (County or Subdivision) (State or Territory)

The elevation of the derrick floor above sea level is 6035 ft.

DETAILS OF WORK

(State names of and expected depths to objective sands; show sizes, weights, and lengths of proposed casings; indicate mudlogging jobs, cementing points, and all other important proposed work)

It is intended to drill a well thru the Pictured Cliff formation using rotary tools and to perforate and water fracture possible producing zones. Est. T.D. 2970'.

Casing Program:

9 5/8" at 120' with 125 sacks regular cement circulated to surface.  
 5 1/2" at 2970' with 75 sacks regular cement, 75 sacks Foamite

The SE/4 of section 33 is dedicated to this well.  
 SE/4, of 050213.

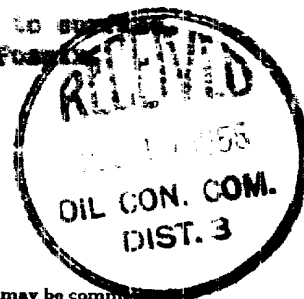

I understand that this plan of work must receive approval in writing by the Geological Survey before operations may be commenced.

Company El Paso Natural Gas Company

Address Box 997

Paria, Tex., New Mexico

By Emell Walsh

Title Petroleum Engineer



NEW MEXICO  
OIL CONSERVATION COMMISSION

Form O-128

WELL LOCATION AND/OR GAS PRODUCTION PLAT

DATE APRIL 24, 1956

OPERATOR EL PASO NATURAL GAS COMPANY LEASE RINCON UNIT SF 080213

WELL NO. 72 SECTION 33 TOWNSHIP 27-N RANGE 7-N NMNM

SECTION 990 FEET FROM SOUTH LINE 850 FEET FROM EAST LINE

RIO ARriba COUNTY, NEW MEXICO CITY ELEVATION 6638

FORMERLY DESIGNATED FORMATION PICTURED CLIFF SO. BLANCO DEDICATED ACREAGE 160  
(1882 PLAT)

Note: All distances must be from outer boundaries of section.

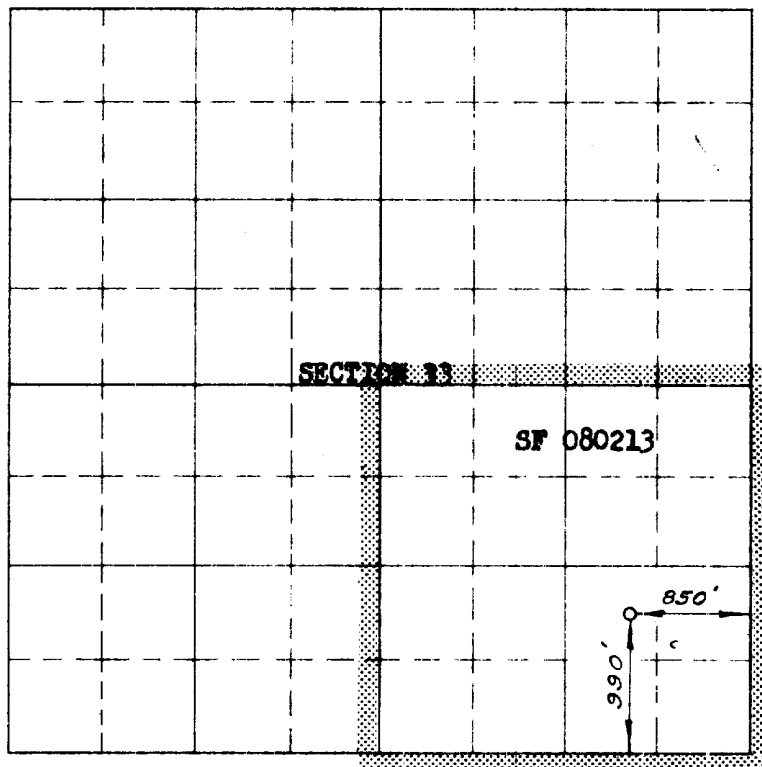

Scale 1 inch equals 1 mile



NOTE: This section of form is to be used for gas wells only

This is to certify that the above plat was prepared from field notes of actual surveys made by me or under my supervision and that the same are true and correct to the best of my knowledge and belief.

Date Surveyed APRIL 18, 1956

C. O. Walker  
Registered Professional Engineer and Oil Land Surveyor

1. Is this well a Dual Comp.  
Yes \_\_\_\_\_ No X
2. If the answer to Question 1 is yes, are there any other dually completed wells within the dedicated acreage.  
Yes \_\_\_\_\_ No \_\_\_\_\_

Name Twelth H. Walker  
Position Petroleum Engineer  
Representing El Paso Natural Gas Co.  
Address Box 997, Farmington, N.M.

(Seal)

Farmington, New Mexico