



COPY TO O. C. G.

UNITED STATES
DEPARTMENT OF THE INTERIOR
GEOLOGICAL SURVEY
P. O. Box 965
Farmington, New Mexico

June 20, 1956

El Paso Natural Gas Company
Box 997
Farmington, New Mexico

Re: Santa Fe 080385

Gentlemen:

Receipt is acknowledged of your "Notice of Intention to Drill" dated June 18, 1956 covering your well No. 77 Rincon Unit in SE $\frac{1}{4}$ sec. 34, T. 27 N., R. 7 W., N. M. P. M., Rio Arriba County, New Mexico, So. Blanco pool.

Your proposed work is hereby approved subject to compliance with the provisions of the "Oil and Gas Operating Regulations" revised May 25, 1942, a copy of which will be sent to you on request, and subject to the following conditions:

1. Drilling operations so authorized are subject to the attached sheet for general conditions of approval.
2. Furnish copies of all logs.

Very truly yours,

(Orig. Sgd.) P. T. McGrath

P. T. McGrath
District Engineer

PTMcGrath:ac

ILLEGIBLE

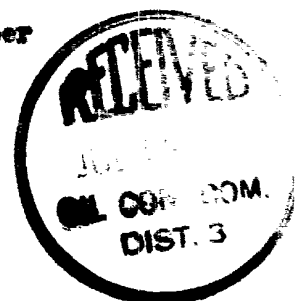

UNITED STATES
DEPARTMENT OF THE INTERIOR
GEOLOGICAL SURVEY



1. *Chlorophyll a* (Chl *a*) is the primary photosynthetic pigment in most plants and algae. It is a green pigment that absorbs light energy in the blue and red regions of the visible spectrum.

Figure 1. The effect of the concentration of the *Agrobacterium* suspension on the transformation efficiency of *Agrobacterium* strains.

Figure 1. The effect of the concentration of the *Agrobacterium* suspension on the transformation efficiency of *Agrobacterium* strains.

101019, 2001, P. T. McGRAITH

[illegible]

1997, 1998, 1999, 2000, 2001, 2002, 2003, 2004, 2005, 2006, 2007, 2008, 2009, 2010, 2011, 2012, 2013, 2014, 2015, 2016, 2017, 2018, 2019, 2020, 2021, 2022, 2023, 2024, 2025, 2026, 2027, 2028, 2029, 2030, 2031, 2032, 2033, 2034, 2035, 2036, 2037, 2038, 2039, 2040, 2041, 2042, 2043, 2044, 2045, 2046, 2047, 2048, 2049, 2050, 2051, 2052, 2053, 2054, 2055, 2056, 2057, 2058, 2059, 2060, 2061, 2062, 2063, 2064, 2065, 2066, 2067, 2068, 2069, 2070, 2071, 2072, 2073, 2074, 2075, 2076, 2077, 2078, 2079, 2080, 2081, 2082, 2083, 2084, 2085, 2086, 2087, 2088, 2089, 2090, 2091, 2092, 2093, 2094, 2095, 2096, 2097, 2098, 2099, 2100, 2101, 2102, 2103, 2104, 2105, 2106, 2107, 2108, 2109, 2110, 2111, 2112, 2113, 2114, 2115, 2116, 2117, 2118, 2119, 2120, 2121, 2122, 2123, 2124, 2125, 2126, 2127, 2128, 2129, 2130, 2131, 2132, 2133, 2134, 2135, 2136, 2137, 2138, 2139, 2140, 2141, 2142, 2143, 2144, 2145, 2146, 2147, 2148, 2149, 2150, 2151, 2152, 2153, 2154, 2155, 2156, 2157, 2158, 2159, 2160, 2161, 2162, 2163, 2164, 2165, 2166, 2167, 2168, 2169, 2170, 2171, 2172, 2173, 2174, 2175, 2176, 2177, 2178, 2179, 2180, 2181, 2182, 2183, 2184, 2185, 2186, 2187, 2188, 2189, 2190, 2191, 2192, 2193, 2194, 2195, 2196, 2197, 2198, 2199, 2200, 2201, 2202, 2203, 2204, 2205, 2206, 2207, 2208, 2209, 2210, 2211, 2212, 2213, 2214, 2215, 2216, 2217, 2218, 2219, 2220, 2221, 2222, 2223, 2224, 2225, 2226, 2227, 2228, 2229, 2230, 2231, 2232, 2233, 2234, 2235, 2236, 2237, 2238, 2239, 2240, 2241, 2242, 2243, 2244, 2245, 2246, 2247, 2248, 2249, 2250, 2251, 2252, 2253, 2254, 2255, 2256, 2257, 2258, 2259, 2260, 2261, 2262, 2263, 2264, 2265, 2266, 2267, 2268, 2269, 2270, 2271, 2272, 2273, 2274, 2275, 2276, 2277, 2278, 2279, 2280, 2281, 2282, 2283, 2284, 2285, 2286, 2287, 2288, 2289, 2290, 2291, 2292, 2293, 2294, 2295, 2296, 2297, 2298, 2299, 2300, 2301, 2302, 2303, 2304, 2305, 2306, 2307, 2308, 2309, 2310, 2311, 2312, 2313, 2314, 2315, 2316, 2317, 2318, 2319, 2320, 2321, 2322, 2323, 2324, 2325, 2326, 2327, 2328, 2329, 2330, 2331, 2332, 2333, 2334, 2335, 2336, 2337, 2338, 2339, 2340, 2341, 2342, 2343, 2344, 2345, 2346, 2347, 2348, 2349, 2350, 2351, 2352, 2353, 2354, 2355, 2356, 2357, 2358, 2359, 2360, 2361, 2362, 2363, 2364, 2365, 2366, 2367, 2368, 2369, 2370, 2371, 2372, 2373, 2374, 2375, 2376, 2377, 2378, 2379, 2380, 2381, 2382, 2383, 2384, 2385, 2386, 2387, 2388, 2389, 2390, 2391, 2392, 2393, 2394, 2395, 2396, 2397, 2398, 2399, 2400, 2401, 2402, 2403, 2404, 2405, 2406, 2407, 2408, 2409, 2410, 2411, 2412, 2413, 2414, 2415, 2416, 2417, 2418, 2419, 2420, 2421, 2422, 2423, 2424, 2425, 2426, 2427, 2428, 2429, 2430, 2431, 2432, 2433, 2434, 2435, 2436, 2437, 2438, 2439, 2440, 2441, 2442, 2443, 2444, 2445, 2446, 2447, 2448, 2449, 2450, 2451, 2452, 2453, 2454, 2455, 2456, 2457, 2458, 2459, 2460, 2461, 2462, 2463, 2464, 2465, 2466, 2467, 2468, 2469, 2470, 2471, 2472, 2473, 2474, 2475, 2476, 2477, 2478, 2479, 2480, 2481, 2482, 2483, 2484, 2485, 2486, 2487, 2488, 2489, 2490, 2491, 2492, 2493, 2494, 2495, 2496, 2497, 2498, 2499, 2500, 2501, 2502, 2503, 2504, 2505, 2506, 2507, 2508, 2509, 2510, 2511, 2512, 2513, 2514, 2515, 2516, 2517, 2518, 2519, 2520, 2521, 2522, 2523, 2524, 2525, 2526, 2527, 2528, 2529, 2530, 2531, 2532, 2533, 2534, 2535, 2536, 2537, 2538, 2539, 2540, 2541, 2542, 2543, 2544, 2545, 2546, 2547, 2548, 2549, 2550, 2551, 2552, 2553, 2554, 2555, 2556, 2557, 2558, 2559, 2560, 2561, 2562, 2563, 2564, 2565, 2566, 2567, 2568, 2569, 2570, 2571, 2572, 2573, 2574, 2575, 2576, 2577, 2578, 2579, 2580, 2581, 2582, 2583, 2584, 2585, 2586, 2587, 2588, 2589, 2590, 2591, 2592, 2593, 2594, 2595, 2596, 2597, 2598, 2599, 2600, 2601, 2602, 2603, 2604, 2605, 2606, 2607, 2608, 2609, 2610, 2611, 2612, 2613, 2614, 2615, 2616, 2617, 2618, 2619, 2620, 2621, 2622, 2623, 2624, 2625, 2626, 2627, 2628, 2629, 2630, 2631, 2632, 2633, 2634, 2635, 2636, 2637, 2638, 2639, 2640, 2641, 2642, 2643, 2644, 2645, 2646, 2647, 2648, 2649, 2650, 2651, 2652, 2653, 2654, 2655, 2656, 2657, 2658, 2659, 2660, 2661, 2662, 2663, 2664, 2665, 2666, 2667, 2668, 2669, 2670, 2671, 2672, 2673, 2674, 2675, 2676, 2677, 2678, 26

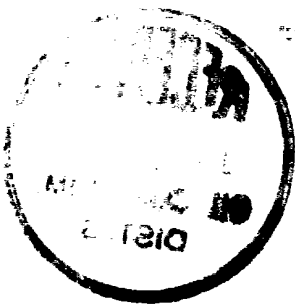

(SUBMIT IN TRIPLICATE)

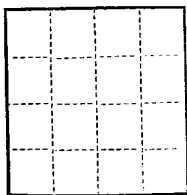
UNITED STATES
DEPARTMENT OF THE INTERIOR
GEOLOGICAL SURVEYLand Office Santa Fe
Lease No. 050305
Unit Rio Arriba Unit

SUNDRY NOTICES AND REPORTS ON WELLS

| | | | |
|---|-------------------------------------|---|--|
| NOTICE OF INTENTION TO DRILL..... | <input checked="" type="checkbox"/> | SUBSEQUENT REPORT OF WATER SHUT-OFF..... | |
| NOTICE OF INTENTION TO CHANGE PLANS..... | | SUBSEQUENT REPORT OF SHOOTING OR ACIDIZING..... | |
| NOTICE OF INTENTION TO TEST WATER SHUT-OFF..... | | SUBSEQUENT REPORT OF ALTERING CASING..... | |
| NOTICE OF INTENTION TO RE-DRILL OR REPAIR WELL..... | | SUBSEQUENT REPORT OF RE-DRILLING OR REPAIR..... | |
| NOTICE OF INTENTION TO SHOOT OR ACIDIZE..... | | SUBSEQUENT REPORT OF ABANDONMENT..... | |
| NOTICE OF INTENTION TO PULL OR ALTER CASING..... | | SUPPLEMENTARY WELL HISTORY..... | |
| NOTICE OF INTENTION TO ABANDON WELL..... | | | |

(INDICATE ABOVE BY CHECK MARK NATURE OF REPORT, NOTICE, OR OTHER DATA)

June 16, 1951

Well No. 77 is located 990 ft. from N line and 990 ft. from E line of sec. 34
SE Section 34 27E T4 R4E
 (1/4 Sec. and Sec. No.) (Twp.) (Range) (Meridian)
So. Blanco Rio Arriba New Mexico
 (Field) (County or Subdivision) (State or Territory)

The elevation of the derrick floor above sea level is 6631 ft.

DETAILS OF WORK

(State names of and expected depths to objective sands; show sizes, weights, and lengths of proposed casings; indicate mudding jobs, cementing points, and all other important proposed work)

It is intended to drill a well thru the Pictured Cliff formation using rotary tools and to perforate and water fracture possible producing zones. Estimated T.D. 2985'.

Casing Program:

5 5/8" at 120' with 125 sacks regular cement circulated to surface.
 5 1/2" at 2985' with 75 sacks regular cement, 75 sacks Puzos.

The SE 1/4 of Section 34 is dedicated to this well.
 SE 1/4, T4E, R4E, S34.

ILLEGIBLE

I understand that this plan of work must receive approval in writing by the Geological Survey before operations may be commenced.

Company Paco Natural Gas CompanyAddress Box 771Burlington, New MexicoBy Will W. [Signature]

Petroleum Engineer

Title

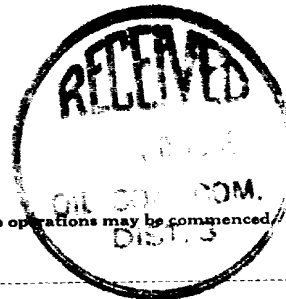

NEW MEXICO
OIL CONSERVATION COMMISSION

Form O-128

WELL LOCATION AND/OR GAS PRORATION PLAT

DATE APRIL 24, 1956

OPERATOR EL PASO NATURAL GAS COMPANY RINCON UNIT SF 080385

SECTION 77 TOWNSHIP 34 RANGE 27-N RANGE 7-W

DISTANCE 990 FEET FROM SOUTH DISTANCE 990 FEET FROM EAST

RIO ARRIBA COUNTY, NEW MEXICO DISTANCE 6621

NAME OF WELL PICTURED CLIFF SO. BLANCO 160

(1882 PLAT)

Note: All distances must be from outer boundaries of section.

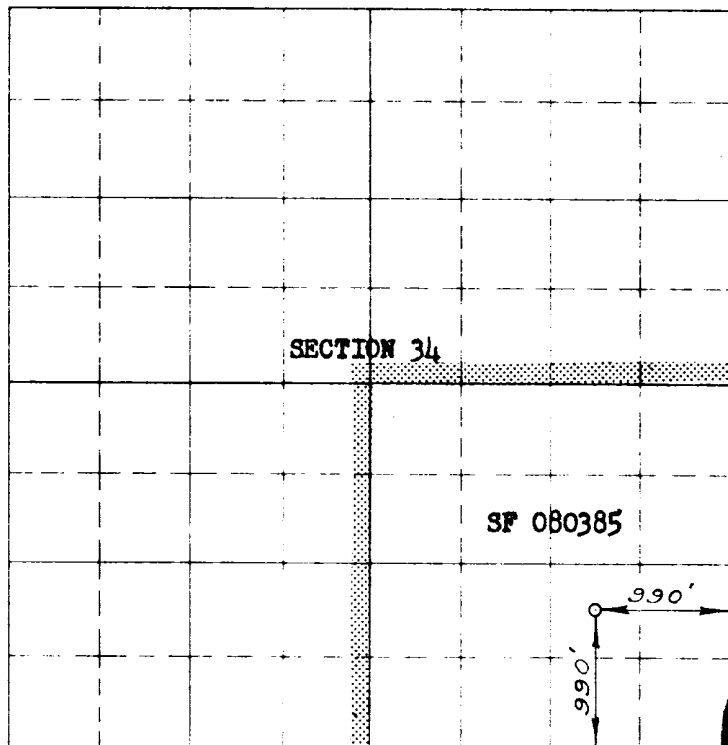

Scale: 1 inch = 1 mile

NOTE

This section of
form is to be used
for gas wells only

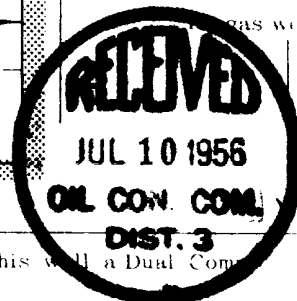

This is to certify that the above plat was prepared from
field notes of actual surveys made by me or under my
supervision and that the same are true and correct to the
best of my knowledge and belief.

Date Surveyed APRIL 18, 1956

E. O. Walker
Registered Professional Engineer and ~~Oil~~ Land Surveyor

1. Is this well a Dual Completion?
Yes _____

2. If the answer to Question 1
is yes, are there any other duals
completed wells within the
dedicated acreage.
Yes _____

Name W. M. Walker

Position Petroleum Engineer

Representing El Paso Natural Gas Co.

Address Box 997, Farmington, N.M.

(Seal)

Farmington, New Mexico

EL PASO NATURAL GAS COMPANY
OPEN FLOW TEST DATA

DATE January 9, 1957

| | |
|--|--|
| Operator El Paso Natural Gas Company | Lessee Rincon Unit # 77 |
| Location 990'S, 990'E, Sec. 34-27-7 | County Rio Arriba State New Mexico |
| Formation Pictured Cliff | Pool South Blanco |
| Casing Diameter 5$\frac{1}{2}$ Set At Feet 3000 | Tubing Diameter 1$\frac{1}{4}$ Set At Feet 2943 |
| Pay Zone Feet 2898 | Total Depth 2996 - c/o - 2960' |
| Stimulation Method Sand Water Frac | Flow Through Casing X Flow Through Tubing |

| | |
|---|---------------------------------------|
| FC-PSI x 10 ⁴ .750 | Stroke Constant 14.1605 |
| Shut-In Pressure 818 | Shut-In Pressure Tubing 818 |
| Flowing Pressure 118 | Working Pressure 158 |
| Temperature 55 | Gravity .640 |
| PSIA 830 | PSIA 830 |
| PSIA 130 | PSIA 170 |
| Flow From Tables 1.011 | |

GROSS VOLUME = $Q \times A \times F \times F_g \times F_v$

$$= 14.1605 \times 130 \times 1.0048 \times .9682 \times 1.011$$

1811

MCF D



| | | |
|---------------|----------|-----|
| 688,906 | (1.0437) | .85 |
| 660,000 | | |
| 1878 | | |
| K. C. McBride | | |

Making spray of water last 30 minutes of test and possibly loading, shown by high working pressure.

L. D. Galloway
L. D. Galloway

OIL CONSERVATION COMMISSION

AZTEC DISTRICT OFFICE

No. Copies Received 2

DISTRIBUTION

| | NO. FURNISHED | |
|-------------------|------------------|---|
| Operator | | |
| Santa Fe | 1 | |
| Proration Office | | |
| State Land Office | | |
| U. S. G. S. | 1 | |
| Transporter | | |
| File | 1 | ✓ |
| | | |