

NEW MEXICO OIL CONSERVATION COMMISSION

Well Location and Acreage Dedication Plat

Section A.

Date Aug 12, 1957

Operator MAGNOLIA PETROLEUM COMPANY Lease JICARILLA "B"
Well No. 3 Unit Letter Section 35 Township 27N Range 18E NMPM
Located 990 Feet From Section Line, 990 Feet From West Line
County Blanco G. L. Elevation 4100 Dedicated Acreage 200 Acres
Name of Producing Formation Mesa Verde Pool Extension of Blk. 3

1. Is the Operator the only owner* in the dedicated acreage outlined on the plat below?
Yes X No .
2. If the answer to question one is "no," have the interests of all the owners been consolidated by communitization agreement or otherwise? Yes No . If answer is "yes," Type of Consolidation
3. If the answer to question two is "no," list all the owners and their respective interests below:

Owner

Land Description

Section B.

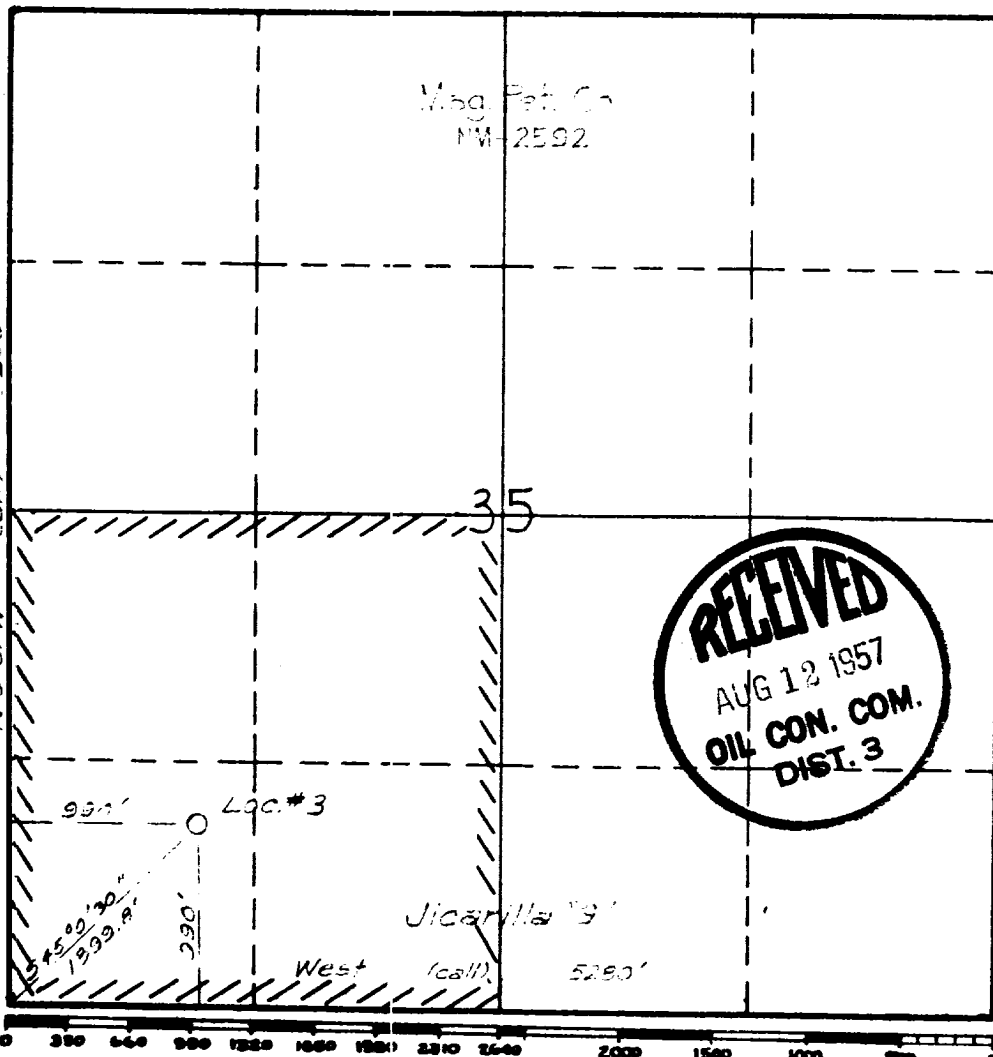

This is to certify that the information in Section A above is true and complete to the best of my knowledge and belief.

Magnolia Petroleum Company

(Operator)

W. D. Hughes
(Representative)

Box 2496, Hobbs, New Mexico
Address

This is to certify that the well location shown on the plat in Section B was plotted from field notes of actual surveys made by me or under my supervision and that the same is true and correct to the best of my knowledge and belief.

Date Surveyed March 12, 1957

Carl E. Turner

Registered Professional
Engineer and/or Land Surveyor.

Certificate No. 2496

OIL CONSERVATION COMMISSION**AZTEC DISTRICT OFFICE**No. Copies Received 5**DISTRIBUTION**

	NO. FURNISHED	
Operator	<u>2</u>	
Santa Fe	<u>1</u>	
Proration Office		
State Land Office		
U. S. G. S.	<u>1</u>	
Transporter		
File	<u>1</u>	✓