

UNITED STATES  
DEPARTMENT OF THE INTERIOR  
BUREAU OF LAND MANAGEMENT

## Sundry Notices and Reports on Wells

1. Type of Well  
GAS

2. Name of Operator  
Meridian Oil Inc.

3. Address & Phone No. of Operator  
PO Box 4289, Farmington, NM 87499 (505) 326-9700

4. Location of Well, Footage, Sec., T, R, M  
1450' FSL, 790' FWL Sec. 34, T-27-N, R-6-W, NMPM

5. Lease Number  
SF-079210  
6. If Indian, Allot or  
Tribe Name  
7. Unit Agreement Name

8. Well Name & Number  
Reuter #2 7419  
9. API Well No.

10. Field and Pool  
Tocito/Basin Dk 71599  
11. County and State  
San Juan Co, NM

## 12. CHECK APPROPRIATE BOX TO INDICATE NATURE OF NOTICE, REPORT, OTHER DATA

## Type of Submission

☒ Notice of Intent☐ Subsequent Report☐ Final Abandonment

## Type of Action

☐ Abandonment☐ Recompletion☐ Plugging Back☐ Casing Repair☐ Altering Casing☒ Other - Complete Tocito/Commingled w/Dakota☐ Change of Plans☐ New Construction☐ Non-Routine Fracturing☐ Water Shut off☐ Conversion to Injection

## 13. Describe Proposed or Completed Operations

Meridian intends to add the Tocito sandstone of the Gallup interval to the subject wellbore. The resulting production will be commingled with the existing Dakota.

New Mexico Oil Conservation Division administrative approval of the downhole commingling and non-standard location applications are pending.

The Tocito will be completed per the attached procedure and wellbore schematic.

## 14. I hereby certify that the foregoing is true and correct.

Signed [Signature] (DB) Title Regulatory Affairs Date 1/27/93

(This space for Federal or State Office use)

APPROVED BY \_\_\_\_\_ Title \_\_\_\_\_

CONDITION OF APPROVAL, if any:

4020 5-104 Hm casing SURFACE CASING REQUIREMENTS  
NS&DHC E

NMOCD

APPROVED

Date

FEB 01, 1993

AREA MANAGER

**Reuter #2  
Tocito Completion  
Procedure**

**PROCEDURE:**

Prior to move on set rig anchors. Construct reserve and blow pit.  
Notify Farmington BLM (326-6201) 24 hours prior to commencing operations.  
Comply with all MOI, federal and state regulations.

1. Prior to move on, set 2 3/8" tubing choke at +/-7415'.
2. MOL & RU. RU 2 7/8" 2M choke manifold, production separator, and one 400 bbl frac tank for flowback. ND wellhead and NU 7 1/16" 3M BOP, stripping head and blooie line. Test BOP to insure proper functioning.
3. Tag PBTD at 7470'. Note top of fill (if fill above bottom perforation at 7450', make a clean out run to PBTD prior to setting bridge plug to isolate Dakota). TOH with 254 joints of 2 3/8" 4.7# J-55 8rd EUE tubing. Retrieve 2 3/8" tubing choke.
4. PU 4 1/2" 11.6# casing scraper. TIH with scraper on 2 3/8" tubing to +/-7200'. TOH.
5. TIH with 4 1/2" 11.6# top-drillable bridge plug on wireline. Set bridge plug at +/-7150' (88' above top Dakota perf @ 7238').
6. Load hole with 2% KCl, +/-114 bbls. Run CBL/GR/CCL.
7. Pressure test casing and bridge plug to 2000 psi.
8. Perforate two 0.5" squeeze holes at +/-6825'. RU on casing and establish injection rate and pressure into squeeze holes. Do not exceed 1500 psi. Perforate two 0.5" squeeze holes at +/-6650'.
9. PU 4 1/2" 11.6# cement retainer. TIH with retainer to +/-6800' and set. Pressure test tubing to 1500 psi.
10. With pipe rams open, establish circulation down tubing. Squeeze with 50 sx cement. Displace cement to top of retainer. **Do not overdisplace cement or exceed 500 psi during pumping operations.** Sting out of retainer and TOH with tubing.
11. WOC a minimum of four (4) hours. PU 3 7/8" bit and 4 1/2" 11.6# casing scraper. TIH with bit and scraper on 2 3/8" tubing. Clean out to top of retainer at +/-6800'. Close pipe rams and pressure test casing to 1500 psi. TOH with bit and scraper.
12. Once casing holds 1500 psi, RU wireline. TIH with dump bailer. Spot 16 gal 10% MSA acid across perforation interval from 6764'-6776'. TOH with dump bailer.
13. Perforate as follows:

<u>Interval</u>	<u>Feet</u>	<u>SPF</u>	<u>Holes</u>
6764'-6776'	12	4	48
<b>Total:</b>	<b>12</b>		<b>48</b>

\* Perfs will be adjusted to cased-hole GR as needed.

14. PU 4 1/2" retrievable packer. TIH with packer on 2 7/8" 9.2# N-80 buttress frac string with turned-down couplings to 6725'. Set packer. Land blanking plug in seating nipple. Pressure up annulus to 500 psi and hold. Pressure test tubing to 7000 psi for a minimum of 15 minutes. Bleed off pressure and retrieve blanking plug.
15. RU Halliburton to frac down 2 7/8" tubing. Pressure test surface lines to 8000 psi (1000 psi over maximum treating pressure) prior to proceeding with stimulation. **Frac during daylight hours only.**
16. Unseat packer. Spot 20 bbl 10% MSA acid to bottom of packer. Displace acid with 30# linear gel. Set packer and breakdown perforations with +/-30 bbls 30# linear gel. **Maximum treating pressure is 7000 psi.**

**Reuter #2  
Tocito Completion  
Procedure**

17. Fracture stimulate in 0.5 to 3.0 ppg stages with 49,600 gal of 70Q CO2 foamed 30# linear gel in 2% KCl and 70,500# 20/40 mesh Brown sand. **Maximum treating pressure is 7000 psi.**
18. Immediately upon completion of stimulation, open well to pit for 20 minutes. After 20 minute flow, shut-in well to allow gels to break.
19. After shut-in, open well to pit on positive choke. If well produces oil, turn production into separator and tank.
20. Once flow and pressure permits, release packer and TOH with 2 7/8" frac string.
21. PU 3 7/8" bit. TIH with on 2 3/8" tubing. Clean out to the top of the cement retainer at 6800'.
22. Drill out retainer and cement. Clean out to the top of the bridge plug at 7050'.
23. Drill off top slips of bridge plug at 7050'. Chase bottom of bridge plug below bottom Dakota perforation at 7450'. TOH with bit.
24. TIH with expendable check on bottom and seating nipple one joint up on 2 3/8" production string. Land tubing at +/-7400'. ND BOP and NU wellhead. Pump off check.
25. Release rig and move off.
26. RU wireline with mast truck. Run after-frac GR from 6900' - 6600' through tubing. RD wireline.

Reuter #2  
 Basin Dakota  
 NW/SW/4 Sec.34, T27N, R06W  
 Wellbore Schematic

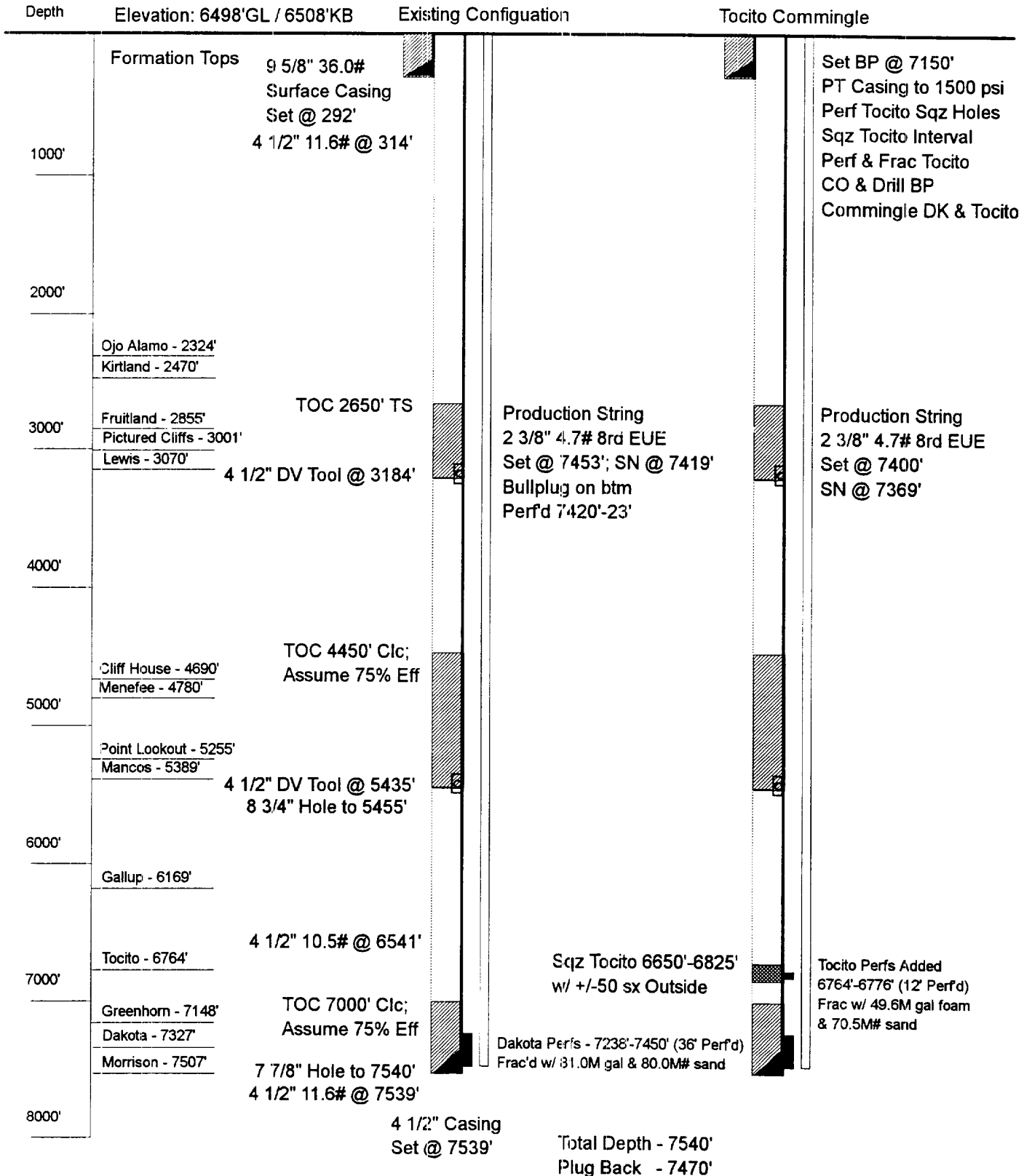

SEE INSTRUCTIONS  
Survey Office  
State Lease - 4 copies  
Fee Lease - 3 copies

State of New Mexico  
Energy, Minerals and Natural Resources Department

Form C-102  
Revised 1-1-89

OIL CONSERVATION DIVISION

P.O. Box 2088

Santa Fe, New Mexico 87504-2088

DISTRICT I  
P.O. Box 1980, Hobbs, NM 88240

DISTRICT II  
P.O. Drawer DD, Arama, NM 88210

DISTRICT III  
1000 Rio Arriba Rd., Alamogordo, NM 87410

WELL LOCATION AND ACREAGE DEDICATION PLAT

All Distances must be from the outer boundaries of the section

Operator Meridian Oil Inc.		Lease Reuter		Well No. 2	
U.S. Letter L	Section 34	Township 27 North	Range 6 West	County Rio Arriba	
Actual Footage Location of Well: 1450 feet from the South line and 790 feet from the West line					
Current Level Elev. 6498'		Producing Formation Tocito/Dakota		Foot S. Blanco/Basin	
				Dedication Acquire 80/320 Acres	

1. Outline the acreage dedicated to the subject well by enclosed parcel or sections shown on the plat below.

2. If more than one lease is dedicated to the well, outline each and identify the ownership thereof (both as to working interest and royalty).

3. If more than one lease of different ownership is dedicated to the well, have the names of all owners been established by communication, lease-pooling, etc.?

☐ Yes ☐ No If answer is "yes" type of communication

If answer is "no" list the owners and tract descriptions which have actually been established. (Use reverse side of this form if necessary.)

No acreage will be assigned to the well until all owners have been established (by communication, lease-pooling, or otherwise) or until a non-standard tract, establishing such interest, has been approved by the Division.

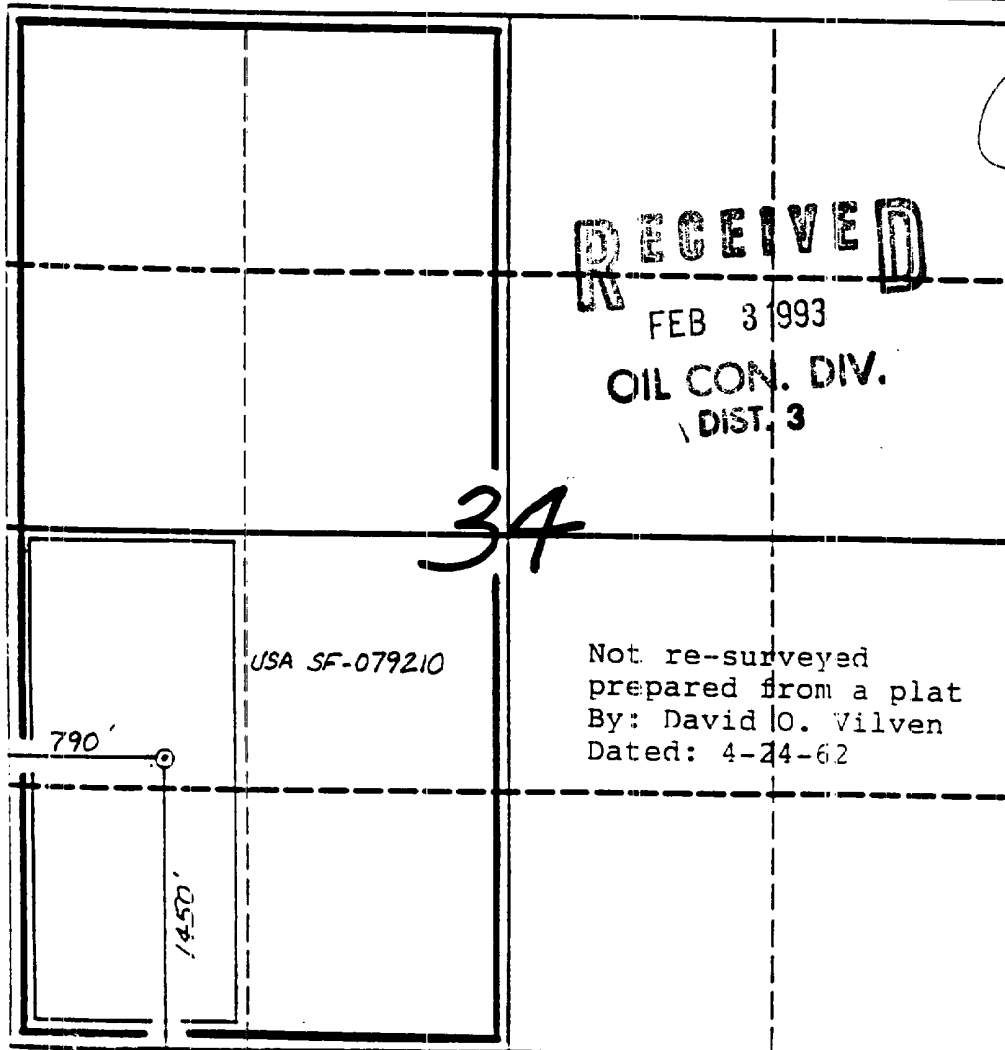

OPERATOR CERTIFICATION

I hereby certify that the information contained herein is true and complete to the best of my knowledge and belief.

Signature  
Peggy Bradfield

Printed Name  
Regulatory Affairs

Position  
Meridian Oil Inc.

Company  
1-22-93

Date

SURVEYOR CERTIFICATION

I hereby certify that the well location shown on this plat was plotted from field notes of actual surveys made by me or under my supervision, and that the same is true and correct to the best of my knowledge and belief.

1-25-93

Date Surveyed  
Needle C. Edwards

Signature of State  
Professional Surveyor

19857

Professional Surveyor

Signature No.

6857