

NEW MEXICO OIL CONSERVATION COMMISSION

Santa Fe, New Mexico

Form G-101
Revised (12/1/55)

NOTICE OF INTENTION TO DRILL

Notice must be given to the District Office of the Oil Conservation Commission and approval obtained before drilling or recompletion begins. If changes in the proposed plan are considered advisable, a copy of this notice showing such changes will be returned to the sender. Submit this notice in QUINTUPLICATE. One copy will be returned following approval. See additional instructions in Rules and Regulations of the Commission. If State Land submit 6 Copies Attach Form G-128 in triplicate to first 3 copies of form G-101

Farmington, New Mexico

(Place)

November 6, 1959

(Date)

OIL CONSERVATION COMMISSION
SANTA FE, NEW MEXICO

Gentlemen:

You are hereby notified that it is our intention to commence the Drilling of a well to be known as

El Paso Natural Gas Company

(Company or Operator)

Johnston State

(Lease)

Well No. 9 (EM), in L The well is

(Unit)

located 1500 feet from the South line and 850 feet from the

West line of Section 36, T. 27N, R. 6W, NMPM.

(GIVE LOCATION FROM SECTION LINE) Blanco MV. & So. Blanco PC Pool, Rio Arriba County

If State Land the Oil and Gas Lease is No. E-290-3

If patented land the owner is

Address

We propose to drill well with drilling equipment as follows: Rotary tools, using gas circulation to drill from Lewis thru the Mesa Verde formation.

The status of plugging bond is Statewide

Drilling Contractor

We intend to complete this well in the Pictured Cliffs & Mesa Verde formation formation at an approximate depth of 5700 feet.

CASING PROGRAM

We propose to use the following strings of Casing and to cement them as indicated:

Size of Hole	Size of Casing	Weight per Foot	New or Second Hand	Depth	Sacks Cement
15"	10 3/4"	32.75	New	170	125
9 7/8"	7 5/8"	26.4	New	3460	250
6 3/4"	5 1/2"	15.5	New	5700'	300

If changes in the above plans become advisable we will notify you immediately.

ADDITIONAL INFORMATION (If recompletion give full details of proposed plan of work.) Possible productive zones in the Mesa Verde and Pictured Cliffs formations will be perforated and produced. The W/2 of Section 36 is dedicated to the Mesa Verde formation. The SW/4 of Section 36 is dedicated to the Pictured Cliffs formation.

NOV 9 1959

Approved, 19
Except as follows:

Sincerely yours,

El Paso Natural Gas Company

(Company or Operator)

ORIGINAL SIGNED J.J. TILLERSON

By

Position Petroleum Engineer

Send Communications regarding well to

Name E. S. Oberly

Address Box 997, Farmington, New Mexico

OIL CONSERVATION COMMISSION

By

Well Location and Acreage Dedication Plat

Section A.

Date **NOVEMBER 4, 1959**Operator **EL PASO NATURAL GAS COMPANY**Lease **JOHNSTON STATE****E-290-3**Well No. **9(PM)** Unit Letter **L** Section **36**Township **27-N** Range **6-W** NMPMLocated **1500** Feet From **SOUTH** Line **850**Feet From **WEST** LineCounty **RIO ARriba** G. L. Elevation **6715**Dedicated Acreage **320 & 160** AcresName of Producing Formation **MESA VERDE & PICTURED CLIFF** Pool **BLANCO MESA VERDE, SO. BLANCO PC**

1. Is the Operator the only owner in the dedicated acreage outlined on the plat below?

Yes ☐ No ☒2. If the answer to question one is "no", have the interests of all the owners been consolidated by communitization agreement or otherwise? Yes ☒ No ☐ If answer is "yes", Type of Consolidation.**Communitization Agreement.**

3. If the answer to question two is "no", list all the owners and their respective interests below:

Owner

Land Description

Section B.

This is to certify that the information in Section A above is true and complete to the best of my knowledge and belief.

El Paso Natural Gas Company

(Operator)

ORIGINAL SIGNED J.J. TILLERSON

(Representative)

Box 997

(Address)

Farmington, New Mexico

**NOTE: THIS PLAT IS RE-ISSUED TO SHOW
PICTURED CLIFF DEDICATION
11 8 89**

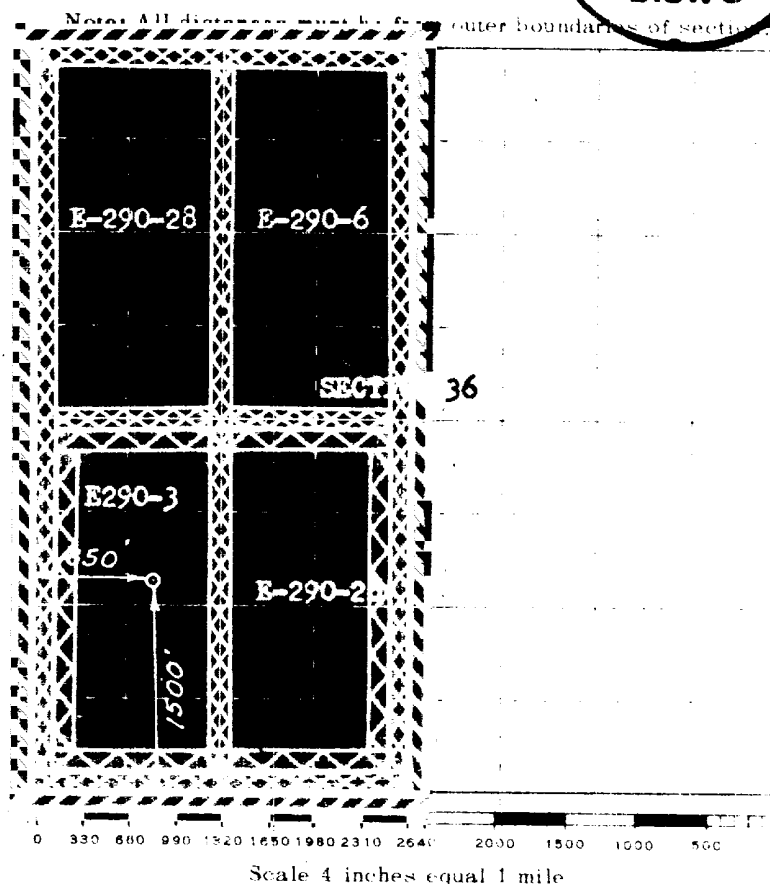

This is to certify that the above plat was prepared from field notes of actual surveys made by me or under my supervision and that the same are true and correct to the best of my knowledge and belief.

(Seal)

Farmington, New Mexico

Date Surveyed **NOVEMBER 10, 1958**

David O. Tillen
Registered Professional Engineer and/or Land Surveyor