

NEW MEXICO OIL CONSERVATION COMMISSION  
WELL LOCATION AND ACREAGE DEDICATION PLAT

Form C-102  
Supersedes C-128  
Effective 1-1-65

All distances must be from the outer boundaries of the Section.

Operator EL PASO NATURAL GAS COMPANY		Lease RINCON UNIT (SF 079364)		Well No. 50
Unit Letter L	Section 31	Township 27-N	Range 6-W	County RIO ARriba
Actual Footage Location of Well: 650 feet from the S line and 990 feet from the W line				
Ground Level Elev. 6650 DF	Producing Formation PICTURED CLIFFS	Pool SO. BLANCO PC	Dedicated Acreage: 172.35 Acres	

1. Outline the acreage dedicated to the subject well by colored pencil or hachure marks on the plat below.
2. If more than one lease is dedicated to the well, outline each and identify the ownership thereof (both as to working interest and royalty).
3. If more than one lease of different ownership is dedicated to the well, have the interests of all owners been consolidated by communitization, unitization, force-pooling, etc?

☒ Yes ☐ No If answer is "yes," type of consolidation Unitization

If answer is "no," list the owners and tract descriptions which have actually been consolidated. (Use reverse side of this form if necessary.)

No allowable will be assigned to the well until all interests have been consolidated (by communitization, unitization, forced-pooling, or otherwise) or until a non-standard unit, eliminating such interests, has been approved by the Commission. THIS PLAT REISSUED TO SHOW CORRECTED ACREAGE AS PER LETTER N.M.O.C. DATED 2-14-68.

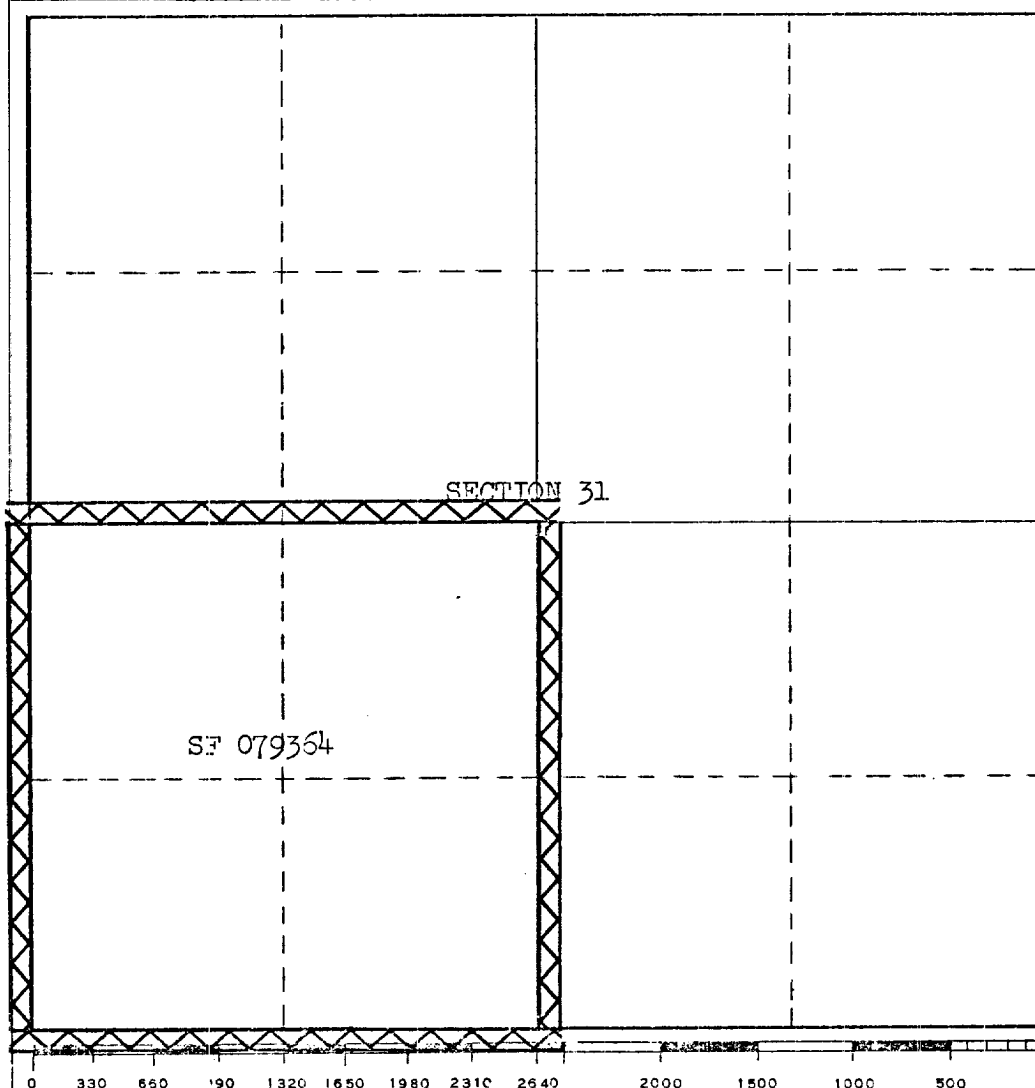

CERTIFICATION

I hereby certify that the information contained herein is true and complete to the best of my knowledge and belief.

*Carl E. Matthews*  
Name

Petroleum Engineer  
Position

El Paso Natural Gas Co.  
Company

March 11, 1968  
Date

Date

I hereby certify that the well location shown on this plat was plotted from field notes of actual surveys made by me or under my supervision, and that the same is true and correct to the best of my knowledge and belief.

Date Surveyed

Registered Professional Engineer  
and/or Land Surveyor  
OIL CON. COM.  
DIST. 2

Certificate No.